

ASSEMBLY MANUAL

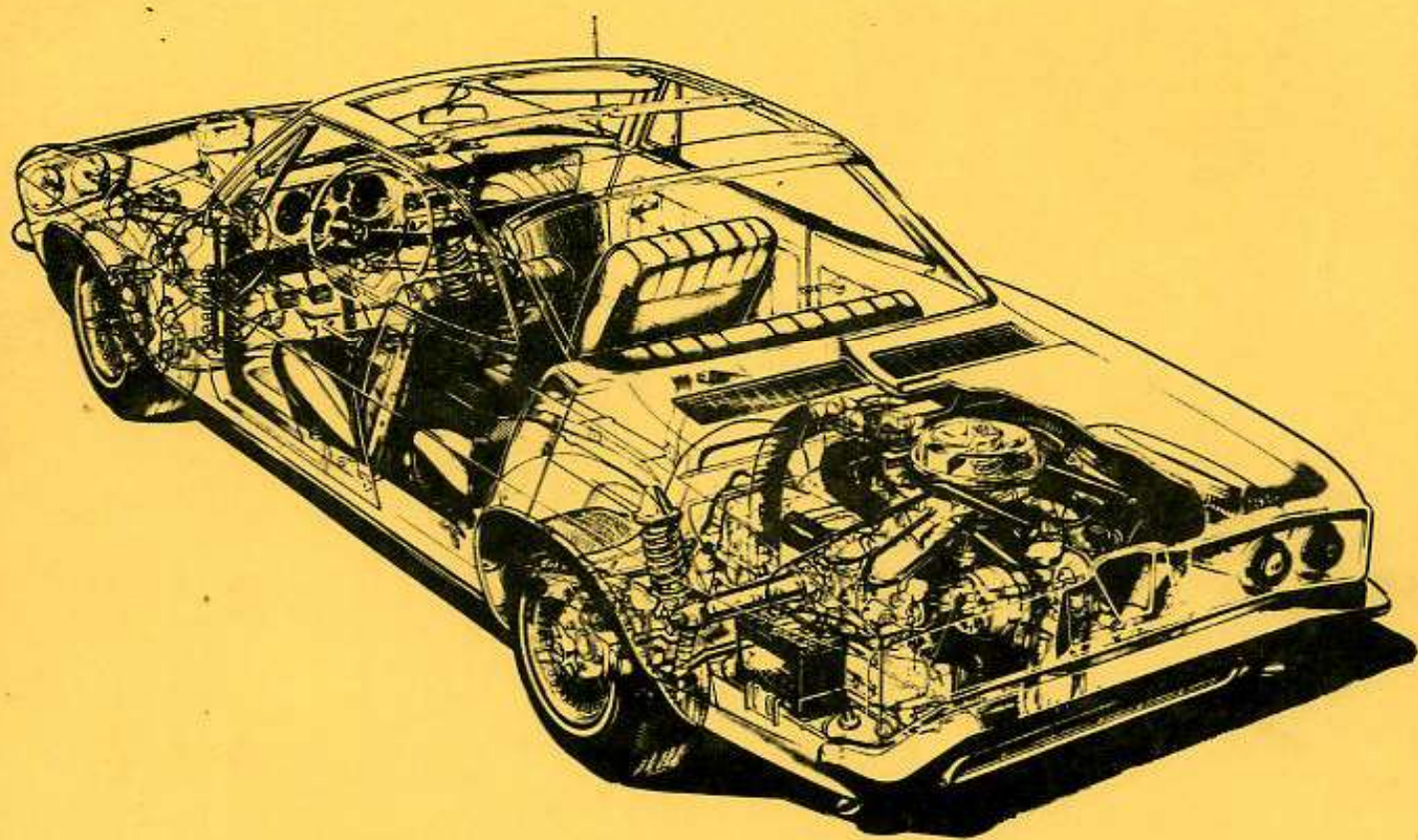

**1965
CORVAIR**

C7315

NOT ILLUSTRATED THIS SHEET

FRONT TRIM HEIGHTS
FRONT SUSPENSION
CHROMIUM

SHEET

1

2

CONTENTS

FRONT SUSPENSION ASSEMBLY
ATTACHING
REAR ASSEMBLY & LINES
FITTING
STABILIZER BAR

SHEET

1

2

3

4

SECTION 3 FRONT SUSPENSION

FRONT SUSPENSION-CONTENTS			
1	2	3	4
5	6	7	8
9	10	11	12
13	14	15	16
17	18	19	20
21	22	23	24
25	26	27	28
29	30	31	32
33	34	35	36
37	38	39	40
41	42	43	44
45	46	47	48
49	50	51	52
53	54	55	56
57	58	59	60
61	62	63	64
65	66	67	68
69	70	71	72
73	74	75	76
77	78	79	80
81	82	83	84
85	86	87	88
89	90	91	92
93	94	95	96
97	98	99	100



CHEVROLET

ASSEMBLY INSTRUCTIONS

3862100

CORVAIR 10000 SERIES

SHEETTITLE

NOT ILLUSTRATED THIS SHEET

- | | | |
|----------|----|--------------------------------------|
| | 1. | CONTENTS |
| A | 2. | FRONT SUSPENSION ASM. -
ATTACHING |
| B | 3. | SHOCK ABSORBER & LUB
FITTINGS |
| C | 4. | STABILIZER BAR |

- | | |
|--------------|------------------------------|
| <u>SHEET</u> | <u>TITLE</u> |
| D 5. | FRONT TRIM HEIGHTS |
| E 6. | FRONT SUSPENSION
GEOMETRY |

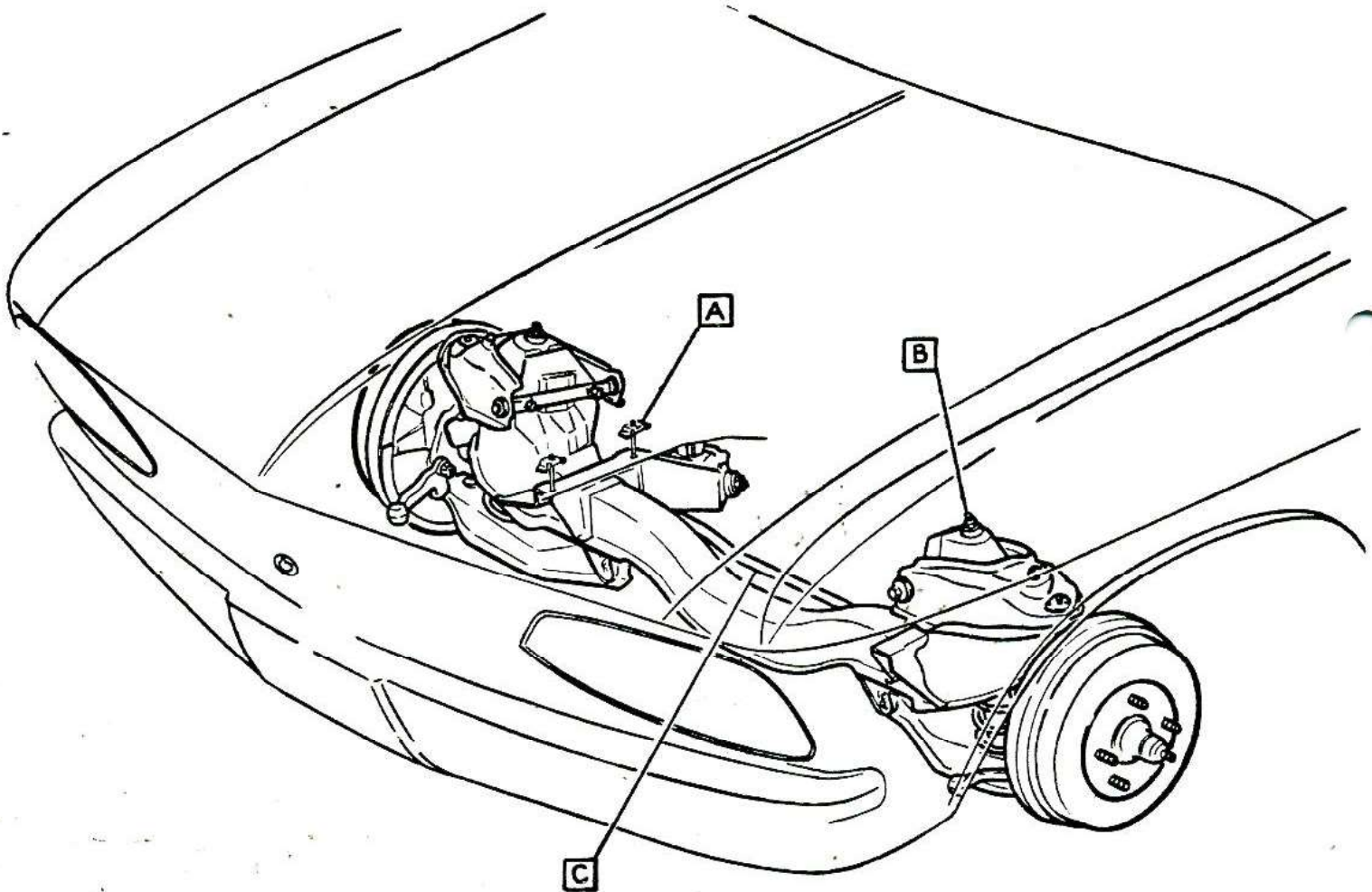

CHEVROLET MOTOR DIVISION, GMC		UPC	DATE	SYM	REVISION RECORD	AUTH.	DE	CX
FRONT SUSPENSION-CONTENTS		3						
10000		1.						
DWG PREL. 2-7	JA	REF. rrel. 1	L-73532	L-				
DATE REL. 2-7		L-	L-	L-				
		<input type="checkbox"/> SHEET	<input checked="" type="checkbox"/>					

1965-30

- | | | |
|----------|----------------|---|
| 1 | 3857074 | Front suspension unit & wheel hub asm. (except 10567 & 10767) |
| | 3857075 | 10567 & 767 |
| 2 | 473059 | P. WASHER |
| 3 | 131099 | L. WASHER |
| 4 | 9416253 | BOLT |
| 5 | 9422214 | BOLT |

INSTALLATION SEQUENCE

DRIVE FRONT BOLTS **5** FIRST, L. H. & R. H. SIDES, THEN INTERMEDIATE BOLTS **5** L. H. & R. H., AND FINALLY REAR BOLT **4**.

NOTE This sequence is necessary to assemble the front suspension unit and wheel hub asm. in place on the body sills with a minimum of assembly stresses built into the job. It takes maximum advantage of the self-aligning features of the holes in the body sills.

NOTE Set caster (see front suspension geometry), tighten with torque shown.

Cage nut - part of body asm.

Bracket - part of body asm.

OPTIONAL TIGHTENING

VIEW A

NOTE Set camber (see front suspension geometry), tighten with torque shown.

VIEW B

FORWARD

- | | |
|---------------------|-----------------------|
| 25-35 LBS FT | 90-120 LBS FT. |
| 35-45 LBS FT | |
| 50-70 LBS FT | |
| 70-90 LBS FT | |

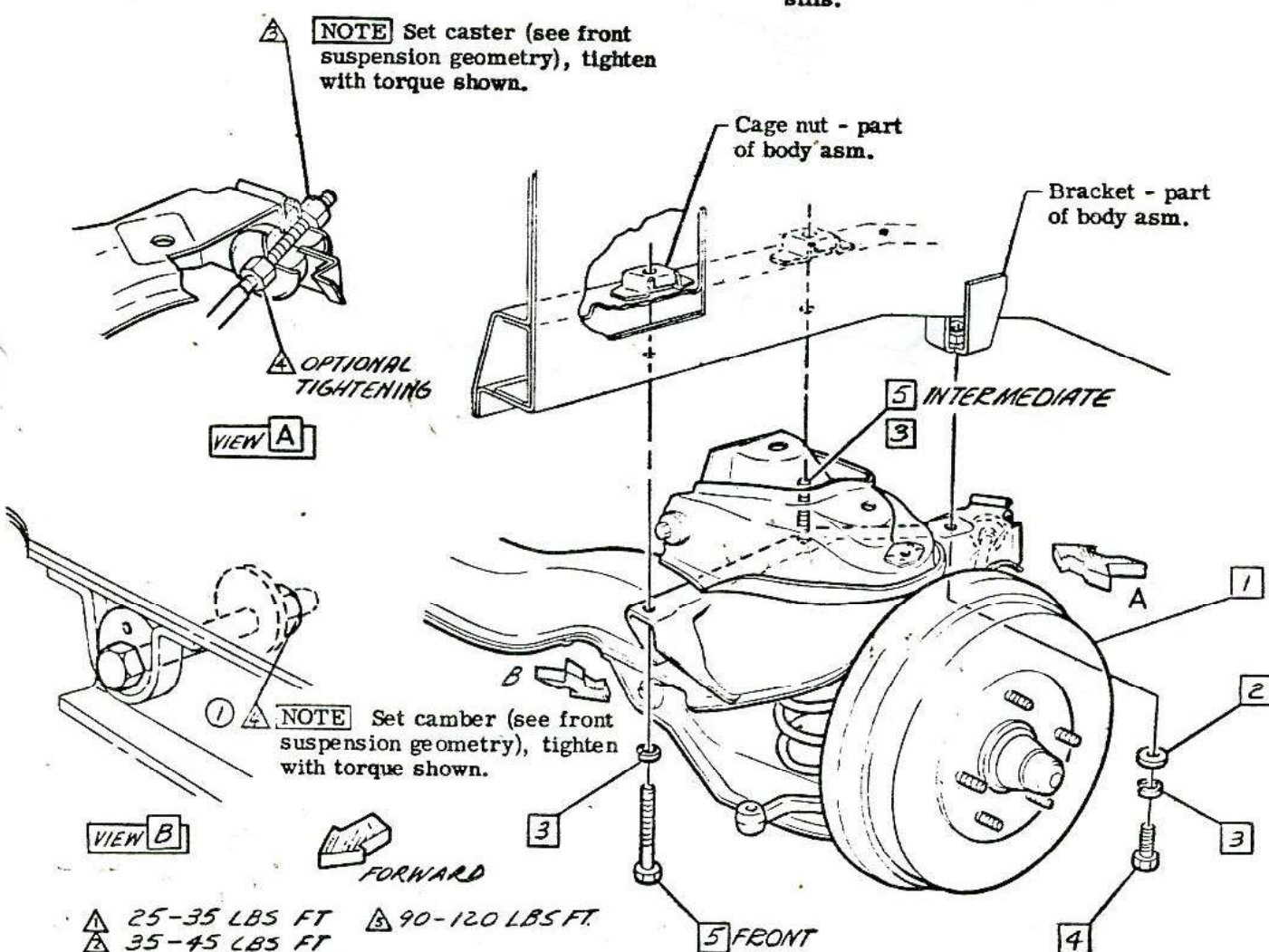

CHEVROLET MOTOR DIVISION, GMC

UPC

DATE SYM

REVISION RECORD

AUTH. DR. CK.

FRONT SUSPENSION ASM. - ATTACHING

3

7-3-64	1	TORQUE (2) WAS TORQUE (5)	45562 TH/CF
12-4-64	2	WAS 45550.9 WASHER	67669 BY/LI

10000

2.

DWG. PREL. 2-7 JA REF: PREL. 2 L- 73532 L-
DATE REL. 5-19 L- L- L-

☒ SHEET



CHEVROLET

ASSEMBLY INSTRUCTIONS

3862100

CORVAIR 10000 SERI

- | | | | | | | | |
|---|---|---------|--------------|----|---------|--------------------|-----|
| ① | 1 | 1365067 | NUT | 8 | 415919 | P. WASHER | |
| | 2 | 5544049 | RETAINER | 9 | 131101 | L. WASHER | |
| | 3 | 3708378 | GROMMET | ④ | 10 | 9417614 | NUT |
| ② | 4 | 3880522 | BUMPER ASM | 11 | 3186935 | SHOCK ABSORBER ASM | |
| ② | 5 | 9417901 | LUBE FITTING | | | | |
| | 6 | 3858356 | BOLT | | | | |
| ③ | 7 | 358501 | NUT | | | | |

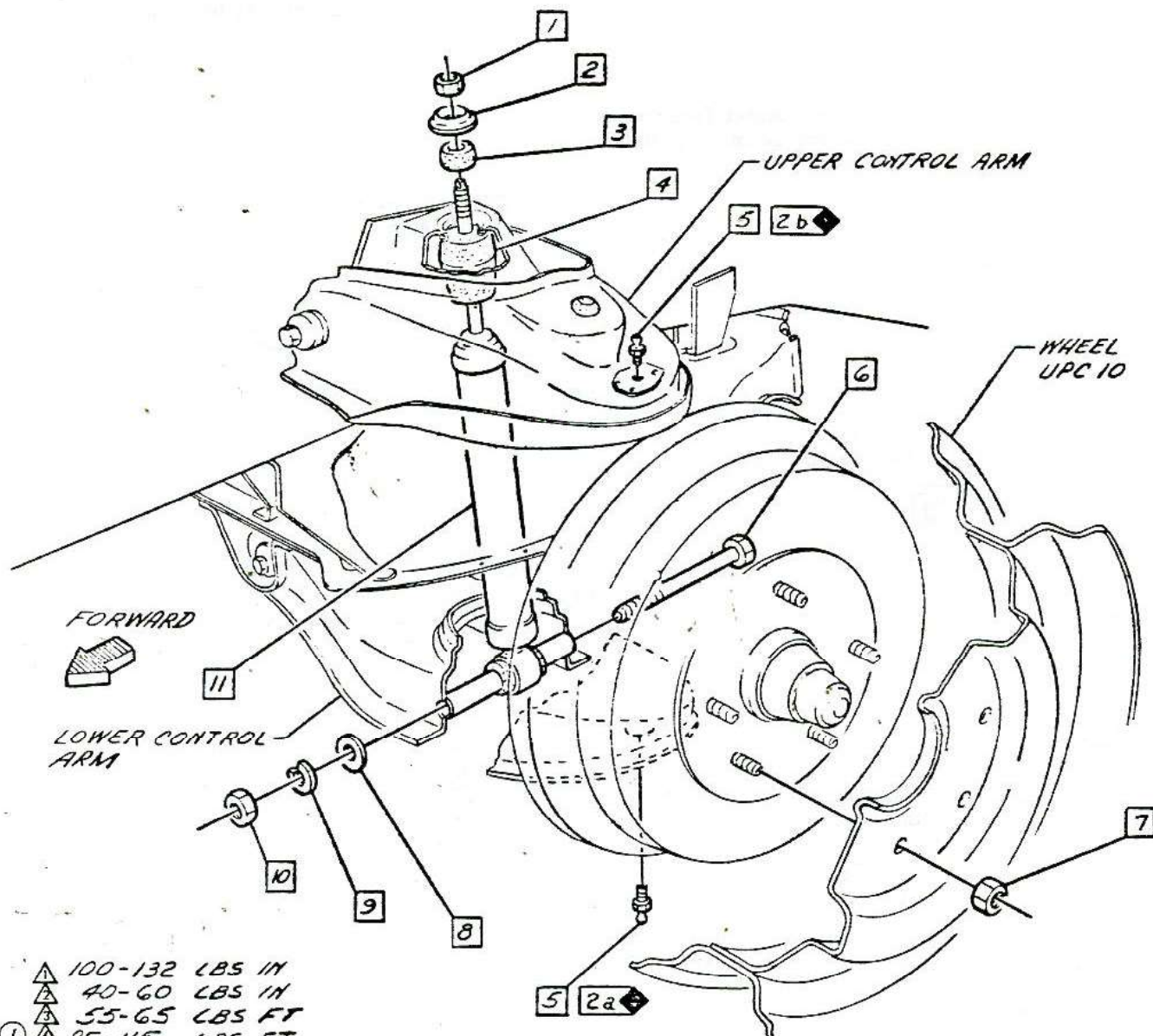











- ▲ 100-132 LBS IN
 ▲ 40-60 LBS IN
 ▲ 55-65 LBS FT
 ① ▲ 85-115 LBS FT

• CHEVROLET MOTOR DIVISION, GMC •				UPC	DATE	SYM	REVISION RECORD	AUTH.	DR	CK.
SHOCK ABSORBER & LUBE FITTINGS				3	1-20-64	1	TORQUE 4 W/ 15-20 LBS FT	255-2	TH	DF
					2-2-65	2	WAS 3858354 BUMPER	29-63	JH	CI
10000				3.						
DWG PREL. 2-13				JA	REF: Prel. 3		L-73532 L-			
DATE REL. 5-19					L-		L-			
				SHEET						

ASSEMBLY INSTRUCTIONS

3862100

CORVAIR 10000 SERIES

- | | | | |
|---|---|---|-------------|
|  |  | 120376 | NUT |
|  |  | 103320 | L. WASHER |
| |  | 3859145 | SUPPORT ASM |
| |  | 103321 | L. WASHER |
|  |  |  | 6255675 |
| |  | 3859143 | SHAFT |

- | | | |
|----|---------|---------------------------------|
| 7 | 3851087 | BUSHING |
| 8 | 122017 | BOLT-Must be installed as shown |
| 9 | 3859819 | BUSHING |
| 10 | 3859144 | CLAMP |
| 11 | 454916 | BOLT |

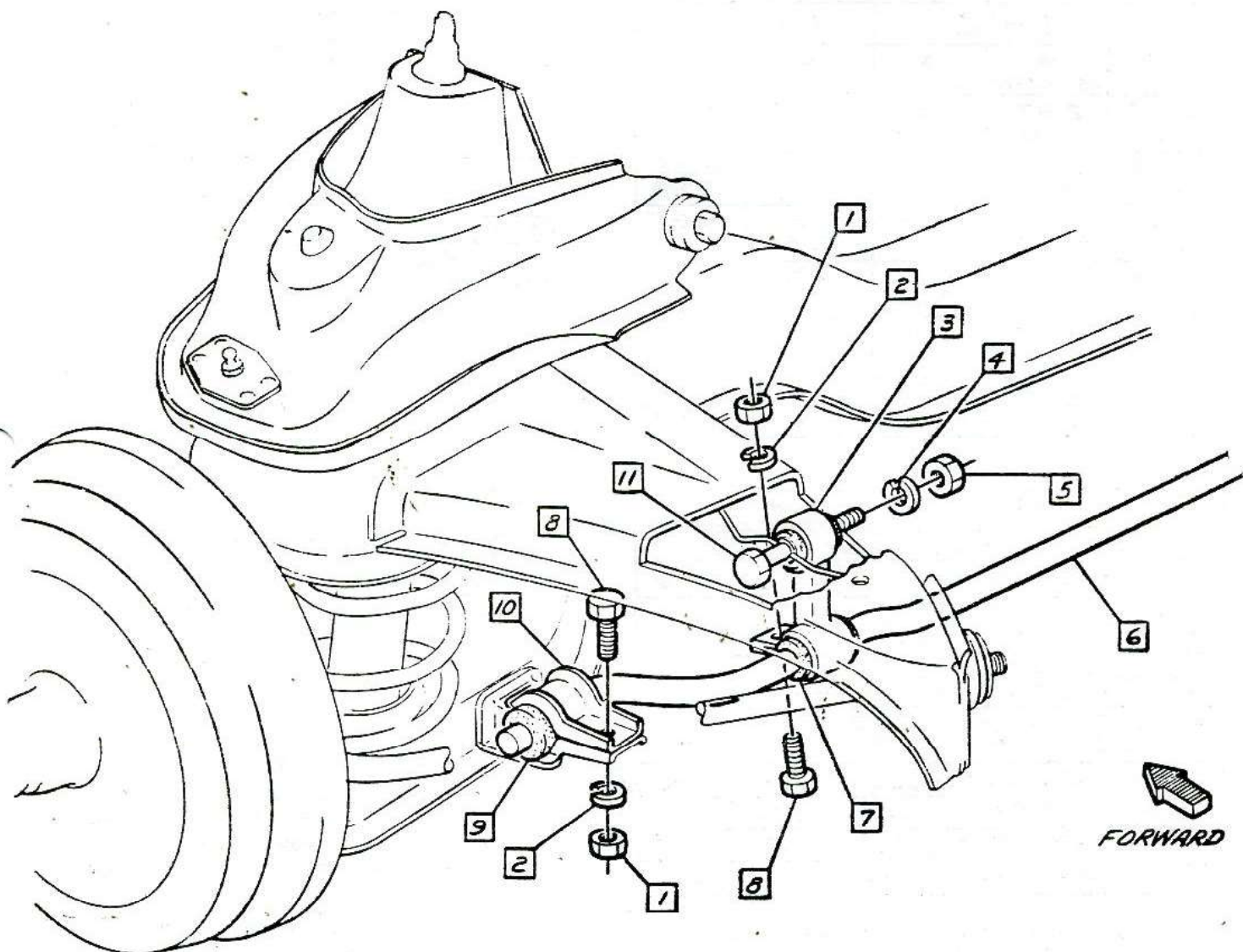

FORWARD

②  100-140 LBS IN
40-50 LBS FT

• CHEVROLET MOTOR DIVISION, GMC •				UPC	DATE	SYM	REVISION RECORD	AUTH.	DR	CK
STABILIZER BAR				3	9-25-64	1	BOLT NUTS ADDED	66467	GB	
						2	TORQUE (2) WAS 30-40 LBS FT			
10000				4.		3	WAS 1E7119 L WASHER	63431		DE
					12-7-64	4	WAS 120377 NUT	66341		JC
						5	WAS 3733130 BOLT			CL
DWG PREL. 2-14 JA REF: Prel. 4 L-73532 L-										
DATE REL. 5-19 L- L- L-										
X SHEET										



CHEVROLET

ASSEMBLY INSTRUCTIONS

3862100

CORVAIR 10000 SERIES

VEHICLE HEIGHTS

FIGURES INCLUDE AUTOMATIC TRANSMISSION
RADIO & COMFORT & CONVENIENCE WITH
WATER IN WINDSHIELD WASHERS.

NOTE PULL VEHICLE UP 3 OR MORE TIMES
ALLOW TO SETTLE, THEN MEASURE "Z" &
"J" DIMENSIONS.

MODEL	DIM. "Z"		DIM. "J"	
	★ AS SHIPPED	● CURB (REF)	★ AS SHIPPED	● CURB (REF)
10137	2.97	2.50	9.50	9.10
A/C	2.90	2.45	9.47	9.08
10139	2.74	2.27	9.29	8.89
A/C	2.69	2.24	9.26	8.88
10537	2.83	2.35	9.35	8.95
A/C	2.77	2.32	9.32	8.94
10539	2.60	2.13	9.14	8.75
A/C	2.55	2.10	9.12	8.74
10567	2.55	2.11	9.03	8.66
A/C	2.20	1.85	8.69	8.39
* 10737	2.72	2.25	9.24	8.84
* 10767	2.49	2.06	8.96	8.59

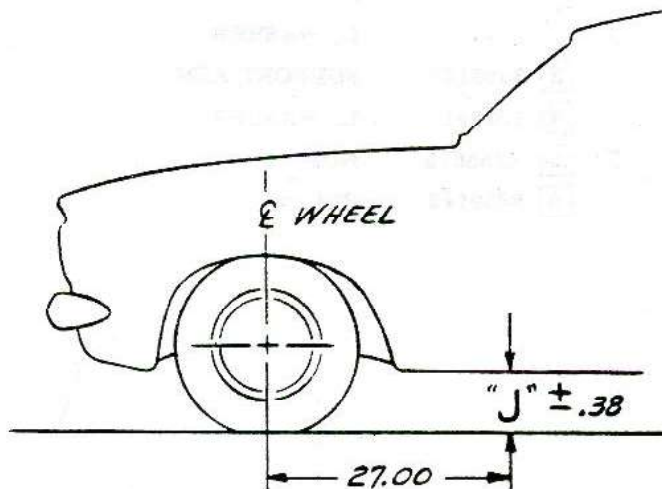

NOTE MEASURE "J" FROM ROCKER
PANEL (NOT SILL MOLDING) TO
GROUND.

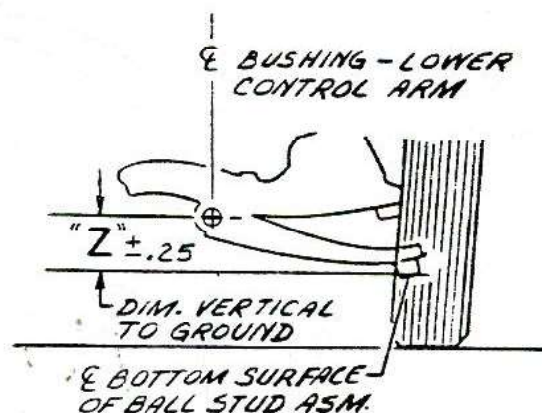

WHEN VEHICLE HAS THE FOLLOWING
EQUIPMENT - ADD OR SUBTRACT FROM
CHARTS AS SHOWN BELOW

	EQUIPMENT	DIM. "Z"	DIM. "J"
PROD.	3 SPEED TRANS.	.00	+.01
PROD.	4 SPEED TRANS.	.00	.00
PROD.	L-63 ENGINE	+.01	-.02
PROD.	L-87 ENGINE	+.01	0

* HEIGHTS FOR 10700 MODELS
INCLUDE L-63 ENGINE

SEDAN & COUPE	HEAVY DUTY SUSP. Z17	AS SHIPPED	-1.21	-.99
		CURB	-1.04	-.86
CONV	HEAVY DUTY SUSP. Z17	AS SHIPPED	-1.00	-.78
		CURB	-.87	-.67

LOAD CONDITIONS

★ AS SHIPPED - OIL, 2 GALS. OF FUEL &
RECOMMENDED TIRE PRESSURE
● CURB WEIGHT - OIL, FULL TANK OF FUEL &
RECOMMENDED TIRE PRESSURE

RECOMMENDED TIRE PRESSURE

HEAVY DUTY SUSPENSION

ALL MODELS - 19 LBS FRONT
30 LBS ± 2 LBS
REAR

RECOMMENDED TIRE PRESSURE

SEDAN & COUPE - 15 LBS FRONT & 26 LBS
(EXC. A/C) ± 2 LBS REAR
A/C & CONVERTIBLE - 15 LBS FRONT & 28 LBS
± 2 LBS REAR

CHEVROLET MOTOR DIVISION, GMC				UPC	DATE	SYM	REVISION RECORD	AUTH.	DR	CK
FRONT TRIM HEIGHTS				3	12-7-64	E	REDRAWN/REDESIGNED	67258	J.C.	C1
10000				5.						
DWG. PREL. 2-15	JA	REF. PREL. 5	L-	L-						
DATE REL. 4-28			L-	L-						
				SHEET						

1965-34

+

MODELS	* CAMBER		* CASTER		TOTAL TOE-IN	
	★ AS SHIPPED	● CURB (REF.)	★ AS SHIPPED	● CURB (REF.)	★ AS SHIPPED	● CURB (REF.)
ALL	40'±30'	1°±30'	① 2°30'±30' ③	② 3°±30' ④	1/2" TO 5/8"	1/4" TO 3/8"

* LEFT & RIGHT SIDES EQUAL WITHIN 0°30'

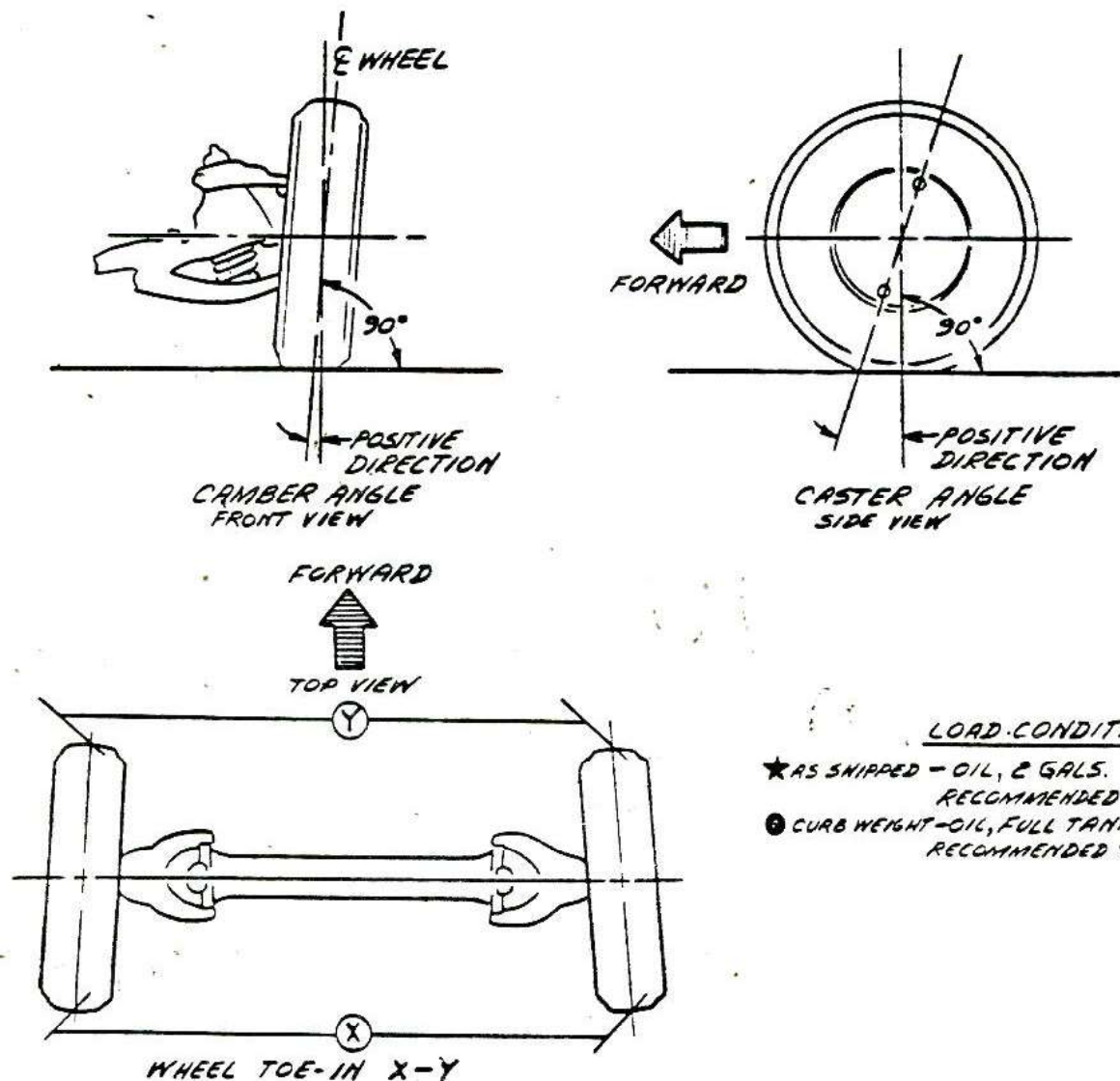

LOAD CONDITIONS

- ★ AS SHIPPED - OIL, 2 GALS. OF FUEL & RECOMMENDED TIRE PRESSURE
- CURB WEIGHT - OIL, FULL TANK OF FUEL & RECOMMENDED TIRE PRESSURE

* CHEVROLET MOTOR DIVISION, GMC *				UPC	DATE	SYM	REVISION RECORD	AUTH.	DR	CK
FRONT SUSPENSION GEOMETRY				3	10/24/44	1	HAS 1°35'±30'	66541	MM	
10000				6.	12/30/44	2	HAS 2°±30'			HB
DWG. PREL. 2-17						3	HAS 3°3'±30'	68389	BR	
DATE REL. 5-19						4	HAS 3°30'±30'			CI
REF: Prel. 6										
L- L- L-										
L- L- L-										
X SHEET										

This document was created with Win2PDF available at <http://www.win2pdf.com>.
The unregistered version of Win2PDF is for evaluation or non-commercial use only.
This page will not be added after purchasing Win2PDF.