

# 1966 FISHER BODY SERVICE MANUAL

FOR ALL  
BODY STYLES

This publication contains the essential removal, installation, adjustment and maintenance procedures for servicing all 1966 Fisher Body Styles. All information, illustrations, and specifications contained in this publication are based on the latest product information available at the time of publication approval. The right is reserved to make changes at any time without notice.

Arrangement of the material is shown by the table of contents on the right-hand side of this page. Black tabs on the first page of each section can be seen on the edge of the book below the section title. A more detailed table of contents precedes each section, and an alphabetical index is included in the back of the manual.

FISHER BODY DIVISION  
PART NO. 4226635

LITHO IN U.S.A.  
AUGUST 1965

Reprinted with Permission of  
General Motors Corporation

## TABLE OF CONTENTS

SECTION	TITLE
1	GENERAL INFORMATION
2	LUBRICATION
3	FRONT END
4	HEADLINING
5	ROOF
6	FOLDING TOP
7	DOORS
8	REAR QUARTER
9	REAR END
10	SEATS
11	ELECTRICAL
12	EXTERIOR MOLDINGS
13	INDEX

"Portions of materials contained herein have been reprinted with permission of General Motors Corporation, Service Technology Group."

©1965 GENERAL MOTORS CORPORATION

16. Inspect installation for proper seal between new caulking material and original material. If a gap is encountered, apply sufficient caulking material to fill the void. On inside of body run a flat stick around the pinchweld flanges to push excess caulking material back into opening between glass and flanges. Remove any excess squeeze-out of material.

17. Watertest installation immediately using cold water spray.
18. Remove masking tape from inside of glass.
19. Install reveal moldings, inside garnish moldings and previously removed parts.

## REAR QUARTER STATIONARY WINDOW "X" STATION WAGON

### REMOVAL

1. Remove rear quarter garnish moldings and rear quarter reveal moldings (see Molding section of Body Service Manual).
2. Remove quarter window upper and lower retainer and belt finishing molding supports.
3. Using a suitable tool, carefully break seal between window rubber channel and body opening. With the aid of a helper, carefully push glass and rubber channel assembly inboard and remove assembly from opening.

**CAUTION:** Use care so that glass does not strike body metal. Edge chips can cause solid tempered safety plate glass to shatter: Do not attempt to grind glass.

### INSTALLATION

1. Clean off old sealer from rubber channel and

body opening to assure a smooth sealing surface.

2. Apply a bead of black weatherstrip adhesive into glass cavity in rubber channel and install rubber channel to glass.
3. Apply a ribbon of medium-bodied sealer completely around window opening.
4. Insert window assembly into opening and install upper and lower window retainers.
5. Using a pressure type applicator, apply weatherstrip adhesive (black) between glass and lip of rubber channel completely around outside of window.
6. Clean off excess sealer and replace previously removed parts.

## REAR QUARTER HARDWARE

### DESCRIPTION

As shown in the following rear quarter hardware drawings, the "closed" style rear quarter window assembly operates within glass run channels. On "hardtop" styles, nylon rollers, which are components of the lower sash channel or which are bolted directly to the window glass, operate within the window front and rear guides.

All side windows are frameless solid tempered safety plate glass. Therefore, use caution when handling window assemblies which may shatter if chipped or deeply scratched.

In order to perform any service operations in the rear quarter it is necessary to remove the rear quarter trim as specified in the preceding trim section (see index).

### REAR QUARTER INNER PANEL SEALING

All rear quarter inner panels are sealed with one or a combination of water deflectors, access hole

covers, sealing plugs (or grommets) and body sealer. Service procedures for inner panel water deflectors are outlined in the "Front and Rear Door" section of this manual (see index). Figure 8-25 is typical of a water deflector installation.

Inner panel access hole covers are retained by a series of screws and sealed with body sealer. Usually, removal of either the water deflector or access hole cover will provide the clearance required for service procedures of rear quarter hardware. Whenever any seal has been disturbed, however, the area must be carefully resealed to prevent waterleaks. Body caulking compound is recommended for service sealing. Figure 8-26 illustrates quarter inner panel sealing on styles which use individual seals at all hardware attaching locations.

### PHANTOM VIEWS

The following figures illustrate the rear quarter

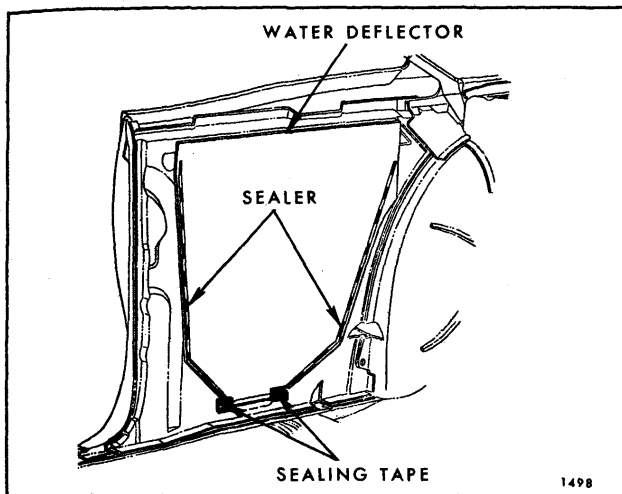

Fig. 8-25—Rear Quarter Inner Panel Sealing - Typical of Water Deflector Installation

hardware components and their relationship to each other on the various styles.

## REAR QUARTER WINDOW "A & B-11" STYLES AND "A-07" STYLE

### Removal and Installation

1. Remove rear quarter trim assembly and inner panel water deflector.

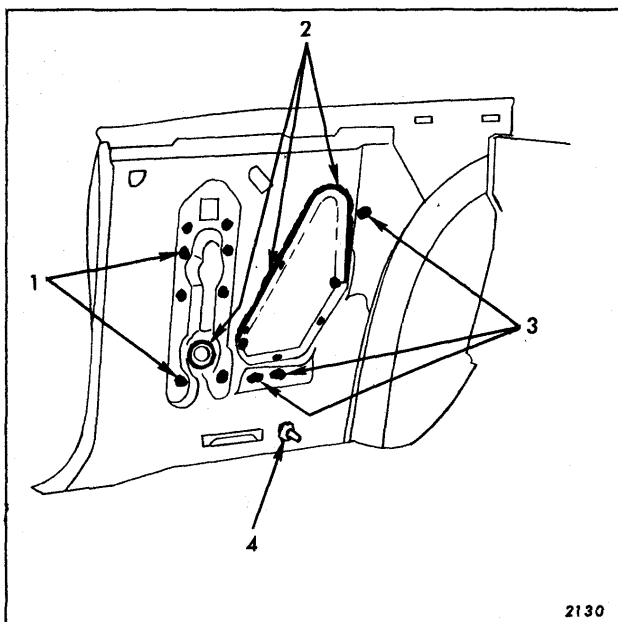

Fig. 8-26—Rear Quarter Inner Panel Sealing - "67" Styles

- |                                   |                                      |
|-----------------------------------|--------------------------------------|
| 1. Regulator Attaching Bolt Slots | 3. Window Guide Adjusting Stud Slots |
| 2. Access Hole Covers             | 4. Electrical Harness Grommet        |

2. On "A" styles, remove glass run channel outer strip assembly. Refer to index of "Front Door" section for strip assembly removal.
3. On "A & B" styles lower window to position shown in Figure 8-39 for "A-07" styles, 8-40 for "A-11" styles, and 8-41 for "B-11" styles.
4. Supporting window with one hand, disengage clip retainer securing regulator lift arm to pivot pin on window lower sash channel ("11" styles) or to lower edge of glass ("07" style).
5. Lower front edge of glass until nylon guide at top of window front vertical sash comes out of front glass channel and rear edge of glass comes out of rear run channel. Then, lift glass up (rear edge first) and remove window from body outboard of window opening.
6. To install, reverse removal procedure.

## REAR QUARTER WINDOW—"X-11" STYLE

### Removal and Installation

1. Remove rear quarter trim assembly and inner panel water deflector.
2. Remove glass run channel inner and outer strip assemblies (at belt). Refer to index of "Door" section for removal procedure.
3. With the window in the full up position, remove window support to regulator plate attaching screws (Fig. 8-42).
4. Operate window regulator down. Disengage window assembly from regulator arm and tilt rear of window downward to disengage window from glass run channels. Lift window upward and inboard and remove from body.
5. To install, reverse removal procedure.

## REAR QUARTER WINDOW ADJUSTMENTS—"A & B" CLOSED STYLES

All window assembly adjustments are provided at the window regulator attaching screws.

1. To obtain proper seating of the glass in the upper glass run channels, or proper contact between belt sealing strips and lower sash channel, loosen regulator attaching screws and adjust window as required.
2. To eliminate a fore and aft bind between the glass run channels (hard operating window),

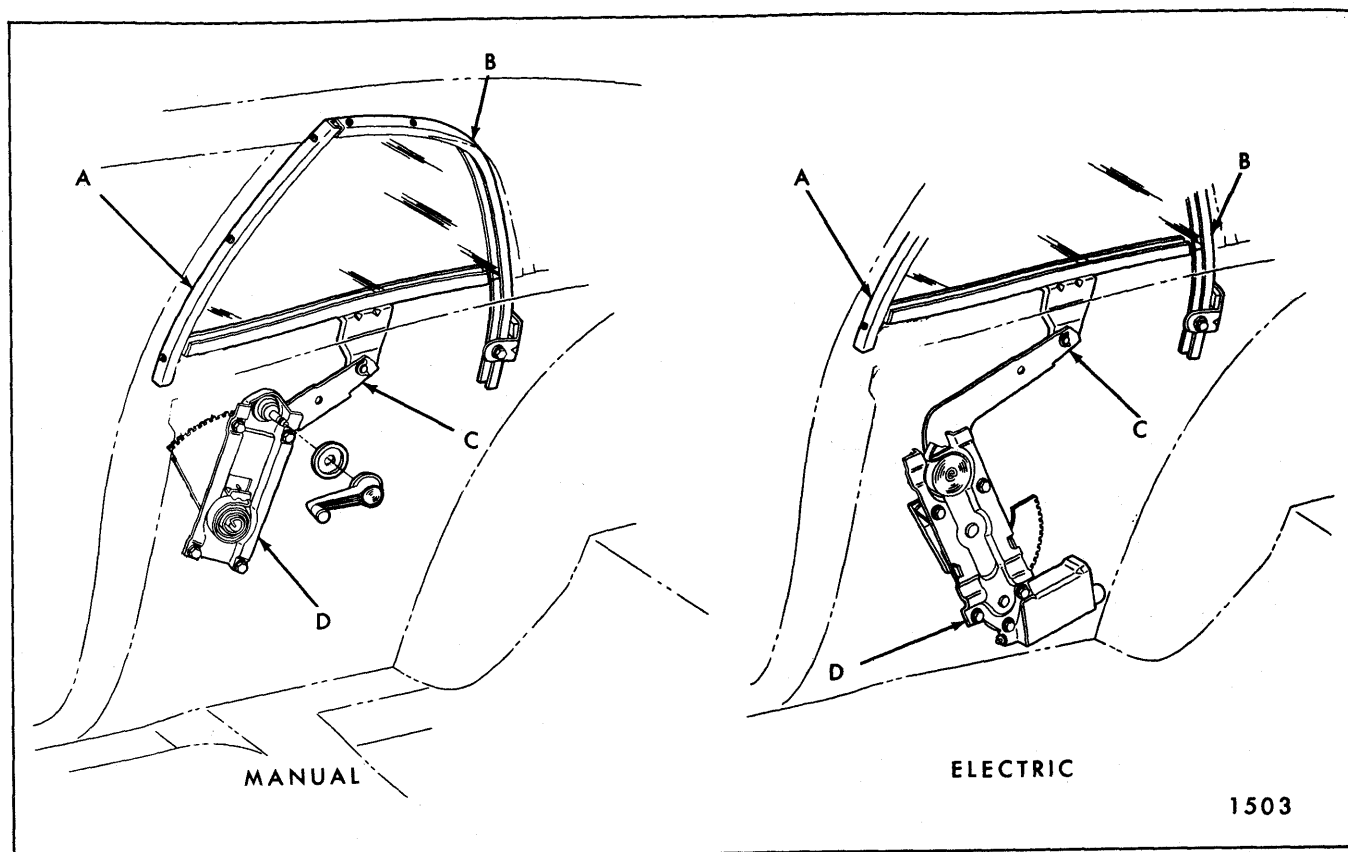

Fig. 8-27—Rear Quarter Window Hardware - "B-11" Styles

A. Front Glass Run Channel  
B. Rear Glass Run Channel

C. Slotted Retainer  
D. Window Regulator

or a condition where window will not stay in rear run channel, loosen rear run channel attaching bolt and adjust run channel fore or aft as required.

### REAR QUARTER WINDOW ADJUSTMENTS—"X" CLOSED STYLES

For proper operation of rear quarter window and correct seating of glass in run channels, adjust rear quarter window in the following sequence:

1. With the window in the full "up" position, loosen the window support to regulator plate attaching screws and the center guide attaching screws.
2. Using hand pressure, press window upward and forward to make certain it is "bottomed" in the upper and forward glass run channels.
3. Tighten window support to regulator plate attaching screws and center guide upper attaching screw.
4. Lower window to full "down" position. Tighten

center guide lower attaching screw while forcing lower portion of guide rearward.

**NOTE:** Do not apply too much pressure when forcing guide rearward, as this tends to make front edge of glass dig into front run channel.

### REAR QUARTER WINDOW REGULATOR (MANUAL AND ELECTRIC)—"A-B & X" CLOSED STYLES

#### Removal and Installation

1. Remove rear quarter trim assembly and inner panel water deflector. On electric styles, disconnect feed wire from regulator motor.
2. On "A & B" styles, disengage clip retainer from pivot pin on window lower sash channel (Fig. 8-41 for "B" styles, Figures 8-39 and 8-40 for "A" styles). Raise window to full-up and prop in that position.
3. On "X" styles, remove support to regulator plate screws (Fig. 8-42). Raise window to full-up and prop in that position.

1503

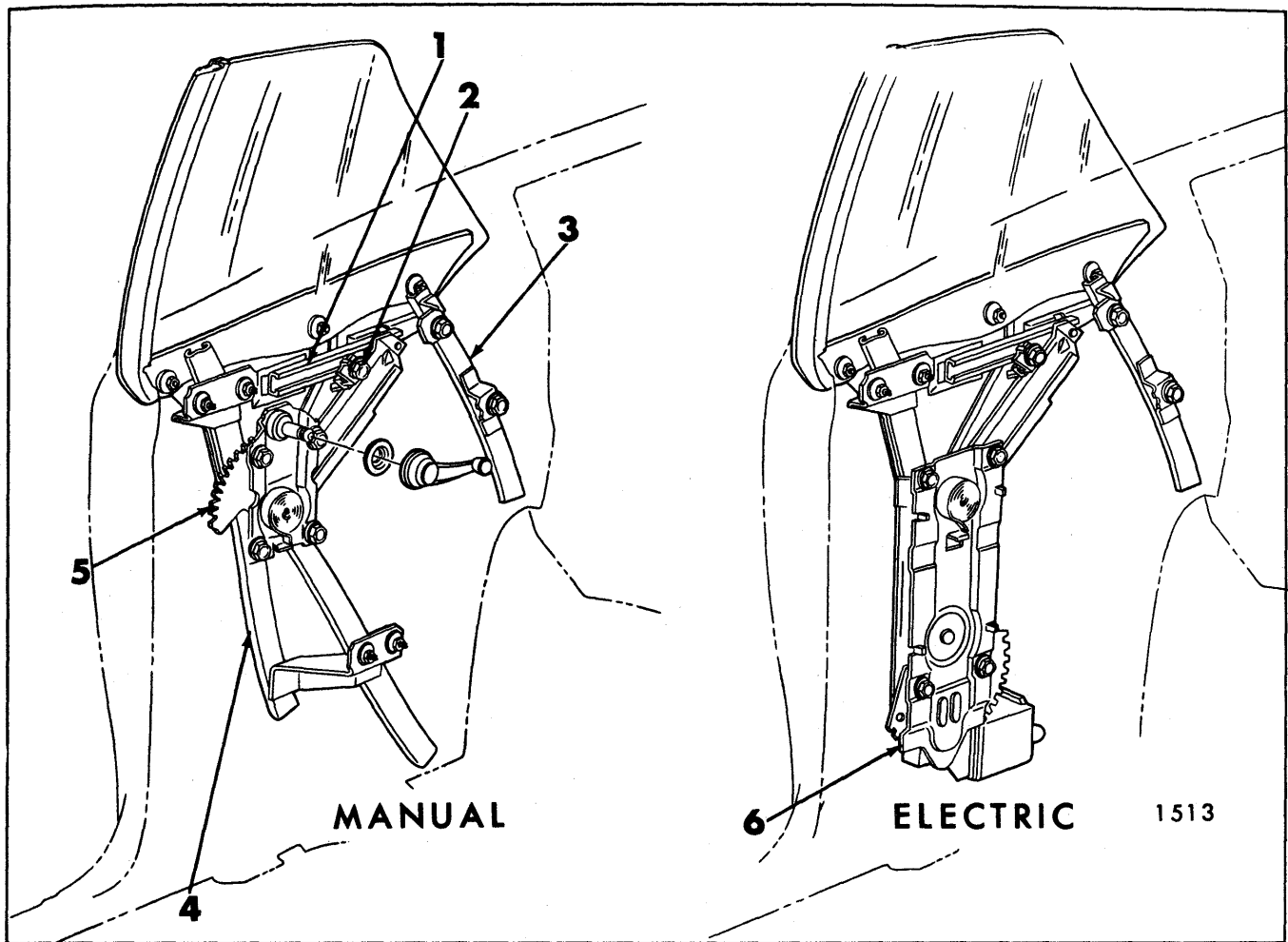

Fig. 8-28—Rear Quarter Window Hardware - "67 B-C" Styles Shown - "37-47-57" Styles Similar

1. Window Sash Channel Cam  
2. Window Up-Stop

3. Rear Guide  
4. Front Guide

5. Regulator (Manual)  
6. Regulator (Electric)

4. On "A & B" styles, remove regulator to inner panel screws and remove regulator through large access hole (Fig. 8-43 - "A" styles shown, "B" similar).
5. On "X" styles, remove regulator to inner panel screws (Fig. 8-42). Disengage roller on regulator plate from window guide and remove regulator through large access hole.
6. To install, reverse removal procedure.

**NOTE:** The procedure for removing electric motor from regulator is described under "Door and Quarter Window Regulator Electric Motor Assembly" in the Door Section of this manual.

## REAR QUARTER WINDOW REAR GLASS RUN CHANNEL—ALL CLOSED STYLES

### Removal and Installation

1. Remove rear quarter window as previously described.

2. Remove run channel to inner panel attaching bolt (Fig. 8-44).
3. On "A-07" style remove screws securing run channel to side roof rail along length of run channel.
4. Using a flat blade tool, carefully pry run channel retaining clips from piercings in side roof rail.

**NOTE:** If difficulty is encountered disengaging run channel, inspect inside of channel for the presence of screws.

5. At belt line on "A" styles, disengage tab on rear run channel from side roof rail by moving run channel downward into opening between the panels; then, remove run channel from body.
6. Prior to installation, inspect foam sealing material for any damage, that would result in waterleaks, and replace as necessary.

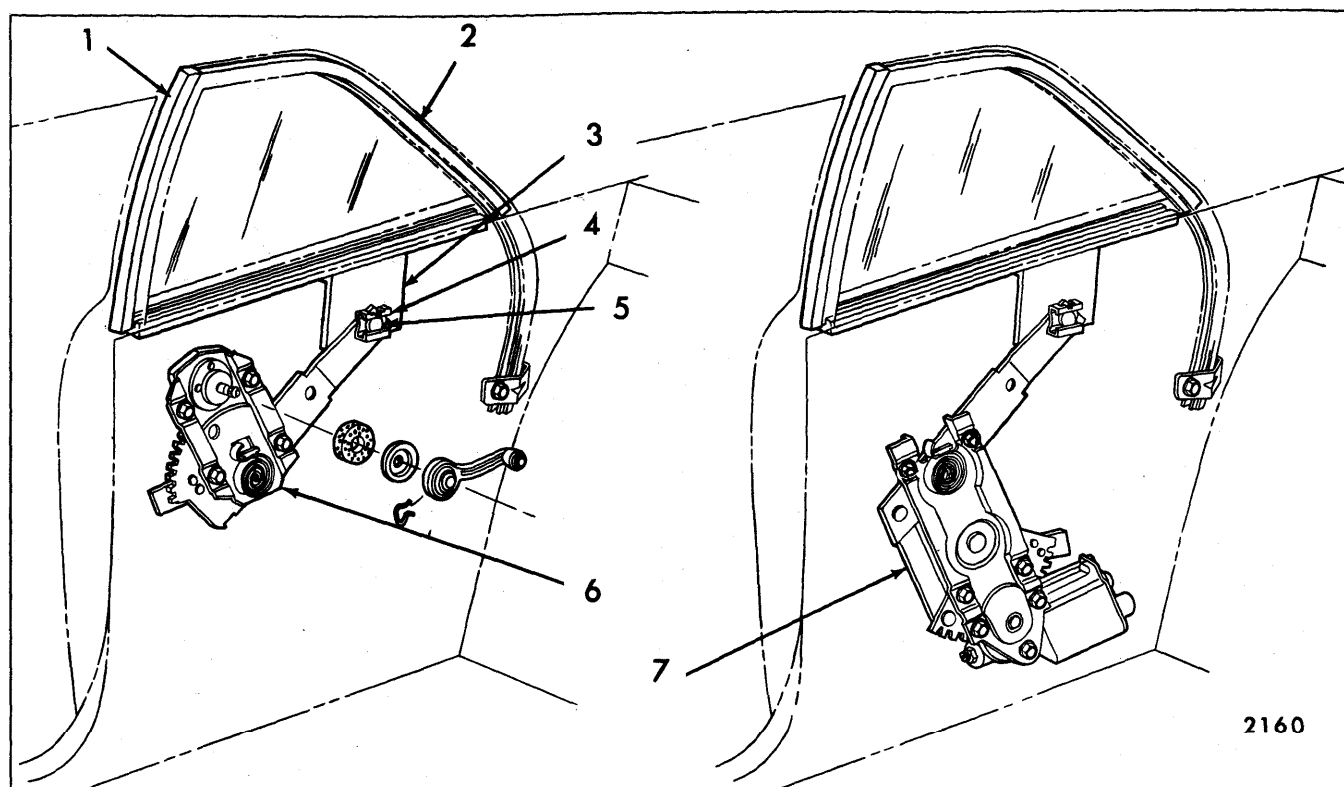

Fig. 8-29—Rear Quarter Hardware - "A-11" Style

- 1. Front Glass Run Channel
- 2. Rear Glass Run Channel

- 3. Window Lower Sash
- 4. Clip Retainer
- 5. Pivot Pin

- 6. Regulator (Manual)
- 7. Regulator (Electric)

- 7. To install, reverse removal procedure.

## REAR QUARTER WINDOW FRONT GLASS RUN CHANNEL—ALL CLOSED STYLES

### Removal and Installation

1. Remove rear quarter window as previously described.
2. On "A" styles, remove screws along length of run channel securing channel to body (Fig. 8-44).
3. On all styles, using a flat blade tool, pry run channel from body pillar and remove run channel (Fig. 8-45).
4. To install, reverse removal procedure. Prior to installation inspect sealing material on body pillar or run channel and replace or add to as required.

## REAR QUARTER WINDOW GUIDE ASSEMBLY—"X-11" STYLES

### Removal and Installation

1. Remove rear quarter trim assembly and trim finishing upper molding.
2. Detach inner panel water deflector sufficiently to gain access to guide attaching screws.
3. Remove guide attaching screws, disengage guide from roller on regulator arm and remove guide through access hole (see Fig. 8-46).
4. To install, reverse removal procedure.

## REAR QUARTER WINDOW OUTER STRIP ASSEMBLY—ALL CLOSED STYLES

1. Remove rear quarter trim assembly and inner panel water deflector.
2. On "A & B" styles, disengage window assembly from regulator lift arm by removing slotted

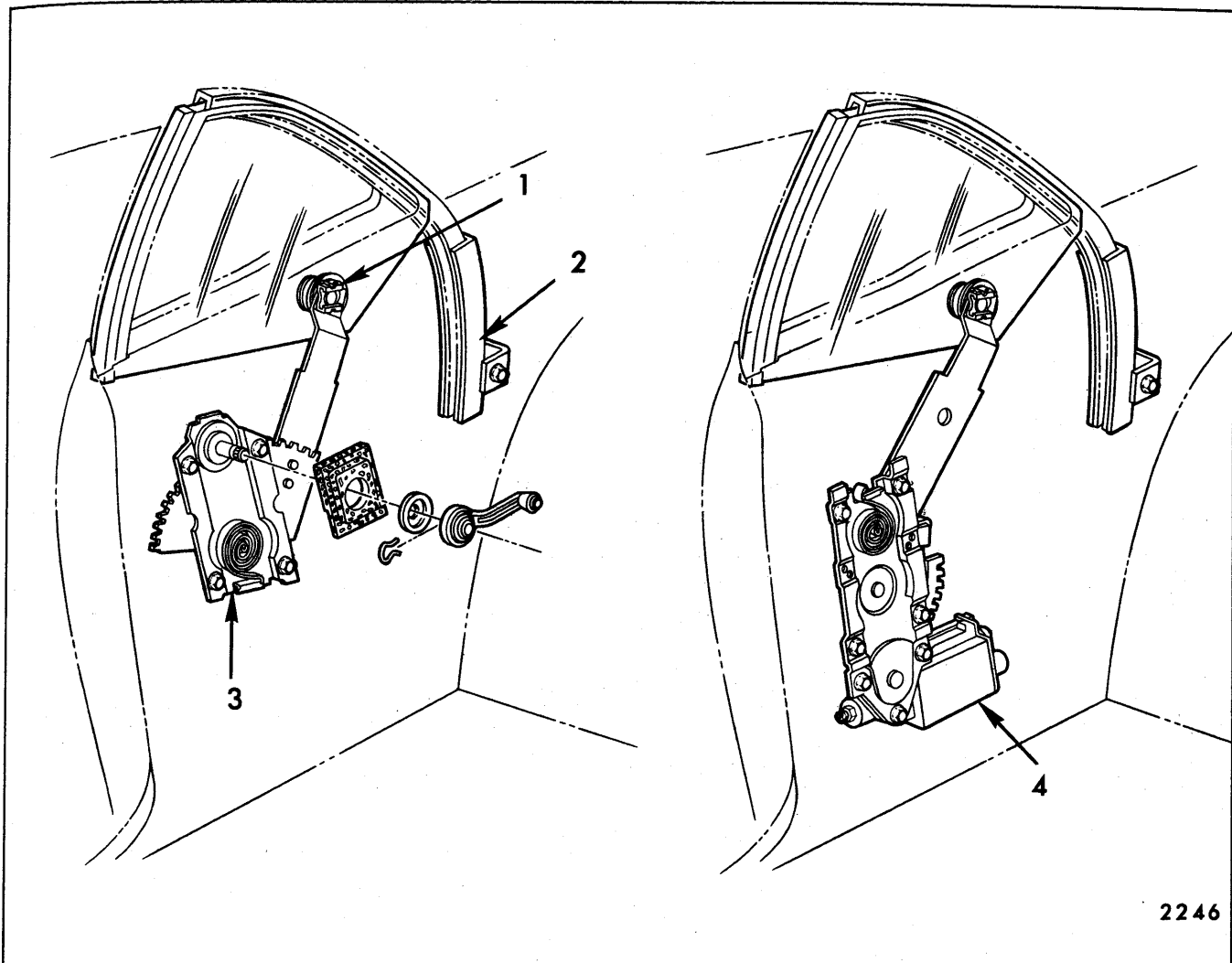

Fig. 8-30—Rear Quarter Hardware - "A-07" Style

1. Glass Retainer
2. Glass Run Channel

3. Window Regulator (Manual)
4. Window Regulator (Electric)

retainer (Fig. 8-41). On "X" styles remove support to regulator plate screws (Fig. 8-42).

3. Lower window assembly to bottom of rear quarter and rest it against outer panel.
4. On styles with screw retained strip assemblies, remove screws securing outer strip to rear quarter outer panel return flange and remove strip from body (Fig. 8-47). On styles with clip retained strip assemblies refer to index of "Door" section for removal procedure.

**NOTE:** Use care not to damage strip assembly or adjacent painted surfaces.

5. To install, reverse removal procedure.

## REAR QUARTER WINDOW ASSEMBLY— "17-37-47-57-67 AND 87" STYLES

The rear quarter window is made of solid tempered safety plate glass. Consequently, it cannot be drilled or ground, or develop scratches or edge chips as it will shatter. The window assembly consists of a pressed-on front vertical sash channel and a bolt-on lower sash channel assembly.

**NOTE:** When reinstalling glass to sash channel bolts, or nylon roller nuts, torque to 60 inch pounds (5 foot pounds). Also, replace glass to sash channel spacers (rubber).

Refer to front of this section for hardware drawings which can assist in performing any of the following procedures. To perform any of these service

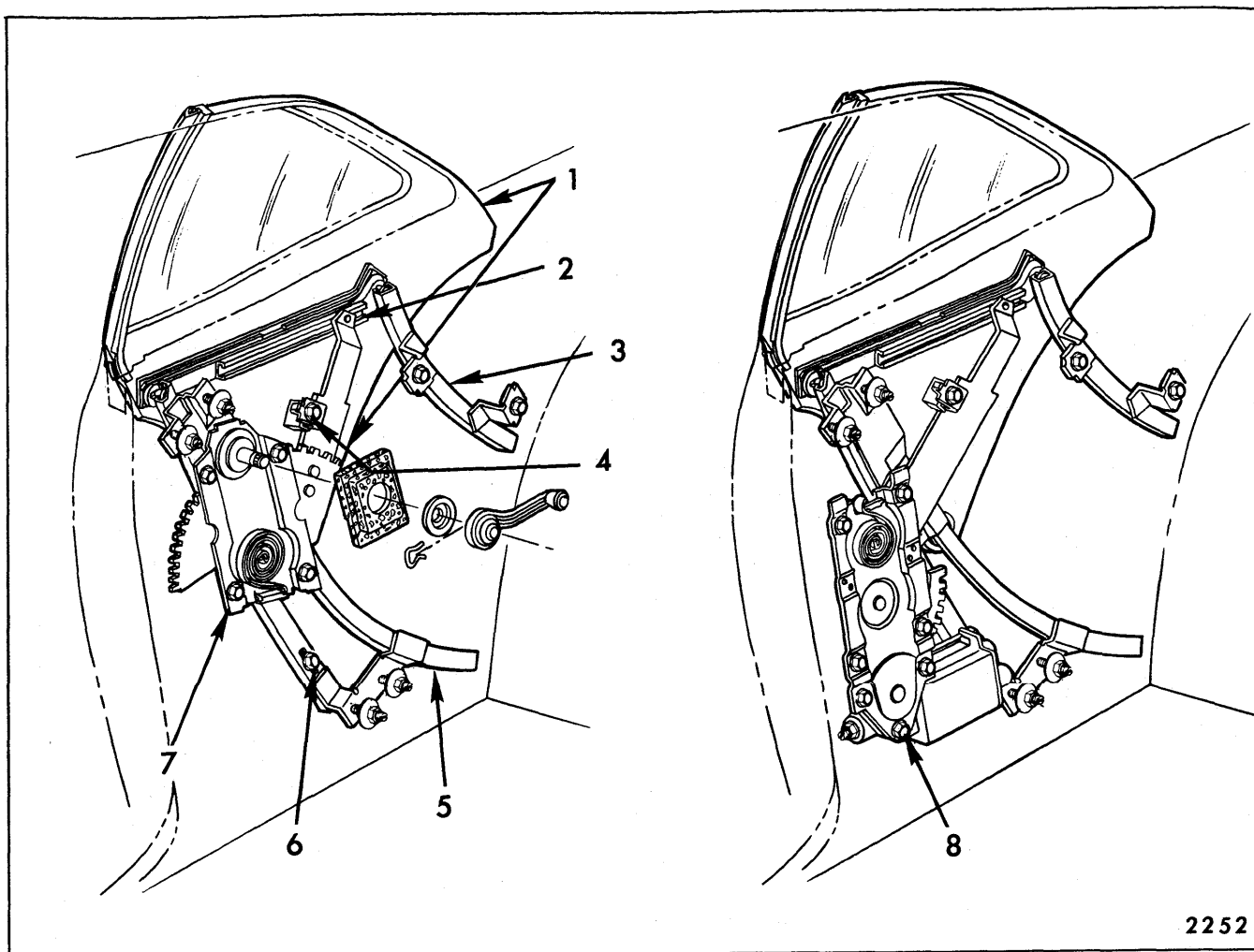

Fig. 8-31—Rear Quarter Hardware - "A-17" Style

1. Window Glass  
2. Sash Channel Cam

3. Rear Guide  
4. Up-Stop

5. Front Guide  
6. Down-Stop

7. Window Regulator (Manual)  
8. Window Regulator (Electric)

operations, remove rear quarter trim assembly and inner panel water deflector or access hole cover.

**a. Removal and Installation "B-C 37 and 57" Styles**

1. With window in full-up position, remove rear guide upper and lower adjusting stud nuts (Fig. 8-48). Disengage guide from roller on window lower sash channel and remove guide through access hole.
2. Lower window to almost full-down position to make lower sash channel cam attaching screws accessible through inner panel access hole (Fig. 8-48).
3. Loosen front guide upper adjusting stud nuts and remove front guide lower adjusting stud nuts (Fig. 8-48).
4. Remove lower sash channel cam attaching

screws (Fig. 8-48). Disengage cam from regulator lift arm roller and remove cam.

5. Manually raise window and remove it from between the panels by lifting upward and inboard.
6. To install rear quarter window, reverse removal procedure. Figure 8-49 is an exploded view of the rear quarter window assembly and identifies the various components and their assembly sequence.

**b. Removal and Installation "B-47" Style**

1. With window in full-up position, remove rear guide upper and lower adjusting stud nuts (Fig. 8-48). Disengage guide from roller on window lower sash channel and remove guide through access hole.



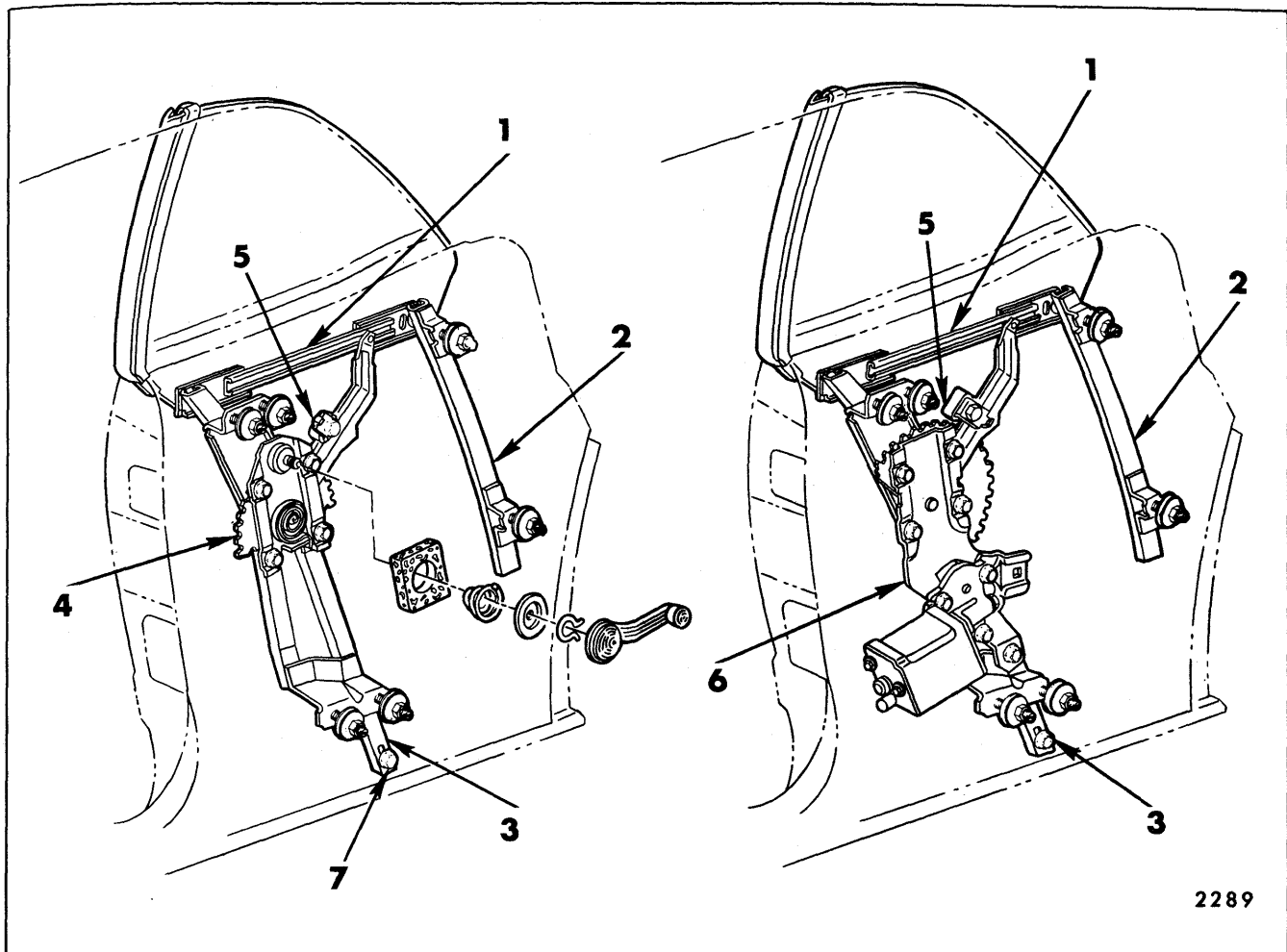

Fig. 8-32—Rear Quarter Hardware - "A-67" Styles

- |                     |                              |                                |
|---------------------|------------------------------|--------------------------------|
| 1. Sash Channel Cam | 4. Window Regulator (Manual) | 6. Window Regulator (Electric) |
| 2. Rear Guide       | 5. Up-Stop                   | 7. Front Guide Lower Stop      |
| 3. Front Guide      |                              |                                |

2. With window lowered to half-down position, remove front guide lower adjusting stud nuts and loosen upper adjusting stud nuts (Fig. 8-48).

3. Disengage front guide lower studs from inner panel by pushing studs outboard. Disengage regulator lift arm from window lower sash channel cam at rear of cam by swinging guide and window assembly forward.

4. Supporting window assembly, drop front guide upper adjusting studs to bottom of the slots in the inner panel. Remove window from body by lifting window upward and inboard.

5. To install, reverse removal procedure. Figure 8-50 is an exploded view of the rear quarter

window assembly and identifies the various components and their assembly sequence.

#### c. Removal and Installation "B-C 67" Styles

1. Lower folding top.

2. Lower window to almost full-down position and remove lower sash channel cam attaching screws (Fig. 8-48). Disengage cam from regulator lift arm roller and remove cam.

3. Lift window straight upward and remove it from body.

4. To install rear quarter window, reverse removal procedure. Figure 8-49 is an exploded view of the rear quarter window assembly and identifies the various components and their assembly sequence.

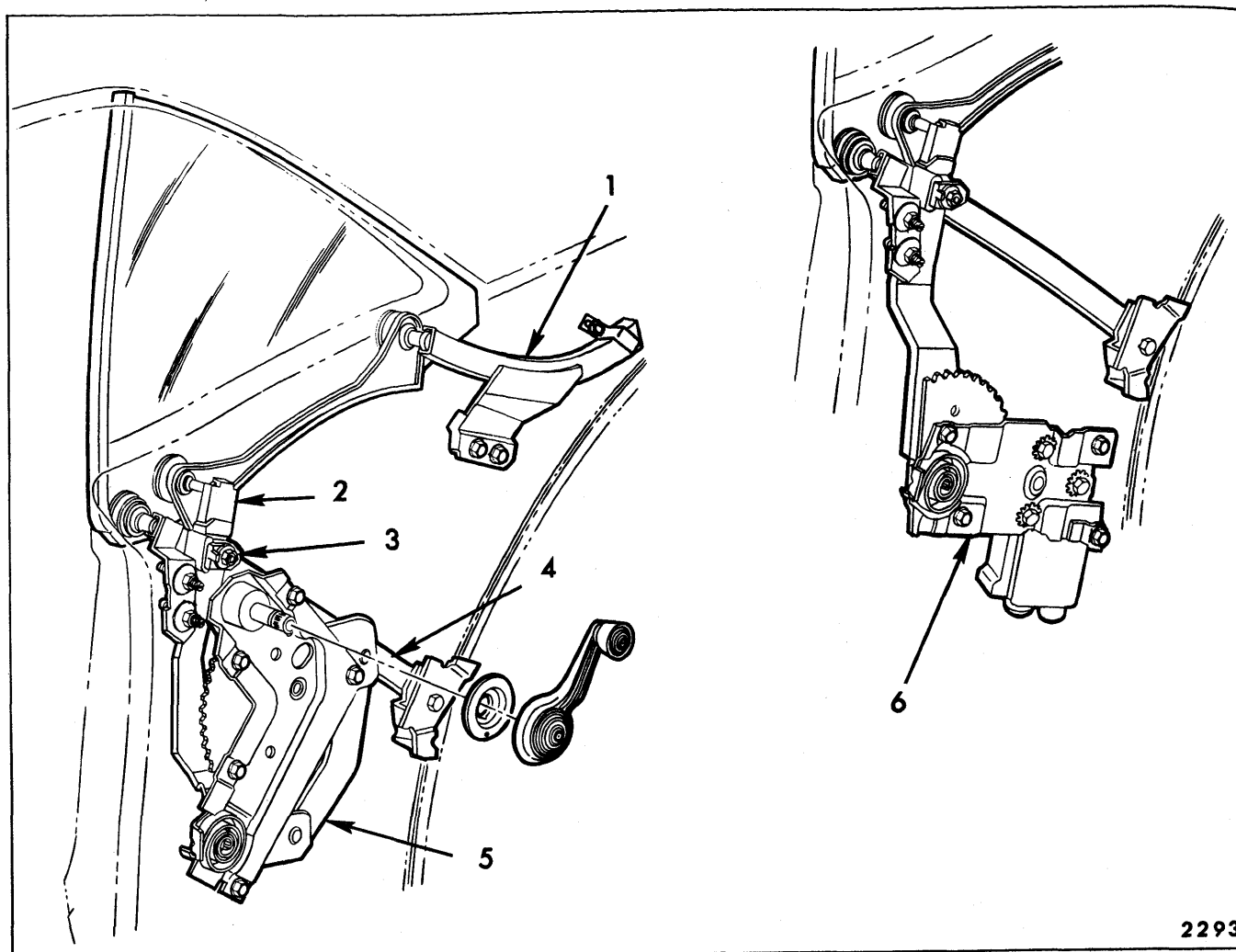

2293

Fig. 8-33—Rear Quarter Hardware - Buick "E" Styles

- |                           |                |                         |
|---------------------------|----------------|-------------------------|
| 1. Rear Guide             | 3. Up-Stop     | 5. Regulator (Manual)   |
| 2. Regulator Lift Arm Cam | 4. Front Guide | 6. Regulator (Electric) |

**Adjustments—"B-C 37-47-57 and 67" Styles**

1. Rear quarter window up-travel is determined by position of the window up-stop (Fig. 8-48). To change the window upper limits, loosen the stop attaching bolt and position the stop as desired.
2. Fore or aft position of the window is determined by the position of the front and rear guides. To adjust the window, loosen the front and rear guide adjusting stud nuts (Fig. 8-48) and reposition the window as required.
3. In or out adjustment of the window assembly, or only the top of the window, can be obtained by utilizing the front and rear guide adjusting studs (Fig. 8-48). To reposition the window in or out, adjust the guide upper and lower adjusting studs in the same direction. To adjust the

top of the window in or out, adjust the lower adjusting studs in the opposite direction of the upper studs.

**d. Removal and Installation "A-17 and 67" Styles**

1. Lower folding top on "67" styles.
2. Remove rear guide upper and lower attaching screws (Fig. 8-51 and 8-52). Disengage guide from sash channel roller and remove guide.
3. Remove glass run channel outer strip assembly (draft strip - see "Front Door" section of manual).
4. Remove the lower two adjusting stud nuts of the quarter window front guide and all but the top attaching bolt of window regulator (see Fig. 8-53).

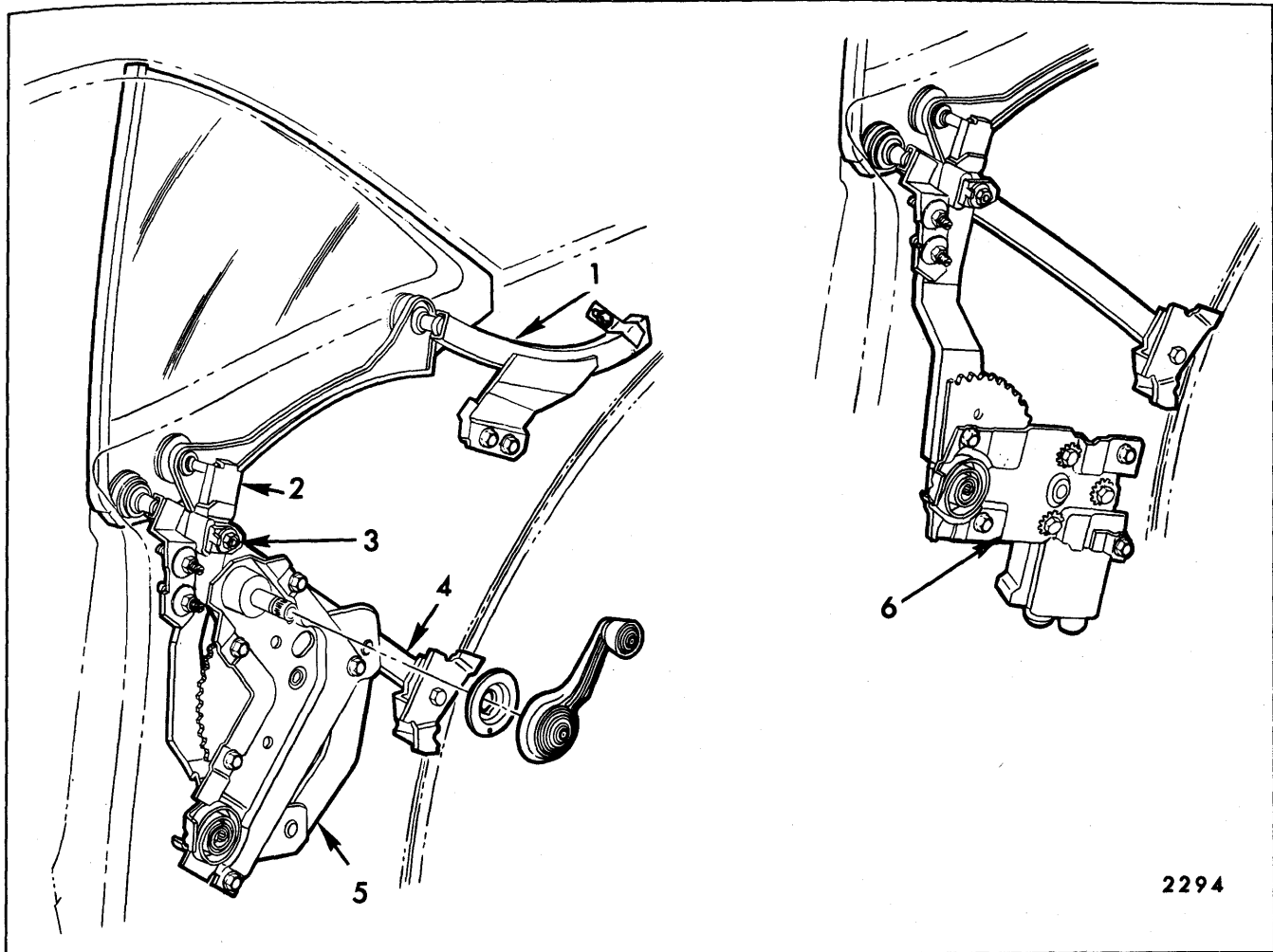

Fig. 8-34—Rear Quarter Hardware - Oldsmobile "E" Body

1. Rear Guide  
2. Regulator Lift Arm Cam

3. Up-Stop  
4. Front Guide

5. Regulator (Manual)  
6. Regulator (Electric)

5. Rotate regulator counter-clockwise until lift arm roller is free of quarter window sash channel cam. Rotate rear edge of glass upward (outboard of side rail on "17" styles) and remove window (see Fig. 8-53).

**NOTE:** If additional clearance is needed (on "17" styles), the side roof rail weatherstrip can be detached at quarter window area.

6. To install, reverse removal procedure.

#### Adjustments—"A-17 and 67" Styles

To perform any rear quarter window adjustments, it is necessary to remove the rear quarter trim assembly.

1. To adjust window "fore or aft", loosen front

and rear guide adjusting stud nuts, position window and guides as required, and tighten nuts.

2. To adjust window "in or out" at belt line, loosen front guide upper adjusting stud nuts, adjust studs in or out as required, and tighten stud nuts.
3. To adjust top of window "in or out", loosen front guide lower adjusting stud nuts, adjust studs in or out as required, and tighten stud nuts.
4. To relieve a "fore or aft" binding condition between front and rear guides, loosen rear guide adjusting stud nut. Operate window to "full-down" position and tighten remaining stud nut.

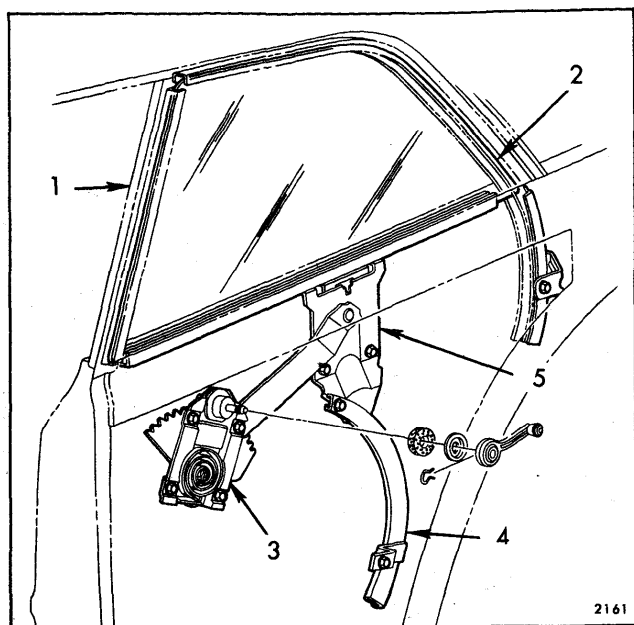

Fig. 8-35—Rear Quarter Hardware - "X-11" Style

- |                            |                      |
|----------------------------|----------------------|
| 1. Front Glass Run Channel | 4. Window Guide      |
| 2. Rear Glass Run Channel  | 5. Window Support to |
| 3. Window Regulator        | Regulator Plate      |

5. To limit up-travel of window, adjust window stop as required (see Figs. 8-52 and 8-51).

#### e. Removal and Installation All "E" Styles

1. With window in full-up position, remove rear guide upper and lower attaching bolts (Fig. 8-54). Disengage guide from roller on window assembly and remove guide through access hole.
2. With quarter window partially lowered (see Fig. 8-54), remove nuts securing regulator lift arm cam to regulator lift arm and remove cam.

**NOTE:** Lift arm must be pushed inboard slightly to remove cam.

3. While supporting glass, remove quarter window front guide attaching bolts and lower guide to bottom of rear quarter.
4. Remove quarter window inboard of roof panel.
5. To install, reverse removal procedure. Figure 8-55 is an exploded view of the quarter window assembly and identifies the various components and their assembly sequence.

#### Adjustments—All "E" Styles

Fore and aft alignment is determined by positioning

front guide. Adjusting rear guide will provide parallel condition of quarter window to door for constant seal. In or out alignment is determined by upper two adjusting studs and nuts at front guide. The adjustable up-stop will provide up or down alignment and partially fore and aft alignments by controlling window travel.

**NOTE:** Adjustments on regulator lift arm cam are provided to permit maximum travel but caution must be observed so not to interfere with quarter trim assembly at belt.

#### f. Removal and Installation "X-37" Style

1. With window in full-up position, remove rear guide upper and lower attaching bolts (Fig. 8-56). Disengage guide from roller on window assembly and remove guide through access hole.
2. Remove glass run channel inner and outer strip assemblies (draft strips) as outlined in the "Front Door" section of this manual - see index. Remove lock pillar sealing strip.
3. Remove front guide lower two adjusting stud nuts and loosen upper two nuts (see Fig. 8-56).
4. Rotate rear edge of glass upward until regulator lift arm roller is free of sash channel cam and front two glass rollers are out of front guide channels (see Fig. 8-56). Remove glass inboard of side rail.

**NOTE:** If additional clearance is needed, the side roof rail weatherstrip can be detached at quarter window area.

5. To install, reverse removal procedure. Figure 8-57 is an exploded view of the quarter window assembly and identifies the various components and their assembly sequence.

#### Adjustments—"X-37" Style

To perform any rear quarter window adjustments, it is necessary to remove the rear quarter trim assembly.

1. To adjust window "fore or aft", loosen front and rear guide adjusting stud nuts, position window and guides as required, and tighten nuts.
2. To adjust window "in or out" at belt line, loosen front guide upper adjusting stud nuts, adjust studs in or out as required, and tighten stud nuts.
3. To adjust top of window "in or out", loosen front guide lower adjusting stud nuts, adjust

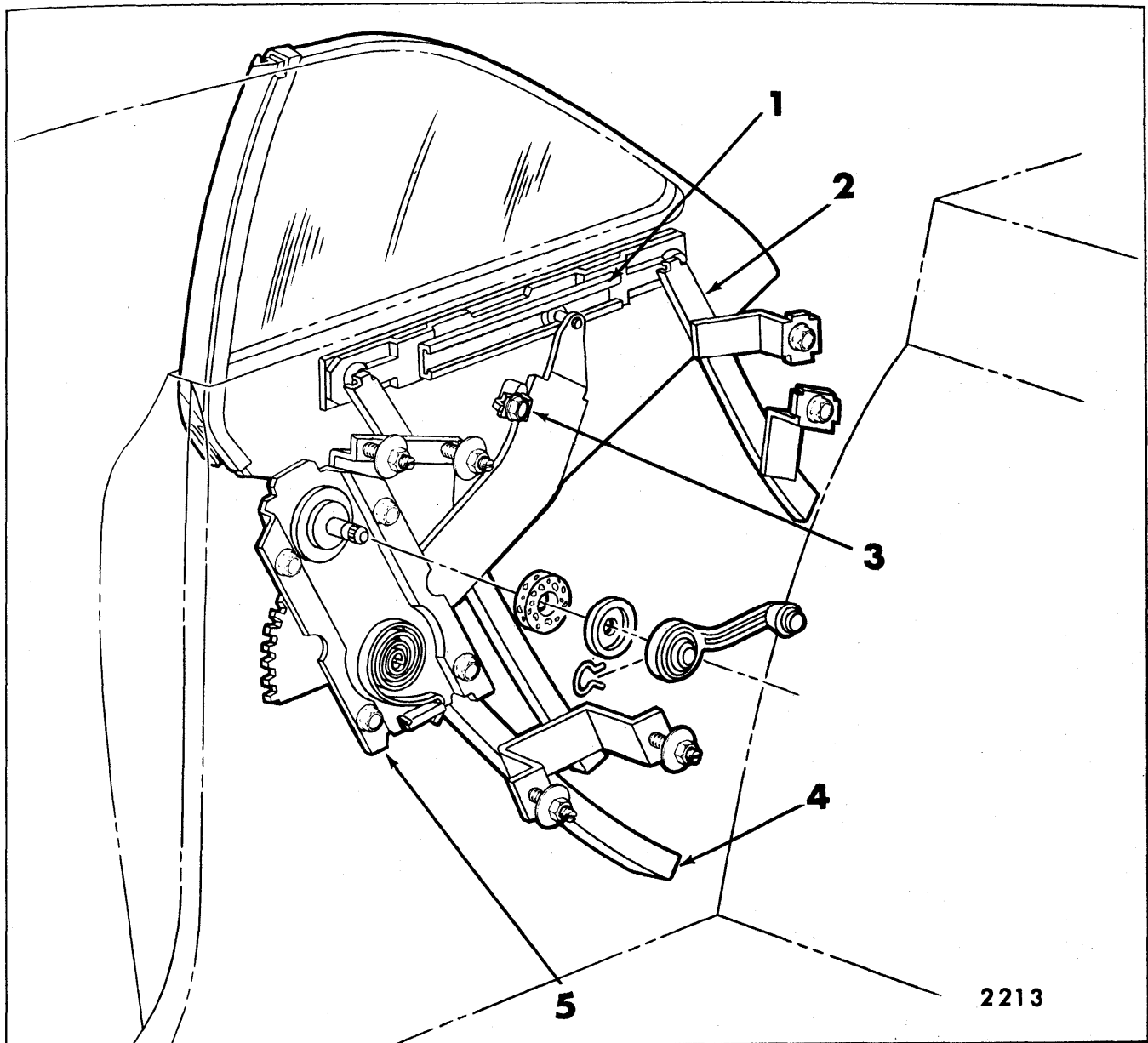

Fig. 8-36—Rear Quarter Hardware - "X-37" Styles

1. Sash Channel Cam  
2. Rear Guide

3. Upper Stop  
4. Front Guide

5. Window Regulator

studs in or out as required, and tighten stud nuts.

4. To relieve a "fore or aft" binding condition between front and rear guides, loosen front and rear guide adjusting stud nuts. Operate window to "full-up" position and tighten upper adjusting stud nuts. Operate window to "full-down" position and tighten remaining stud nuts.

**NOTE:** When adjusting studs on front guide, make certain that adjacent studs are adjusted

equally to prevent creation of a bind between cam channels.

5. To limit up-travel of window, adjust window stop as required (see Fig. 8-36).

#### g. Removal and Installation "Z-37" Styles

1. With window in full-up position, remove rear guide upper and lower attaching bolts (Fig. 8-58). Disengage guide from roller on window assembly and remove guide.

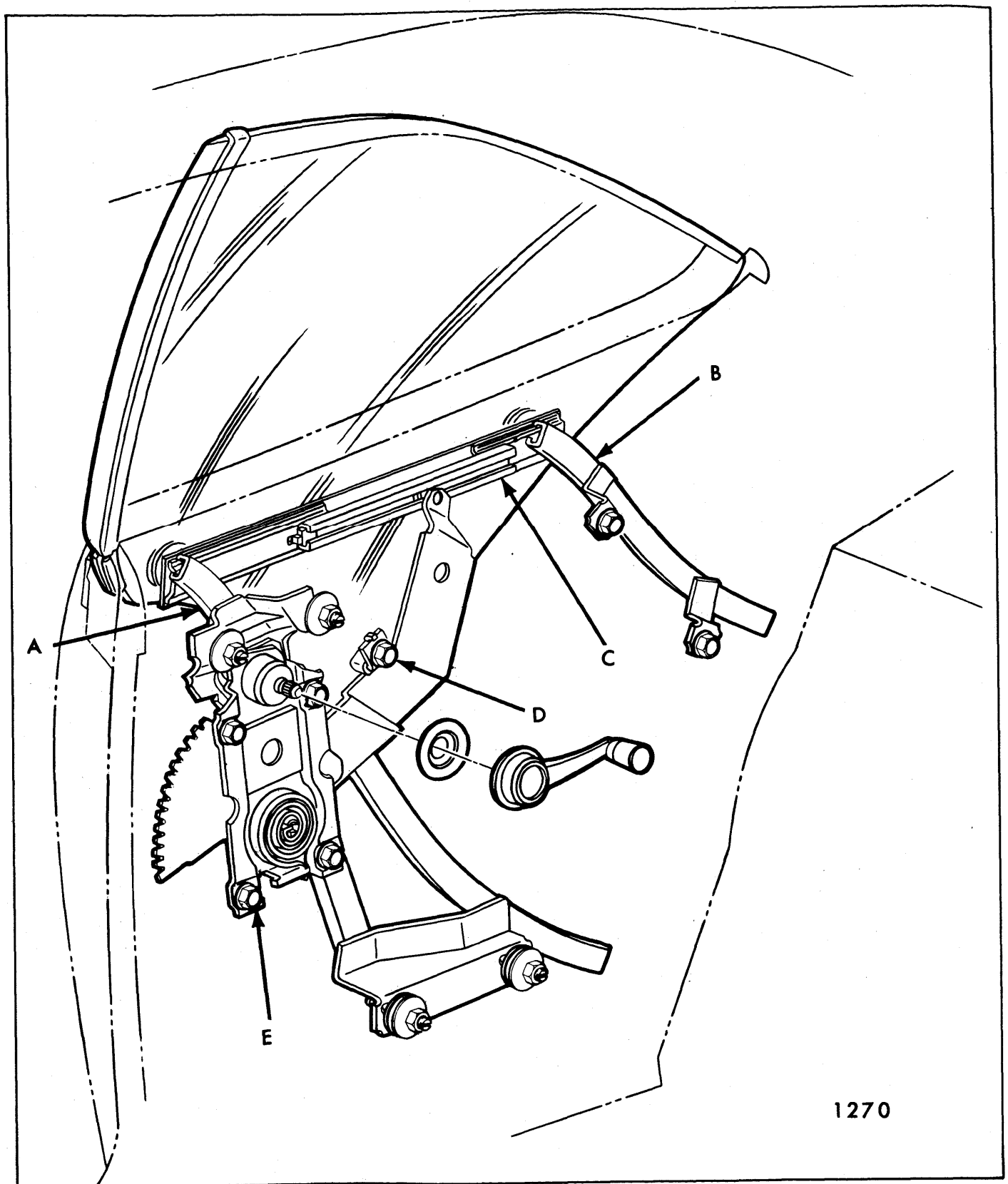

1270

Fig. 8-37—Rear Quarter Hardware - "37" Styles

A. Front Guide  
B. Rear Guide

C. Lower Sash Channel Cam  
D. Window Up-Stop

E. Window Regulator

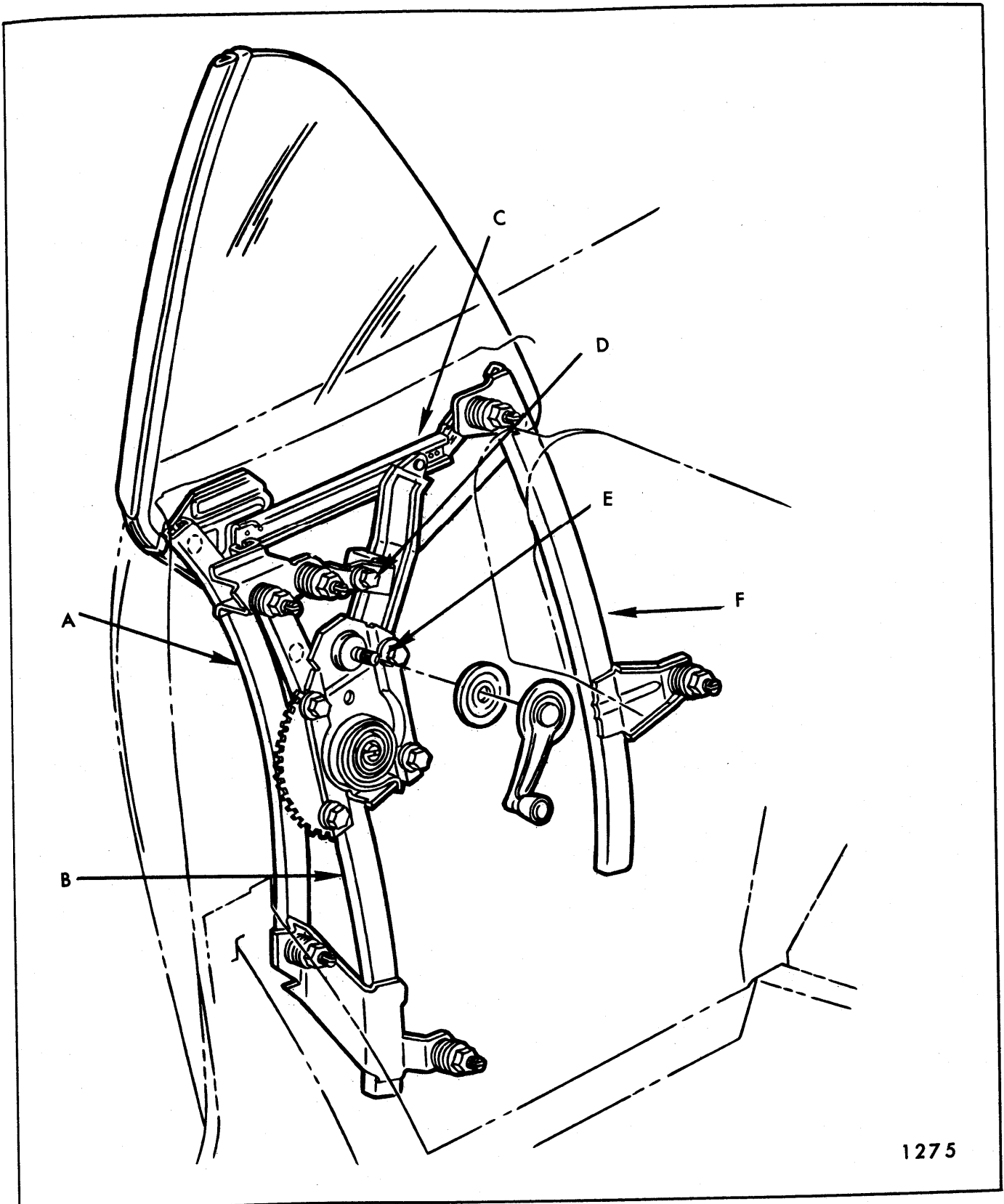

Fig. 8-38—Rear Quarter Hardware - "67" Style

A. Front Guide (Forward Channel)  
B. Front Guide (Rearward Channel)

C. Sash Channel Cam  
D. Window Up-Stop

E. Window Regulator  
F. Rear Guide

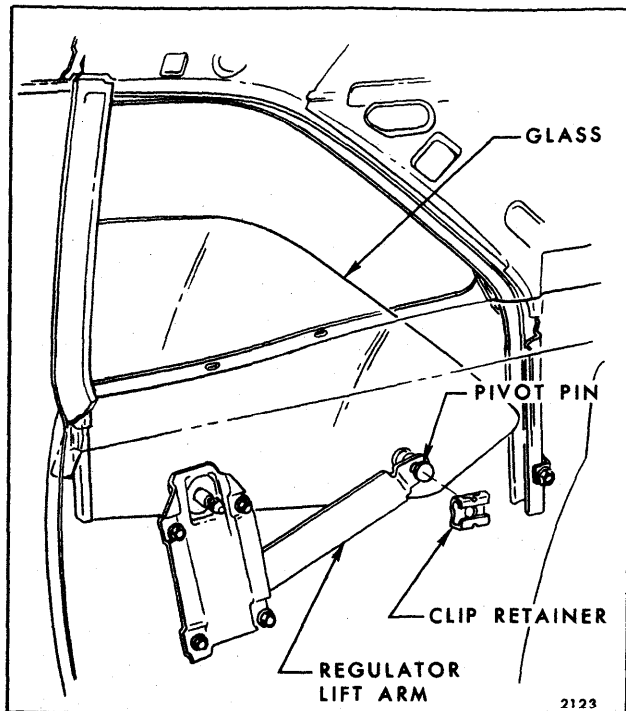

Fig. 8-39—Rear Quarter Window Attachment - "A-07" Styles

2. Remove regulator as described in a following procedure.

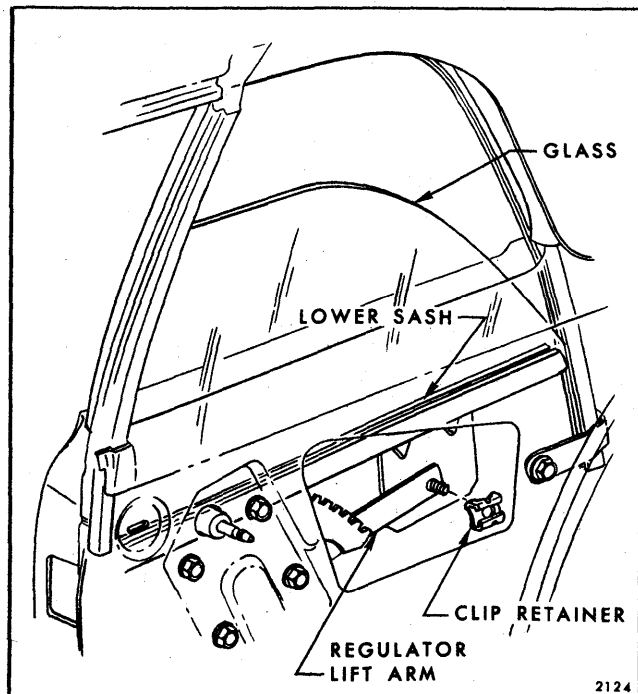

Fig. 8-40—Rear Quarter Window Attachment - "A-11" Styles

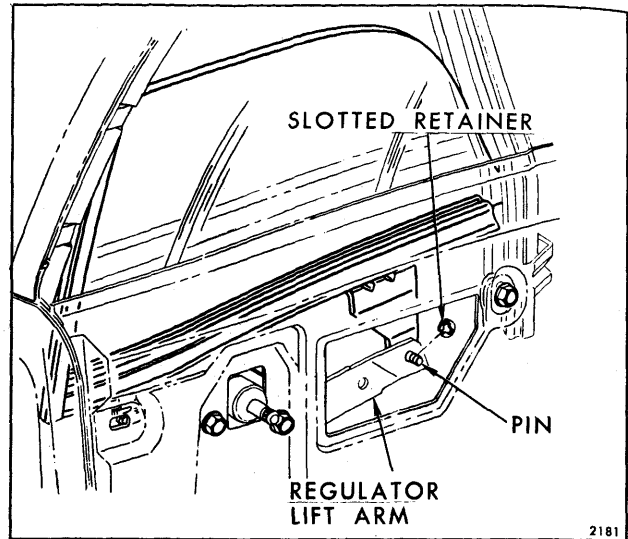

Fig. 8-41—Rear Quarter Window Attachment - "B-11" Styles

3. Slide rear quarter window upward and forward and pivot top rear corner of glass to a point outboard of side roof rail. Continue glass upward and forward to disengage front glass rollers from front guide assembly and remove rear quarter window from body.
4. To install, reverse removal procedure. Figure 8-59 is an exploded view of the quarter window assembly and identifies the various components and their assembly sequence.

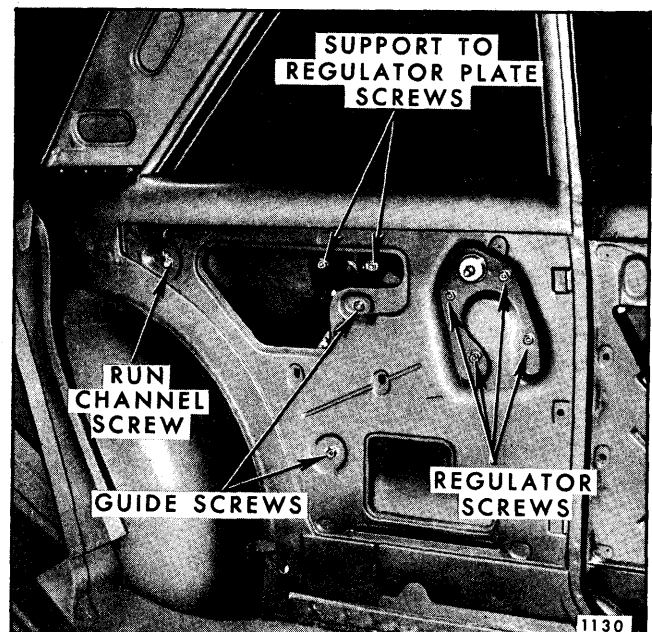

Fig. 8-42—Rear Quarter Hardware Attachment - "X-11" Style



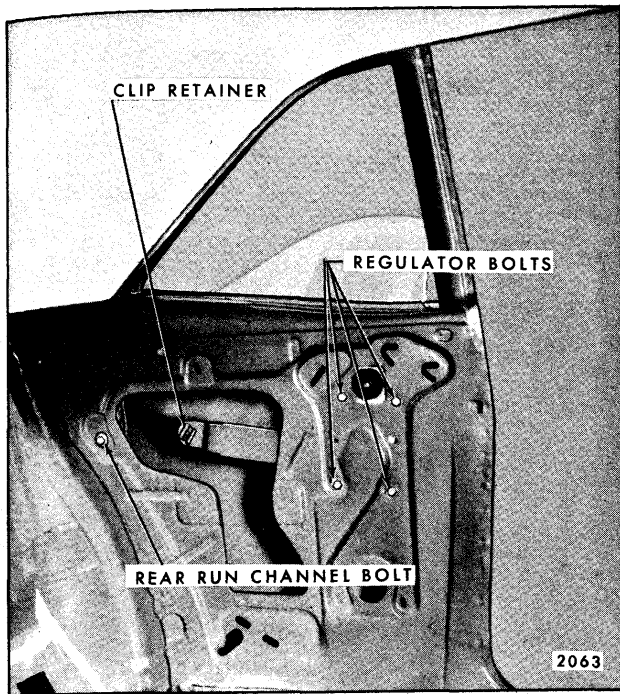

Fig. 8-43—Rear Quarter Hardware Attachment - "A-07"  
Styles Shown - "11" Styles Similar

#### Adjustments—"Z-37" Styles

1. The quarter window up-stop can be utilized for adjustments of glass to side roof rail weatherstrip (see Section "A-A" in Fig. 8-60).
2. The rear guide can be adjusted to gain proper fore and aft contact of rear quarter window vertical weatherstrip to rear edge of front door window (see section "C-C and F-F" in Fig. 8-60).
3. The upper two adjusting studs of the rear quarter window front guide are used for in or out and fore or aft adjustment of quarter window at front leading edge (see section "D-D" in Fig. 8-60).
4. The lower two adjusting studs of rear quarter window front guide are adjustable up or down and fore or aft for proper operation of quarter window (see section "E-E" in Fig. 8-60).

#### h. Removal and Installation "Z-67" Styles

1. Lower folding top.
2. Remove window regulator as described in a following procedure.
3. Raise glass straight up and remove from body.
4. To install, first engage lower forward roller

of glass into rear channel of front guide and then upper forward roller of glass into front channel of front guide and reverse removal procedure (see Fig. 8-38). Figure 8-61 is an exploded view of the quarter window assembly and identifies the various components and their assembly sequence.

#### Adjustments—"Z-67" Styles

1. The quarter window up-stop can be utilized for adjustments of glass to side roof rail weatherstrip (see section "A-A" in Fig. 8-62).
2. Both front and rear guides provide fore or aft and in or out adjustment at all attaching locations. The upper attaching locations directly affect position of quarter glass and lower attachments provide smooth operation of dropping rear quarter window (see Fig. 8-62).

### REAR QUARTER WINDOW REGULATOR ASSEMBLY (MANUAL)—"B-C 37-47-57 AND 67" STYLES

#### Removal and Installation

1. Remove rear quarter trim assembly. On "67" styles remove inner panel access hole cover. On "37-47 and 57" styles, remove inner panel water deflector.
2. Operate window to "full-up" and prop it in that position.
3. Remove regulator attaching bolts (Fig. 8-48). Disengage regulator lift arm roller from window lower sash channel cam and remove regulator through inner panel access hole.
4. To install, reverse removal procedure.

### REAR QUARTER WINDOW REGULATOR ASSEMBLY (ELECTRIC)—"B-C 37-47-57 AND 67" STYLES

#### Removal and Installation

1. Remove rear quarter trim assembly. On "67" styles remove inner panel access hole cover. On "37-47 and 57" styles, remove inner panel water deflector.
2. With window in almost fully lowered position, remove lower sash channel cam attaching screws and remove cam (Fig. 8-48). Manually raise window to full-up and prop in that position.

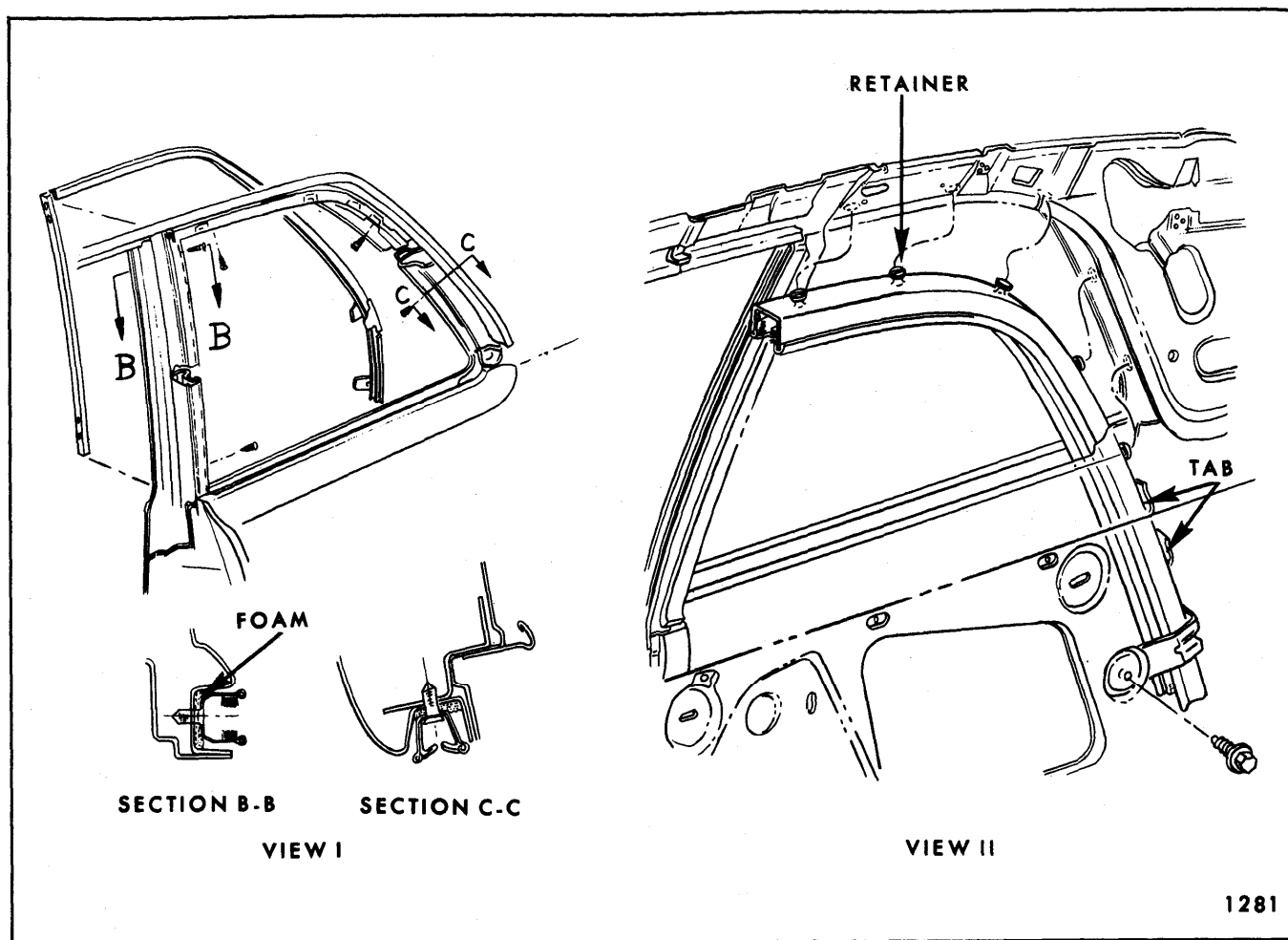

Fig. 8-44—Rear Quarter Window Glass Run Channels - Typical of All Closed Styles

3. On "67" styles, disconnect regulator motor wire harness at in-line connector located in-board of quarter inner panel. **DO NOT** attempt to disconnect permanent connector at regulator motor.
4. On the remaining styles, disconnect wire harness at motor. Remove window regulator attaching bolts (Fig. 8-48) and remove regulator through inner panel access hole.

**NOTE:** The procedure for removing electric motor from regulator is described and illustrated under "Door and Quarter Window Regulator Electric Motor Assembly" in the "Door" section of this manual.

5. To install, reverse removal procedure.

### REAR QUARTER WINDOW REGULATOR ASSEMBLY (MANUAL OR ELECTRIC)— "A-E-X & Z" HARDTOP AND CONVERTIBLE STYLES

#### Removal and Installation

1. Remove rear quarter trim assembly and inner panel access hole cover (or water deflector).
2. On "E" styles, remove rear quarter window. On "A & X" styles and "Z-37" styles, prop window in a full-up position. On "Z-67" styles, lower rear quarter window to the position illustrated in Figure 8-63.
3. On "Z-37" styles, remove rear quarter window rear guide assembly.
4. On "A & E" styles, equipped with electric

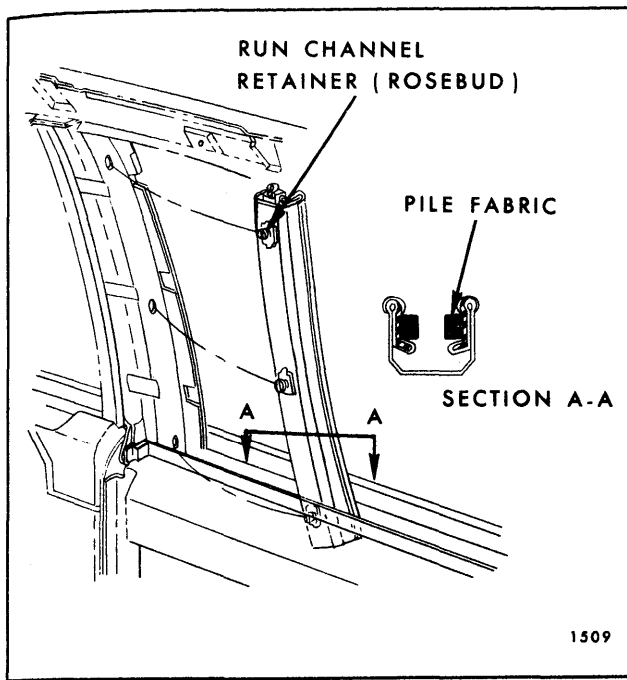

Fig. 8-45—Rear Quarter Window Front Glass Run Channels - Typical of "B" Styles

option, disconnect regulator motor wire harness at "in-line" connector and remove wire retaining clip attaching screw.

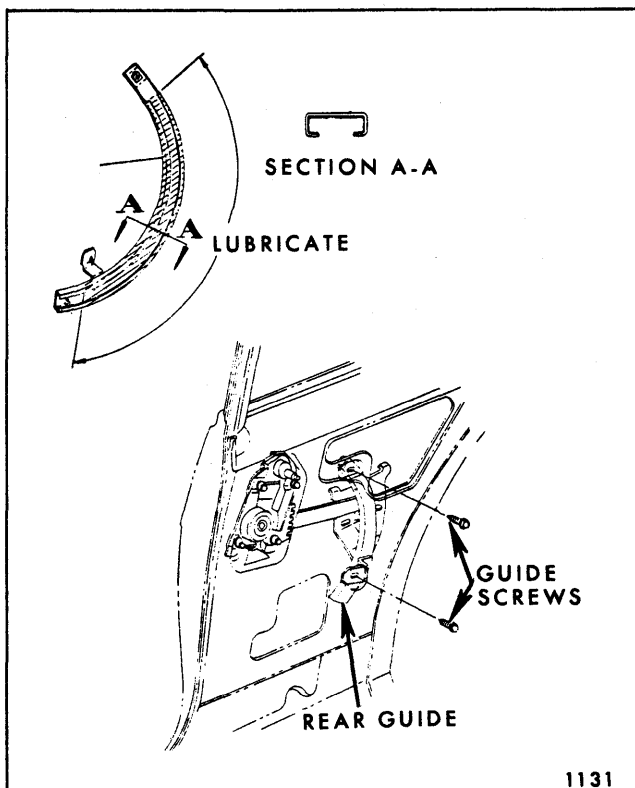

Fig. 8-46—Rear Quarter Window Guide - "X-11" Styles

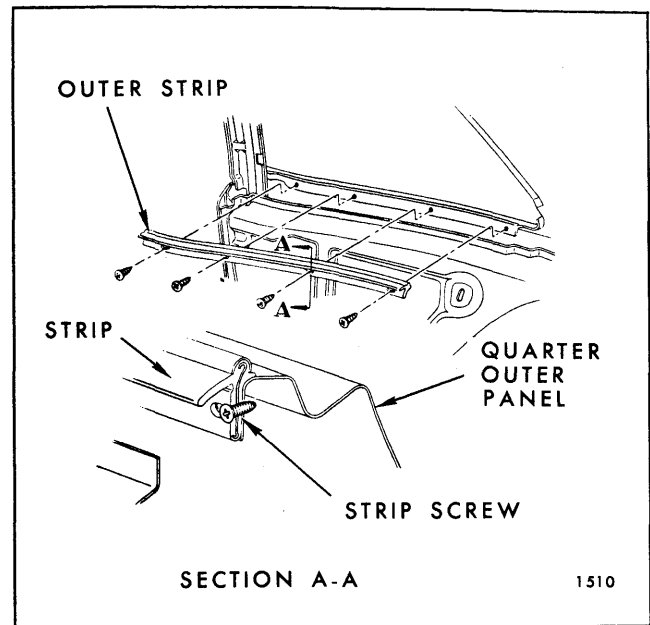

Fig. 8-47—Rear Quarter Window Outer Strip Assembly - All Closed Styles

5. Remove regulator attaching bolts (four on manual and five on electric, see Fig. 8-32). Slide unit rearward to disengage lift arm roller from sash cam and remove regulator.

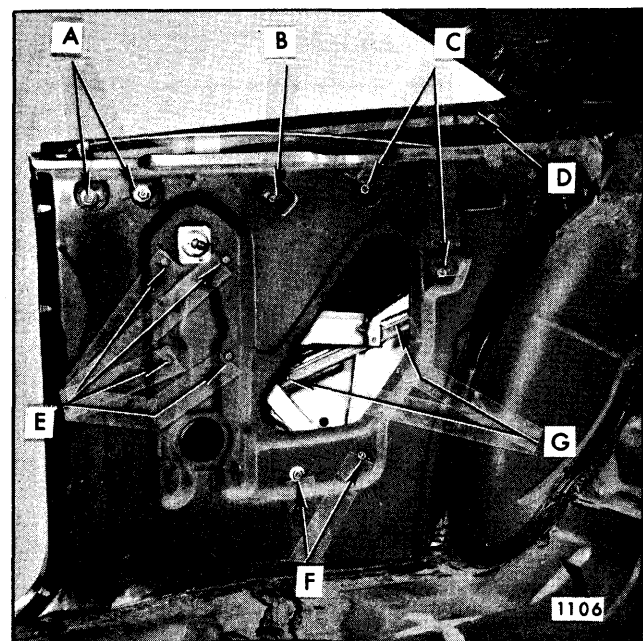

Fig. 8-48—Rear Quarter Hardware - "B and C" Hardtop Styles

- |   |   |
|---|---|
| A. Front Guide Upper Adjusting Studs and Nuts | E. Regulator Bolts                            |
| B. Up-Stop Bolt                               | F. Front Guide Lower Adjusting Studs and Nuts |
| C. Rear Guide Studs and Nuts                  | G. Sash Channel Cam Screws                    |
| D. Outer Strip Assembly                       |   |

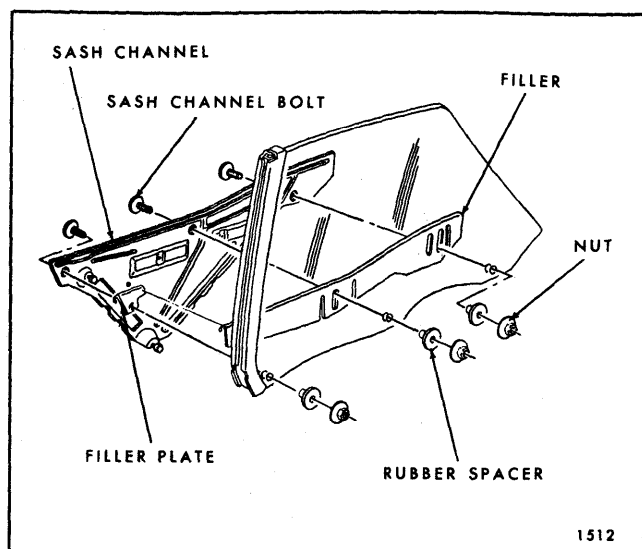

Fig. 8-49—Rear Quarter Window Assembly - "B&C" - "37-57 and 67" Styles

**NOTE:** If necessary, loosen upper attaching points of front guide to gain additional clearance.

6. To install, reverse removal procedure.

**NOTE:** The procedure for removing the electric motor from the regulator is described under "Door and/or Quarter Window Regulator Electric Motor Assembly".

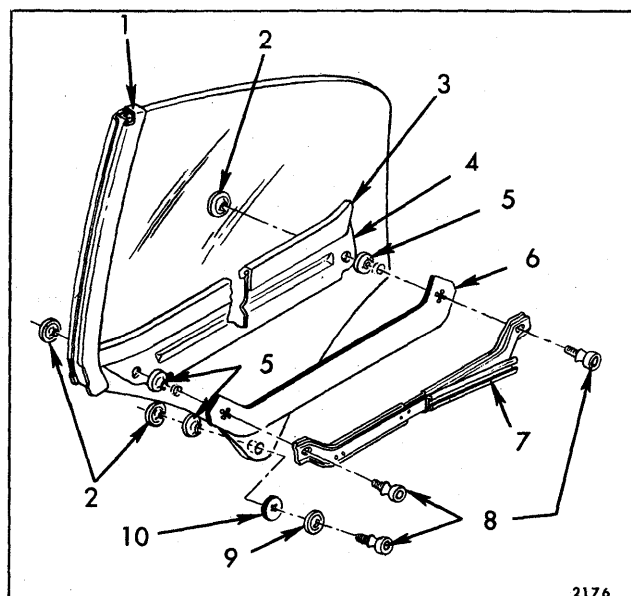

Fig. 8-50—Rear Quarter Window Assembly - Chevrolet "B-47" Style

- |                            |                            |
|----------------------------|----------------------------|
| 1. Front Sash Channel      | 6. Lower Sash Inner Filler |
| 2. Nut                     | 7. Lower Sash Cam Assembly |
| 3. Lower Sash Outer Filler | 8. Roller Assembly         |
| 4. Outer Filler Retainer   | 9. Washer (Steel)          |
| 5. Bushing                 | 10. Washer (Rubber)        |

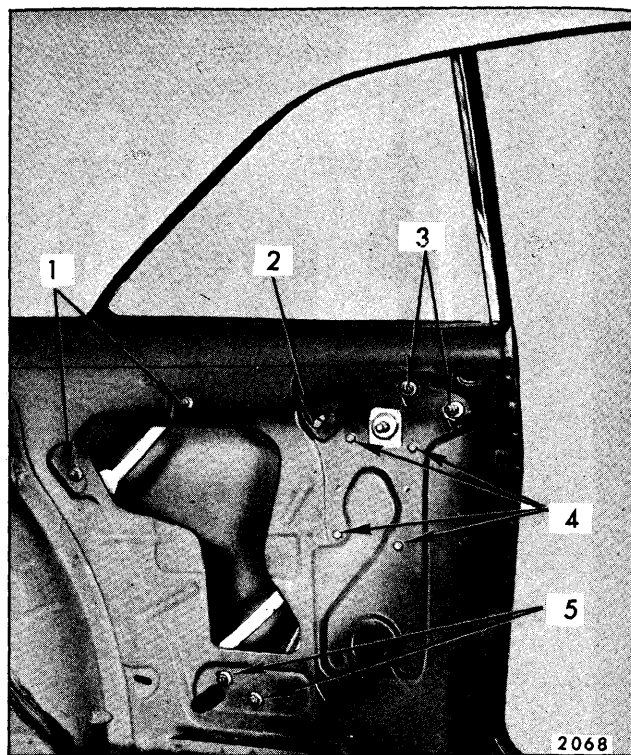

Fig. 8-51—Rear Quarter Hardware - "A-17" Style

- |   |   |
|---|---|
| 1. Rear Guide Adjusting Studs and Nuts      | 4. Regulator Bolts                          |
| 2. Up-Stop Bolt                             | 5. Front Guide Lower Adjusting Studs & Nuts |
| 3. Front Guide Upper Adjusting Studs & Nuts |   |

## REAR QUARTER WINDOW FRONT GUIDE "B-C 37-47-57 AND 67" STYLES

### Removal and Installation

1. Remove rear quarter window assembly as previously described.
2. Remove front guide upper and lower adjusting stud nuts (Fig. 8-48) and remove guide through access hole.
3. To install, reverse removal procedure.

## REAR QUARTER WINDOW REAR GUIDE— "B-C 37-47-57 AND 67" STYLES

### Removal and Installation

1. Remove rear quarter trim assembly. On "67" styles remove inner panel access hole cover. On "37-47 and 57" styles remove inner panel water deflector.
2. With window in full-up position, remove rear

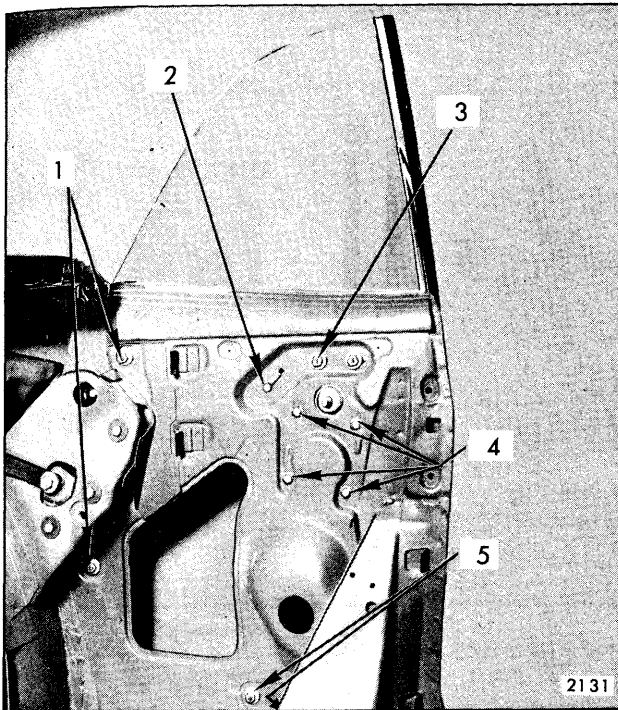

Fig. 8-52—Rear Quarter Hardware - "A-67" Style

- |   |   |
|---|---|
| 1. Rear Guide Adjusting Studs and Nuts      | 4. Regulator Bolts                          |
| 2. Up-Stop Bolt                             | 5. Front Guide Lower Adjusting Studs & Nuts |
| 3. Front Guide Upper Adjusting Studs & Nuts |   |

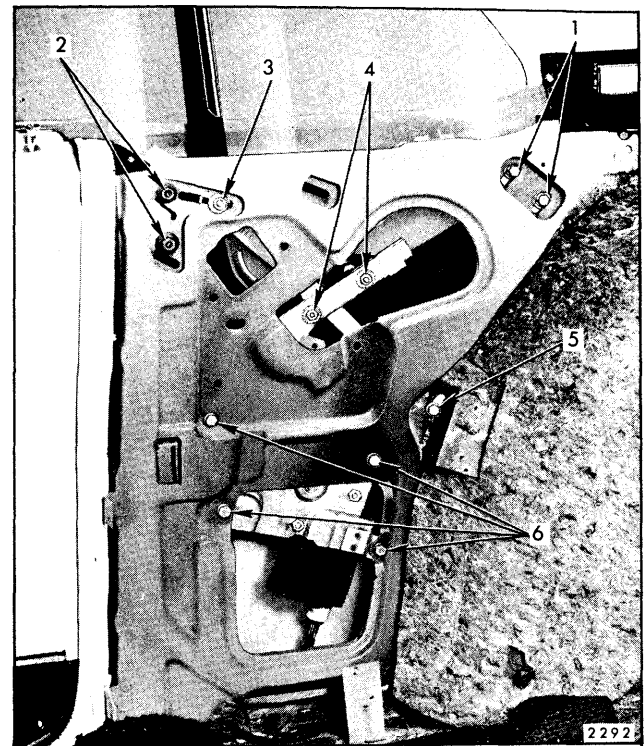

Fig. 8-54—Rear Quarter Hardware - "E" Body

- |   |  |
|---|--|
| 1. Rear Guide Attaching Bolts               | 4. Regulator Lift Arm Cam Attaching Nuts                 |
| 2. Front Guide Upper Adjusting Studs & Nuts | 5. Front Guide Lower Attaching Bolt                      |
| 3. Up-Stop Attaching Bolts                  | 6. Regulator Attaching Bolts (4 for Elect, 5 for Manual) |

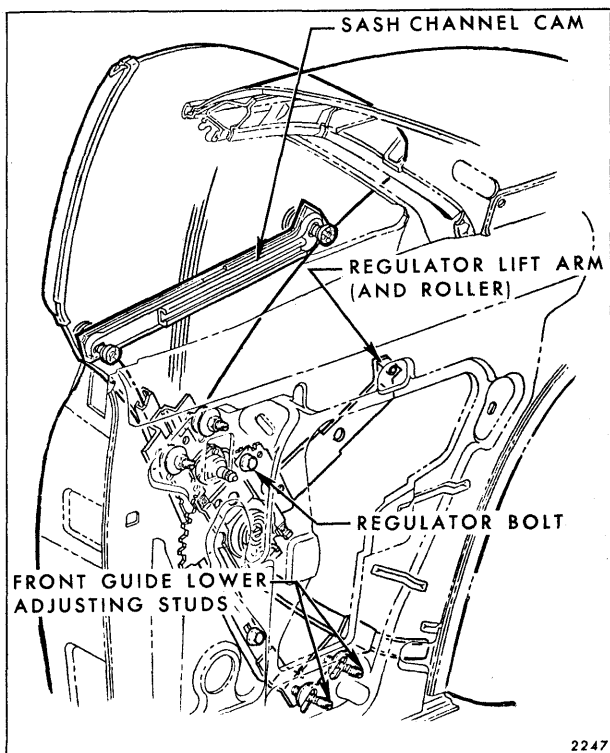

Fig. 8-53—Rear Quarter Window Removal  
"A-17 and 67" Styles

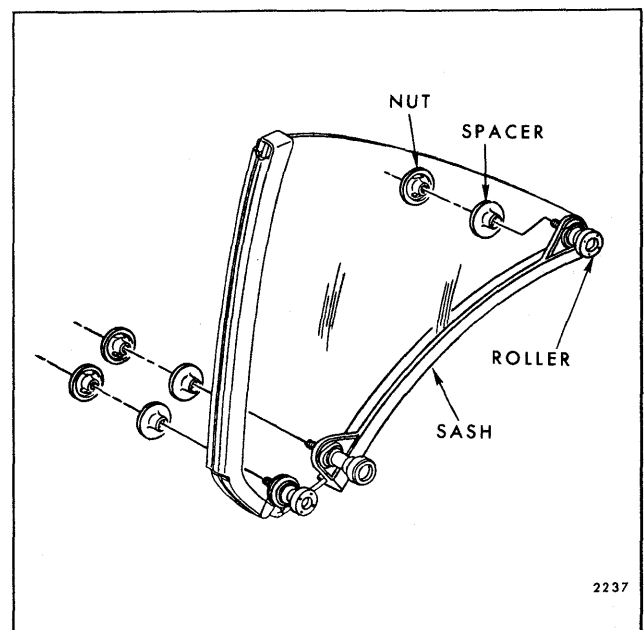

Fig. 8-55—Rear Quarter Window Assembly - "E" Body Styles

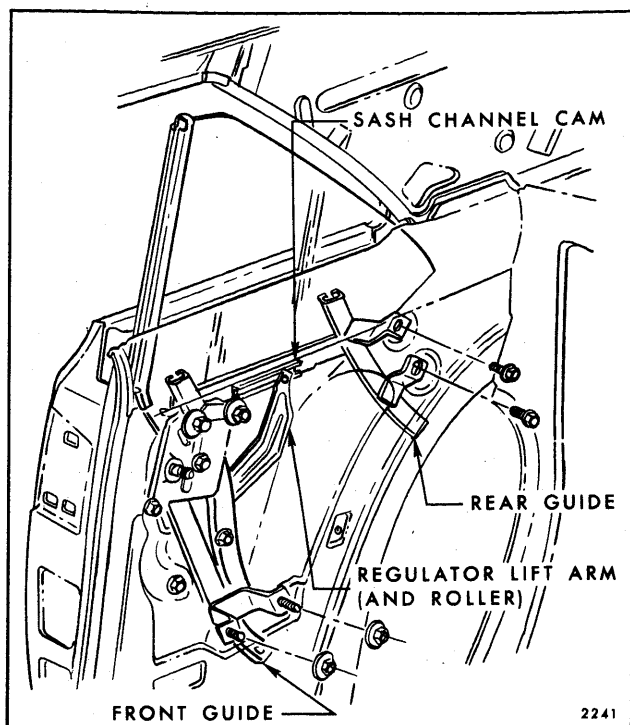

Fig. 8-56—Rear Quarter Hardware - "X"-37 Style

guide upper and lower adjusting stud nuts (Fig. 8-48). Disengage guide from roller on window lower sash channel and remove guide through access hole.

3. To install, reverse removal procedure.

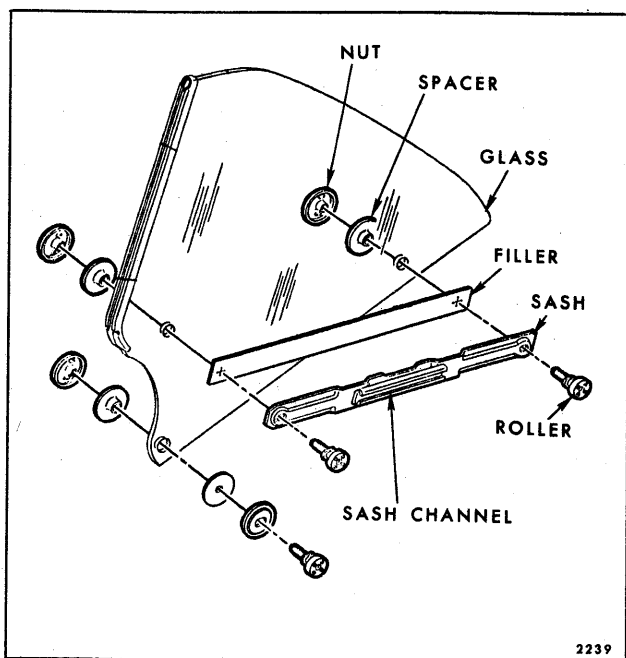

Fig. 8-57—Rear Quarter Window Assembly - "X"-37 Style

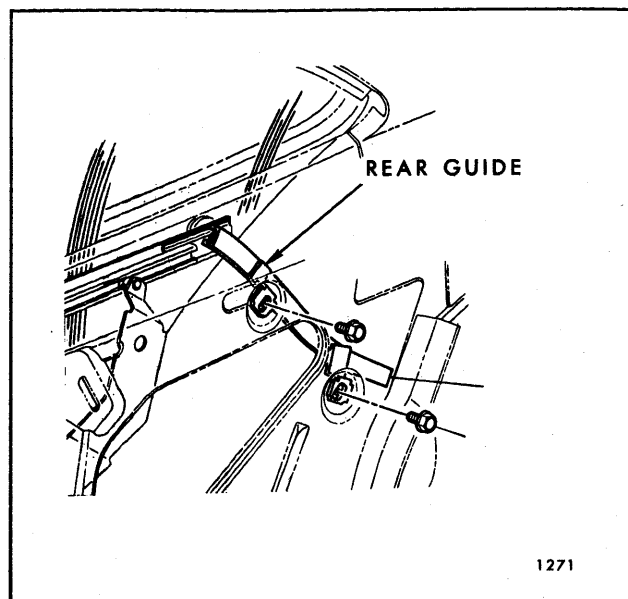

Fig. 8-58—Rear Quarter Window Rear Guide Assembly - "Z-37" Styles

## REAR QUARTER WINDOW FRONT GUIDE ASSEMBLY—"A-E-X & Z" HARDTOP AND CONVERTIBLE STYLES

### Removal and Installation

1. Remove rear quarter window assembly.
2. On "A, X & Z" styles, remove front guide upper and lower adjusting stud nuts (refer to Figs. 8-52 and 8-51). These illustrations are for "A" bodies but are indicative of all styles).

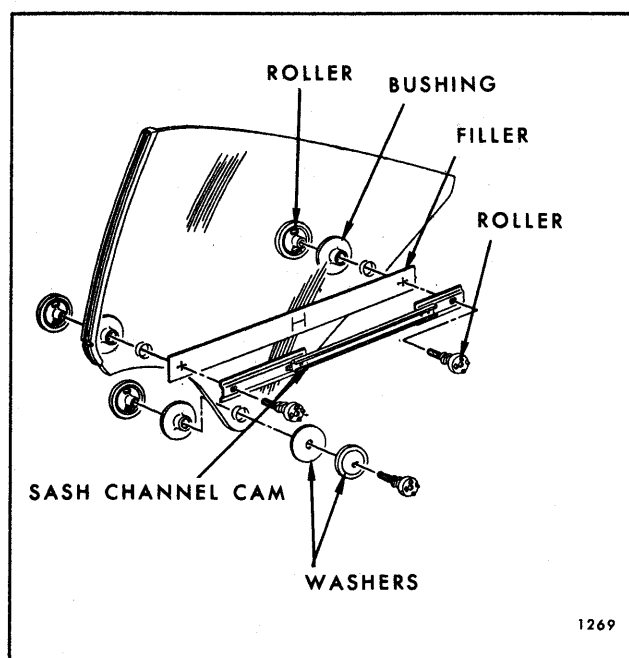

Fig. 8-59—Rear Quarter Window Assembly - "Z-37" Styles

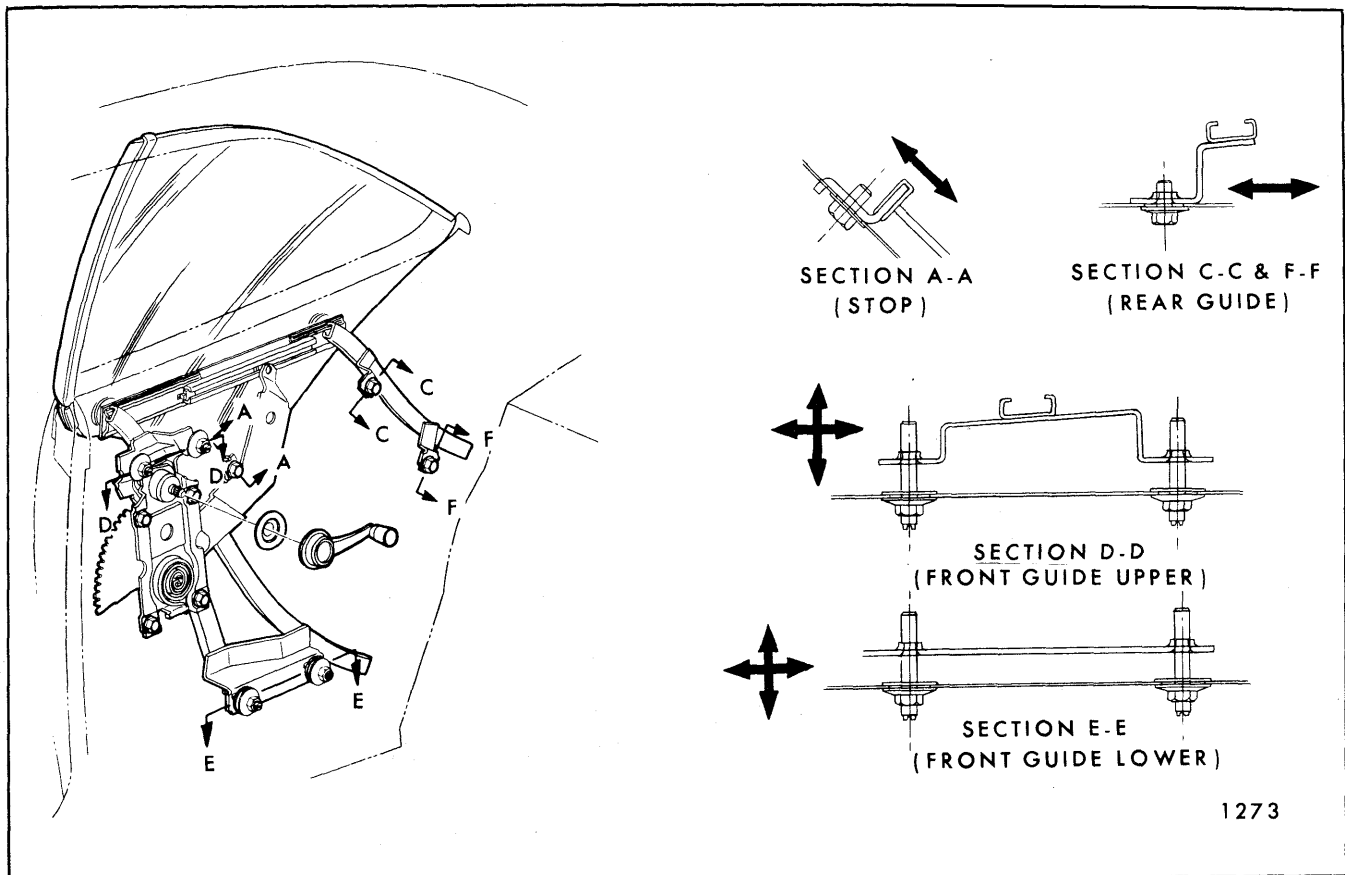

Fig. 8-60—Rear Quarter Window Adjustments - "Z-37" Styles (Arrows Indicate Adjustment Direction Available)

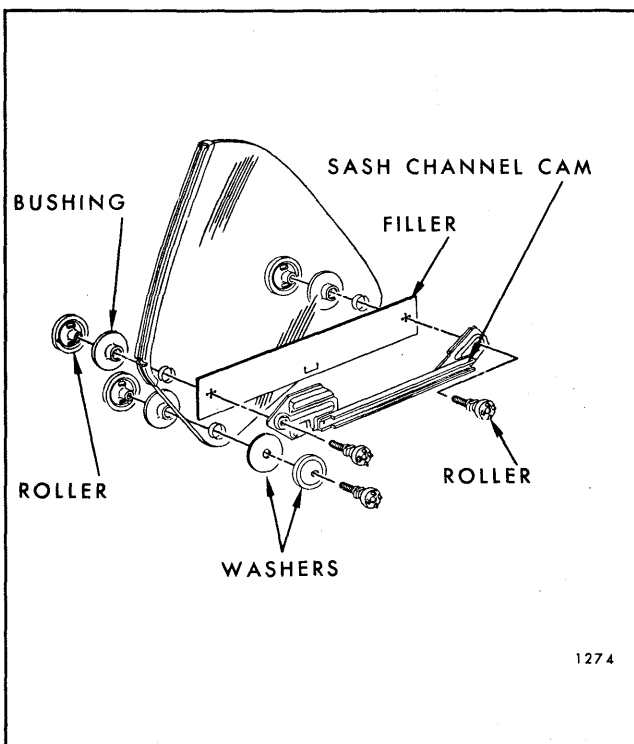

Fig. 8-61—Rear Quarter Window Assembly - "Z-67" Styles

**NOTE:** As explained under "Rear Quarter Window Assembly" - Removal and Installation for "E" bodies, the front guide attachments must be removed and guide lowered prior to removal of window assembly.

3. Disengage guide adjusting studs from slots in quarter inner panel and remove guide through access hole on all except "E" styles. On "E" bodies, remove front guide between rear quarter inner and outer panels at belt.
4. To install, reverse removal procedure. Adjust guide for proper window operation as specified under "Rear Quarter Window Adjustments".

**NOTE:** The rear channel of the front guide of "A-17 & 67" styles is equipped with an adjustable lower stop to control height of quarter window in the lowered position (see Fig. 8-32).

## REAR QUARTER WINDOW GLASS RUN CHANNEL—CHEVROLET "B-47" STYLE

### Removal and Installation

1. Remove rear quarter upper extension trim panel.

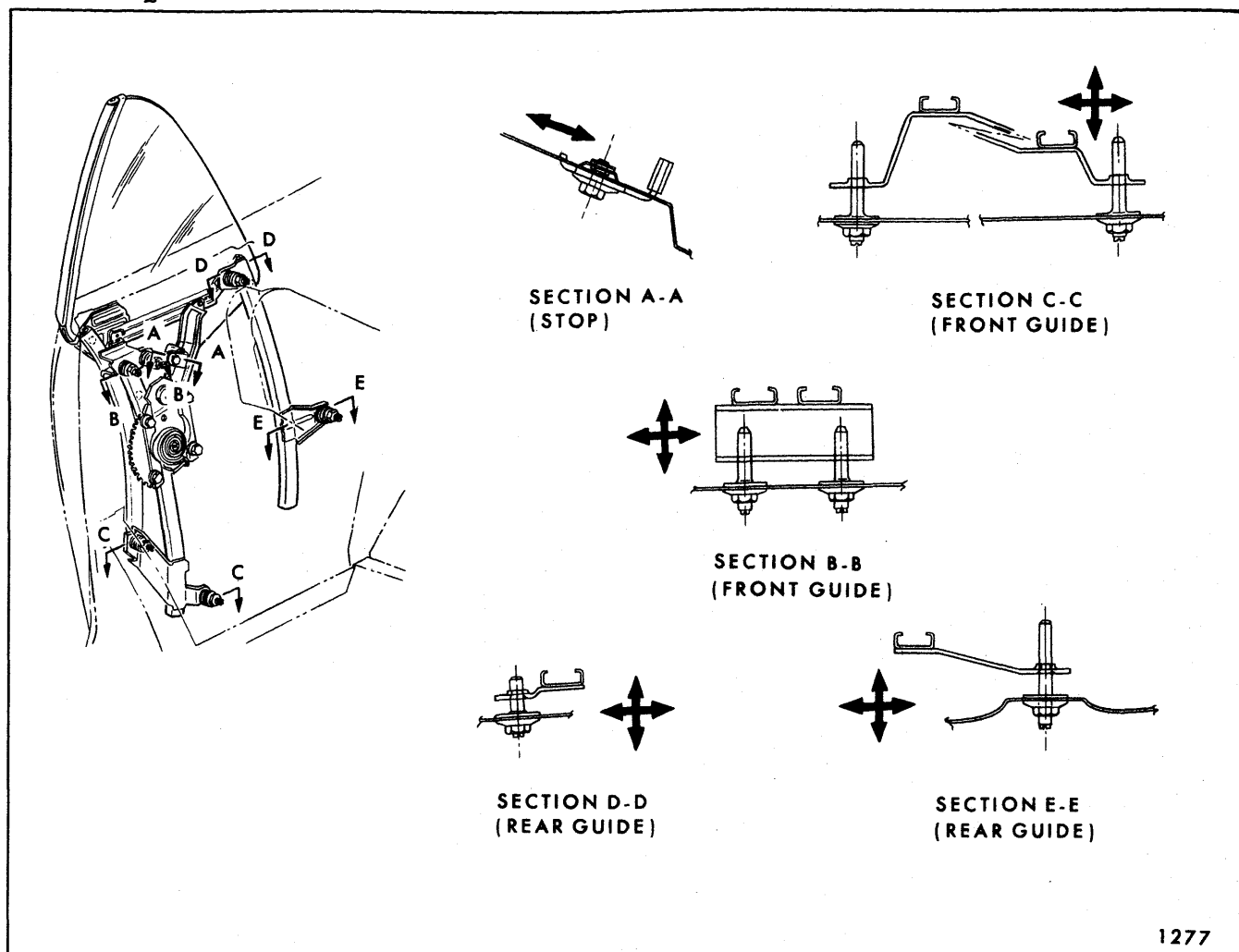

Fig. 8-62—Rear Quarter Window Adjustments - "Z-67" Styles (Arrows Indicate Adjustment Direction Available)

2. With window in full-down position, remove screw securing run channel to rear quarter extension panel (Fig. 8-64).
3. Remove screw inserted through forward end of run channel into side roof rail (Fig. 8-64) and remove run channel from body.
4. To install, reverse removal procedure. Prior to installation apply a bead of body caulking compound to surface of run channel that mates with side roof rail to effect a weathertight seal when installed.
2. Remove screw securing side roof rail weatherstrip, weatherstrip retainer and rear quarter window run channel to side roof rail (see View "B" in Fig. 8-65).
3. Remove screw securing lower end of run channel to rear quarter inner panel (see View "B" in Fig. 8-65).
4. On Buick styles, remove screw securing outer wall of run channel to side rail (see Section "A-A" in Fig. 8-65).
5. Remove rear quarter window upper glass run channel.
6. To install, reverse removal procedure. If original sealing strip (see section "E-E" in Fig. 8-65) is damaged, seal run channel to side rail with pumpable caulking compound.

## REAR QUARTER WINDOW UPPER GLASS RUN CHANNEL ASSEMBLY—"E" STYLES

### Removal and Installation

1. Remove rear seat cushions and back (see seat trim index).



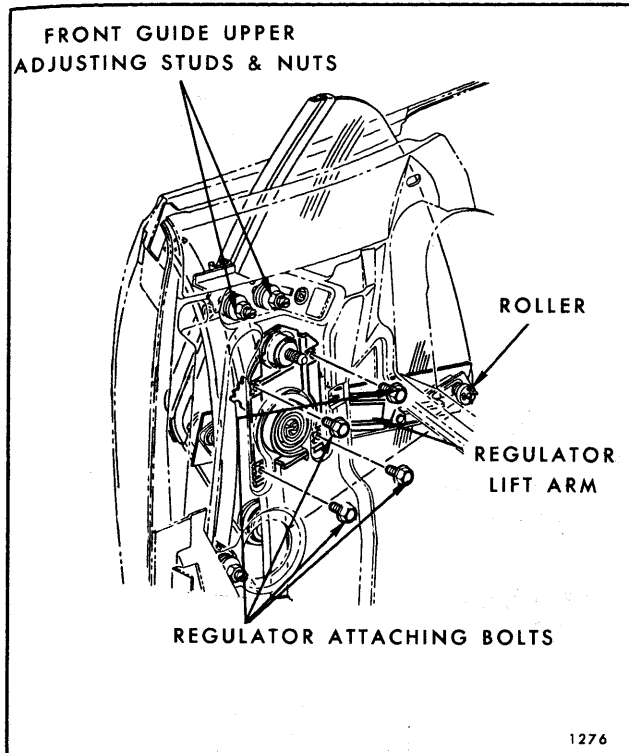

Fig. 8-63—Rear Quarter Window Regulator Attachment - "Z-67" Styles

## REAR QUARTER WINDOW OUTER STRIP ASSEMBLY—PONTIAC, OLDSMOBILE, AND BUICK "B-37 AND 67" STYLES

### Removal and Installation

1. Remove rear quarter trim assembly. On "67" styles remove inner panel access hole cover. On "37" styles remove inner panel water deflector.

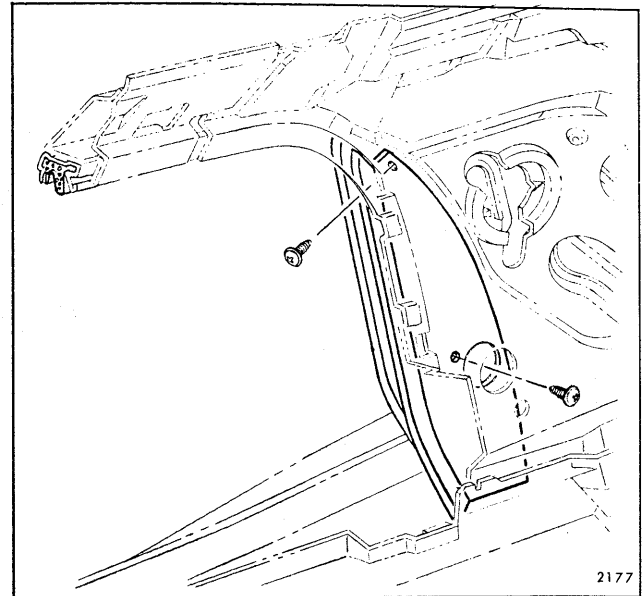

Fig. 8-64—Rear Quarter Window Glass Run Channel - "B-47" Style

2. Working through access hole, loosen down-stop attaching screw (Fig. 8-66). Slide stop to bottom of guide channel and retighten stop bolt.
3. Operate window to full-down position and remove screws securing outer strip assembly to outer panel return flange.
4. To install, reverse removal procedure. Reposition window down-stop for proper alignment of top edge of glass with body belt line when window is fully lowered.

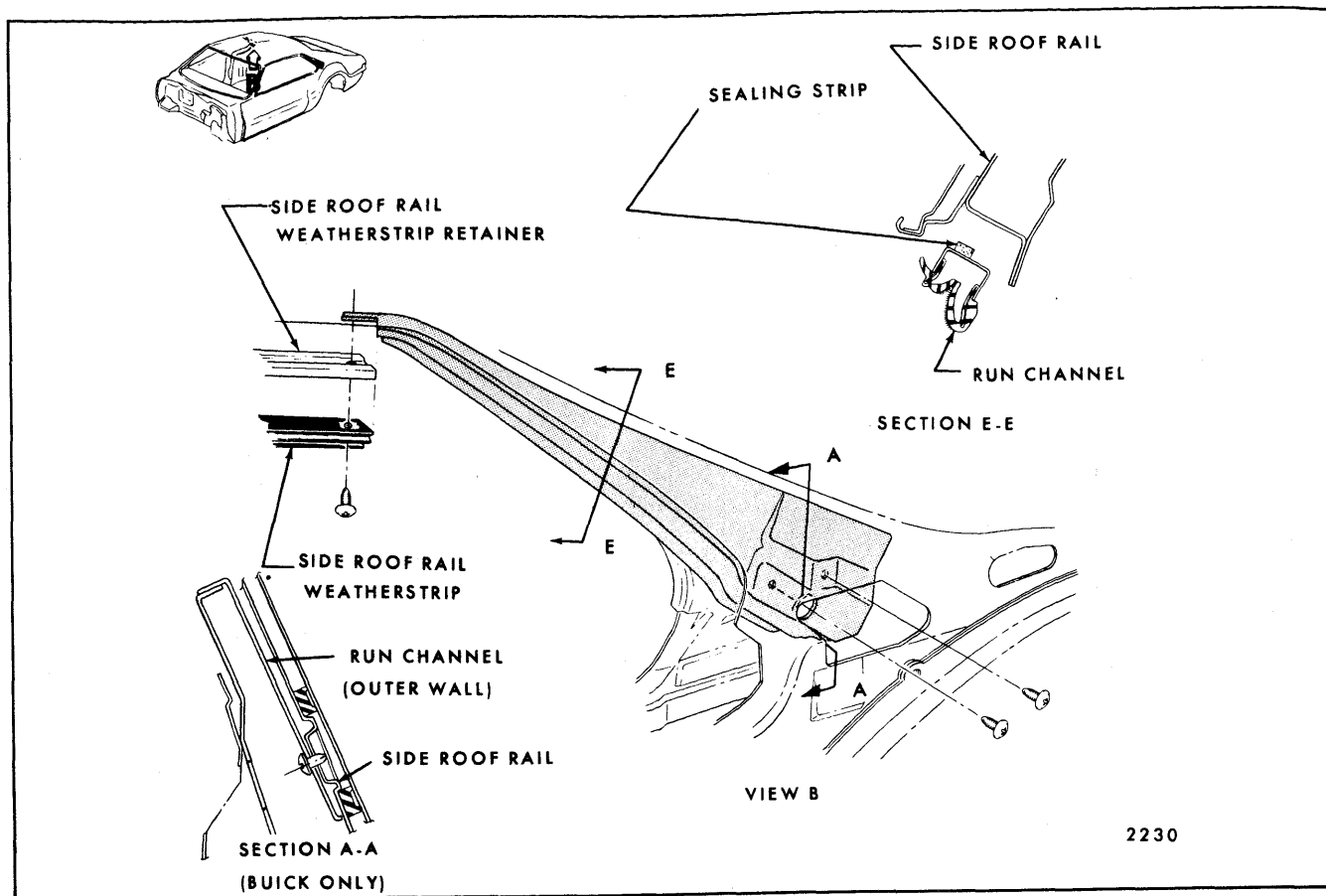

Fig. 8-65—Rear Quarter Window Upper Glass Run Channel - "E" Body Styles

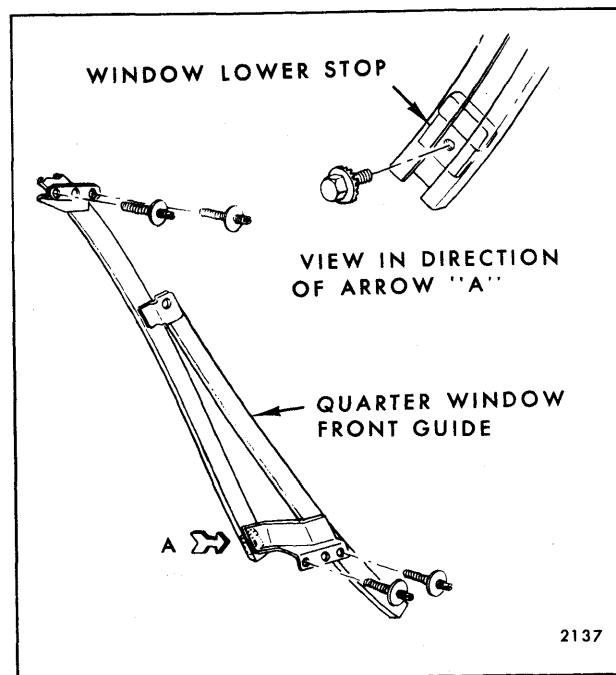

Fig. 8-66—Rear Quarter Window Lower Stop Adjustment - Styles so Equipped