

# **ASSEMBLY MANUAL**

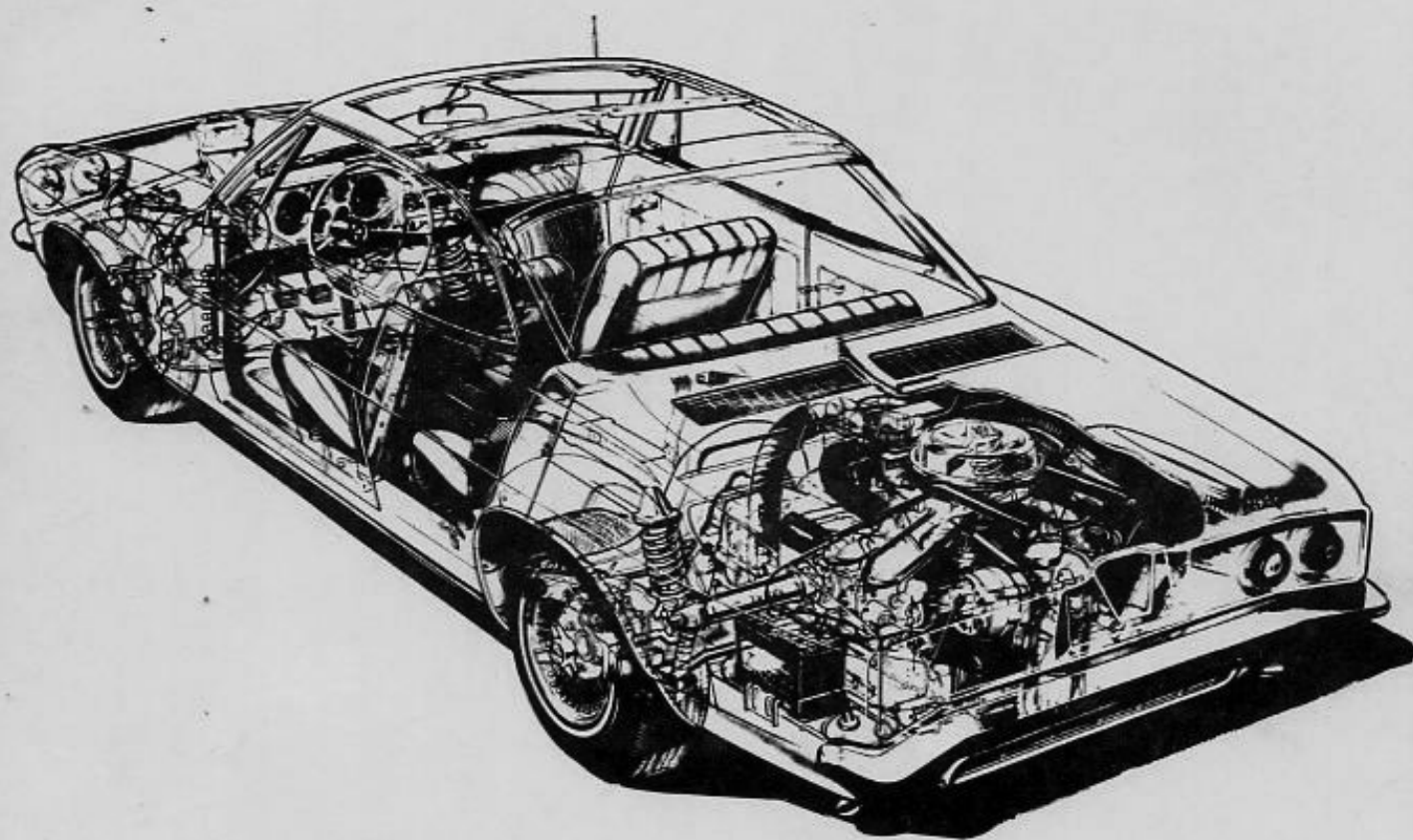

**1965  
CORVAIR**

**C7315**



CHEVROLET

## ASSEMBLY INSTRUCTIONS

3862100

CORVAIR 10000 SERIES

- ① 1 3867225 DUCT & DAMPER ASM.-L.H. (10100-500)  
3867231 (10700)  
3867226 R.H.
- ② 2 9417558 SCREW
- ③ 3 3867251-2 SHROUD-LWR-L. & R.H.

## SUGGESTED ASSEMBLY SEQUENCE

1. Fixture exhaust duct asm. & lower shroud in the thermostat setting fixture to hold locating dimensions shown.
2. Attach exhaust duct asm. to lower shroud.
3. Remove assembly from fixture.

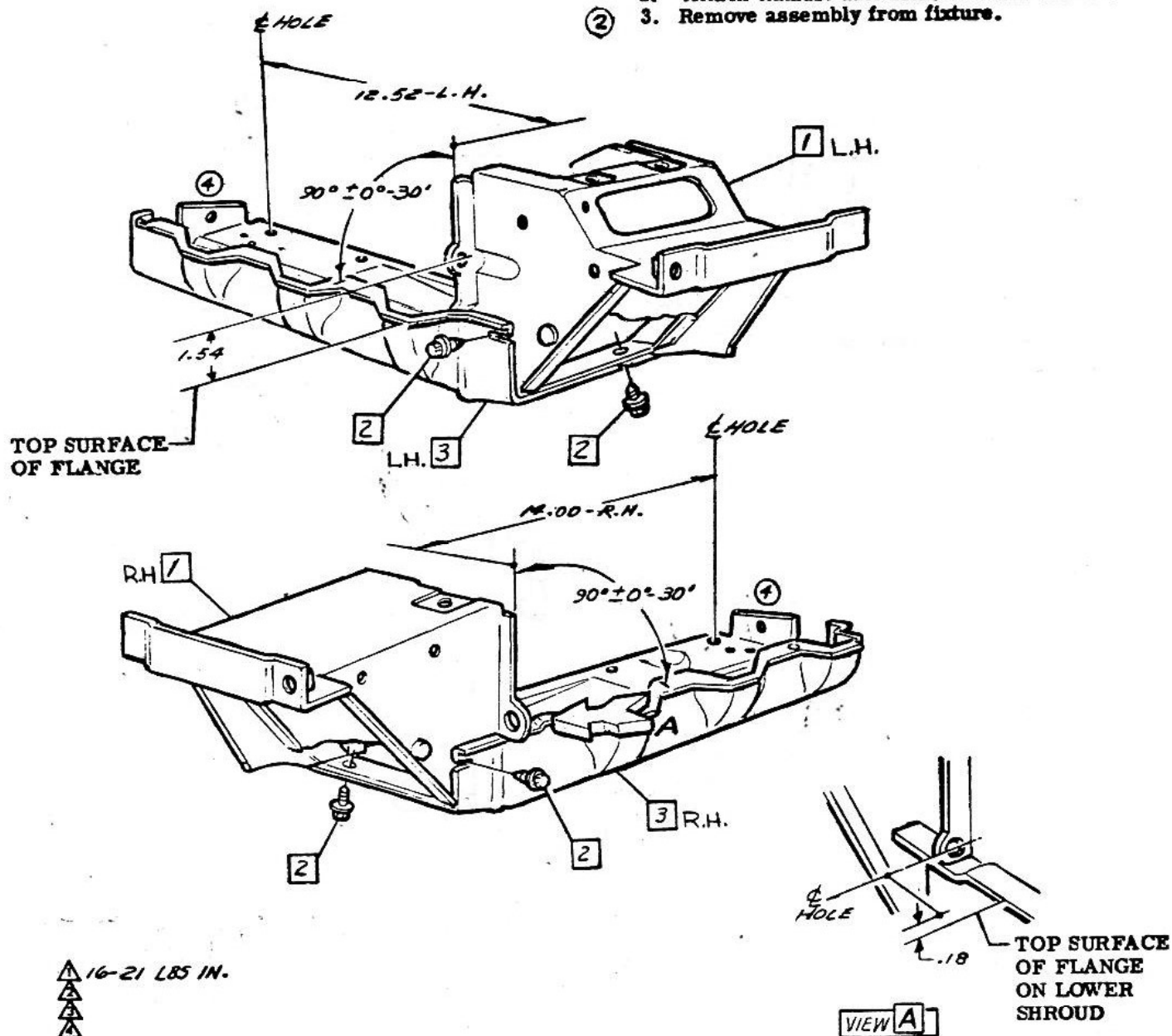

CHEVROLET MOTOR DIVISION, GMC

UPC

DATE SYN

REVISION RECORD

AUTH. DR. CK.

EXHAUST DUCT ASM. &amp; LOWER SHROUD

6

8-13-64	1	3867225, 3867231, & 3867226	63607 JB	
		WAS 3851957, 3851971, & 3851958	63687	
	2	SEQUENCE NOTE REVISED		DF
9-3-64	3	WAS 3856791-2 SHROUD	65521 JB	
	4	DWG REVISED 2 PLACES		DF

10000

B3.

DWG PEEL 3-10 JB REF: Prel. B9 L-73743 L-  
DATE REL 5-15 L- L- L-

SHEET

1965-60

- |     |         |                            |     |         |                  |
|-----|---------|----------------------------|-----|---------|------------------|
| ⚠ 1 | 103025  | NUT                        | ⚠ 6 | 3856795 | SWIVEL           |
| 2   | 3856793 | BRACKET                    | 7   | 441310  | RIVET            |
| 3   | 3156784 | THERMOSTAT ASM (10100-500) | 8   | 3830431 | SHIELD-HEAT-L.H. |
|     | 3156432 | (10700)                    |     | 3856798 | R.H.             |
| 4   | 3856794 | ROD-ACTUATING              |     |         |                  |
| 5   | 3711177 | CLIP                       |     |         |                  |

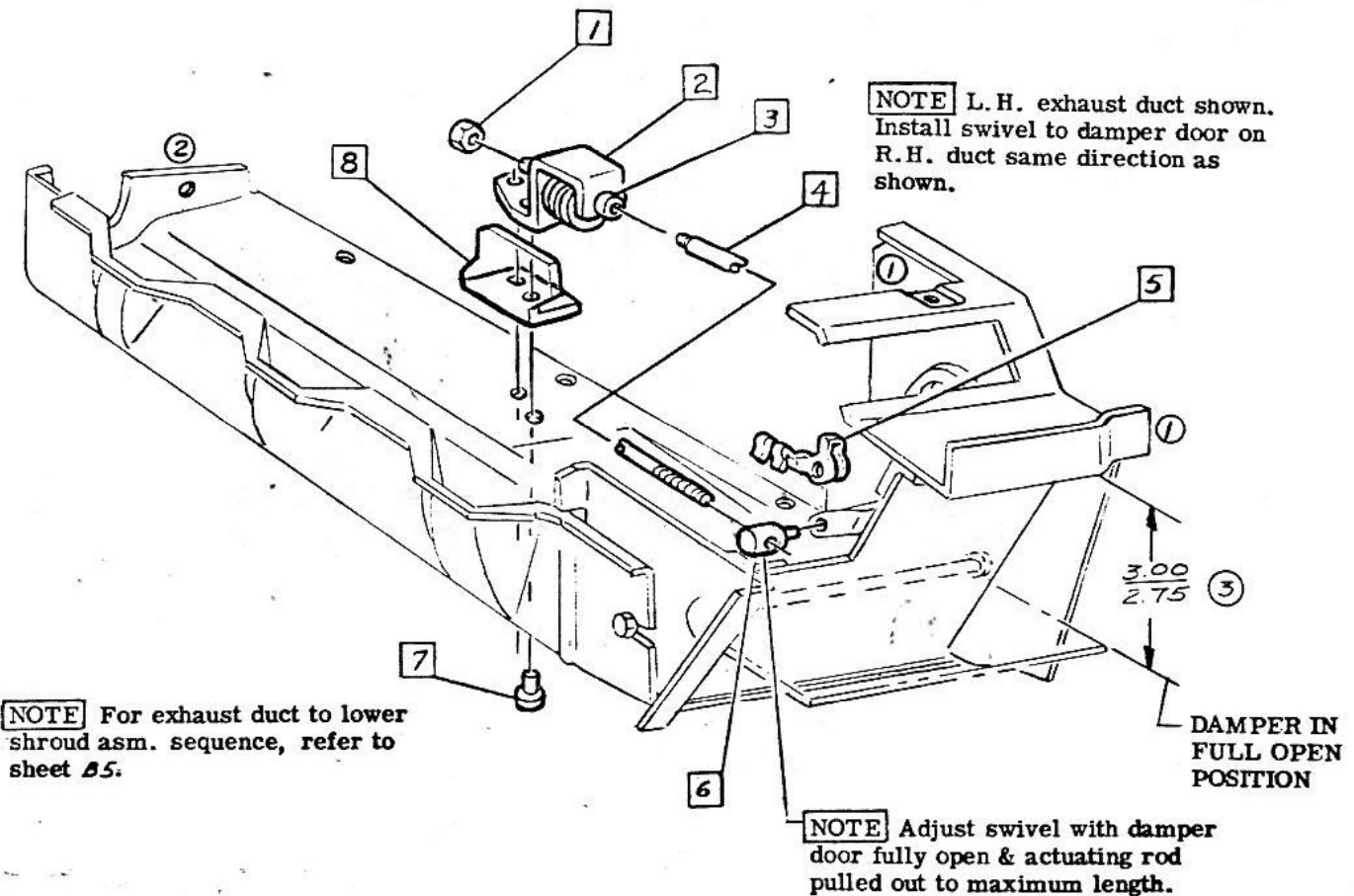

- ⚠ 70-110 LBS IN.  
⚠ 13-17 LBS IN.  
⚠

CHEVROLET MOTOR DIVISION, GMC				UPC	DATE	SYM	REVISION RECORD	AUTH	DR	CK
EXHAUST DUCT HEAT THERMOSTAT				6	3-12-64	1	DWG REVISED 2 PLACES	63867	JB	DF
					3-3-64	2	DWG REVISED	65521	JB	DF
10000				B4.	3-31-65	3	WAS 3.16	70035	CA	CI
DWG PREL 3-10 JB REF: Prel. B5 L-72375 L-										
DATE REL 5-18 L- L- L-										
SHEET										



CHEVROLET

## ASSEMBLY INSTRUCTIONS

3862100

CORVAIR 10000 SERIES

- 1 3822936 SEAL  
2 3788090 SEAL  
② 3 9419385 SCREW ASM

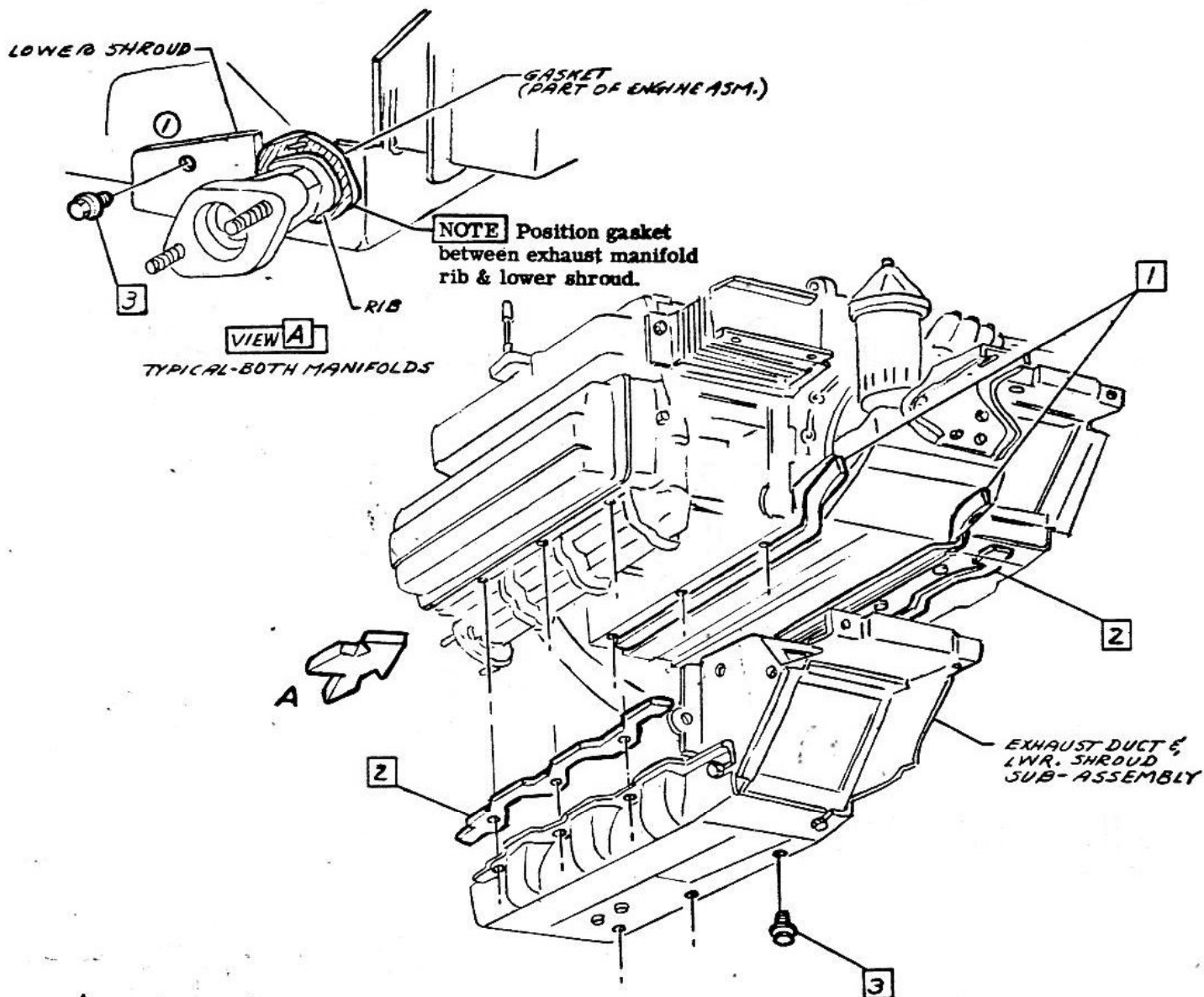

70-95 LBS IN.  
▲  
▲  
▲

• CHEVROLET MOTOR DIVISION, GMC •				UPC	DATE	SYM	REVISION RECORD	AUTH.	DR.	CK.
SHROUD-LOWER & EXHAUST DUCT ASM. TO ENG.				6	3-3-64	1	DWG REVISED	65521	JB	
						2	WAS 9417881 SCREW	65836		DF
10000				B5.						
DWG PREL 3-10 J.B. REF: Prel. B6 L-53956 L-73793										
DATE REL 3-10 L- L- L-				SHEET						

1965-62