

1960-1969

CORVAIR

PARTS CATALOG

REVISION NO. 1
Reprinted in its Entirety
Effective March, 1970

PARTS ORDERS TO BE PLACED BY CHEVROLET DEALERS WITH GENERAL MOTORS PARTS DIVISION

WAREHOUSES CONVENIENTLY LOCATED AT THE FOLLOWING POINTS:

- | | | | |
|-------------------|---------------------|-----------------------|----------------------|
| *Atlanta, Georgia | *Denver, Colo. | New York, N.Y. | Omaha, Nebr. |
| *Baltimore, Md. | *Detroit, Mich. | Louisville, Ky. | Philadelphia, Pa. |
| Birmingham, Ala. | El Paso, Texas | ▲ Martinsburg, W. Va. | Pittsburgh, Pa. |
| *Boston, Mass. | Fargo, N.D. | Memphis, Tenn. | *Portland, Oregon |
| Buffalo, N.Y. | #▲ Flint, Mich. | Milwaukee, Wis. | Richmond, Virginia |
| Charlotte, N.C. | Great Falls, Mont. | *Minneapolis, Minn. | ▲ St. Louis, Mo. |
| *Chicago, Ill. | Houston, Texas | *Newark, N.J. | Salt Lake City, Utah |
| *Cincinnati, Ohio | Indianapolis, Ind. | New Orleans, La. | San Antonio, Texas |
| Cleveland, Ohio | *Jacksonville, Fla. | *Oakland, Cal. | Los Angeles, Calif. |
| *Dallas, Texas | Kansas City, Mo. | Oklahoma City, Okla. | |
- *Master Warehouses ▲ Major Supply Depots. # Factory Warehouse.

All illustrations and specifications contained in this literature are based on the latest production information available at the time of publication approval. Chevrolet Motor Division reserves the right to make changes at any time without notice in colors, materials, equipment, specifications and models, and also to discontinue models.

CHEVROLET MOTOR DIVISION
GENERAL MOTORS CORPORATION
DETROIT, MICH. 48202

0.000 ENGINE— CLUTCH
1.000 COOLANT—GRILLE— OIL SYSTEM
2.000 CHASSIS— ELECTRICAL SYSTEM
3.000 FUEL—EXHAUST— CARBURETION
4.000 TRANSMISSION— BRAKES
5.000 BRAKES—REAR AXLE AND DRIVE
6.000 FRONT AXLE— STEERING
7.000 FRAME—SPRINGS— BUMPER
8.000 SHEET METAL HEATER
9.000 BODY MTG.—AIR COND.—INSTR.
10.000 WINDSHIELD DOORS—CONTROLS
11.000 REAR GLASS SEAT AND ADJUSTER
12.000 METAL TRIM—CLIPS AND PANELS
13.000 BODY WIRING FLDG. TOP TRIM
14.000 FLDG. TOP PARTS INTERIOR TRIM
15.000 REAR TRIM—MATS YARDAGE
16.000 TRUCK INTERIOR AND PANELS
17.000 SGL. AND DBL. UNIT BODY PARTS

GROUP 16.000

INTERIOR AND

PANELS



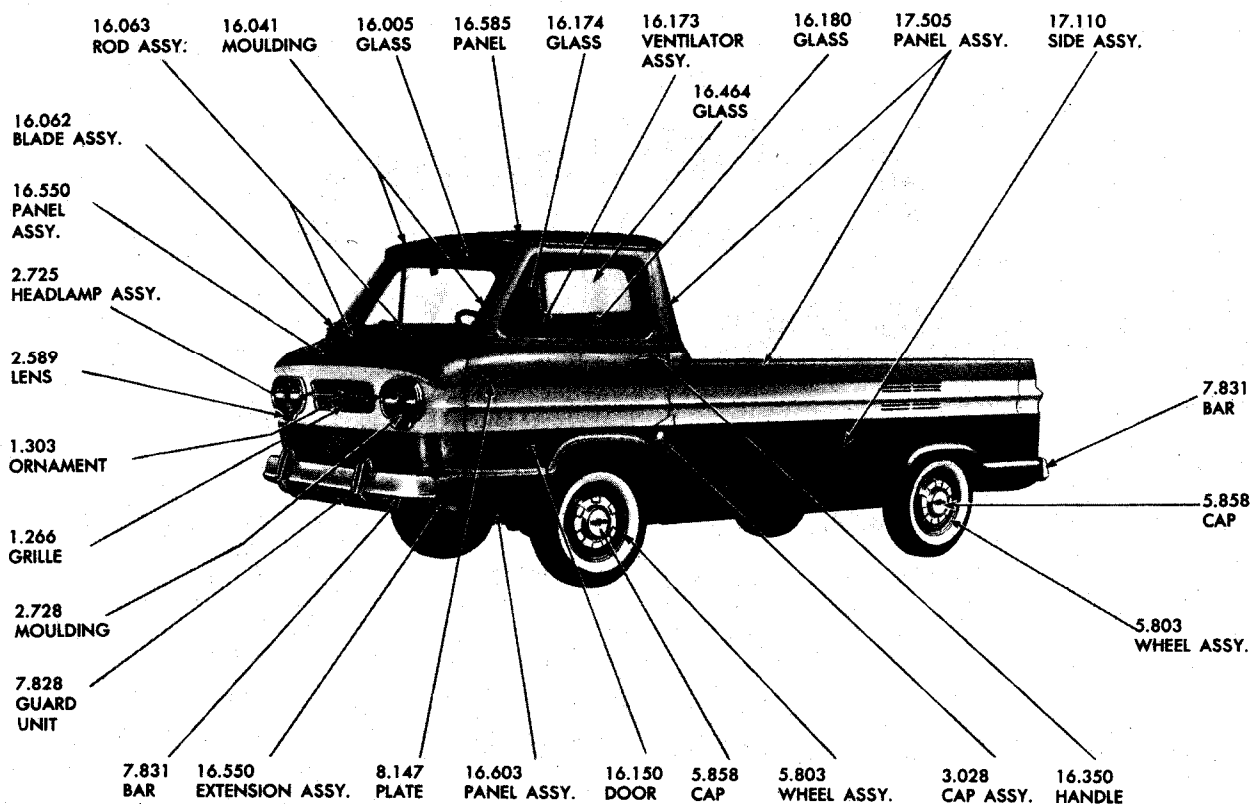

1961-64 CORVAIR PICK-UP

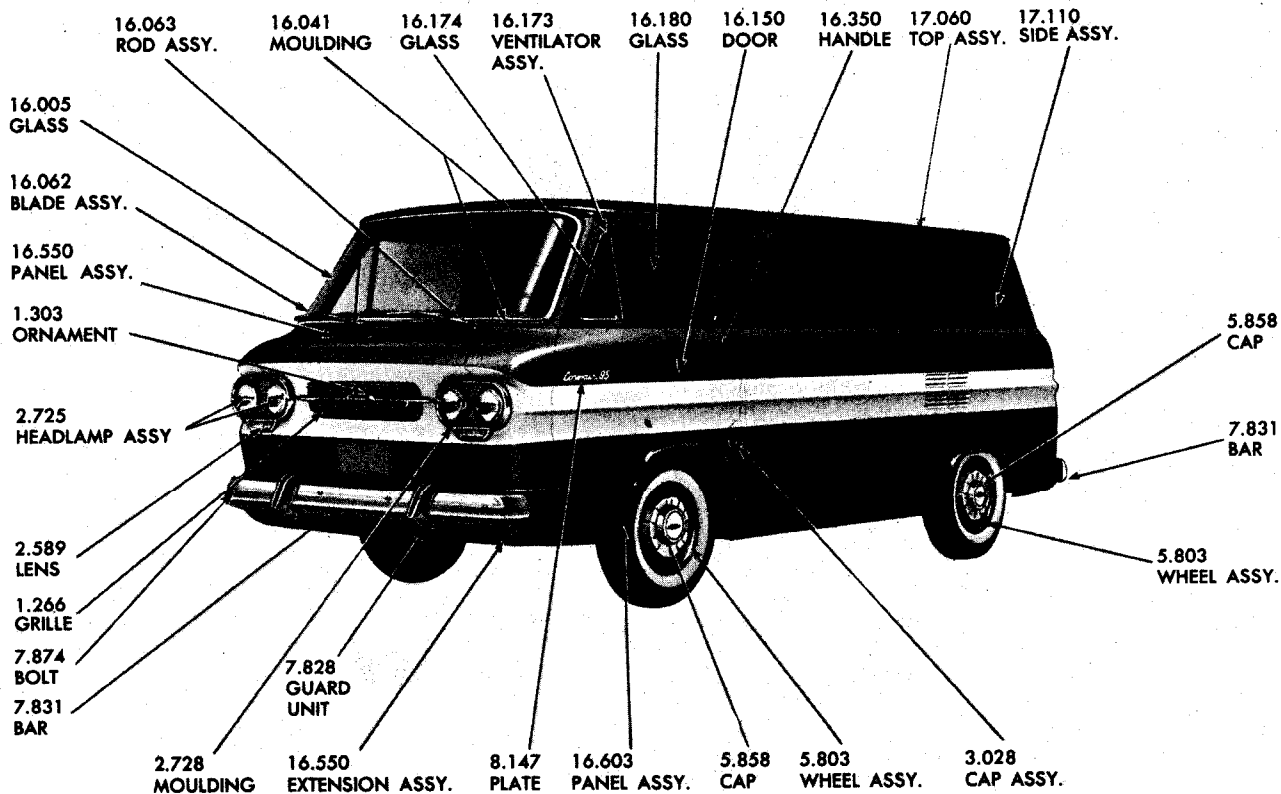

1961-64 CORVAIR PANEL

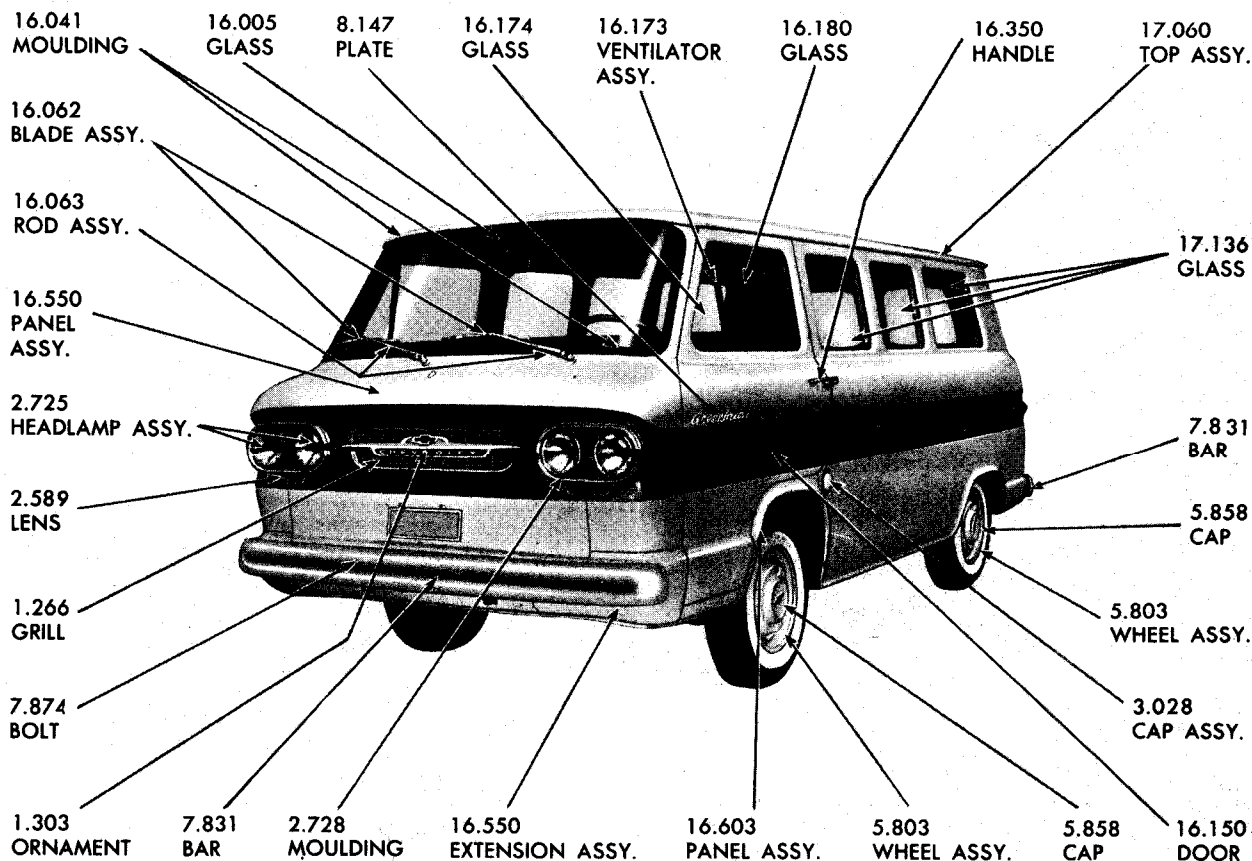

1961-65 CORVAIR GREENBRIER

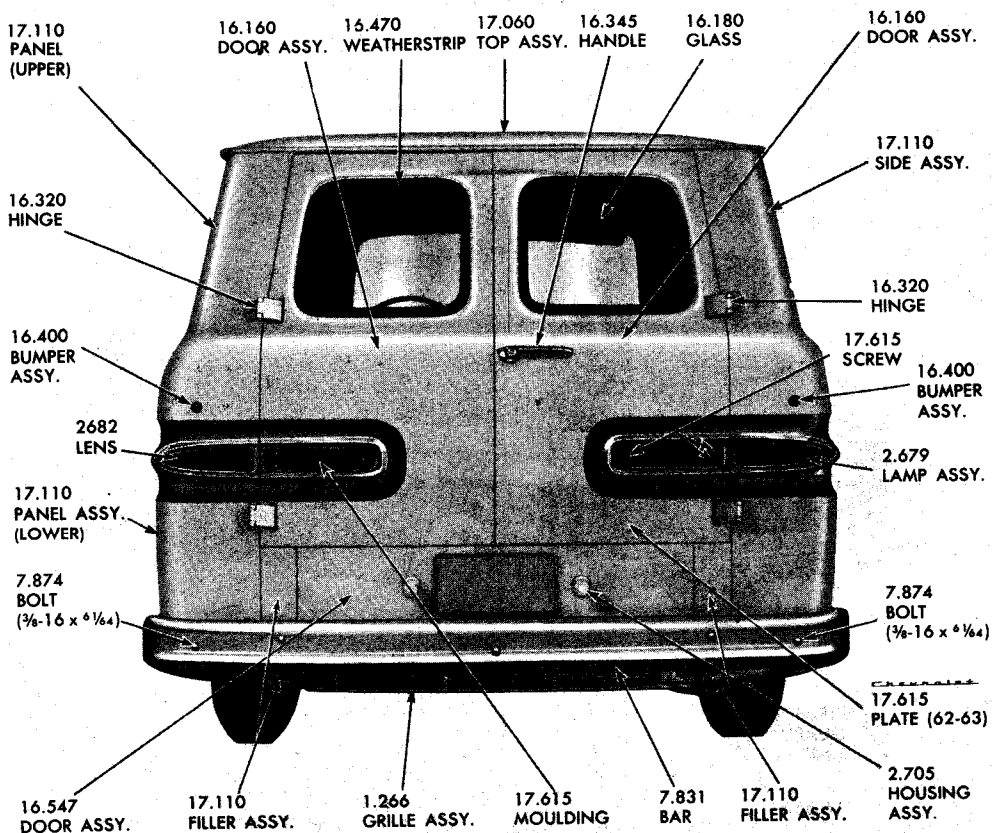

1961-65 CORVAIR GREENBRIER AND PANEL REAR END

©1969 CHEVROLET MOTOR DIVISION, GENERAL MOTORS CORPORATION—P&A 30C

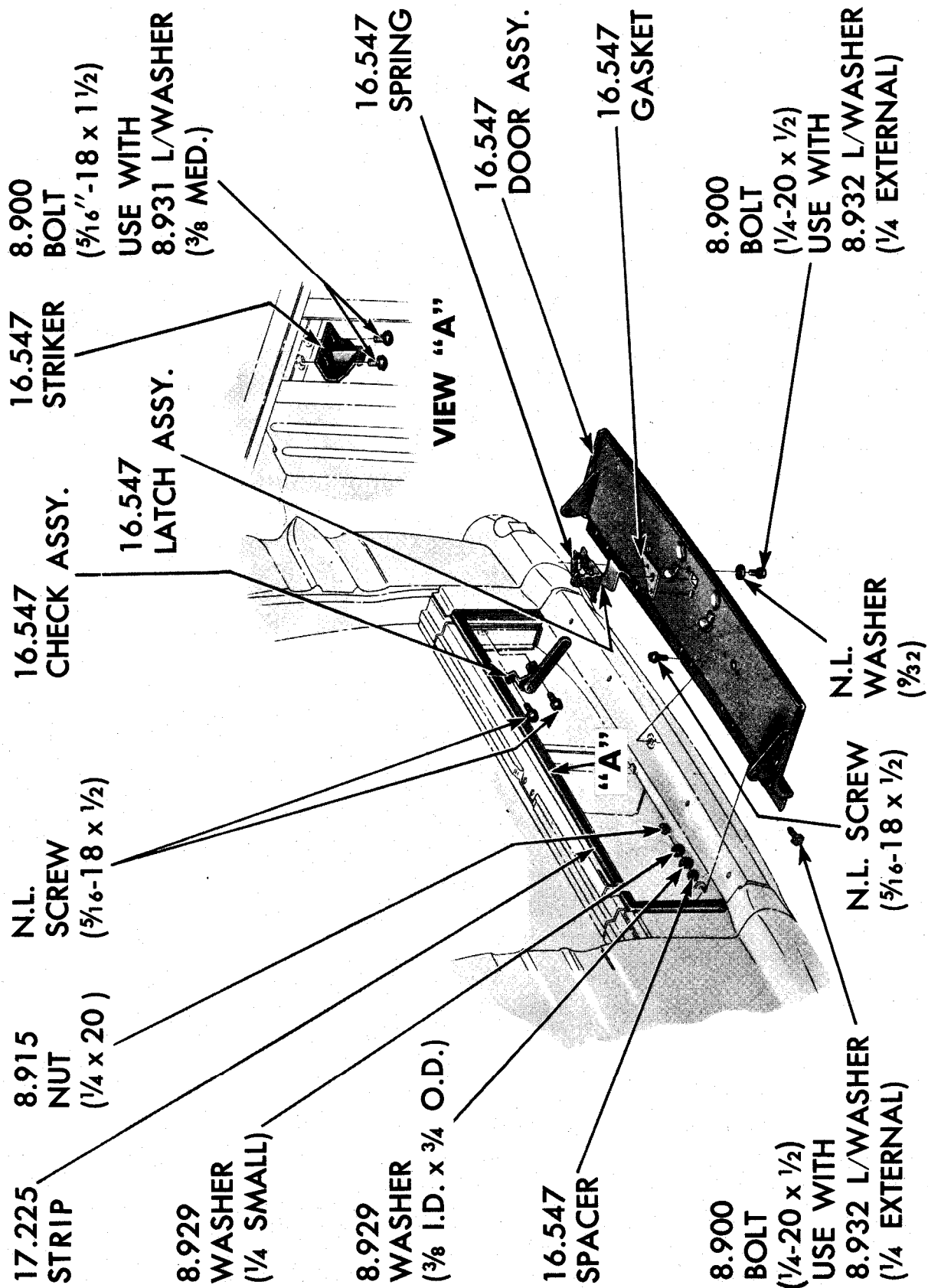

1961-63 CORVAIR F.C. ENGINE ACCESS DOOR

©1969 CHEVROLET MOTOR DIVISION, GENERAL MOTORS CORPORATION—P&A 30C

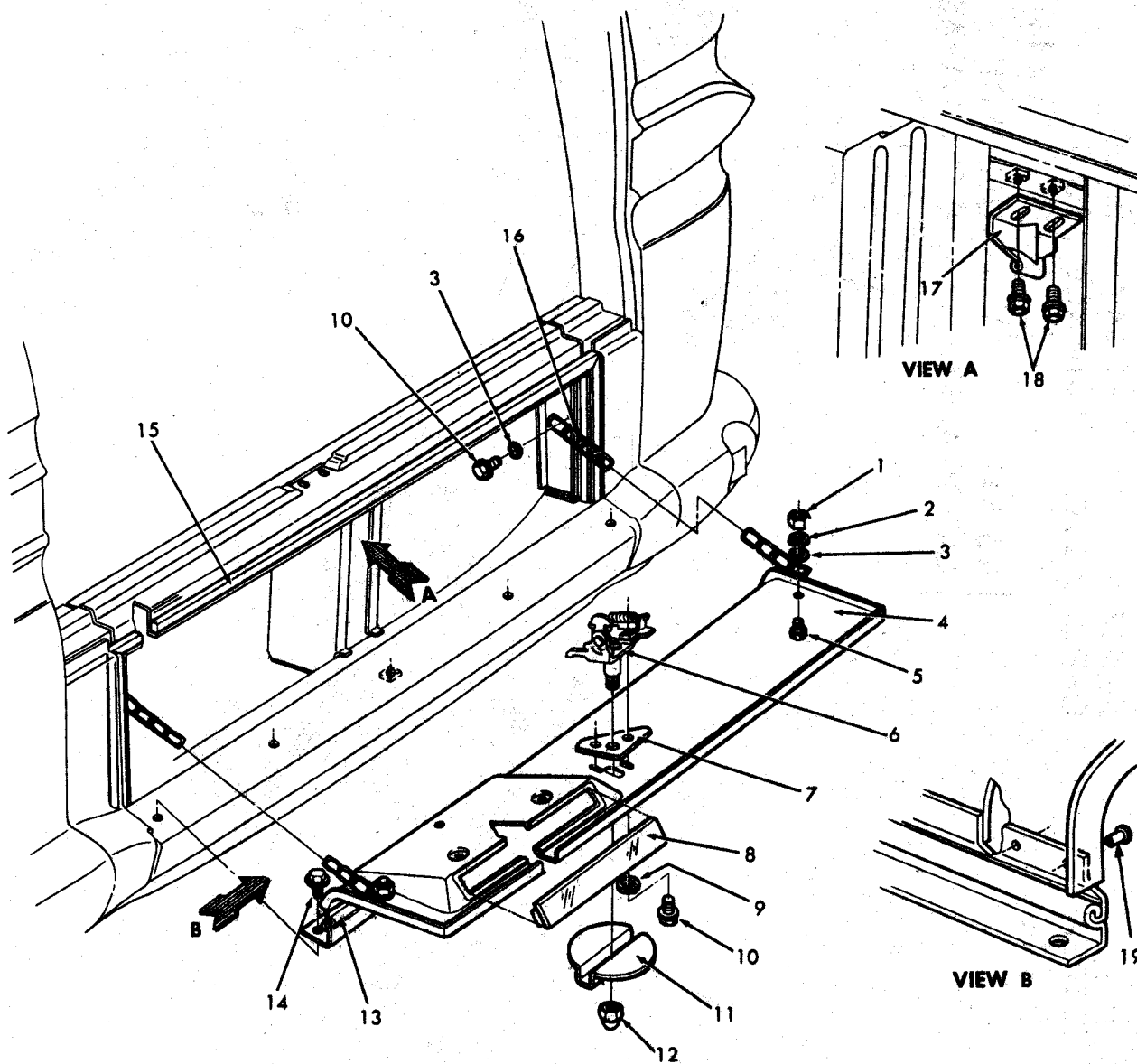

1964-65 CORVAIR F.C. ENGINE ACCESS DOOR DETAILS

1. 8.916	NUT, (1/4-20)		11. 16.547	HANDLE	3848805
2. 8.931	WASHER, (1/4 Med.)		12. 8.919	NUT, (3/8-16)	
3. N.L.	WASHER, (17/64 I.D. x 5/8 O.D.)		13. 16.547	HINGE ASSEMBLY	3848799
4. 16.547	DOOR	3848746	14. 8.900	BOLT, (5/16-8 x 1/2)	
5. 8.913	SCREW, (1/4-20 x 5/8)		15. 17.225	STRIP	3781045
6. 16.547	LOCK ASSEMBLY	3848802	16. 16.547	CHECK ASSEMBLY	3838704
7. 16.547	GASKET	3783386	17. 16.547	CATCH	3848806
8. 2.709	LENS	3848807	18. 8.900	BOLT, (1/4-20 x 7/16)	
9. 16.547	WASHER	3704579	19. N.L.	RIVET, (3/16 x 1/4)	
10. 8.900	BOLT, (1/4-20 x 1/2)				

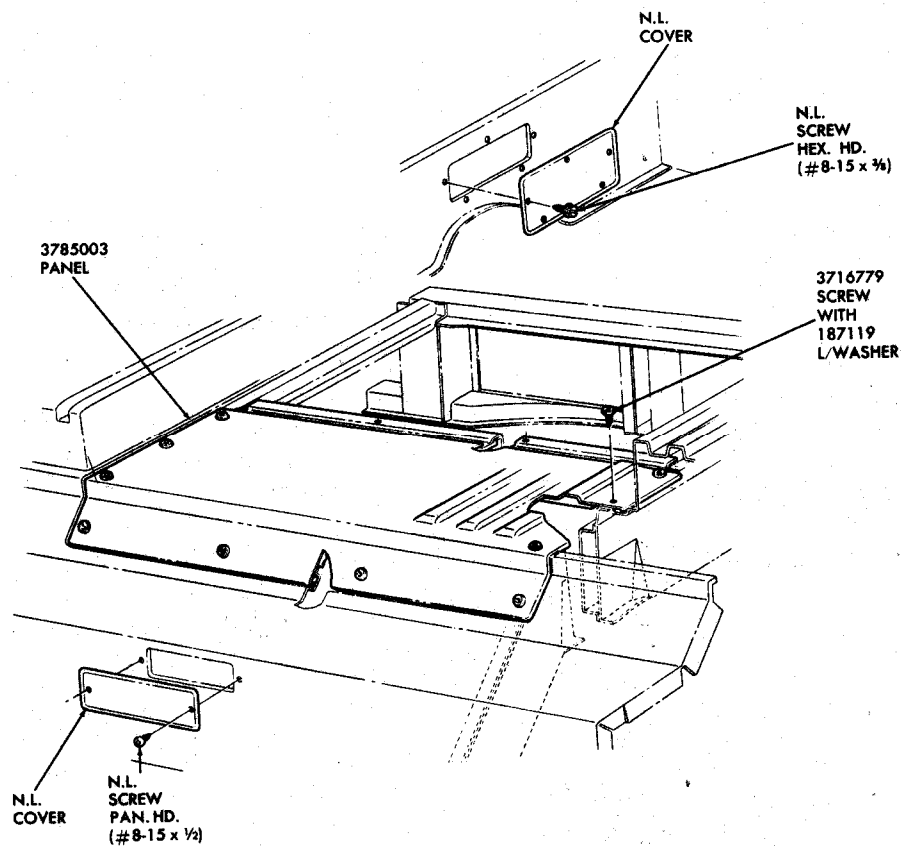

1961-65 CORVAIR F.C. REAR FLOOR TRIM PANEL

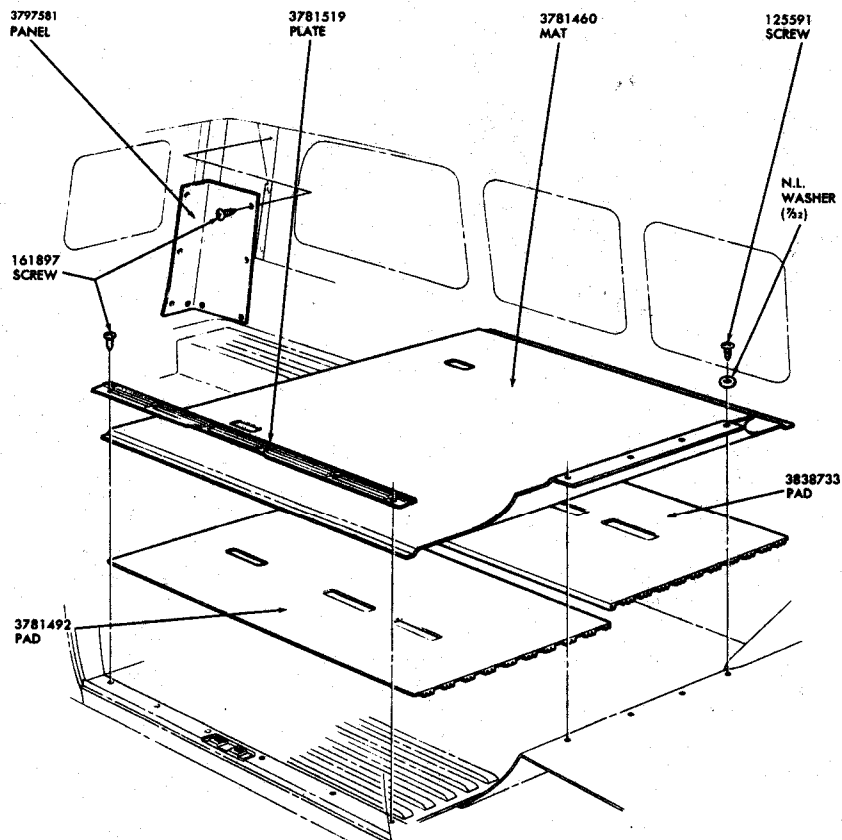

1961-65 CORVAIR F.C. FILLER PANEL DETAILS

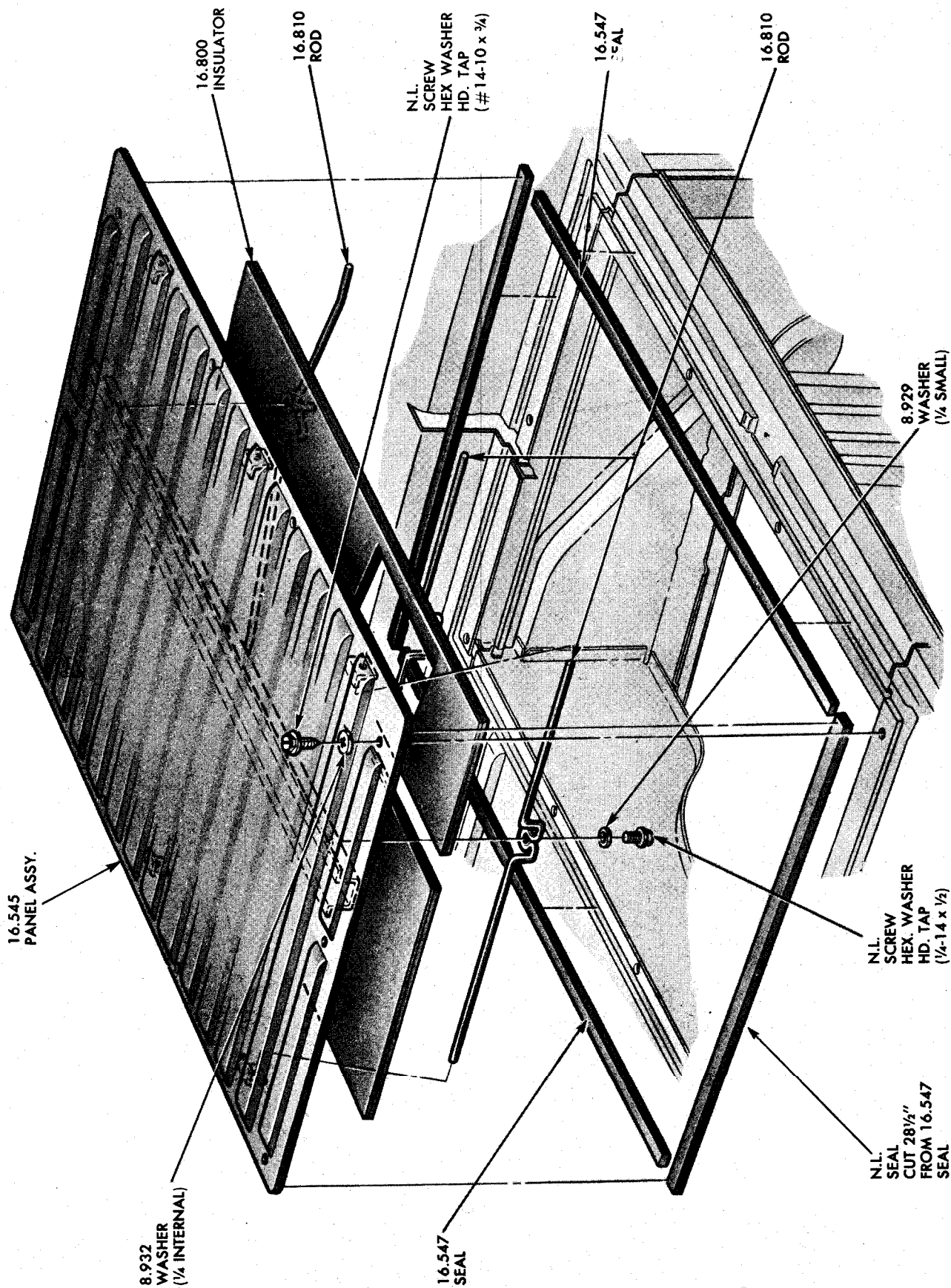

1961-65 CORVAIR F.C. ENGINE COMPARTMENT COVER

©1969 CHEVROLET MOTOR DIVISION, GENERAL MOTORS CORPORATION—P&A 30C

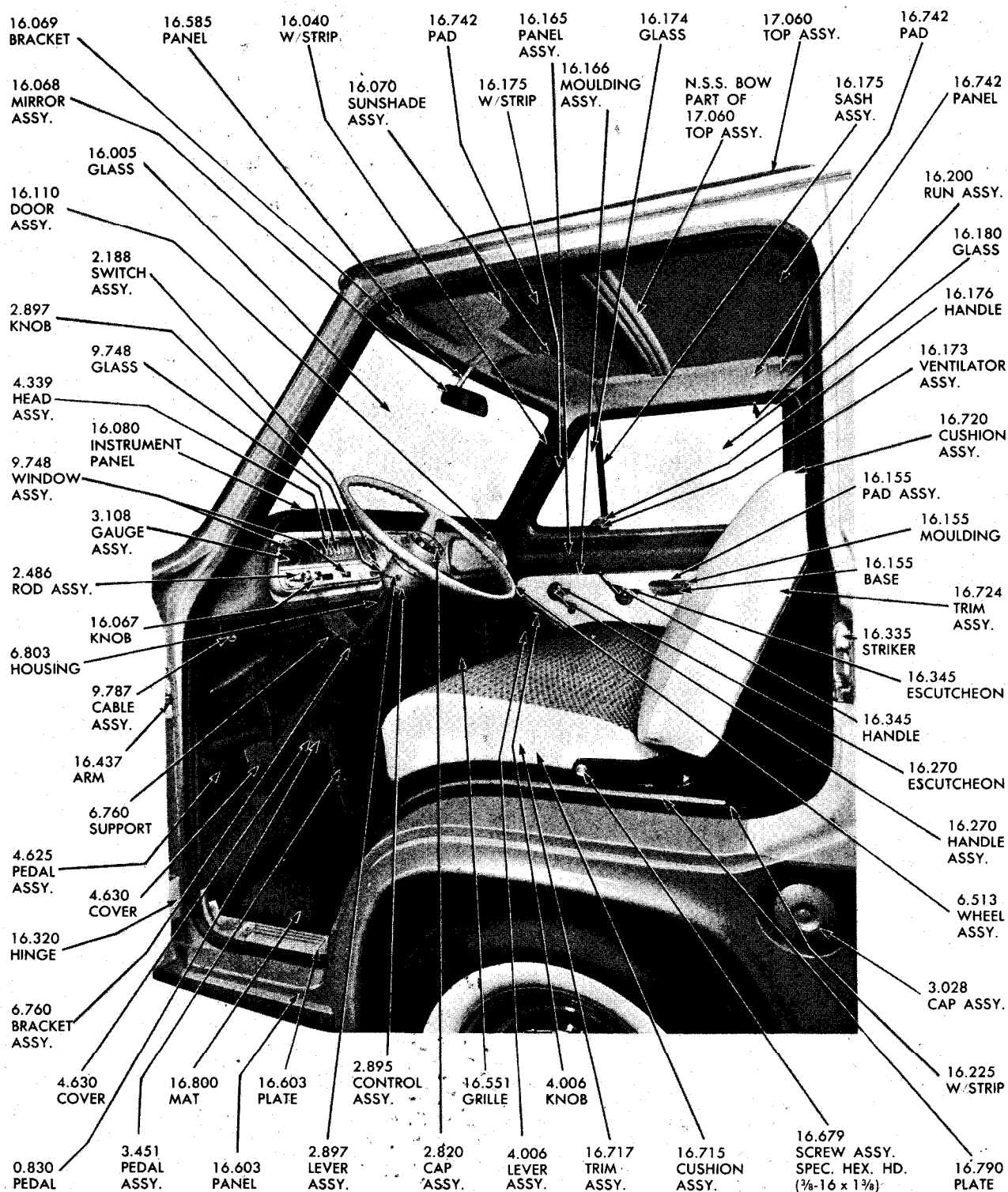

1961-65 GREENBRIER FRONT INTERIOR VIEW

©1969 CHEVROLET MOTOR DIVISION, GENERAL MOTORS CORPORATION—P&A 30C

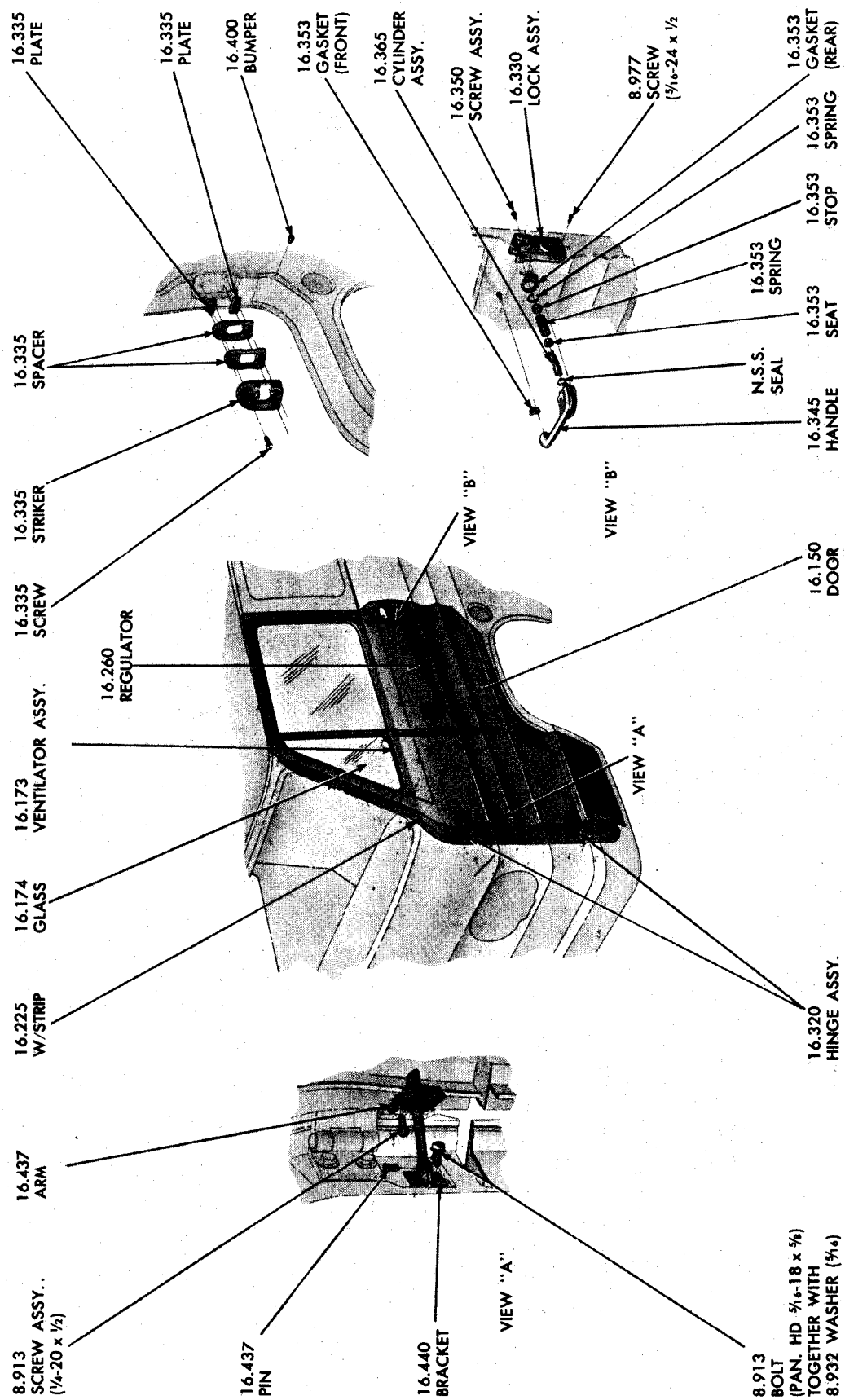

1961-65 CORVAIR F.C. FRONT DOOR DETAILS

©1969 CHEVROLET MOTOR DIVISION, GENERAL MOTORS CORPORATION—P&A 30C

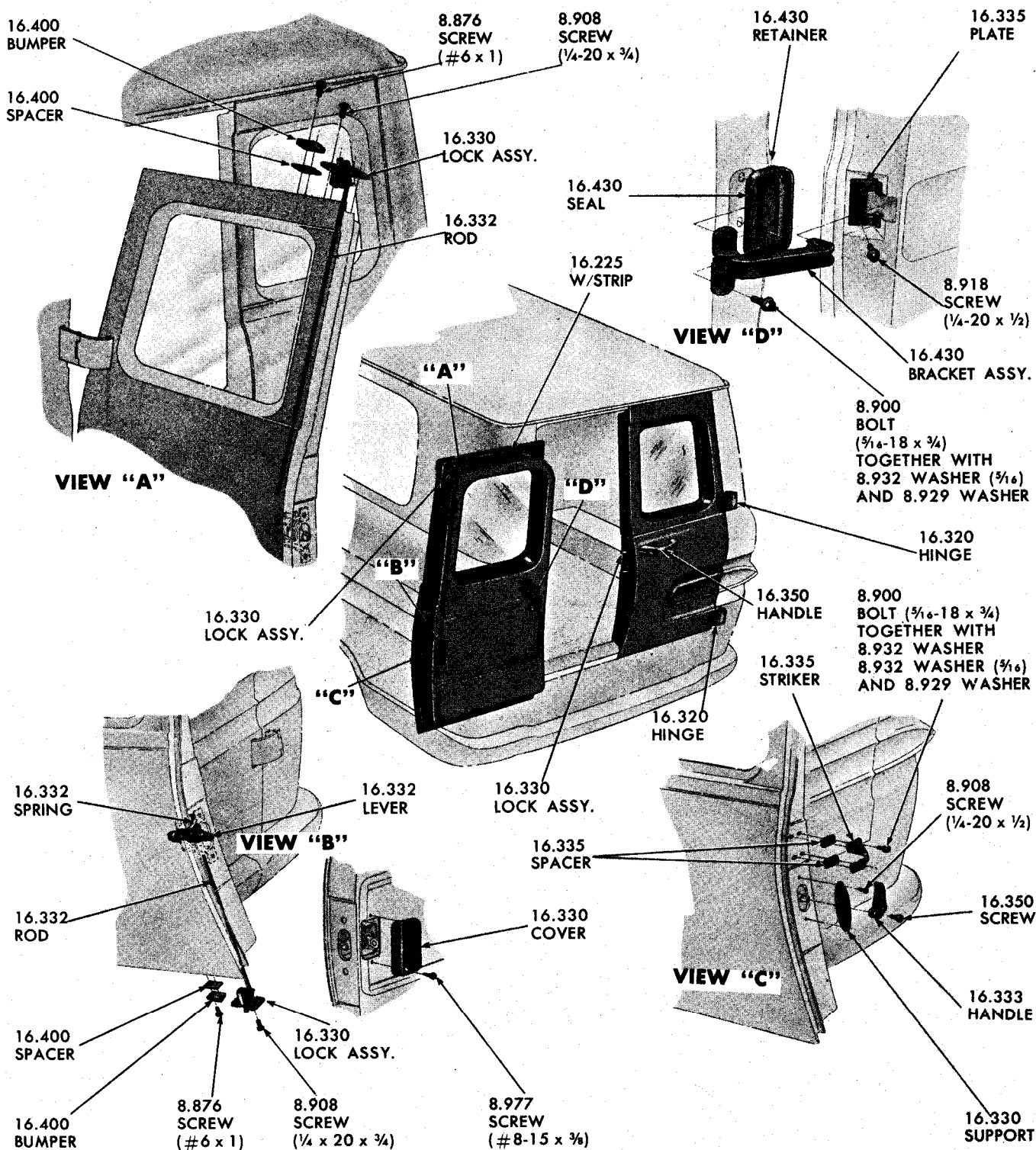

1961-65 GREENBRIER AND PANEL REAR LOADING DOOR DETAILS

©1969 CHEVROLET MOTOR DIVISION, GENERAL MOTORS CORPORATION—P&A 30C

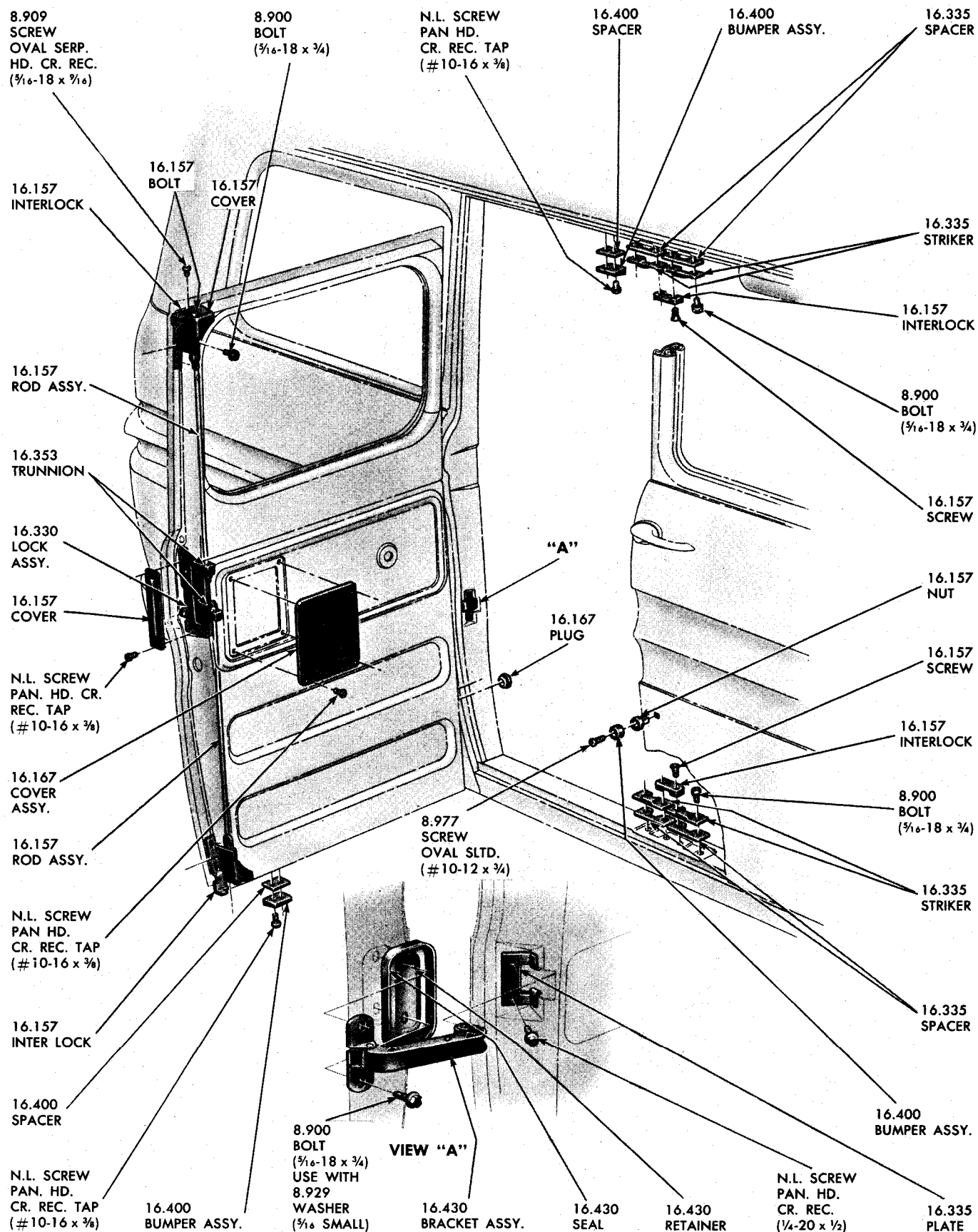

1961-65 CORVAIR F.C. SIDE CARGO DOOR LOCK AND STRIKER DETAILS

©1969 CHEVROLET MOTOR DIVISION, GENERAL MOTORS CORPORATION—P&A 30C

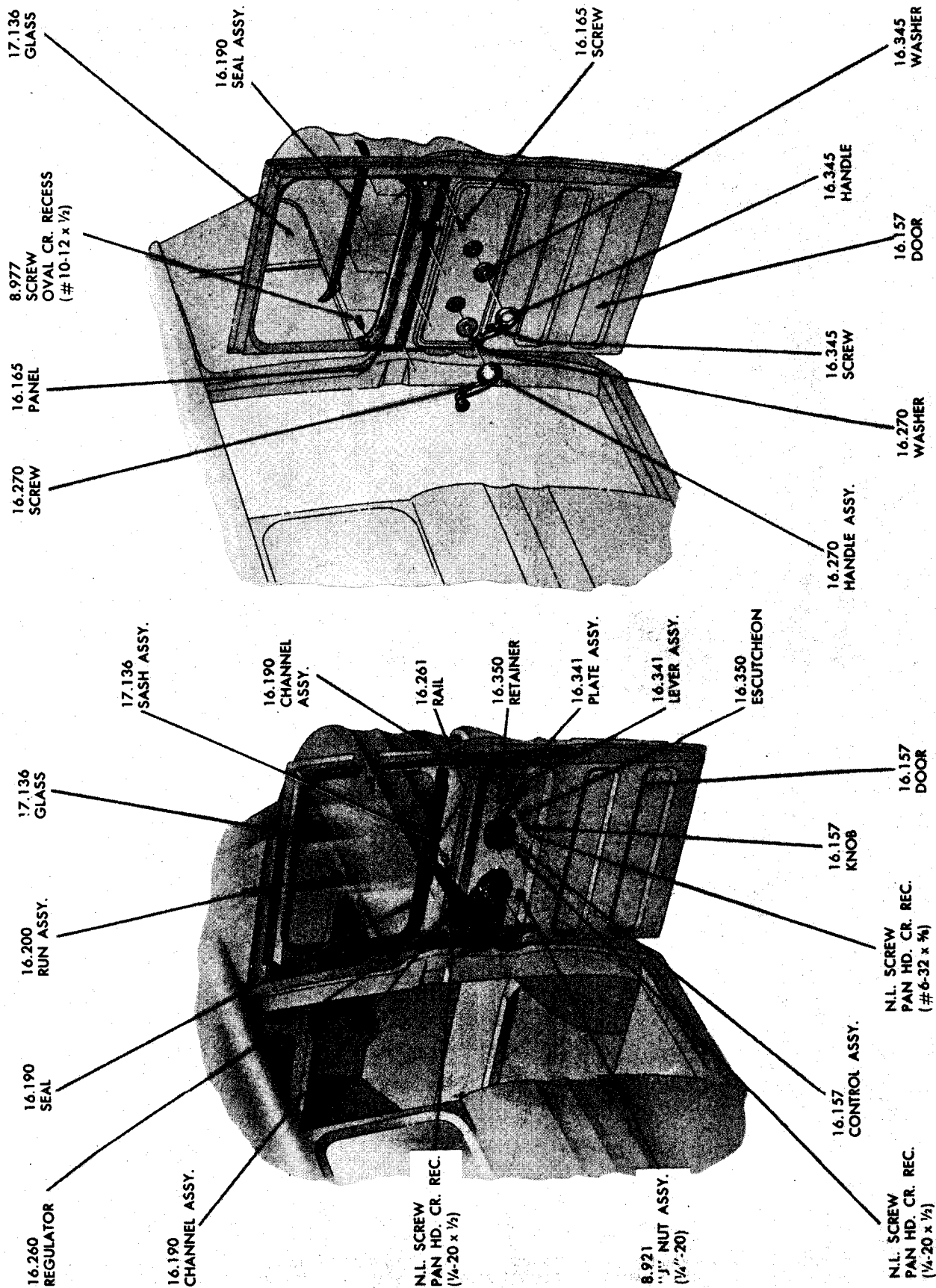

1961-65 CORVAIR F.C. SIDE CARGO DOOR DETAILS

©1969 CHEVROLET MOTOR DIVISION, GENERAL MOTORS CORPORATION—P&A 30C

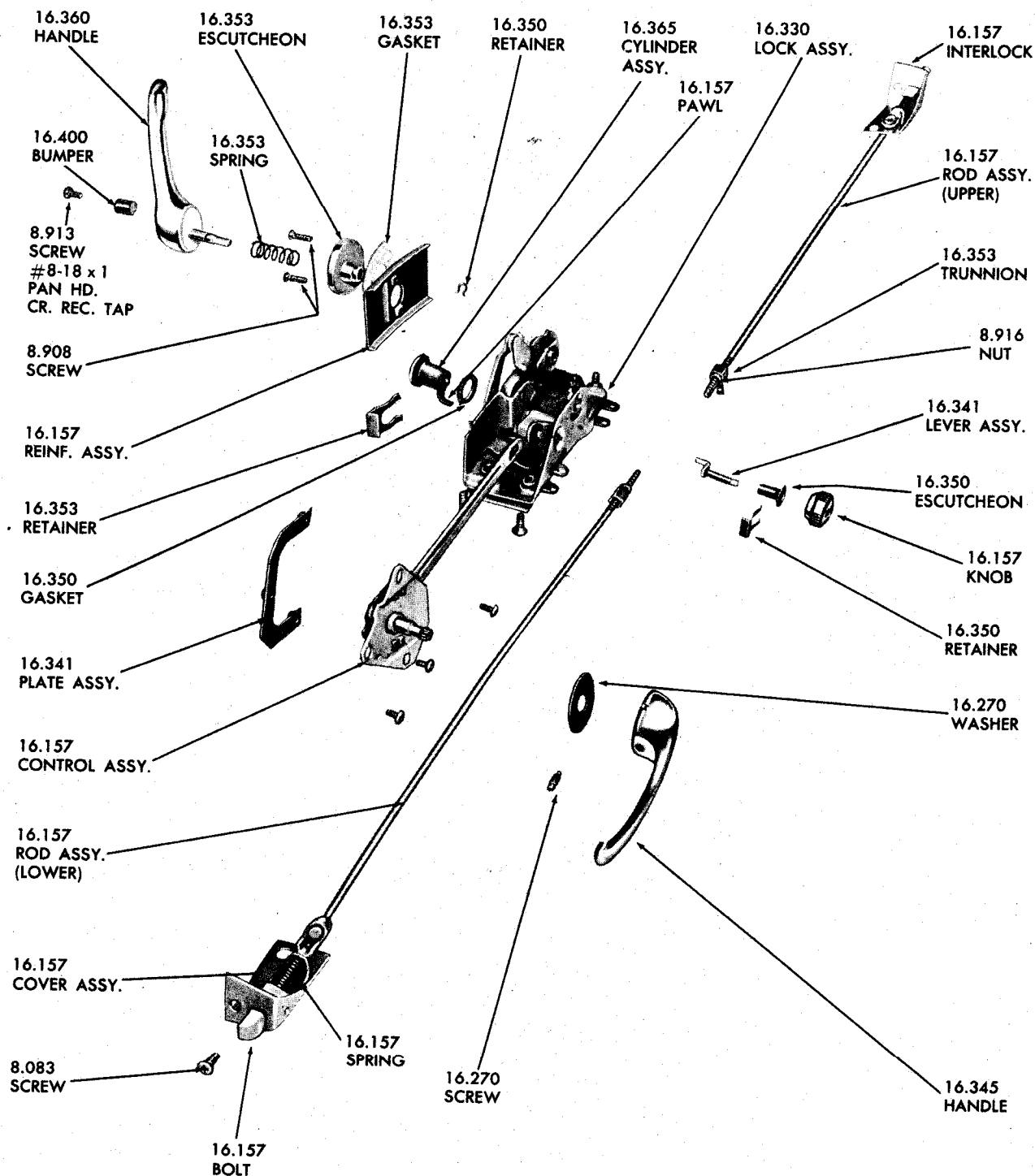

1961-65 CORVAIR F.C. SIDE CARGO DOOR LOCK—(EXPLODED)

©1969 CHEVROLET MOTOR DIVISION, GENERAL MOTORS CORPORATION—P&A 30C

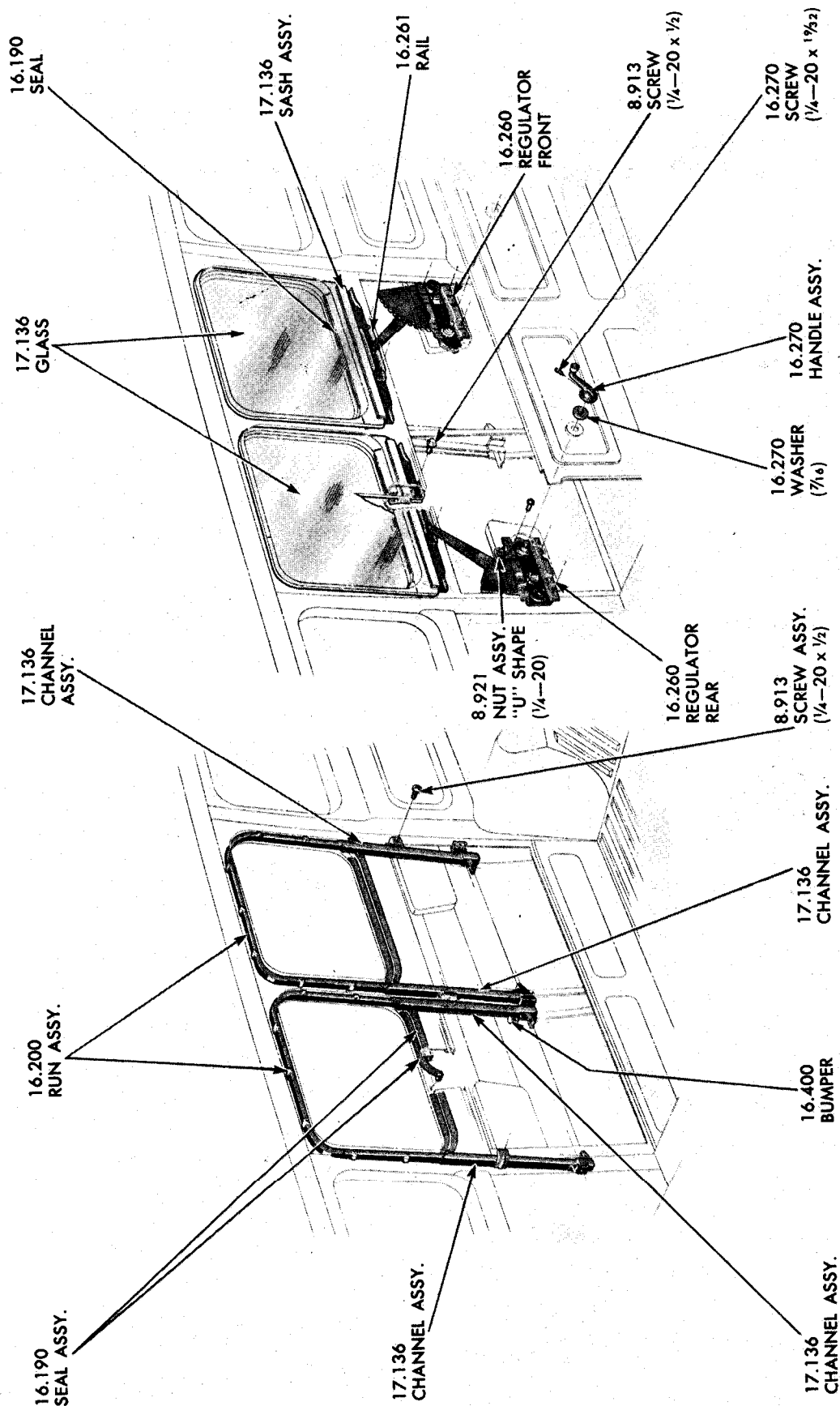

1961-65 SIDE WINDOW CHANNEL AND REGULATOR ASSY.

©1969 CHEVROLET MOTOR DIVISION, GENERAL MOTORS CORPORATION—P&A 30C

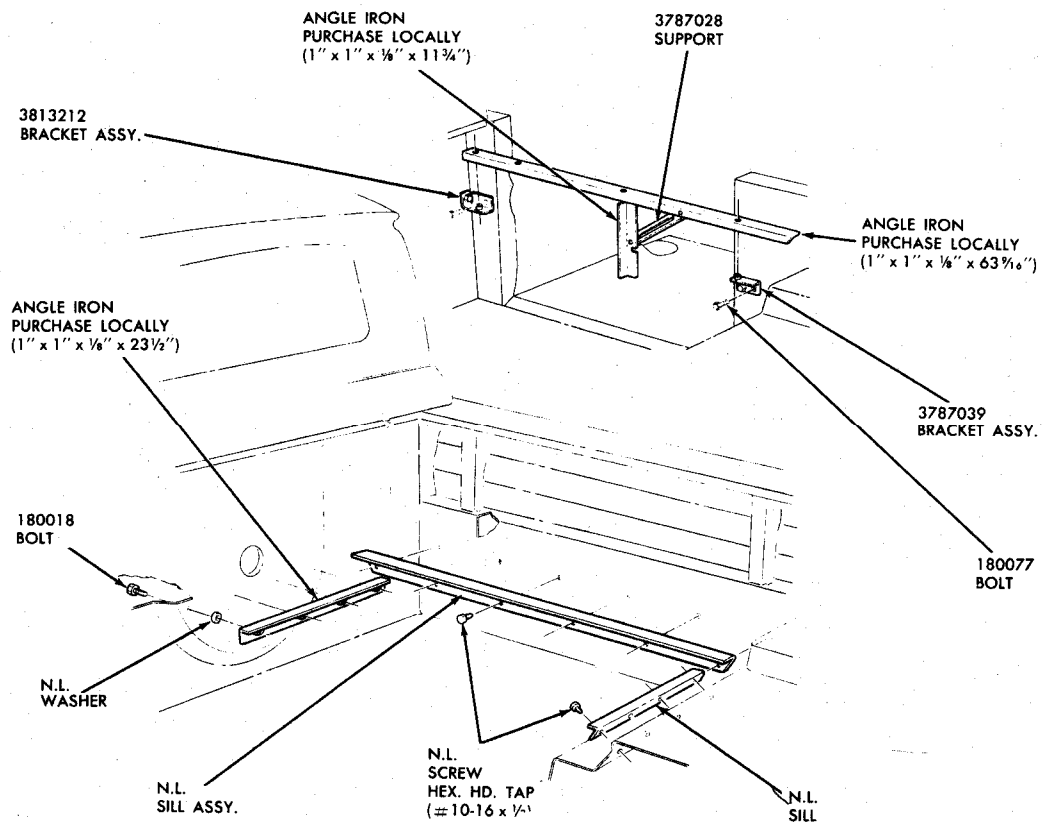

1961-64 CORVAIR F.C. PICK-UP LEVEL FLOOR SILL AND BRACKET DETAILS

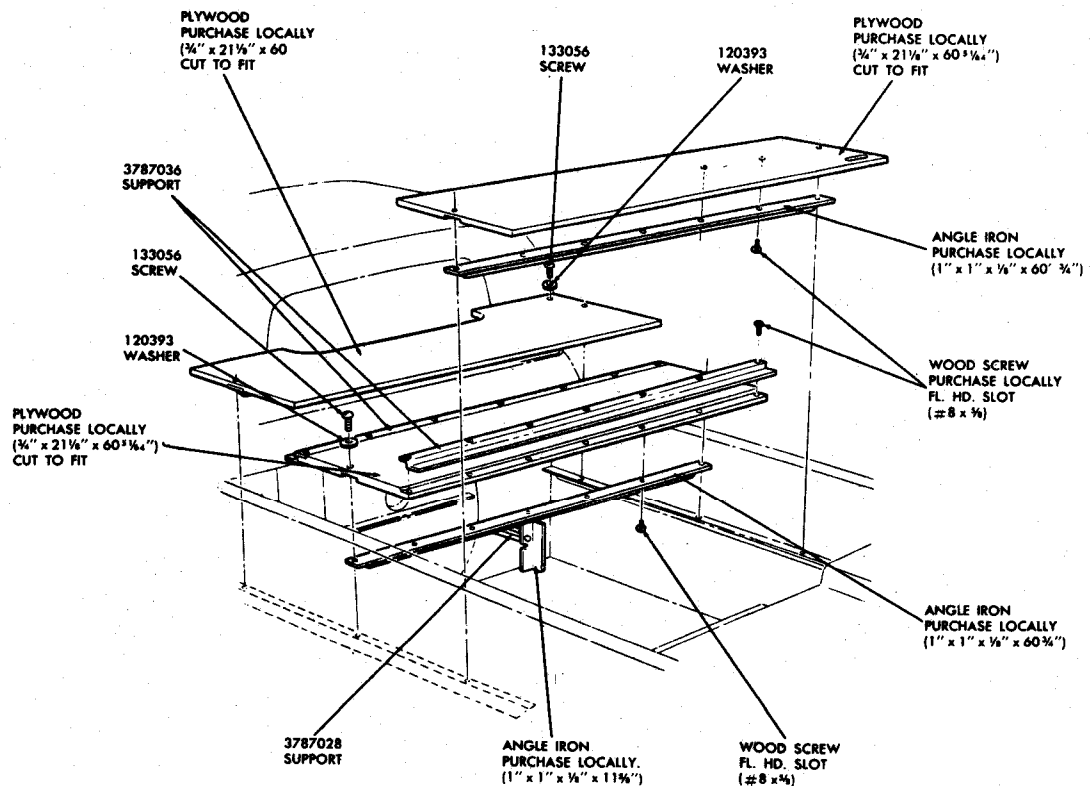

1961-64 CORVAIR F.C. PICK-UP LEVEL FLOOR PLATFORM DETAILS

©1969 CHEVROLET MOTOR DIVISION, GENERAL MOTORS CORPORATION—P&A 30C



16.005 GLASS, WINDSHIELD		
61-65 F.C.	3772351	safety 1
16.010 FILLER, Windshield Glass		
ALL ALL	3830213	(³ / ₆₄ " thick—40 ft. roll)—(10.696) A.R.
ALL ALL	3830214	(³ / ₃₂ " thick—60 ft. roll)—(10.696) A.R.
16.040 WEATHERSTRIP, Windshield		
61-65 F.C. (exc. deluxe equip.)	3777046	rubber (150" dev. length) 1
61-65 F.C. w/deluxe equip.	3785254	rubber (173" dev. length) (2 raised ridges on base of inner glass slot) (Note 1) 1
NOTE 1. Cut to required length.		
16.041 MOULDING—CAP, Windshield Reveal		
61-65 F.C. w/deluxe equip	3787669	upper L.H.
61-65 F.C. w/deluxe equip	3787670	upper R.H.
61-65 F.C. w/deluxe equip	3787667	lower L.H.
61-65 F.C. w/deluxe equip	3787668	lower R.H.
61-65 F.C. w/deluxe equip.	3818416	CAP, windshield reveal—(11.208) 4
16.062 BLADE ASSY.—INSERT ASSY., Windshield Wiper		
61-65 F.C.	3941969	(Trico) (14 ⁷ / ₈ " long)—(10.146) 2
61-64 F.C.	3779741	(Anco) (15 ⁵ / ₃₂ " long)—(10.146) 2
65 F.C.	3871085	(Anco) (15" long)—(10.146) 2
61-63 F.C.	3821753	INSERT ASSY. (Anco) (15 ⁵ / ₃₂ " long)—(10.146) 2
62-65 F.C.	3819074	INSERT ASSY. (Trico) (14 ⁴ / ₈ " long)—(10.146) 2
Not required in this group.		
See group 10.146		INSERT ASSY.
Not required in this group.		
See group 10.146		INSERT ASSY.
16.063 LINK ASSY.—ROD ASSY.—SPACER, Windshield Wiper		
61-65 F.C.	4907566	L.H.
61-65 F.C.	4907565	R.H.
61-65 F.C.	3775139	ROD ASSY. (13 ¹ / ₆₄ " long) 1
61-65 F.C.	3764098	SPACER, link assy. (1 ¹ / ₈ " dia. x 1 ¹¹ / ₆₄ " thick) 1
16.064 MOTOR ASSY., Windshield Wiper		
62 F.C. w/2-SPD.	4910144	complete—(10.150) 1
62 F.C. w/Sgl. Spd.	4910214	complete—(10.150) 1
63-65 F.C. w/2-SPD.	4911476	complete—(10.150) 1
63-65 F.C. w/Sgl. Spd.	4911945	complete—(10.150) 1
61 F.C. w/2-SPD.	4909108	MOTOR UNIT (10.150) 1
61 F.C. w/Sgl. Spd.	4907734	MOTOR UNIT (10.150) 1
16.065 ARM ASSY.—ARMATURE ASSY.—BOLT—BRACKET—BRUSH ASSY.—BRUSH KIT—CAP—CASE ASSY.—COIL ASSY.—COVER—GASKET—GEAR—GROMMET—HOLDER ASSY.—KIT—NUT—PLUG—RETAINER—RING—SCREW—SHAFT—SPRING—WASHER,		
Windshield Wiper Motor		
62 F.C.,		w/pin 1
63-65 F.C. w/sgl. spd.	4910243	w/pin 1
63-65 F.C. w/2-SPD.	4910968	ARMATURE ASSY.—(10.150) 1
61 F.C. w/sgl. spd.	4908915	ARMATURE ASSY.—(10.150) 1
62-65 F.C. w/sgl. spd.	4909915	ARMATURE ASSY.—(10.150) 1
62-65 F.C. (2-spd. w/washer)	4910164	
61 F.C. w/sgl. spd.,		
62-65 F.C. w/2-spd.	4907157	BOLT (No. 10—32 thds.—4 ³ / ₈ " O.L.)—(10.150) 2
62-65 F.C. w/sgl. spd.	4903428	BOLT, through (No. 10—32, 1 ¹¹ / ₆₄ " x 3 ⁷ / ₈ ")—(10.150) 2
61-64 F.C. (sgl. spd. w/washer),		
65 F.C.	4904212	BRACKET, motor brush holder mounting—(10.783) A.R.
61 F.C. w/sgl. spd.	4905189	BRUSH ASSY.—(10.150) 2
62-65 F.C.	4910516	BRUSH KIT, replacement—(10.150) 1
61 F.C. w/sgl. spd.	4905259	CAP, drive shaft sealing—(10.157) 1
62-65 F.C. w/sgl. spd.	4909948	CAP, drive shaft protector—(10.157) 1
62-65 F.C.	4910424	CAP ASSY.—(10.150) 1
61 F.C. w/2-spd.	4909112	CASE ASSY., w/brush—(10.150) 1
61 F.C. w/2-spd.	4908447	COIL ASSY., field—(10.150) 1
62-65 F.C. (2-spd. w/washer)	4910291	COIL ASSY., field—(10.150) 1
62-65 F.C. w/sgl. spd.	4910299	COIL ASSY., field—(10.150) 1
63-65 F.C. w/2-spd.	4912095	COVER, gear train w/plate—(10.157) 1
63-65 F.C. w/sgl. spd.	4912096	COVER, gear train, w/plate—(10.157) 1
61-62 F.C.	542675	GASKET (2 ⁵ / ₃₂ " dia. x 3 ³ / ₈ " thk.)—(10.152) 1
62-65 F.C.	3792579	GASKET—(10.152) 1

62-65	F.C. w/sgl. spd.	4910140
62-65	F.C. (2-spd. w/washer)	4909941
61-65	F.C.	3707952
61	F.C. w/2-spd.	4904756
62-65	F.C.	4910180
62-65	F.C.	4909925
61	F.C. w/sgl. spd.	4907735
61	F.C. w/sgl. spd.	9413553
62-65	F.C.	4909914
61-65	F.C.	531848
64-65	F.C.	4912427
61	F.C. w/2-spd.	4904998
62-65	F.C.	4910142
61	F.C. w/sgl. spd.	4906744
62-65	F.C. w/sgl. spd.	4910139
61	F.C. w/2-spd.	4908424
61	F.C. w/sgl. spd.	4906716
62-65	F.C. (2-spd. w/washer)	4909942
61-65	F.C.	4908709
64	F.C.	4911856
61	F.C.	4905194
61	F.C.	138479

GEAR, intermediate w/pinion—(10.157)	1
GEAR, intermediate w/plate—(10.157)	1
GROMMET, spray connector tee to spray nozzle ($\frac{9}{32}$ ")—(2.251)	1
GROMMET, motor housing wire—(10.152)	1
GROMMET, mounting—(10.152)	3
HOLDER ASSY., brush—(10.150)	1
KIT, brush holder and circuit breaker—(10.150)	1
NUT, arm and pin retaining ($\frac{1}{4}$ "—28)—(8.917)	1
PLUG, armature shaft thrust—(10.150)	1
RETAINER, link assy. to motor assy.—(10.160)	1
RETAINER, slip, drive link to motor (used w/ $\frac{3}{8}$ " dia. stud)—(10.160)	1
RING, driveshaft retaining—(10.157)	1
RING, driveshaft retaining—(10.157)	1
SCREW, armature end plate adj. ($\frac{1}{4}$ "—28 x $\frac{7}{8}$ ")—(10.150)	1
SHAFT, drive, w/gear—(10.157)	1
SHAFT ASSY., drive, w/gear—(10.157)	1
SHAFT ASSY., drive, w/gear—(10.157)	1
SHAFT ASSY., drive, w/gear—(10.157)	1
SPRING, brush ($\frac{3}{16}$ " dia. w/9 right hand turns close wound)—(10.150)	1
SPRING, pump extension—(10.153)	1
WASHER, drive shaft and gear assy. spacer—(10.150)	1
WASHER, motor assy. (No. 10)—(8.932)	4

16.065ABELLOWS—BOARD ASSY.—BUMPER—CAM—CLIP—COIL ASSY.—COVER—FILLER—GASKET—GEAR—HOUSING—NOZZLE ASSY.—PAWL—PAWL UNIT—PUMP ASSY.—PUMP PACKAGE—PUMP UNIT—RELAY ASSY.—RESERVOIR ASSY.—

RING—SPRING—TEE—VALVE ASSY.—WASHER, Windshield Washer

61-65	F.C.	4914074	pump valve—(10.153)	1
62-64	F.C. w/2-spd.	4910775	BOARD ASSY., pump terminal—(10.153)	1
61-62	F.C.	4905345	BUMPER, actuating arm—(10.153)	1
61-62	F.C.	4906931	CAM, pump (4 lobe)—(10.153)	1
62	F.C. w/2-spd.	4910117	CAM, pump (3 lobe)—(10.153)	1
63-65	F.C.	4918233	CAM, pump (4 lobe)—(10.153)	1
61-62	F.C.	4904474	CLIP, pump relay terminal board—(10.153)	1
62-65	F.C. w/2-spd.	4916802	COIL ASSY., pump terminal—(10.153)	1
62-65	F.C. w/2-spd.	4910431	COVER, pump—(10.153)	1
60-65	F.C.	3760369	FILLER, washer jar hose water—(10.154)	1
61-62	F.C.	4908747	GASKET, pump cover—(10.157)	1
62-63	F.C. w/sgl. spd.	4910888	GEAR, pump—(10.153)	1
62-64	F.C. w/2-spd.	4910110	HOUSING, pump bellows—(10.153)	1
61-65	F.C.	3776836	NOZZLE ASSY., washer spray	1
62-65	F.C. w/2-spd.	4910123	PAWL, pump ratchet—(10.153)	1
61-62	F.C.	4914935	PAWL UNIT, pump ratchet—(10.153)	1
62	F.C.	4911521	PUMP ASSY.—(10.153)	1
63-65	F.C.	4912365	PUMP PACKAGE—(10.153)	1
61	F.C.	4909111	PUMP UNIT (Note 1)—(10.153)	1
NOTE 1 Consists of pump assy., cover, gasket, screws and nuts.				
61-62	F.C. w/sgl. spd.	4906055	RELAY ASSY., pump (w/terminal board) (straight)—(10.153)	1
61	F.C. w/2-spd.	4909133	RELAY ASSY., pump (w/terminal board) (angled)—(10.153)	1
61-65	F.C.	3776830	RESERVOIR ASSY., washer	1
61-62	F.C.	9416094	RING, pump pawl retaining—(8.934)	1
61-62	F.C.	4908486	RING, pump retaining—(10.153)	1
61-62	F.C.	4905737	SPRING, pump ratchet lock—(10.153)	1
62-65	F.C. w/2-spd.	4910108	SPRING, pump cam follower ($\frac{31}{32}$ " dia.)—(10.153)	1
62-65	F.C. w/2-spd.	4910124	SPRING, pump ratchet pawl—(10.153)	1
62-65	F.C. w/2-spd.	4913551	SPRING, pump dog—(10.153)	1
61-63	F.C.	3760758	TEE, washer spray connector—(10.155)	1
61-65	F.C.	4914356	VALVE ASSY., pump—(10.153)	1
Not required in this group.				
See group 4.008			WASHER	A.R.
2390395				

16.066 HOSE, Windshield Washer

ALL	ALL	3830665	R.H. and L.H. pump to nozzle ($\frac{5}{32}$ " I.D.)—(8.962)	2
ALL	ALL	3830663	jar to pump ($\frac{7}{32}$ " I.D.)—(8.962)	1

16.067 KNOB—BEZEL—BOARD ASSY.—NUT—SWITCH ASSY., Windshield Wiper

61-65	F.C. w/sgl. spd. (exc. washer)	3780348	($\frac{13}{16}$ " dia. x $1\frac{13}{32}$ " long)—(10.164)	1
-------	--------------------------------	---------	--	---

61-65	F.C. w/washer	1990992	control w/set screw—(10.164)	1
63-65	F.C.	6256713	BEZEL, wiper switch—(2.487)	1
61	F.C. w/2-spd.	4908473	BOARD ASSY., motor terminal—(10.163)	1
61	F.C. w/sgl. spd.	4906709	BOARD ASSY., motor terminal—(10.163)	1
62-64	F.C. w/2-spd.	4910515	BOARD ASSY., motor terminal—(10.163)	1
62-65	F.C. w/sgl. spd.	4910350	BOARD ASSY., motor terminal—(10.163)	1
65	F.C.	3820531	NUT, control switch—(10.163)	1
61	F.C. w/2-spd.	1993527	SWITCH ASSY.—(10.163)	1
61-65	F.C. w/sgl. spd.	1993441	SWITCH ASSY.—(10.163)	1
61-65	F.C. (sgl. spd. w/washer)	1993541	SWITCH ASSY.—(10.163)	1
63-65	F.C. (2-spd. w/washer)	1993584	SWITCH ASSY.—(10.163)	1

16.068 MIRROR ASSY.—BUSHING, Rear View

61-62	F.C.,		inside (painted head)—(10.185)	1
63-65	GREENBRIER, SIDE RAMP	3633013	outside, non-glare	1
64-65	F.C.	3838535	BUSHING, rear view mirror stud (Note 1)—(10.185)	1
63-65	GREENBRIER, side ramp	565801		
NOTE 1 Used with 899769 mirror assy.				

16.069 ARM—BRACKET—BOLT—NUT—PAD—REINFORCEMENT ASSY.—SCREW—SUPPORT, Rear View Mirror

62-64	F.C.	3818424	(w/985771 mirror) (unpainted)	1
61-62	F.C.,		BRACKET, inside	1
63-65	F.C. (exc. PANEL)	3940865	BRACKET, outside rear view mirror (three 11 dia. hole)	R.H.
61-65	F.C.	3795374	BRACKET, mirror to arm, (w/985771 mirror)	A.R.
62-65	F.C.	3799983	BRACKET, arm to body, small, (stamped No. 1)	
62-65	F.C.	3818436	(w/985771 mirror) (unpainted)	1
62-65	F.C.	3818438	BRACKET, arm to body, large, (stamped No. 2)	
			(w/985771 mirror) (unpainted)	1
61-64	F.C.	3769162	BOLT, special tee (1/428 x 1 1/2)	A.R.
61-62	F.C.	3730635	NUT, support arm (w/988355 mirror) (7/8—23)	1
61-65	F.C.	3816679	PAD (w/short mirror) (triangle shape—three 25/64 holes)	A.R.
61-65	F.C.	3795375	REINFORCEMENT ASSY., outside rear view mirror	
			(3 1/8" x 5 w/three 5/16"—18 nut)	L.H.
61-65	F.C.	3795376	REINFORCEMENT ASSY., outside rear view mirror	
			(3 1/8" x 5 w/three 5/16"—18 nut)	R.H.
61-62	F.C.,		SCREW, rr. view mirror assy. (ov. hd. cr. rec. 10—32 x 9/16")—(10.186)	1
63-65	F.C. (exc. PANEL)	565842	SCREW, outside mirror to base MTG. BRKT.	1
63-64	F.C.	3903176	SUPPORT (w/985771 mirror) (unpainted)	2
62-65	F.C.	3818439		

16.070 SUNSHADE ASSY.

62-63	F.C.	3814290	w/supprot (fawn)	1
64-65	F.C.	3838971	w/support (fawn)	L.H.
64-65	GREENBRIER w/deluxe equip.	3838973	(cameo white)	L.H.
64-65	GREENBRIER w/deluxe equip.	3838974	(cameo white)	R.H.
64-65	F.C.	3838972	w/support (fawn)	R.H.

16.080 INSTRUMENT PANEL (in prime)

61-65	F.C.	3799883		1
-------	------	---------	--	---

16.081 PLATE—COVER, Instrument Cluster

61-64	F.C. (exc. P.G.)	3840659	trim—(10.252)	1
61-64	F.C. w/P.G.	3840660	trim—(10.252)	1
63	F.C. (exc. P.G.)	3824296	trim—(10.252)	1
65	F.C. (exc. P.C.)	3860730	cluster trim	1
61-65	F.C. (exc. P.G.)	3780325	COVER, transmission control lever instrument panel hole (1 41/64 x 1 1/8)	1
61-65	F.C. w/P.G.	3780326	COVER, transmission control lever instrument panel hole (1 41/64 x 1 7/64 w/2—1 1/64 dia. holes)	1

16.100 BOX—SWITCH ASSY., Instrument Panel Compt. and Courtesy

61-65	F.C.	3782178		1
61-65	F.C.	3859328	SWITCH ASSY., panel compt.—(10.275)	1

16.110 DOOR ASSY.—BUMPER—CASE—CYLINDER—GROMMET—KEY—LOCK ASSY.—RETAINER—STRIKER, Instrument Panel Compartment

61-62	F.C. (exc. deluxe equip.),			
63-65	GREENBRIER (exc. deluxe equip.)	3782093		1
63	F.C. w/deluxe equip.	3826788		1

64-65 F.C.	3844807	BUMPER, door (rubber $1\frac{1}{32}$ " dia. x $1\frac{1}{64}$ ")—(10.263)	1
61-65 F.C.	3785243	CASE, w/lock bolt less cylinder retainer and keys—	2
61-65 F.C.	1380873	(10.266)	1
61-65 F.C.	4566764	CYLINDER, door lock—(10.266)	1
61-65 F.C.	6280978	GROMMET, door ($1\frac{1}{4}$ " I.D. x $1\frac{1}{2}$ " O.D.)—(10.262)	1
61-63 F.C.	3694624	KEY, blank (octagon head)—(2.187)	A.R.
61-64 F.C.	3732065	LOCK ASSY., w/lock bolt, $1\frac{5}{8}$ " ret. ($7\frac{1}{8}$ " face dia. x $1\frac{9}{16}$ " long—chrome)—(10.268)	1
61-65 F.C.	4131049	RETAINER, lock cylinder case, latch retainer (1" long w/two $\frac{5}{32}$ " dia. holes)—(10.267)	1
61-65 F.C.	3781854	STRIKER, door lock ($1\frac{3}{4}$ " x $\frac{33}{64}$ "—w/2 holes)—(10.268)	1
16.115 HINGE, Instrument Panel			
61-65 F.C.	3772376	compartment door (13" long w/slotted holes)	1
16.120 TRAY ASSY.—KNOB—PLATE—RETAINER ASSY.—SPRING, Ash Receiver (less handle)			
61-65 F.C.	3765252	less knob	1
62-65 GREENBRIER w/deluxe equip.	3814974	w/retainer	1
61-65 F.C.	3796126	KNOB, face plate	1
61-65 F.C.	3765256	PLATE, tray face	1
61-65 F.C.	3762449	RETAINER ASSY.	1
62-65 F.C.	3765474	SPRING	1
16.125 RETAINER ASSY., Grille			
61-65 F.C.	3775016	ornament, inner	1
61-65 F.C.	3775017	ornament, outer	1
16.150 DOOR—PANEL, Side Front (in prime)			
61-63 F.C.	3826612	less trim and hardware	R.H.
61-64 F.C.	3865455	front	L.H.
64 F.C.	3865456	front	R.H.
65 F.C.	3858232	front	R.H.
61-65 F.C.	3865457	PANEL, front door outer	L.H.
61-65 F.C.	3865458	PANEL, front door outer	R.H.
16.155 REST ASSY.—BASE—MOULDING—NUT—PAD ASSY.—SCREW, Door Arm			
65 F.C.	3860762	front and rear door arm rest (red)	2
65 F.C. w/deluxe equip.	3882632	front and rear door arm rest (lt. green)	2
65 F.C. w/deluxe equip.	3860764	front and rear door arm rest (turquoise)	2
61-62 F.C. (exc. GREENBRIER)	3778798	BASE, rest	1
61-64 F.C. w/deluxe equip.	3786650	BASE, side front door and rear arm rest (white)	A.R.
61-64 F.C. w/deluxe equip.	3716956	MOULDING, rest	A.R.
61-62 F.C.	4780691	NUT, side door rest assy. (clinch) ($1\frac{1}{4}$ "—20 for $1\frac{1}{2}$ " opening)	2
61 F.C. (exc. GREENBRIER w/deluxe equip.)	3783499	PAD ASSY., left or right (silver)	A.R.
62-63 F.C. (exc. deluxe equip.),			
62-63 GREENBRIER w/deluxe equip.	3813128	PAD ASSY., side front door and rear arm rest (med. fawn)	A.R.
62-63 GREENBRIER w/deluxe equip.	3814012	PAD ASSY., rest (green)	A.R.
62-63 GREENBRIER w/deluxe equip.			
63 F.C. w/deluxe equip.	3816953	PAD ASSY., rest (red)	A.R.
64 F.C. w/deluxe equip.	3845893	PAD ASSY., rest (red)	2
64 F.C. w/deluxe equip.	3845894	PAD ASSY., rest (fawn)	2
65 GREENBRIER w/deluxe equip.	9422487	SCREW, rear arm rest ($1\frac{1}{4}$ "—14 x $1\frac{1}{4}$ ")—(8.977)	4
16.157 DOOR—PANEL—BOLT—CONTROL ASSY.—COVER—EXTENSION—GROMMET—HINGE ASSY.—INTERLOCK—KNOB—LEVER—NUT—PAWL—PIN—REINFORCEMENT ASSY.—ROD—SCREW—SPACER—SPRING—STRIKER, Body Side			
61-64 SIDE RAMP	3773526	ramp	R.H.
61-64 PANEL	3813447	side of vehicle, intermediate	L.H.
61-64 PANEL	3813448	side of vehicle, intermediate	R.H.
63-64 PANEL	3813341	side of vehicle, rear	L.H.
63-64 PANEL	3813342	side of vehicle, rear	R.H.
61-65 GREENBRIER	3813345	side of vehicle, rear	L.H.
61-65 GREENBRIER	3813346	side of vehicle, rear	R.H.

61-65	GREENBRIER	3813441
61-65	GREENBRIER	3813442
61-65	PANEL	3858288
61-65	PANEL	3858289
61-65	PANEL	3858290
61-65	GREENBRIER	3858284
61-65	GREENBRIER	3771827
61-65	GREENBRIER	3771828
61-64	SIDE RAMP	3773528
61-65	GREENBRIER	3858283
61-65	F.C. (exc. PICK-UP)	3798700

61-65	GREENBRIER w/deluxe equip.	3787627
61-65	GREENBRIER w/deluxe equip.	3787628
61-65	GREENBRIER w/deluxe equip.	3817813
61-65	GREENBRIER w/deluxe equip.	3817814
61-65	F.C. (exc. PICK-UP)	3776508
NOTE 1 It may be necessary to relocate the two attaching holes when installing on left side.		
61-65	F.C. (exc. PICK-UP)	3798702
61-65	F.C. (exc. PICK-UP)	3798701
64-65	GREENBRIER w/deluxe equip.	3844821
64-65	GREENBRIER w/deluxe equip.	3844822
61-65	F.C. (exc. PICK-UP)	3868334

61-64	SIDE RAMP	3776706
61-65	F.C. (exc. PICK-UP)	3778928
61-65	F.C. (exc. PICK-UP)	3778931
61-65	F.C. (exc. PICK-UP)	3778932
62-64	F.C. (exc. PICK-UP)	
65	F.C.	7591126
61	F.C. (exc. PICK-UP)	3813272
61-64	SIDE RAMP	3778575
61-63	F.C. (exc. PICK-UP)	3783004

61	F.C. (exc. PICK-UP)	3854326
61-63	F.C. (exc. PICK-UP)	456540

61-65	F.C. (exc. PICK-UP)	3776321
62-65	F.C. (exc. PICK-UP)	3813475
62-65	F.C. (exc. PICK-UP)	3813476
61-65	F.C. (exc. PICK-UP)	3819105
61-65	F.C. (exc. PICK-UP)	3819106
61-63	F.C. (exc. PICK-UP)	9416990

61-63	F.C. (exc. PICK-UP)	3785540
-------	---------------------	---------

61-65	F.C. (exc. PICK-UP)	3775359
61-64	SIDE RAMP	3778431
61-65	F.C. (exc. PICK-UP)	3776481

61-64	SIDE RAMP	3796624
-------	-----------	---------

16.160 DOOR ASSY.—NUT—SCREW, Rear

63-64	F.C. (exc. PICK-UP)	3794627
63-64	F.C. (exc. PICK-UP)	3794628
61-65	F.C. (exc. PICK-UP)	3773421
61-65	F.C. (exc. PICK-UP)	3773422
61-63	F.C. (exc. PICK-UP)	3783004
61-63	F.C. (exc. PICK-UP)	3716779

16.165 PANEL—EYELET—RETAINER—SCREW—SEAL, Door Inside Trim

61-65	F.C.	3786569
61-65	F.C.	3786570
61-65	GREENBRIER	3813453
61-65	GREENBRIER	3813454
62-63	GREENBRIER w/deluxe equip.	3814384

side of vehicle, intermediate (front)	L.H.
side of vehicle, intermediate (front)	R.H.
PANEL, side of vehicle, intermediate	R.H.
PANEL, side of vehicle, rr. door outer	L.H.
PANEL, side of vehicle, rr. door outer	R.H.
PANEL, side of vehicle, intermediate door outer	L.H.
PANEL, side of vehicle, rear	L.H.
PANEL, side of vehicle, rear	R.H.
PANEL, ramp door outer	1
PANEL, side of vehicle intermediate door outer	L.H.
BOLT, side and intermediate doors lock rod, upper and lower	A.R.

CONTROL ASSY., side front door lock remote	L.H.
--	------

CONTROL ASSY., side front door lock remote	R.H.
--	------

CONTROL ASSY., side intermediate door lock	L.H.
--	------

CONTROL ASSY., side intermediate door lock	R.H.
--	------

COVER, intermediate and side rear door lock (Note 1)	A.R.
--	------

COVER ASSY., side intermediate and rear	R.H.
---	------

COVER ASSY., side intermediate and rear	L.H.
---	------

EXTENSION, side rear	L.H.
----------------------	------

EXTENSION, side rear	R.H.
----------------------	------

GROMMET, side rear and intermediate door, hinge strap panel	8
---	---

HINGE ASSY., ramp door	1
------------------------	---

INTERLOCK, side rear (body half)	2
----------------------------------	---

INTERLOCK, side rear (door half)	L.H.
----------------------------------	------

INTERLOCK, side rear (door half)	R.H.
----------------------------------	------

KNOB, inside locking rod—(10.559)	1
-----------------------------------	---

KNOB ASSY., side intermediate door lock	1
---	---

LEVER, ramp door safety catch release	1
---------------------------------------	---

NUT, side rear and intermediate door outer bumper assy. (No. 10 spring type)—(7.800)	A.R.
--	------

PAWL, side intermediate door lock cylinder	L.H.
--	------

PIN, side and inter. door lock rod cover bolt (slotted $\frac{3}{16}$ " x $\frac{5}{8}$ ")—(8.939)	A.R.
--	------

REINFORCEMENT ASSY., side intermediate door outside handle	1
--	---

ROD, side intermediate door lock lower	1
--	---

ROD, side intermediate door lock upper	1
--	---

ROD ASSY., left side intermediate and rear, lower	A.R.
---	------

ROD ASSY., right side intermediate and rear, lower	A.R.
--	------

SCREW, side rear door interlock ($\frac{5}{16}$ "—18 x $1\frac{1}{8}$ ")—(8.908)	A.R.
---	------

SCREW, side rear and inter. lock rod cover, upper and lower ($\frac{7}{16}$ "—18 x $\frac{9}{16}$ ")—(16.332)	2
--	---

SPACER, side rear door hinge pillar	1
-------------------------------------	---

SPACER, ramp door lock striker	A.R.
--------------------------------	------

SPRING, side and intermediate doors lock rod, upper and lower	A.R.
---	------

STRIKER, ramp door safety	1
---------------------------	---

rear (used w/o glass)	L.H.
-----------------------	------

rear (used w/o glass)	R.H.
-----------------------	------

rear (used w/glass)	L.H.
---------------------	------

rear (used w/glass)	R.H.
---------------------	------

NUT, rear door outer bumper assy. (No. 10 nylon)—(7.800)	2
--	---

SCREW, rear door outer bumper ($\frac{5}{16}$ "—18 x $1\frac{1}{8}$ ")—(8.024)	2
---	---

side front	L.H.
------------	------

side front	R.H.
------------	------

left, side rear and intermediate	A.R.
----------------------------------	------

right, side rear and intermediate	A.R.
-----------------------------------	------

PANEL ASSY., side front door lower trim (red)	R.H.
---	------

62-63	GREENBRIER w/deluxe equip.	3798071	PANEL ASSY., side front door lower trim (turquoise) . . .	L.H.
64-65	GREENBRIER w/deluxe equip.	3844657	PANEL ASSY., side front door lower trim (turquoise) . . .	L.H.
64-65	GREENBRIER w/deluxe equip.	3844658	PANEL ASSY., side front door lower trim (turquoise) . . .	R.H.
64-65	GREENBRIER w/deluxe equip.	3844762	PANEL ASSY., side intermediate door lower trim (med. fawn) . . .	R.H.
64-65	GREENBRIER w/deluxe equip.	3844764	PANEL ASSY., side intermediate door lower trim (red) . . .	R.H.
64-65	GREENBRIER w/deluxe equip.	3844765	PANEL ASSY., side intermediate door lower trim (turquoise) . . .	L.H.
64-65	GREENBRIER w/deluxe equip.	3844767	PANEL ASSY., side intermediate door lower trim (light green) . . .	L.H.
64-65	GREENBRIER w/deluxe equip.	3844772	PANEL ASSY., side rear door lower trim (med. fawn) . . .	R.H.
64-65	GREENBRIER w/deluxe equip.	3844774	PANEL ASSY., side rear door lower trim (red) . . .	R.H.
64-65	GREENBRIER w/deluxe equip.	3844778	PANEL ASSY., side rear door lower trim (light green) . . .	R.H.
61-65	GREENBRIER w/deluxe equip.	3787311	EYELET, side door and side trim panel . . .	A.R.
61	GREENBRIER w/deluxe equip.	4592059	EYELET, body side rr. trim panel—(14.685) . . .	28
61-65	GREENBRIER w/deluxe equip.	3788817	RETAINER, side front, intermediate and side rear door and body side trim panel . . .	A.R.
61-65	F.C.	3786100	SCREW (cr. rec. 10—24 x $\frac{5}{8}$ ") . . .	A.R.
61-65	F.C.	3773402	SEAL, side front ($\frac{5}{32}$ " x $\frac{3}{8}$ " O.D. x 99" long) (neoprene closed cell tubing)—(16.547) . . .	2
63-65	GREENBRIER		SEAL, side intermediate and side rear door trim.	
63-65	F.C.	3796626	front door inner trim panel . . .	A.R.

16.166 MOULDING ASSY., Door Trim Panel

64-65	GREENBRIER w/deluxe equip.	3844659	side front door lower trim panel . . .	2
64-65	GREENBRIER w/deluxe equip.	3844758	side intermediate door lower trim panel . . .	2

16.167 COVER—PLUG, Door

61-64	PANEL	3784810	side rear and intermediate door lock access hole . . .	A.R.
ALL	ALL	4410574	PLUG, hinge access hole—(12.981) . . .	A.R.

16.173 VENTILATOR ASSY., Front Door

61-65	F.C.	3797907	side . . .	L.H.
61-65	F.C.	3797908	side . . .	R.H.

16.174 GLASS, Front Door Ventilator

61-65	F.C.	3795429	safety . . .	2
-------	------	---------	--------------	---

16.175 RIVET—SASH ASSY.—WEATHERSTRIP, Front Door

64-65	F.C.	9704875	vent. front upper support ($\frac{1}{8}$ ")—(10.669) . . .	2
61-65	F.C. (exc. deluxe equip.)	3779491	SASH ASSY., left, front dr. vent glass . . .	1
61-65	F.C. (exc. deluxe equip.)	3779492	SASH ASSY., right, front dr. vent glass . . .	1
61-65	F.C.	3775861	WEATHERSTRIP, left, front dr. vent glass front . . .	1

16.176 PLATE—HANDLE—PIN—SPRING—STOP—WASHER, Front Door Ventilator

61-65	F.C.	3775860	side locking handle . . .	2
61-65	F.C.	3757725	HANDLE, left, side door ventilator locking . . .	1
61-65	F.C.	3757726	HANDLE, right, side door ventilator locking . . .	1
61-65	F.C.	3697476	PIN, side locking handle retainer . . .	2
61-65	F.C.	3716643	SPRING, side ventilator pivot . . .	2
61-65	F.C.	3762400	STOP, side door ventilator pivot . . .	2
61-65	F.C.	4162192	WASHER, side front door ventilator lower support friction ($\frac{11}{16}$ " O.D. x $\frac{31}{32}$ " I.D.)—(10.660) . . .	4
61-65	F.C.	3696038	WASHER, side front door ventilator locking handle ($\frac{5}{8}$ " O.D. x $\frac{29}{64}$ " I.D.) . . .	2
61-65	F.C.	4162193	WASHER, front door ventilator pivot spring seat ($\frac{11}{16}$ " O.D. w/slotted $\frac{21}{32}$ " dia. hole)—(10.660) . . .	2

16.180 GLASS, Door Window

61-65	F.C.	3789883	side front door (safety) . . .	2
-------	------	---------	--------------------------------	---

61-65	F.C. (exc. PICK-UP)	3773812	rear door window (safety)	2
16.190 CHANNEL ASSY.—BUMPER—FILLER—SASH ASSY.—SEAL, Door Glass Sash				
61-65	GREENBRIER	3822847	right side intermediate and fr. dr. rr. guide, left side intermediate and rr. dr. frt. guide	1
61-65	GREENBRIER	3822848	left side intermediate and rr. dr. rr. guide, right side intermediate and rr. dr. frt. guide	1
61-65	F.C.	3822851	frt. door rear guide	2
61-63	F.C.	3762180	BUMPER, side front door window glass stop—(8.024)	2
ALL	ALL	3830213	FILLER ($3\frac{3}{4}$ " thick—40 ft. roll)—(10.696)	A.R.
ALL	ALL	3830214	FILLER ($1\frac{1}{2}$ " thick—60 ft. roll)—(10.696)	A.R.
61-65	F.C.	3773963	SASH ASSY., side door frong glass lower	L.H.
61-64	F.C. w/laminated glass	3778913	SEAL, side front door glass lower, w/ $15\frac{1}{4}$ — $17\frac{1}{4}$ thickness glass (22 41 / 64 dev. length)	2
61-65	F.C. (exc. laminated glass)	3771998	SEAL, side front door glass lower, w/ $13\frac{1}{4}$ — $15\frac{1}{4}$ thickness glass, side intermediate and side rr. dr. window glass lower, body side front panel	A.R.
61-65	F.C.	3773961	SEAL ASSY., left, side front door window	2
61-65	F.C.	3773962	SEAL ASSY., right, side front door window	2
61-65	GREENBRIER	3776319	SEAL ASSY., side intermediate and side rr. dr. glass, side frt. panel frt. and rr. window glass	A.R.
16.200 RUN ASSY., Door Glass				
61-65	F.C.	3817655	front door rear, center and rear side windows (Note 1)	A.R.
61-65	F.C.	3797911	front door front	2
NOTE 1. It may be necessary to cut to required length using the old part as a template.				
16.225 WEATHERSTRIP, Door Opening				
61-65	F.C. (exc. PICK-UP)	3778077	rear door	L.H.
61-65	F.C. (exc. PICK-UP)	3778078	rear door	R.H.
61-65	F.C. (exc. PICK-UP)	3778375	side intermediate door	1
61-65	F.C. (exc. PICK-UP)	3778376	side rear door	1
61-65	F.C.	3767156	side door inner (cemented to door opening)	2
61-65	F.C.	3769319	side door outer (cemented to door)	2
16.260 REGULATOR—PIN—ROLLER—SPRING, Door Window				
61-65	F.C. (exc. deluxe equip.)	3772781	side front door window	L.H.
61-65	F.C. (exc. deluxe equip.)	3772782	side front door window	R.H.
61-65	GREENBRIER w/deluxe equip.	3787581	side front door window	L.H.
61-65	GREENBRIER w/deluxe equip.	3787582	side front door window	R.H.
61-65	GREENBRIER (exc. deluxe equip.)	3822853	left, side front panel front window and right, side rear and intermediate door window	A.R.
61-65	GREENBRIER (exc. deluxe equip.)	3822854	right, side front panel front window and left, side rear and intermediate door window	A.R.
61-65	GREENBRIER w/deluxe equip.	3827244	side front panel front window, side intermediate and right side rr. door window	A.R.
61-65	GREENBRIER w/deluxe equip.	3827245	side front panel rear window, side intermediate and left side rr. door window	A.R.
65	F.C.	4158246	PIN, regulator roller—(12.195)	A.R.
65	F.C.	4158245	ROLLER(12.195)	A.R.
65	F.C.	4233229	SPRING, counter balance—(10.783)	2
16.261 RAIL, Window Regulator Guide				
61-65	F.C., front door lower,		body side front panel front and rear, side intermediate and side rear door	A.R.
61-65	GREENBRIER	3771999		
16.270 HANDLE ASSY.—ESCUTCHEON—SCREW—WASHER, Door Window				
61-62	F.C.,		side front door window regulator,	
65	F.C.		side front panel front and rear window regulator,	
61-65	GREENBRIER (exc. body side door)		side rear and intermediate door window regulator	A.R.
61-65	GREENBRIER w/body side door	3702184		
61-65	GREENBRIER w/deluxe equip.	3787315	ESCUTCHEON, left or right, side front door, side intermediate door and side rear door window regulator	A.R.

61-65	GREENBRIER w/deluxe equip. (exc. body side door)	3787520
ALL	F.C.	3718951
61-63	F.C.	3817009

16.320 HINGE, Door

61-65	F.C.	3813657
61-65	F.C.	3813653
61-65	F.C. (exc. PICK-UP)	3773722
61-65	F.C. (exc. PICK-UP)	3773716
61-65	F.C. (exc. PICK-UP)	3773724
61-65	F.C. (exc. PICK-UP)	3773726
61-65	F.C. (exc. PICK-UP)	3842361
61-65	F.C. (exc. PICK-UP)	3842362

NOTE 1. When using on the right side remove pin 3718497 and re-install from opposite end, so the position of the head is on top.

16.323 PIN—BUSHING, Door Hinge

61-65	F.C. (exc. PICK-UP)	3773706
61-65	F.C. (exc. PICK-UP)	3776633
61-65	F.C.	3718497
61-65	F.C. (exc. PICK-UP)	3773704
61-65	F.C.	3828536

ESCUTCHEON, left, side front panel window regulator	2
SCREW, window regulator (all locations) (self locking set $\frac{1}{4}$ —20 x $\frac{19}{32}$)	A.R.
WASHER, window regulator (all locations) ($\frac{7}{16}$)	A.R.

side front door upper (Note 1)	A.R.
side front door lower (Note 1)	A.R.
left and right, side rear door upper, side intermediate door upper (body half)	A.R.
left and right, side rear door upper, side intermediate door upper (door half)	A.R.
left and right, side rear door upper, side intermediate door lower (door half)	A.R.
left and right, side rear door lower, side intermediate door lower (body half)	A.R.
left, rear door	2
right, rear door	2

side rear and side intermediate door hinge	A.R.
rear door hinge	4
side front door upper and lower hinge	A.R.
BUSHING, side rear door, intermediate door and rear door hinge	A.R.
BUSHING, side front door upper and lower hinge—(10.464)	A.R.

16.325 GROMMET—BOLT, Door Hinge

61-65	F.C. (exc. PICK-UP)	3779099
61-62	F.C. (exc. PICK-UP)	3762563

rear door hinge	8
BOLT, rear door hinge (hex. hd. $\frac{3}{8}$ —24 x $1\frac{1}{4}$)	A.R.

16.328 TUMBLER UNIT—HOUSING—KEY—RETAINER UNIT—SPRING UNIT, Door Safety Lock

61-65	F.C.	601256
61-65	F.C.	601258
61-65	F.C.	601259
61-65	F.C.	601257
61	F.C. (exc. PICK-UP)	7015601
61-65	F.C.	3694624
61-65	F.C.	601261
61-65	F.C.	601260

(copper)—(10.553)	A.R.
(black)—(10.553)	A.R.
(yellow)—(10.553)	A.R.
(nickel)—(10.553)	A.R.
HOUSING, side intermediate door cylinder—(10.552)	A.R.
KEY, blank (octagon head)—(2.187)	A.R.
RETAINER UNIT (10.553)	A.R.
SPRING UNIT (10.553)	A.R.

16.330 LOCK ASSY.—BUSHING—SPACER—SPRING—SUPPORT ASSY., Door

61-65	F.C.	3776607
61-65	F.C.	3776608
61	F.C.	3799143
61	F.C.	3799144
61-62	F.C. (exc. PICK-UP)	3776342
61-65	F.C. (exc. PICK-UP)	3762280
61-65	F.C. (exc. PICK-UP)	3778391
62-65	F.C. (exc. deluxe equip., PICK-UP)	3813349
62-65	F.C. (exc. deluxe equip., PICK-UP)	3813350
62-65	GREENBRIER w/deluxe equip.	3813361
62-65	GREENBRIER w/deluxe equip.	3813362
62-65	F.C.	3813459
62-65	F.C.	3813460
61-65	F.C.	3796339
61-65	F.C. (exc. PICK-UP)	3773802
62-65	F.C.	4158734
61-65	F.C. (exc. PICK-UP)	3712131

side front door	L.H.
side front door	R.H.
side intermediate door	L.H.
side intermediate door	R.H.
side rear door	R.H.
rear door	L.H.
rear door	R.H.
side rear door	L.H.
side rear door	R.H.
side rear door	L.H.
side rear door	R.H.
side intermediate door	L.H.
side intermediate door	R.H.
BUSHING, side intermediate door lock outside release upper lever	1
SPACER, rear door lock upper and lower striker	A.R.
SPRING, right or left, side intermediate door lock lever—(10.474)	A.R.
SUPPORT ASSY., rear door lock outer	1

16.332 ROD—LEVER—SCREW—SPRING, Rear Door Lock

61-65	F.C. (exc. PICK-UP)	3773798
61-65	F.C. (exc. PICK-UP)	3773799

upper (26 $\frac{13}{16}$ long)	1
lower (10" long)	1

61-65	F.C. (exc. PICK-UP)	3762860
61-65	F.C. (exc. PICK-UP)	3785540
62-65	F.C. (exc. PICK-UP)	3813334
61-65	F.C. (exc. PICK-UP)	3807241

16.333 HANDLE, Door and Side Ramp Lock

61-65	F.C. (exc. PICK-UP)	3807362
61-64	SIDE RAMP	3795795
61-64	SIDE RAMP	3795796

LEVER, w/shaft, left door	1
SCREW, side rear and intermediate door lock assy. (⁵ / ₁₆ —18 x ⁹ / ₁₆)	A.R.
SCREW, side rear door lock assy. (⁵ / ₁₆ —18 x ¹ / ₂)	A.R.
SPRING, left door (¹³ / ₁₆ I.D.)	1

left and right, side rear door inside lock, left, rear door lock	A.R.
HANDLE ASSY., side ramp door lock	L.H.
HANDLE ASSY., side ramp door lock	R.H.

16.335 STRIKER—CATCH ASSY.—PLATE—SCREW—SPACER, Door Lock

61-65	F.C. (exc. PICK-UP)	3773800
61-62	PICK-UP	
61-64	SIDE RAMP	3776370
61-65	F.C. (PICK-UP)	3778599
61-65	F.C.	4664964
61-65	F.C.	4664963
61-65	F.C. (exc. PICK-UP)	3848735
61-64	SIDE RAMP	3789984
61-65	F.C. (exc. PICK-UP)	3776639
61-65	F.C.	4649281
61-65	F.C.	4649282
61-63	F.C.	4676731
61-65	F.C.	4651466
61-65	F.C.	4651465
61-65	F.C.	4670836
61-65	F.C.	4670835
61-65	F.C. (exc. PICK-UP)	3778601
61-65	F.C. (exc. PICK-UP)	3798368

rear door lock upper and lower	2
end gate lock,	
ramp door lock	2
left rear door, center	1
side front door lock—(10.569)	L.H.
side front door lock—(10.569)	R.H.
side rear and intermediate door lock	2
CATCH ASSY., ramp door safety	1
PLATE, side rear, intermediate and rear door check arm striker	A.R.
PLATE, door lock striker adjusting upper—(10.571)	A.R.
PLATE, door lock striker adjusting lower—(10.571)	2
SCREW, door lock striker—(10.570)	A.R.
SPACER, left, side door lock striker (¹ / ₈ " thick)— (10.571)	A.R.
SPACER, right, side door lock striker (¹ / ₈ " thick)— (10.571)	A.R.
SPACER, left, side door lock striker (¹ / ₈ " thick)— (10.571)	A.R.
SPACER, right, side door lock striker (¹ / ₈ " thick)— (10.571)	A.R.
SPACER, left, rear door lock striker—(12.237)	A.R.
SPACER, side rear and intermediate door lock striker	A.R.

16.341 CONTROL—LEVER ASSY.—PLATE ASSY., Door Lock

61-65	F.C. (exc. custom equip.)	3773861
61-65	F.C. (exc. custom equip.)	3773862
61-65	F.C. (exc. PICK-UP)	3817811
61-65	F.C. (exc. PICK-UP)	3817812
61	F.C. (exc. PICK-UP)	3781920
62-65	F.C. (exc. PICK-UP)	3813469
62-65	F.C. (exc. PICK-UP)	3813470
61-65	F.C.	3778317

side front door lock remote	L.H.
side front door lock remote	R.H.
side intermediate door lock remote	L.H.
side intermediate door lock remote	R.H.
LEVER ASSY., side intermediate door lock	A.R.
LEVER ASSY., side intermediate door lock remote	L.H.
LEVER ASSY., side intermediate door lock remote	R.H.
PLATE ASSY., side front and side intermediate lock remote control mtg.	A.R.

16.345 HANDLE—ESCUTCHEON—SCREW—WASHER, Door

61-65	F.C.	3848873
61-65	GREENBRIER w/deluxe equip.	3787316
ALL	F.C.	3718951
61-63	F.C.	3817009

side front, rear and intermediate door lock remote control	A.R.
ESCUTCHEON, left or right, side front door and side intermediate door lock remote control	A.R.
SCREW, side front and intermediate door lock remote control handle (sl. hd. ¹ / ₄ "—20 x ¹⁹ / ₃₂ ")—(16.270)	A.R.
WASHER, side front and intermediate door lock remote control handle (¹⁵ / ₂ " I.D. x ¹⁷ / ₈ " O.D.)—(16.270)	A.R.

16.350 HANDLE—ESCUTCHEON—GASKET—RETAINER—SCREW, Door Lock Outside

61-65	F.C.	3773917
61-65	F.C.	
61-65	F.C. (exc. PICK-UP)	3773918
61-64	F.C. (exc. PICK-UP)	3776251
61	F.C. (exc. PICK-UP)	4587931
61	F.C. (exc. PICK-UP)	3776252
61-65	F.C. (exc. PICK-UP)	4168122
61-65	F.C.	4577250
61-65	F.C. (exc. PICK-UP)	3842459

side front door outside	L.H.
right, side front door outside,	
right, rear door outside	A.R.
ESCUTCHEON, side intermediate door lock locking lever	2
GASKET, side intermediate door lock cylinder—(12.249)	A.R.
RETAINER, side intermediate door lock locking lever escutcheon	2
RETAINER, side intermed. door outside handle— (10.513)	A.R.
SCREW, side front door outside handle rear door outside handle (¹ / ₄ "—20 x ⁵ / ₈ ")—(12.242)	A.R.
SCREW, side rear door and rear door lock safety (¹ / ₄ "— 28 x ¹⁷ / ₃₂ ")—(10.540)	A.R.

16.353 ESCUTCHEON—GASKET—RETAINER—RING—SEAT—SPRING—STOP—TRUNNION, Door Outside Handle

61-65	F.C. (exc. PICK-UP)	3778035	side intermediate rear door outside handle	L.H.
61-65	F.C. (exc. PICK-UP)	3778036	side intermediate door outside handle	R.H.
61-65	F.C.	3784051	GASKET, left side front	A.R.
61-65	F.C.	3773916	GASKET, side front door handle rear, rear door outside handle	A.R.
63-65	F.C.,			
61-64	F.C. (exc. PICK-UP)	3784052	GASKET, right side front, rear door outside handle front	A.R.
61-65	F.C. (exc. PICK-UP)	3778032	GASKET, left or right, side intermed. door outside handle	A.R.
61	F.C. (exc. PICK-UP)	4755272	RETAINER, side intermediate door lock cylinder gasket—(10.551)	A.R.
61-65	F.C.,			
61	F.C. (exc. PICK-UP)	7015683	RETAINER, side front door lock stop ring, side intermediate door lock cylinder pawl—(10.551)	A.R.
61-65	F.C. (exc. PICK-UP)	4168353	RETAINER, rear door lock stop ring—(10.529)	A.R.
61-65	F.C.	4168356	RING, side front and rr. door lock outside handle pushbutton seal	A.R.
61-65	F.C.	3698886	SEAT, side door and rear door outside handle pushbutton spring ($1\frac{1}{2}$ I.D. x 1 O.D.)	A.R.
61-65	F.C. (exc. PICK-UP)	3778037	SPRING, left or right, side intermediate door outside handle seat	A.R.
61-65	F.C.	3698885	SPRING, side door and rear door outside handle pushbutton	A.R.
61	F.C. (exc. PICK-UP)	3788623	SPRING, side intermed. door lock handle return	2
62-65	F.C.	3813466	SPRING, side intermediate door lock outside handle return	2
61-65	F.C.	3698887	STOP, side door and rear door lock outside handle pushbutton	A.R.
61-65	F.C. (exc. PICK-UP)	3776243	TRUNNION, side intermediate and rear door lock rod	A.R.

16.360 HANDLE, Door Outside

61-65	F.C. (exc. PICK-UP)	3796368	side intermediate door	R.H.
61-65	F.C. (exc. PICK-UP)	3796367	side intermediate door	L.H.

16.365 CYLINDER ASSY.—CYLINDER UNIT, Door Outside

61-65	F.C.	3783484	side front and rear door outside handle (Note 1)	A.R.
NOTE 1. Cut 1" from end of shaft on all doors.				
61	F.C. (exc. PICK-UP)	3888860	CYLINDER UNIT, side intermediate door lock—(10.550)	A.R.

16.370 SLEEVE—CAP, Door Outside Handle Lock Cylinder

61-65	F.C.	7018370	right, front and rear	A.R.
65	F.C.	7018374	left, front, side and rear door	A.R.
61-65	F.C.	7018371	CAP, front side, rear door—(10.552)	A.R.

16.400 BUMPER—SPACER, Door

61-65	F.C. (exc. PICK-UP)	3796366	side intermediate door outer door handle ($1\frac{13}{16}$ O.D. x $1\frac{15}{16}$ long)	A.R.
61-65	F.C.	3900684	side door rear upper ($\frac{33}{64}$ I.D. x $\frac{3}{4}$ O.D.)	2
61-63	F.C.	4565415	side door rear lor—(10.587)	2
61-65	GREENBRIER	3711168	body side front and rear window glass, body side rear and intermediate door window glass stop ($\frac{9}{16}$ dia. x $\frac{1}{2}$ long)	A.R.
61-64	F.C. (exc. PICK-UP) (2nd design)	3812749	rear door outer	2
61-65	F.C. (exc. PICK-UP) (1st design)	3785718	BUMPER ASSY., side rear, side intermediate and rear door outer ($1\frac{17}{16}$ I.D. x 1 O.D.)	A.R.
61-65	F.C. (exc. PICK-UP)	3776353	BUMPER ASSY., side rear, side intermediate and rear door ($1\frac{3}{8}$ x $1\frac{5}{8}$ w/2 holes)	A.R.
61-65	F.C. (exc. PICK-UP)	3778721	SPACER, side rear, intermediate and rear door bumper (1 x $\frac{5}{8}$ " w/two $\frac{19}{64}$ " dia. holes) (Note 1)	A.R.

NOTE 1. Attaching holes are $\frac{19}{64}$ " dia. spaced $\frac{3}{4}$ " in. center to center.

16.430 BRACKET ASSY.—RETAINER—SEAL, Door

61-62	F.C. (exc. PICK-UP),		w/arm rear door check	2
63-65	GREENBRIER, PANEL	3785743		
61-62	F.C. (exc. PICK-UP),		side rear and intermediate door check arm, side intermediate and side rear door check, left or right	A.R.
63-65	GREENBRIER, PANEL	3785740		
61-62	F.C. (exc. PICK-UP),		RETAINER, side rear and intermediate door check arm seal	A.R.
63-65	GREENBRIER	3776641		
61-62	F.C. (exc. PICK-UP),			

63-65	GREENBRIER	3776640	SEAL, side rear and intermediate check arm	A.R.
16.437 ARM—PIN, Door Check				
61-65	F.C.	3813660	side front door check, w/guide	2
61-65	F.C.	3850740	PIN, side front door arm ($3\frac{1}{8}$ dia. x $9\frac{1}{16}$ long)	2
16.440 BRACKET, Door Check				
61-65	F.C.	3773478	side front door arm to hinge pillar ($1\frac{1}{4}$ x $1\frac{17}{64}$)	2
16.464 GLASS, Back Window				
61-65	PICK-UP	3879068	solid safety	1
16.469 WEATHERSTRIP—RETAINER, Rear Corner Window				
Not required in this group.				
See group 16.470				
61-65	F.C.	3847414	(rubber—50 ft. roll)	
		3847415	RETAINER (rubber—50 ft. roll)—(16.471)	A.R.
16.470 WEATHERSTRIP, Back Window Glass				
61-64	PICK-UP	3847414	(rubber—50 ft. roll)—(16.469)	A.R.
61-65	F.C. (exc. PICK-UP)	3778347	rear door window—(17.190)	2
16.471 RETAINER, Back Window Glass Weatherstrip				
61-65	F.C.	3847415	(rubber—50 ft. roll)	A.R.
16.494 LAMP ASSY.—SWITCH ASSY., Dome and Courtesy				
61-65	F.C.	2986057	dome (w/cable assy.)	1
61-65	GREENBRIER	4826444	SWITCH ASSY., door jamb—(11.950)	A.R.
63	F.C.	4891633	SWITCH ASSY., door jamb (use w/985574)—(11.950)	1
16.495 LENS—CLIP, Dome Lamp				
61-65	F.C.	2973210	(plastic— $6\frac{3}{16}$ O.L.)	1
61-65	F.C.	2973324	CLIP, wire and bulb	A.R.
16.507 PANEL—FILLER—PILLAR ASSY., Door Hinge				
61-65	F.C.	3777693	front door pillar trim	L.H.
61-65	F.C.	3777694	front door pillar trim	R.H.
61-65	F.C.	3774756	FILLER, front door pillar to outer rocker panel	L.H.
61-65	F.C.	3774756	FILLER, front door pillar to outer rocker panel	R.H.
61-65	F.C.	3775001	PILLAR ASSY., front door (Note 1)	L.H.
61-65	F.C.	3775002	PILLAR ASSY., front door (Note 1)	R.H.
NOTE 1 When using 3775001-2 PILLAR ASSY. on early 1961 models remove drip mouldings.				
16.520 PANEL—PILLAR ASSY.—REINFORCEMENT, Door Body Lock				
61-65	F.C. (exc. PICK-UP)	3772089	front door lock pillar outer	L.H.
61-65	F.C. w/body side door	3784967	PILLAR ASSY., body side front door lock	L.H.
61-65	F.C. (exc. PICK-UP)	3784968	PILLAR ASSY., body side front door lock	R.H.
61-64	SIDE RAMP	3778252	PILLAR ASSY., side ramp door lock rear	R.H.
61-64	SIDE RAMP	3778430	PILLAR ASSY., body side ramp door lock front	L.H.
61-65	F.C. (exc. PICK-UP)	3779237	REINFORCEMENT ASSY., body side front door lock pillar lower	L.H.
16.544 SUPPORT, Toe Panel				
61-65	F.C.	3789792		L.H.
16.545 PANEL—BRACKET—BRACE ASSY.—MEMBER ASSY.—OUTRIGGER—PLATE—RAIL ASSY.—RETAINER ASSY.—SILL ASSY.—STRAINER—STRIP ASSY., Floor Board				
61-65	F.C.	3838729	loading	1
61-65	F.C.	3781989	PANEL ASSY., rear seat riser floor	1
61-65	F.C.	3774557	PANEL ASSY., body rear	1
61-65	F.C.	3786498	PANEL ASSY., engine compartment floor	1
61-65	F.C.	3844955	PANEL ASSY., front seat riser (Note 1)	1
NOTE 1. When using on some models it will be necessary to provide hole for transmission linkage.				
61-65	F.C.	3844968	PANEL ASSY., front floor (Note 2)	1
NOTE 2 Models prior to 1964 require use of one brake main cylinder access hole cover 3844970.				
61-63	F.C.	3776813	BRACKET, engine rear mounting crossmember—(7.011)	1
64-65	F.C.	3848811	BRACE ASSY., engine rear mounting crossmember—(7.011) (Note 3)	1
61-65	F.C.	3856870	MEMBER ASSY., engine upper and lower, cross w/door sill—(7.011)	1
61-65	F.C.	3783226	OUTRIGGER, side rail No. 3	R.H.
61-65	F.C. (exc. P.G.)	3820704	PLATE, front underbody to rear underbody	2
61-65	F.C.	3848410	RAIL ASSY., side front	R.H.

61-64	SIDE RAMP	3778815	RETAINER ASSY., underbody nut front	1
61-64	SIDE RAMP	3778819	RETAINER ASSY., underbody nut intermediate	1
61-65	F.C.	3848809	SILL ASSY., rear door	1
61-65	F.C.	3858293	STRAINER, rear door sill front	2
61-65	F.C.	3782298	STRIP ASSY., rear suspension cross member support	2

NOTE 3. When using this assy. on Greenbrier and Panel models plug the 2 hinge slots in the rear face of rear door sill.

16.546 SUPPORT ASSY., Engine Compartment

61-65	F.C.	3774804	floor panel	R.H.
-------	------	---------	-------------	------

16.547 COVER—CATCH—CHECK ASSY.—DOOR—GASKET—HANDLE—HINGE ASSY.—LATCH ASSY.—LOCK ASSY.—PLUG—SEAL—SPRING, Inspection

61-62	F.C. (1st design)	592865	brake main cylinder access hole—(12.980)	11
64-65	F.C.	3844970	brake main cylinder access hole	1
62-64	F.C. (2nd design)	3817988	brake main cylinder access hole	1
61-63	F.C. w/air	3786099	COVER ASSY., heater hole—(8.845)	1
61-65	F.C.	3848806	CATCH, engine access door lock striker	1
61-65	F.C.	3783222	CATCH ASSY., battery access door	1
61-65	F.C.	3838704	CHECK ASSY., engine access door	2
64-65	F.C.	3848746	DOOR, engine access	1
61-63	F.C.	3819229	DOOR ASSY., engine access (Note 1)	1
NOTE 1. When using in place of 3812713, check assy. 3838704 must also be used.				
61-65	F.C.	3783386	GASKET, engine access door lock	1
64-65	F.C.	3848805	HANDLE, engine access door—(8.080)	1
64-65	F.C.	3848799	HINGE ASSY., engine access door	1
61-63	F.C.	3783385	LATCH ASSY., w/handle, engine access door—(8.080)	1
64-65	F.C.	3848802	LOCK ASSY., engine access door—(8.080)	1
ALL	ALL	4410574	PLUG, hinge access hole—(12.981)	A.R.
61-65	F.C.	3774797	SEAL, engine compartment floor panel and filler, frt. side and rear (41 ¹ / ₂ " long—rubber) (Note 2)	A.R.
61-65	F.C.	3773402	SEAL, body side rr. inner frt. upper panel (5 ⁵ / ₁₆ I.D. x 3 ³ / ₈ O.D. x 99 long) (neoprene closed cell tubing)	A.R.
61-62	F.C.	4308736	SPRING, motor compartment door latch bolt—(8.080)	1
61-62	F.C.	4308737	SPRING, motor compartment door handle lever—(8.080)	1

NOTE 2. Cut to required length.

16.548 HINGE—HANDLE—RETAINER ASSY.—SEAL—SPRING—STRIKER, Battery Access Door

61-65	F.C.	3781090	(11 ³ / ₄ " long)	1
61-65	F.C.	3781082	HANDLE, lock (11 ¹ / ₆₄ dev. length)	1
61-65	F.C.	3781084	RETAINER ASSY., lock (2 ⁷ / ₃₂ w/two 19 ¹⁹ / ₆₄ dia. holes)	1
61-65	F.C.	3781092	SEAL, door to panel (38 ⁵ / ₁₆ long)	1
61-65	F.C.	3781089	SPRING, lock (7 ⁷ / ₁₆ dia. x 1 ²¹ / ₃₂ long)	1
61-65	F.C.	3781087	STRIKER, lock (1 ⁷ / ₁₆ x 1 ¹ / ₂)	1

16.550 PANEL—EXTENSION ASSY.—REINFORCEMENT—SHIELD, Dash and Toe

61-65	F.C.	3769921	body front outer	L.H.
61-65	F.C.	3769922	body front outer	R.H.
61-65	F.C.	3844816	PANEL ASSY., toe (Note 1)	1
61-65	F.C.	3844798	PANEL ASSY., body front center	1
61-65	F.C.	3844797	PANEL ASSY., body front (complete) (Note 1 & 2)	1
61-65	F.C.	3844996	PANEL ASSY., dash	1
61-65	F.C.	3774886	EXTENSION ASSY., body front outer panel	R.H.
61-65	F.C.	3844801	EXTENSION ASSY., body front outer panel	L.H.
61-65	F.C.	3789793	REINFORCEMENT, toe panel	1
64-65	F.C.	3860759	SHIELD, front end splash	1

NOTE 1. Models prior to 1964 require rework of the accelerator control.

NOTE 2. 1961 models require use of 1964 w/w motor or reworking of the 1961 motor.

If 1964 motor is used the two lead wires must be interchanged at the harness assy. connector.

16.551 PANEL—GRILLE—OUTLET ASSY.—REINFORCEMENT—SPACER, Cowl Side

61-65	F.C.	3776807	plenum outer	L.H.
61-65	F.C.	3776808	plenum outer	R.H.
61-65	F.C.	3844830	plenum center	1
61-65	F.C.	3774867	GRILLE, ventilator outlet	L.H.
61-65	F.C.	3774868	GRILLE, ventilator outlet	R.H.
61-65	F.C.	3774864	OUTLET ASSEMBLY, panel air	2
61-65	F.C.	3789794	REINFORCEMENT, toe panel support	1
61-64	F.C.	3789795	SPACER (1 ¹ / ₂ " dia. hole—1 ¹ / ₈ " thick)—(6.509) (Note 1)	1

NOTE 1. Use w/3789794 reinforcement added to bolt hole area of L.H. toe panel support.

16.553 MOULDING, Front Door

62-65	F.C.	3813681	hinge pillar drip	2
-------	------	---------	-------------------	---

16.585 PANEL—FILLER—RAIL ASSY., Roof

61-64	PICK-UP	3770279	top	1
61-65	F.C.	3775508	front trim	1
61-65	GREENBRIER w/deluxe equip.	3788983	FILLER, bow ($5/8$ dial x 49 long x $1/8$ thick)	12
61-64	PICK-UP,			
65	F.C.	3775487	RAIL ASSY., front.	1

16.603 PANEL—PLATE—SILL ASSY., Front Intermediate

61-65	F.C.	3769946	front outer front rocker	R.H.
61-65	F.C.	3777857	PANEL ASSY., front outer rocker	L.H.
61-65	F.C.	3777858	PANEL ASSY., front outer rocker	R.H.
61-65	F.C.	3775782	PLATE, front door opening front scuff	R.H.
61-65	F.C.	3796424	SILL ASSY., rear underbody intermediate cross	1

16.670 SEAT UNIT, Auxiliary

64	PANEL w/deluxe equip.	3847849	complete (beige and red)	1
64	PANEL w/deluxe equip.	3847850	complete (beige and med. fawn)	1
64	PANEL (exc. deluxe equip.)	3847851	complete (fawn and lt. fawn)	1

16.170ASEAT UNIT, Front

64	GREENBRIER	3847844	complete (lt. and med. fawn)	1
----	------------	---------	------------------------------	---

16.674 BRACKET—SUPPORT, Auxiliary Seat

62-64	PANEL	3816417	hinge lower	2
62-64	PANEL	3816418	hinge upper	2
62-64	PANEL	3816419	SUPPORT, rear	1

16.679 FRAME ASSY.—BOLT—NUT—SCREW ASSY., Seat

61-65	F.C.	3775195	front seat bottom, full width w/spring	1
61-63	F.C. (exc. PANEL)	3775196	front seat back cushion, full width w/spring	1
64-65	F.C.	3844896	front seat back cushion, full width w/spring	1
61-63	PANEL		BOLT, driver and aux. seat back adjusting,	
61-65	F.C.	3778535	front seat back adjusting ($5/16$ —18 x $7/8$)	A.R.
62-63	PANEL w/full width seat	3789438	NUT, aux. seat lower brkt. to floor panel ($5/16$ —18) (2 holed tapping plate)—(7.238)	1
61-65	F.C.	3778537	SCREW ASSY., seat back and rear leg ($3/8$ —16 x $3/8$)	A.R.

16.682 ADJUSTER ASSY.—BOLT—SPRING—SUPPORT ASSY.—RETAINER—ROD, Seat

61-65	F.C.	3776729		L.H.
61-65	F.C. w/full width seat	3776730		R.H.
61-64	PANEL (exc. full width seat)	3776768		R.H.
62-65	F.C.	3788988	BOLT, driver and front seat back bumper	2
61-65	F.C.	3719849	SPRING, adjuster return ($11^{51}/64$ free length)	1
61-65	F.C. (exc. PANEL),			
61-64	PANEL w/full width seat	3776743	SPRING, adjuster locking rod ($7^{3}/4$ free length)	1
61-65	F.C.	3775020	SUPPORT ASSY., front seat track rear	1
61-65	F.C.	3777707	SUPPORT ASSY., front seat track front	A.R.
61-65	F.C.	3787962	RETAINER, seat adjustment front support	2
61-64	PANEL		RETAINER, driver and aux. seat back cushion spring and frame assy. adj.,	
61-65	F.C. (exc. PANEL)	3788990	front seat back cushion spring and frame assy.	A.R.
64-65	F.C. w/full width seat	3776742	ROD, locking ($37^{19}/64$ long)	1

16.714 BELT ASSY.—BOLT—HOOK—NUT—PLATE ASSY.—RETRACTOR UNIT—SEALER—WASHER, Seat

NOTE Components of Seat Belt Assemblies are not available separately. To comply with specified safety standards, it is not recommended that integral retractors,

buckles and inserts which are sewn into the belt be removed and replaced.

Both right and left hand seat belt sections should be replaced as a unit. Many designs of metal inserts and buckles may look alike, may "false-latch" one into the other

(without the specified strain), but are not interchangeable.

64	F.C.	3957807	driver and pass. (black)—(14.875)	A.R.
64	F.C.	3957843	driver and pass. (fawn)—(14.875)	A.R.
64-65	F.C.	3957864	front third seat rear, supplementary (black)	1
64-65	F.C.	3957862	front—(14.875)	2
	Not required in this group.			
	See group 14.875			
	3957866			
	Not required in this group.			
	See group 14.875			
	3957869			
	Not required in this group.			
	See group 14.875			
	3957885			
62-63	GREENBRIER	3814733	BOLT ($7^{1}/8$ —20 x $27/32$)—(14.875)	2

64-65	F.C.	3828745
64-65	F.C.	3841314
64-65	F.C.	3870527
61	F.C.	4840719
60-66	CORVAIR	3866766
62-65	GREENBRIER	4496146
64-65	F.C.	986068
64-65	ALL	3841316

BOLT ($7/16"$ —20 x $1\frac{3}{8}"$)—(14.875)	A.R.
BOLT ($7/16"$ —20 x $1\frac{1}{4}"$)—(14.875)	A.R.
BOLT ASSY., front st. belt assy. ($7/16$ x $2\frac{1}{32}$)	4
HOOK (chrome) seat and coat—(15.388)	2
NUT, floor panel bolt—(0.626)	A.R.
PLATE ASSY., front wheelhouse seat belt anchor—(14.875)	2
RETRACTOR UNIT, seat belt—(14.875)	1
SEALER—(14.875)	A.R.

16.715 CUSHION ASSY.—BRACKET—LEG ASSY.—PLATE—REINFORCEMENT, Seat Bottom

62	GREENBRIER w/deluxe equip.	3815636
62	GREENBRIER w/deluxe equip.	3815718
63	PANEL (exc. deluxe equip.)	3831501
63	GREENBRIER (exc. deluxe equip.)	3831537
63	GREENBRIER (exc. deluxe equip.)	3831570
63	PANEL w/deluxe equip.	3831579
64	PANEL w/deluxe equip. (exc. full width seat)	3846919
64	PANEL, SIDE RAMP w/full width seat (exc. deluxe equip.)	3846921
64	GREENBRIER (exc. deluxe equip.)	3846922
64-65	GREENBRIER w/deluxe equip.	3846925
64-65	GREENBRIER w/deluxe equip.	3846926
64-65	GREENBRIER w/deluxe equip.	3846927
64-65	GREENBRIER w/deluxe equip.	3846930
64-65	GREENBRIER w/deluxe equip.	3846931
64-65	GREENBRIER w/deluxe equip.	3846932
64-65	GREENBRIER w/deluxe equip.	3846933
64	PANEL (exc. deluxe equip.)	3847750
64	PANEL w/deluxe equip.	3847752
64	PANEL w/deluxe equip.	3847753
65	F.C.	3867774
61-65	GREENBRIER (2nd design)	3814168
61-65	GREENBRIER	3778523
61-65	GREENBRIER	3778515
61-65	GREENBRIER	3778516
61-65	GREENBRIER	3814170
61-65	GREENBRIER	3814169
61-65	F.C.	3787963
61-65	F.C.	3787964

front (turquoise)	1
center or supplementary (fawn and med. fawn)	1
auxiliary (lt. and med. fawn)	1
front (lt. and med. fawn)	1
center or supplementary (lt. and med. fawn)	1
auxiliary (beige and med. fawn)	1
driver (beige and med. fawn)	1
front (lt. and med. fawn)	1
front (lt. and med. fawn)	1
front (turquoise)	1
front (lt. green)	1
front (med. fawn)	1
rear and supplementary (red)	1
rear and supplementary (turquoise)	1
rear and supplementary (med. fawn)	1
rear and supplementary (lt. green)	1
auxiliary (lt. and med. fawn)	1
auxiliary (beige and med. fawn)	1
auxiliary (beige and red)	1
rear and supplementary (lt. and med. fawn)	1
BRACKET, supplementary seat mounting ($3\frac{5}{16}$ wide w/four $2\frac{3}{64}$ dia. holes)	2
LEG ASSY., rear center seat	1
LEG ASSY., left, supplementary seat and center seat front	A.R.
LEG ASSY., right, supplementary seat and center seat front	A.R.
PLATE, rear seat leg anchor ($1\frac{3}{64}$ x $8\frac{1}{64}$ w/two $2\frac{3}{64}$ dia. holes and two slotted holes)	4
PLATE, supplementary seat leg anchor ($1\frac{3}{64}$ x $4\frac{7}{8}$ w/two $2\frac{3}{64}$ dia. holes)	2
REINFORCEMENT, front wheelhouse to front seat riser front	L.H.
REINFORCEMENT, front wheelhouse to front seat riser front	R.H.

16.716 BUMPER—CLIP—NUT—RING, Seat

61	F.C.	3792828
61-65	F.C.	3722217
61-63	GREENBRIER	142745
ALL	ALL	4556605

driver and front seat back cushion ($7/8"$ dia. x $7/16"$ thick)—(8.024)	A.R.
CLIP, cushion retainer	A.R.
NUT, rear seat hold down bolt ($5/16"$ —18) (wing type)—(8.920)	A.R.
RING, hog	A.R.

16.717 TRIM ASSY., Seat Cushion

61	GREENBRIER w/deluxe equip.	3786812
61	GREENBRIER (exc. deluxe equip., TAXI)	3784533

front (green and silver)	1
supplementary or center (dark gray)	1

63	PANEL (exc. deluxe equip.)	3794602
64	GREENBRIER (exc. deluxe equip.)	3833882
64	PANEL (exc. deluxe equip.)	3833890
64	PANEL w/full width seat, (exc. deluxe equip.)	
64	SIDE RAMP (exc. deluxe equip.)	3833894
64	PANEL w/deluxe equip., full width seat,	
64	SIDE RAMP w/deluxe equip.	3842125
64	PANEL w/deluxe equip., full width seat,	
64	SIDE RAMP w/deluxe equip.	3842131
64-65	GREENBRIER w/deluxe equip.	3842137
64-65	GREENBRIER w/deluxe equip.	3842143
64-65	GREENBRIER w/deluxe equip.	3842233
64-65	GREENBRIER w/deluxe equip.	3842251
64-65	GREENBRIER w/deluxe equip.	3844525
64-65	GREENBRIER w/deluxe equip.	3844531
65	F.C. (exc. deluxe equip.)	3865412
65	F.C.	3865414

16.720 CUSHION ASSY., Seat Back

61	GREENBRIER w/deluxe equip.	3788241
62	GREENBRIER (exc. deluxe equip.)	3815690
62	GREENBRIER w/deluxe equip.	3815715
63	GREENBRIER	3831538
63	GREENBRIER (exc. deluxe equip.)	3831571
63	GREENBRIER w/deluxe equip.	3831828
64	PANEL (exc. deluxe equip.)	3847726
64	PANEL w/deluxe equip. (exc. full width seat)	3847727
64	PANEL w/deluxe equip. (exc. full width seat)	3847728
64	GREENBRIER	3847729
64	SIDE RAMP,	
64	PANEL w/full width seat (exc. deluxe equip.)	3847730
64	F.C. w/deluxe equip., full width seat	3847731
64	F.C. w/deluxe equip., full width seat	3847732
64-65	GREENBRIER w/deluxe equip.	3847734
64-65	GREENBRIER w/deluxe equip.	3847735
64-65	GREENBRIER w/deluxe equip.	3847738
64-65	GREENBRIER w/deluxe equip.	3847740
64-65	GREENBRIER w/deluxe equip.	3847741
65	F.C.	3867771
65	F.C. (exc. deluxe equip.)	3867772

16.724 TRIM ASSY., Seat Back

61	F.C. w/full width seat (exc. deluxe equip.)	3784516
62	GREENBRIER w/deluxe equip.	3797648
63	GREENBRIER (exc. deluxe equip.)	3824958
63	PANEL w/deluxe equip. (exc. full width seat)	3825555

auxiliary (lt. and med. fawn)	1
front (lt. and med. fawn)	1
driver (lt. and med. fawn)	1
front (lt. and med. fawn)	1
front (beige and med. fawn)	1
front (beige and red)	1
front (turquoise)	1
front (lt. green)	1
rear and supplementary (med. fawn)	1
rear and supplementary (lt. green)	1
front (med. fawn)	1
front (red)	1
front (lt. and med. fawn)	1
rear and supplementary (lt. and med. fawn)	1

front (blue and silver)	1
center or supplementary (med. fawn and multi-colored)	1
center or supplementary (turquoise and green)	1
front (lt. and med. fawn) (vinyl)	1
center or supplementary (lt. and med. fawn)	1
center or supplementary (beige and med. fawn)	1
driver or auxiliary (lt. and med. fawn)	1
driver or auxiliary (beige and med. fawn)	1
driver or auxiliary (beige and red)	1
front (lt. and med. fawn)	1
front (lt. and med. fawn)	1
front (beige and med. fawn)	1
front (beige and red)	1
front (turquoise)	1
front (med. fawn)	1
rear or supplementary (red)	1
rear or supplementary (med. fawn)	1
rear or supplementary (lt. green)	1
rear and supplementary (lt. and med. fawn)	1
front (lt. and med. fawn)	1

front	1
center or supplementary (turquoise and green)	1
rear or supplementary (lt. and med. fawn)	1
driver or auxiliary (beige and med. fawn)	1

63	PANEL w/deluxe equip. (exc. full width seat)	3825566	driver or auxiliary (beige and red)	1
63	GREENBRIER w/deluxe equip.	3825598	front (turquoise)	1
63	GREENBRIER w/deluxe equip.	3825609	front (turquoise and green)	1
63	GREENBRIER w/deluxe equip.	3825622	center or supplementary (beige and fawn)	1
63	GREENBRIER w/deluxe equip.	3825647	center or supplementary (turquoise and green)	1
64	GREENBRIER	3833884	front (lt. and med. fawn)	1
64	SIDE RAMP w/deluxe equip.			
64	PANEL w/deluxe equip., full width seat	3852750	front (beige and red)	1
64-65	GREENBRIER w/deluxe equip.	3842169	front (turquoise)	1
64	PANEL w/deluxe equip. (exc. full width seat)	3852752	driver or auxiliary (beige and med. fawn)	2
64-65	GREENBRIER w/deluxe equip.	3842259	rear or supplementary (med. fawn)	1
64-65	GREENBRIER w/deluxe equip.	3842269	rear or supplementary (red)	1
64-65	GREENBRIER w/deluxe equip.	3844505	front (med. fawn)	1
64-65	GREENBRIER w/deluxe equip.	3844515	front (red)	1
65	F.C. (exc. deluxe equip.)	3865413	front (lt. and med. fawn)	1
65	F.C.	3865415	rear and supplementary (lt. and med. fawn)	1

16.742 PAD—PANEL—REINFORCEMENT, Top Lining

61-66	F.C.	3885867	front trim (vinyl coated, jute felt web grain) (30 ³ / ₆₄ x 49) (Note 1 & 2)	A.R.
-------	--------------	---------	---	------

NOTE 1 Used on models w/o front roof bow.

NOTE 2 Cut as required.

61-65	F.C. (exc. PICK-UP)	3818138	front, intermediate and rear (vinyl coated, jute felt—web grain) (Note 3)	A.R.
-------	-------------------------------	---------	--	------

NOTE 3 Cut to required shape. Used on models w/front roof bow.

61-65	F.C. (exc. PICK-UP)	3776827	PANEL, roof side rear trim	1
61-65	F.C.	3775580	PANEL, windshield header inner	1
61-65	F.C.	3772797	PANEL, windshield header outer	1
61-65	F.C. (exc. PICK-UP)	3786849	PANEL, roof side front trim	L.H.
61-65	F.C. (exc. PICK-UP)	3786850	PANEL, roof side front trim	R.H.
61-65	F.C. (exc. PICK-UP)	3775511	PANEL, roof side rear corner trim	L.H.
61-65	F.C. (exc. PICK-UP)	3775512	PANEL, roof side rear corner trim	R.H.
61-65	F.C. (exc. PICK-UP)	3776825	PANEL ASSY., roof side rear trim	L.H.
61-65	F.C. (exc. PICK-UP)	3776826	PANEL ASSY., roof side rear trim	R.H.

16.760 FELT, Cushion and Back

62-63	F.C.	3829935	insulator (35" x 100 yds. long)—(15.492) (Note 1)	A.R.
-------	--------------	---------	---	------

NOTE 1 This part number consists of 1 yd. of felt, to be furnished in a 100 yd. roll.

16.790 EXTENSION—PANEL—PLATE—SEAL, Body Side

61-65	F.C.	3779961	front outer rear rocker panel reinforcement	L.H.
61-65	F.C.	3779962	front outer rear rocker panel reinforcement	R.H.
61-64	SIDE RAMP	3778816	underbody closing panel front	R.H.
61-63	SIDE RAMP	3785444	PANEL, underbody closing	R.H.
61-63	F.C. w/left body side door,			
64-65	F.C. (exc. SIDE RAMP)	3844981	PANEL ASSY., body side rocker	L.H.
61-65	F.C. (exc. PICK-UP, left body side door)	3774957	PANEL ASSY., body side inner rocker	L.H.
61-65	F.C.	3776802	PANEL ASSY., front inner front rocker	R.H.
61-64	SIDE RAMP	3784932	PANEL ASSY., rocker	R.H.
61-65	F.C.	3844809	PANEL ASSY., front inner front rocker	L.H.
61-65	F.C. (exc. PICK-UP)	3844982	PANEL ASSY., body side rocker	R.H.
61-65	F.C.	3775783	PLATE, front door opening rear scuff	L.H.
61-65	F.C.	3775784	PLATE, front door opening rear scuff	R.H.
61-65	GREENBRIER	3781519	PLATE, side intermediate door scuff	1
61-65	GREENBRIER	3773402	SEAL, body side rear inner trim front upper panel (⁵ / ₃₂ " I.D. x ³ / ₈ " O.D. x 99 long) (neoprene closed cell tubing)—(16.547)	A.R.
63-65	GREENBRIER		SEAL, side-intermediate and side rear door trim,	
64-65	F.C.	3796626	front door inner trim panel	A.R.

16.800 MAT—INSULATOR—PAD, Floor and Toe

61-63	F.C. (exc. deluxe equip. heater)	3833992	panel (black)	1
61-65	GREENBRIER (exc. TAXI, deluxe equip.)	3781460	rear floor (black)	1
65	F.C. (exc. deluxe equip.)	3844885	panel (black)	1
64-65	GREENBRIER w/deluxe equip.	3844903	panel (dark fawn)	1
61-62	F.C. (exc. PICK-UP)	3774882	INSULATOR, engine compt. floor panel rear—(16.810)	1
61-65	GREENBRIER	3838733	PAD, rear floor mat	L.H.
61-65	GREENBRIER	3781492	PAD, rear floor mat	R.H.
61-64	SIDE RAMP	3776592	PAD, ramp door scuff ($3^{11}/_{16}$ x $49^{25}/_{64}$)	1

16.804 MAT, Body Side

61-65	GREENBRIER w/deluxe equip.	3789585	front whlhse. panel (green)	L.H.
62-65	GREENBRIER w/deluxe equip.	3814157	front whlse. (dark fawn)	L.H.

16.810 INSULATOR—ROD, Floor

61-65	F.C. (exc. PICK-UP)	3774882	engine compartment panel (Note 1)	A.R.
61-65	NOTE 1. Cut to required size. F.C. (exc. PICK-UP)	3774881	ROD, engine compt. floor panel insulator retaining ($28^{1}/_{8}$ dev. length)	A.R.



GROUP 17.000

SINGLE AND DOUBLE

UNIT BODY PARTS

UNIT 1003 TIME

UNIT 1003 TIME

UNIT 1003 TIME

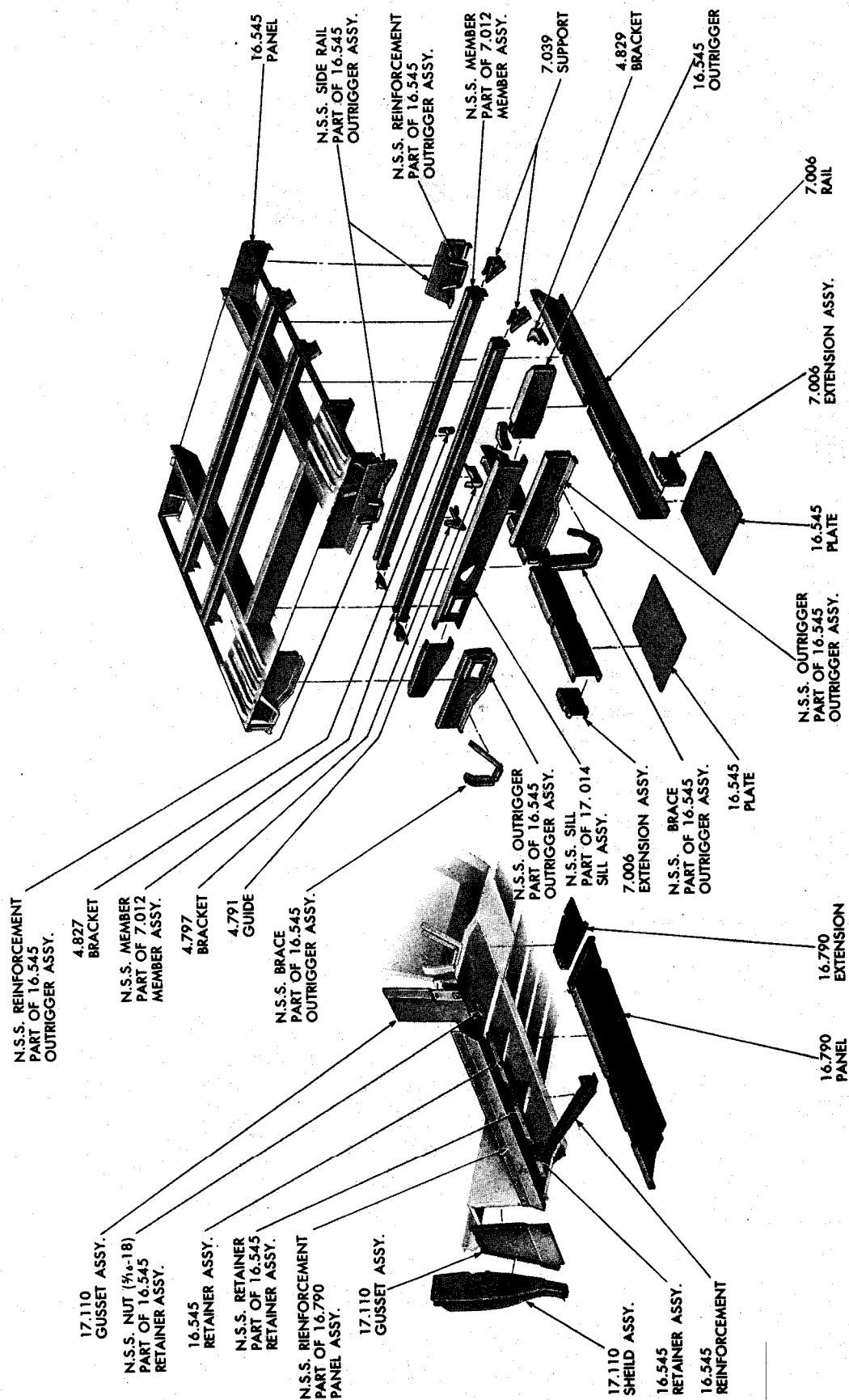

1961-65 CORVAIR F.C. REAR UNDERBODY ASSEMBLY--(EXPLODED)

©1969 CHEVROLET MOTOR DIVISION, GENERAL MOTORS CORPORATION—P&A 30C

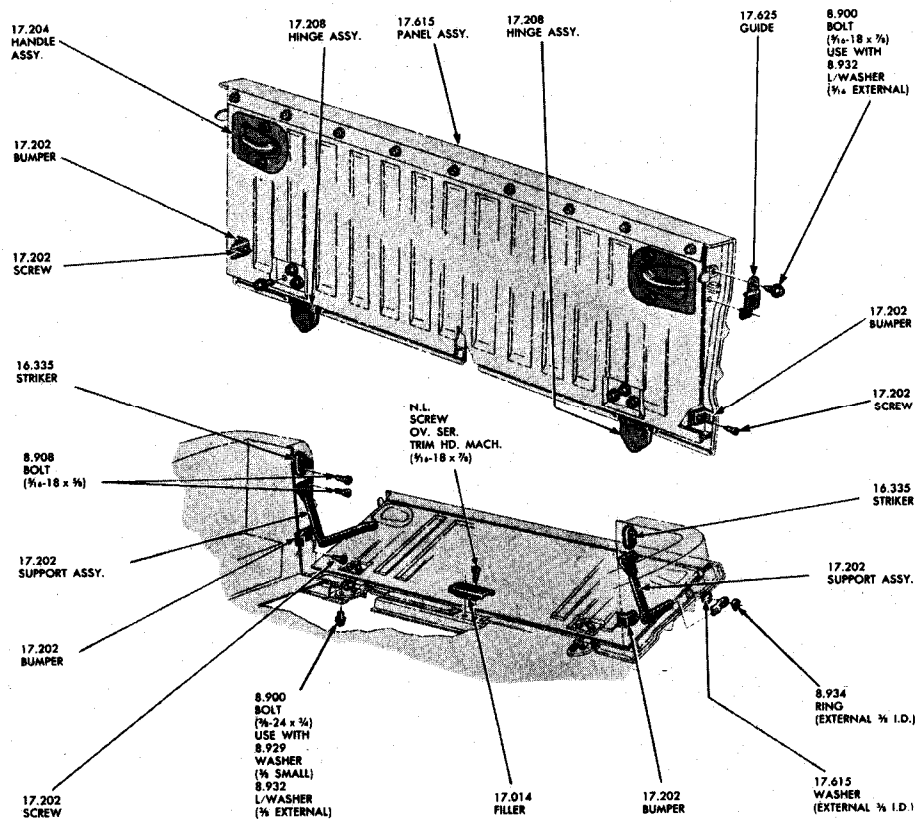

1961-64 CORVAIR PICK-UP END GATE DETAILS

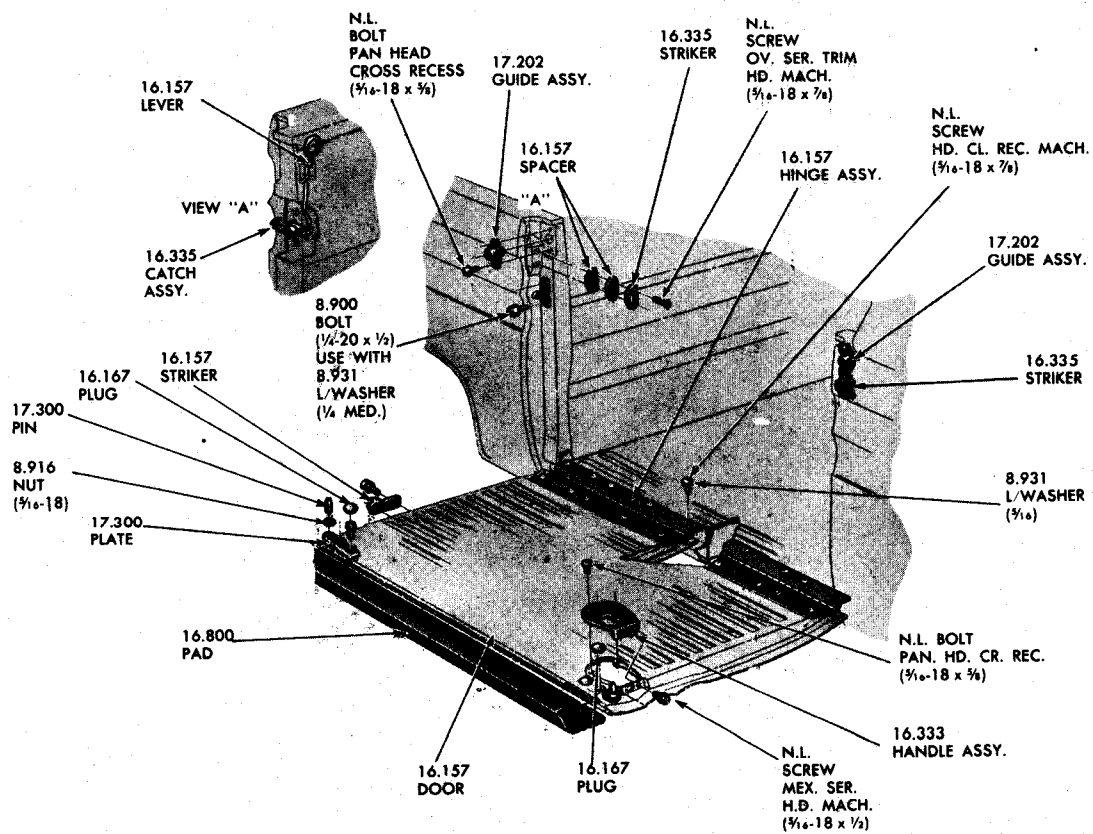

1961-64 CORVAIR SIDE RAMP DETAILS

17.014 STRAINER, Cross

61-65 F.C. 3777209
 61-65 F.C. 3777210

rear door sill rear L.H.
 rear door sill rear R.H.

17.060 TOP ASSY., Roof

61-65 F.C. (exc. PICK-UP) 3795020

(prime coated) 1

17.070 INSULATOR—NUT ASSY.—SCREW—SUPPORT, Luggage

ALL ALL 3788017
 NOTE 1 Cut as required.

roof cross strap center—(12.815) (Note 1) A.R.

61-65 F.C. (exc. PICK-UP) 528846

NUT ASSY., luggage carrier to roof top (1"S—20)—
 (12.815) (Note 2) A.R.

NOTE 2 Use with unit 988398.

ALL ALL 3892100

SCREW, luggage carrier rack strap to support assy.
 (special trim head cross recess machine) (No. 8—32 x
 1 1/8")—(12.815) 6
 SUPPORT, right—(12.815) 3

17.110 SIDE ASSY.—BRACKET ASSY.—COVER ASSY.—EXTENSION ASSY.—FILLER ASSY.—PANEL—PLATE—PLUG—REINFORCEMENT ASSY.—RETAINER—SEAL—SHIELD—STRAINER ASSY., Body

61-64 SIDE RAMP 3820485

..... L.H.

61-64 SIDE RAMP 3820484

..... R.H.

61-64 PANEL w/left body side
 door 3816145

..... L.H.

61-65 PANEL 3848374

..... R.H.

62-65 GREENBRIER 3848376

..... R.H.

61-64 PANEL (exc. body side door) 3848379

..... L.H.

61-65 GREENBRIER (exc. left body
 side door) 3848377

..... L.H.

61-64 GREENBRIER (exc. left body
 side door) 3779198

BRACKET ASSY., front window regulator mounting
 plate 1

61-65 GREENBRIER w/deluxe
 equip. 3844806

COVER ASSY., spare tire (charcoal) 1

61-65 F.C. 3781612

EXTENSION ASSY., front outer panel (Note 1) R.H.

61-65 F.C. 3780911

EXTENSION ASSY., front outer panel L.H.

61-65 F.C. 3775558

EXTENSION ASSY., rear splash shield R.H.

61-63 PICK-UP 3776521

EXTENSION ASSY., lower inner panel L.H.

61-63 PICK-UP 3776522

EXTENSION ASSY., lower inner panel R.H.

61-65 F.C. 3776738

FILLER ASSY., rear lower panel R.H.

61-64 PICK-UP 3778561

PANEL, upper inner L.H.

61-64 PICK-UP 3778562

PANEL, upper inner R.H.

61-64 PANEL 3858277

PANEL, rear upper (Note 2) L.H.

NOTE 2. PANEL may have round or square hole for rear door outer bumper. If necessary, enlarge square hole to
²³/₆₄" dia. and use 1-3812749 bumper, 2-3716779 screws and 2-124829 nuts.

61-65 PANEL 3858276

PANEL, rear upper R.H.

61-65 GREENBRIER 3858279

PANEL, rear upper L.H.

61-65 GREENBRIER 3858274

PANEL, rear upper R.H.

61-64 SIDE RAMP 3778438

PANEL, front inner 1

61-64 SIDE RAMP 3858268

PANEL, front outer R.H.

61-65 GREENBRIER 3774789

PANEL, front inner trim L.H.

61-65 F.C. 3778503

PANEL ASSY., side rear lower (Note 1) L.H.

61-65 F.C. 3778504

PANEL ASSY., side rear lower (Note 1) R.H.

61-65 F.C. 3781191

PANEL ASSY., front wheelhouse L.H.

61-65 F.C. 3781192

PANEL ASSY., front wheelhouse R.H.

61-65 F.C. (exc. PICK-UP) 3783683

PANEL ASSY., rear inner front upper (Note 3) L.H.

61-65 F.C. (exc. PICK-UP) 3849458

PANEL ASSY., rear inner front upper (Note 3 & 4) R.H.

NOTE 3. PANEL ASSY. may require bumper reinforcement. Drill holes or plug holes as required.

NOTE 4. It may be necessary to add rubber seal.

61-65 GREENBRIER 3776864

PANEL ASSY., rear quarter window inner R.H.

61-65 GREENBRIER (exc. left body
 side door) 3770121

PANEL ASSY., front outer L.H.

61-64 PANEL (exc. left body side
 door) 3770117

PANEL ASSY., front outer L.H.

61-64 PICK-UP 3785269

PANEL ASSY., lower inner L.H.

61-64 PICK-UP 3776525

PANEL ASSY., front lower outer L.H.

61-64 PICK-UP 3776037

PANEL ASSY., upper outer corner L.H.

61-64 PICK-UP 3776038

PANEL ASSY., upper outer corner R.H.

61-64 PICK-UP 3778563

PANEL ASSY., upper inner corner L.H.

61-64 PICK-UP 3778564

PANEL ASSY., upper inner corner R.H.

61-65 F.C. 3858276

PANEL ASSY., rear, upper right (primed) (Note 5) 1

NOTE 5. Add ²³/₆₄" dia. hole for rr. door rubber bumper on 1961-62 and early 1963 models.

61-65 GREENBRIER (exc. left body
 side door) 3775152

PLATE, front panel front window regulator mounting (10
 O.L.) 1

61-65	GREENBRIER (exc. left body side door)	3775153
61-64	F.C. (exc. GREENBRIER) . . .	3780536
61-64	PANEL (exc. left body side door)	3783168
61-64	PANEL	3784905
61-64	PANEL	3784906
61-65	GREENBRIER	3780722
61-65	GREENBRIER w/deluxe equip. (exc. body side door)	3788817
61	F.C. (exc. PICK-UP)	
61	PICK-UP	
61	F.C.	
61	SIDE RAMP	3827365
61-65	F.C.	3775408
61-65	F.C.	3783691
61-64	SIDE RAMP	3778426
61-65	F.C.	3775401
61-65	F.C.	3775402
61-65	F.C. (exc. PICK-UP, left body side door)	3774938

NOTE 1. May be necessary to cut slots for door hinges. Use old part as a guide.

17.112 PANEL—EYELET—EXTENSION ASSY.—SCREW, Body Side Trim

64-65	GREENBRIER	3844551
64-65	GREENBRIER	3844552
	NOTE 1 Paint as required.	
61-65	F.C. (exc. PICK-UP)	3783795
61-65	F.C. (exc. PICK-UP)	3783796
62-63	GREENBRIER w/deluxe equip. (exc. left body side door)	3814461
62-63	GREENBRIER w/deluxe equip.	3798080
64-65	GREENBRIER w/deluxe equip.	3844685
64-65	GREENBRIER w/deluxe equip.	3844686
64-65	GREENBRIER w/deluxe equip.	3844691
64-65	GREENBRIER w/deluxe equip.	3844692
64-65	GREENBRIER w/deluxe equip. (exc. left side door)	3844751
64-65	GREENBRIER w/deluxe equip. (exc. left side door)	3844753
64-65	GREENBRIER w/deluxe equip. (exc. left side door)	3844757
61-65	GREENBRIER w/deluxe equip.	3787311
61-65	F.C. (exc. PICK-UP)	3783797
62-65	F.C. (exc. PICK-UP)	3783798
61-65	GREENBRIER w/deluxe equip.	4667286

PLATE, front panel rear window regulator mounting (10 O.L.)	1
PLUG, inner rocker panel and access holes (3 ¹ / ₆₄ x 1 ¹ / ₄ thick) (silver)	A.R.
REINFORCEMENT ASSY., outer panel	L.H.
REINFORCEMENT ASSY., rear outer panel front	L.H.
REINFORCEMENT ASSY., rear outer panel front	R.H.
RETAINER, rear quarter window inner panel	R.H.
RETAINER, body side front trim panel (1 x 1 ¹³ / ₁₆ " w/two 1 ¹ / ₆₄ " dia. holes)—(16.165)	1
SEAL, body side rr. inner front and rr. upper panel and inner rocker panel, body side splash shield and rr. stake pocket air deflector, body side center splash shield, center stake rear filler (5 ⁹ / ₁₆ " edge grip—3 ³ / ₄ ")—(8.154)	A.R.
SHIELD, body side front splash	1
SHIELD ASSY., side center splash	L.H.
SHIELD ASSY., splash	R.H.
SHIELD ASSY., rear splash	L.H.
SHIELD ASSY., rear splash	R.H.

STRAINER ASSY., front panel	1
---------------------------------------	---

body side rear inner trim (Note 1)	L.H.
body side rear inner trim (Note 1)	R.H.
PANEL ASSY., body side rear inner rear	L.H.
PANEL ASSY., body side rear inner rear	R.H.
PANEL ASSY., body side front trim (fawn)	L.H.
PANEL ASSY., body side rear trim (turquoise)	R.H.
PANEL ASSY., body side rr. trim (fawn)	L.H.
PANEL ASSY., body side rr. trim (fawn)	R.H.
PANEL ASSY., body side rr. trim (lt. green)	L.H.
PANEL ASSY., body side rr. trim (lt. green)	R.H.
PANEL ASSY., body side frt. trim (red)	L.H.
PANEL ASSY., body side frt. trim (turquoise)	L.H.
PANEL ASSY., body side frt. trim (lt. green)	L.H.
EYELET, side door and side trim panel—(16.165)	A.R.
EXTENSION ASSY., body side rear inner rear panel	L.H.
EXTENSION ASSY., body side rear inner rear panel	R.H.
SCREW, w/washer, side rear trim panel assy., left and right oval hd. cr. rec. 8-18—6 x 5 ⁵ / ₁₆ (chrome)	A.R.

17.136 GLASS—CHANNEL ASSY.—RETAINER—SASH ASSY.—WEATHERSTRIP, Window

61-65	GREENBRIER	3772352
61-65	GREENBRIER	3772380
61-65	GREENBRIER (exc. left body side door)	3824837
61-65	GREENBRIER (exc. left body side door)	3824840
61-65	GREENBRIER (exc. left body side door)	3824841
61-65	GREENBRIER (exc. left body side door)	3824842

rear quarter	2
body side frt. panel frt. and rr. window, side intermediate door and side rr. door window	A.R.
CHANNEL ASSY., body side front window glass run front	1
CHANNEL ASSY., body side front window glass run rear	1
CHANNEL ASSY., body side rear window glass run front	1
CHANNEL ASSY., body side rear window glass run rear	1

61-65	GREENBRIER	3776856	RETAINER, rear quarter window glass	8
61-65	GREENBRIER	3771995	SASH ASSY., body side front panel frt. and rr. window	
			lwr. side intermediate door and rr. dr. window lower	A.R.
61-65	GREENBRIER	3777045	WEATHERSTRIP, rear quarter window	2
61-64	F.C. (exc. PICK-UP)	3778347	WEATHERSTRIP, rear window glass—(17.190)	2
17.136A MOULDING, Window Garnish				
61-65	GREENBRIER	3776857	rear quarter window garnish	2
61-65	GREENBRIER (exc. left body side door)	3775557	MOULDING ASSY., body side front panel front and rear window garnish	A.R.
17.160 PILLAR ASSY.—FILLER ASSY., Door and End Gate Hinge				
61-65	F.C. (exc. PICK-UP)	3796853	body rear door hinge	L.H.
61-65	F.C. (exc. PICK-UP)	3796854	body rear door hinge	R.H.
61-65	F.C. (exc. PICK-UP)	3775166	body side rear door hinge	R.H.
61-64	PICK-UP	3820487	end gate	L.H.
61-64	PICK-UP	3820488	end gate	R.H.
61-65	F.C.	3819225	FILLER ASSY., rear door sill strainer	L.H.
61-65	F.C.	3819226	FILLER ASSY., rear door sill strainer	R.H.
17.190 WEATHERSTRIP, End Gate				
Not required in this group.				
	See group 16.470	3778347		
17.202 SUPPORT ASSY.—BUMPER—GUIDE ASSY., Side Ramp and End Gate				
61-64	PICK-UP	3838944	end gate	1
61-66	PICK-UP	4826780	BUMPER, end gate—(12.212)	A.R.
61-64	SIDE RAMP	3776593	GUIDE ASSY., ramp door	2
17.204 HANDLE ASSY., End Gate Lock				
61-64	PICK-UP	3787755	end gate w/lock	L.H.
61-64	PICK-UP	3787756	end gate w/lock	R.H.
17.208 BUSHING—PIN—RING, End Gate Hinge				
61-64	PICK-UP	3828536	($1\frac{1}{32}$ " I.D. x $1\frac{1}{32}$ " x $1\frac{15}{32}$ " long)—(10.464)	4
61-64	PICK-UP	3718497	PIN ($1\frac{1}{32}$ " dia. x $3\frac{3}{16}$ " long)—(16.323)	2
ALL	ALL	274676	RING, retaining outer link pin ($\frac{5}{16}$ " I.D.)—(8.934)	A.R.
17.225 SEAL, Engine Access Door				
61-65	F.C.	3850793	upper	1
61-65	F.C.	3850794	lower	1
17.300 PIN—PLATE, Ramp Door Guide				
61-64	SIDE RAMP	3776764		2
61-64	SIDE RAMP	3776765	PLATE, pin mounting	2
17.405 SUPPORT, Platform				
61-64	PICK-UP w/level floor	3787036	floor loading center platform	2
17.447 BUSHING, Platform				
61-64	PICK-UP	3787029	($\frac{3}{8}$ " leg.	1
17.505 PANEL ASSY.—BRACKET—PILLAR ASSY., Body				
61-64	PICK-UP	3776021	side upper outer	L.H.
61-64	SIDE RAMP	3778250	side rear upper outer	R.H.
61-64	PICK-UP	3778559	BRACKET, body side upper inner panel mounting rear	2
61-64	PICK-UP	3784005	PILLAR ASSY., lock upper	L.H.
61-64	PICK-UP	3784006	PILLAR ASSY., lock upper	R.H.
17.507 CLIP, Body Side Outer Panel				
61-65	F.C.		to attach body side door name plate,	
61-64	PICK-UP	3770339	to attach end gate name plate—(8.147)	A.R.
17.615 PANEL—MOULDING—PLATE—SCREW—WASHER, End Gate and Rear Door				
61-64	PICK-UP	3770268	end gate outer	1
61-64	PICK-UP	3838980	PANEL ASSY., end gate	1
61-65	F.C. w/deluxe equip.	3782008	MOULDING, end gate and rear door trim (plastic w/red reflectorized painted center) ($11\frac{39}{64}$ x $2\frac{27}{64}$)	2
61-64	PICK-UP		PLATE, end gate,	
62-65	F.C. (exc. PICK-UP)	3776088	right, rear door, name	1

61-65 F.C. w/deluxe equip. 161867
61-64 PICK-UP 4239333
61-65 F.C. w/deluxe equip. 3789600

SCREW, end gate and rear door reflector (cr. rec.
tapping 8—15 x 1/2")—(8.977) 6
WASHER, support to end gate panel 2
WASHER, end gate panel and rr. door reflector 6

17.625 BRACKET, End Gate and Side Ramp

61-64 PICK-UP 3778495
NOTE 1. May be necessary to rework.

left or right, end gate hinge mounting (Note 1) 1

Alphabetical Index

Illustration Index

Help

For help with Acrobat Reader, click the following link:

[Acrobat Reader Help](#)

To upgrade your copy of Acrobat Reader, click here:

[Acrobat Reader Upgrade/Install](#)

