

ASSEMBLY MANUAL

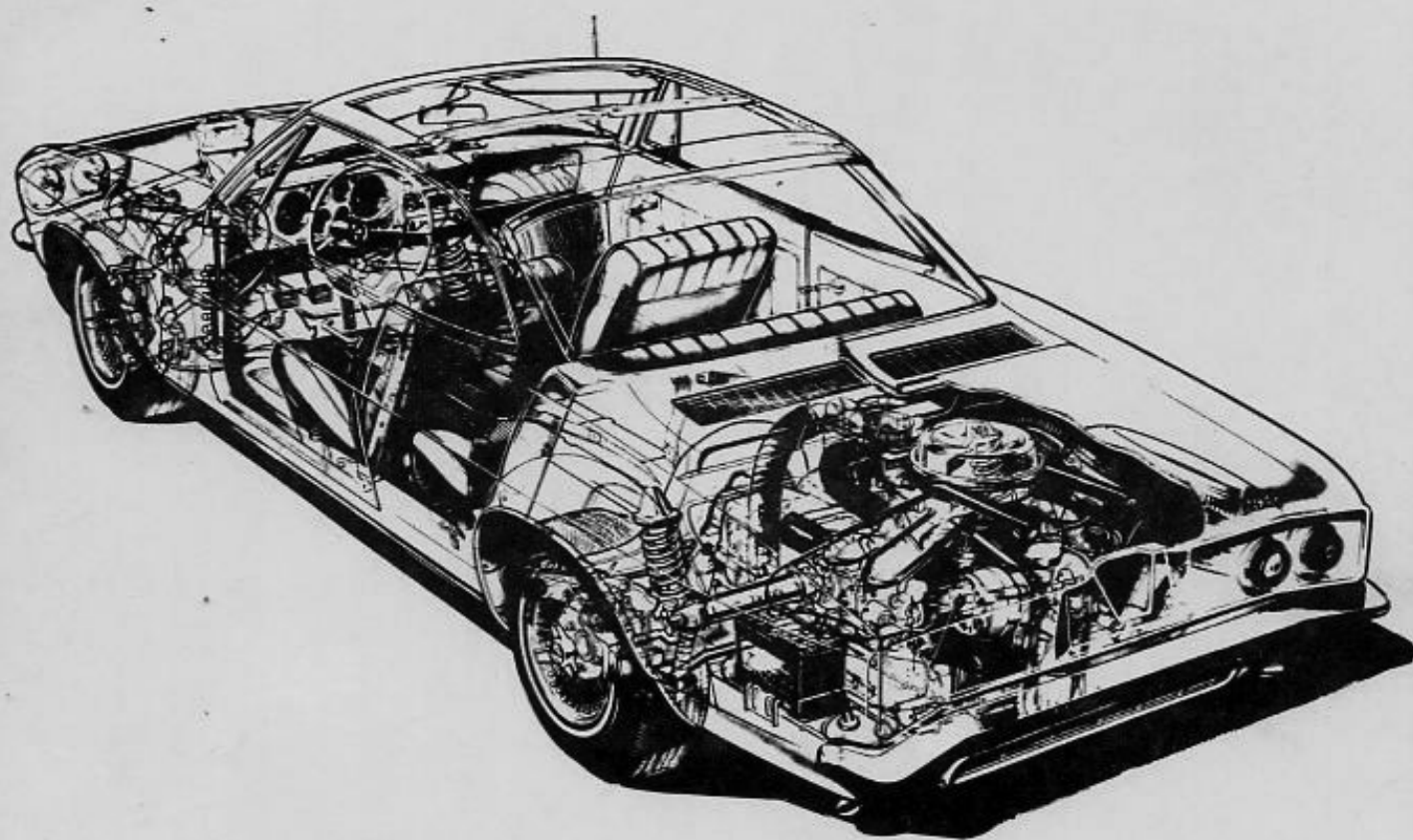

**1965
CORVAIR**

C7315

SECTION 4
REAR SUSPENSION



P H E T O C E T

ASSEMBLY INSTRUCTIONS

3862100

CORVAIR 10000 SERIES

SHEET

TITLE

NOT ILLUSTRATED ON THIS SHEET

	A1.	CONTENTS
A	A3.	REAR WHEEL SPINDLE, SUPPORT & BRAKE
B	A4.	DIFF. CARRIER & DRIVE SHAFT & UNIVERSAL JOINT
C	A5.	DIFF. CARRIER DIPSTICK
D	B1.	TORQUE CONTROL ARM & FRONT STRUT
E	B2.	REAR STRUT
F	B3.	SPRING & SHOCK ABSORBER
G	B5.	REAR SUSPENSION GEOMETRY

SHEET

TITLE

A2.	REAR SUSPENSION ASSEMBLY PROCEDURE
B4.	REAR TRIM HEIGHTS

① 358501

NUT

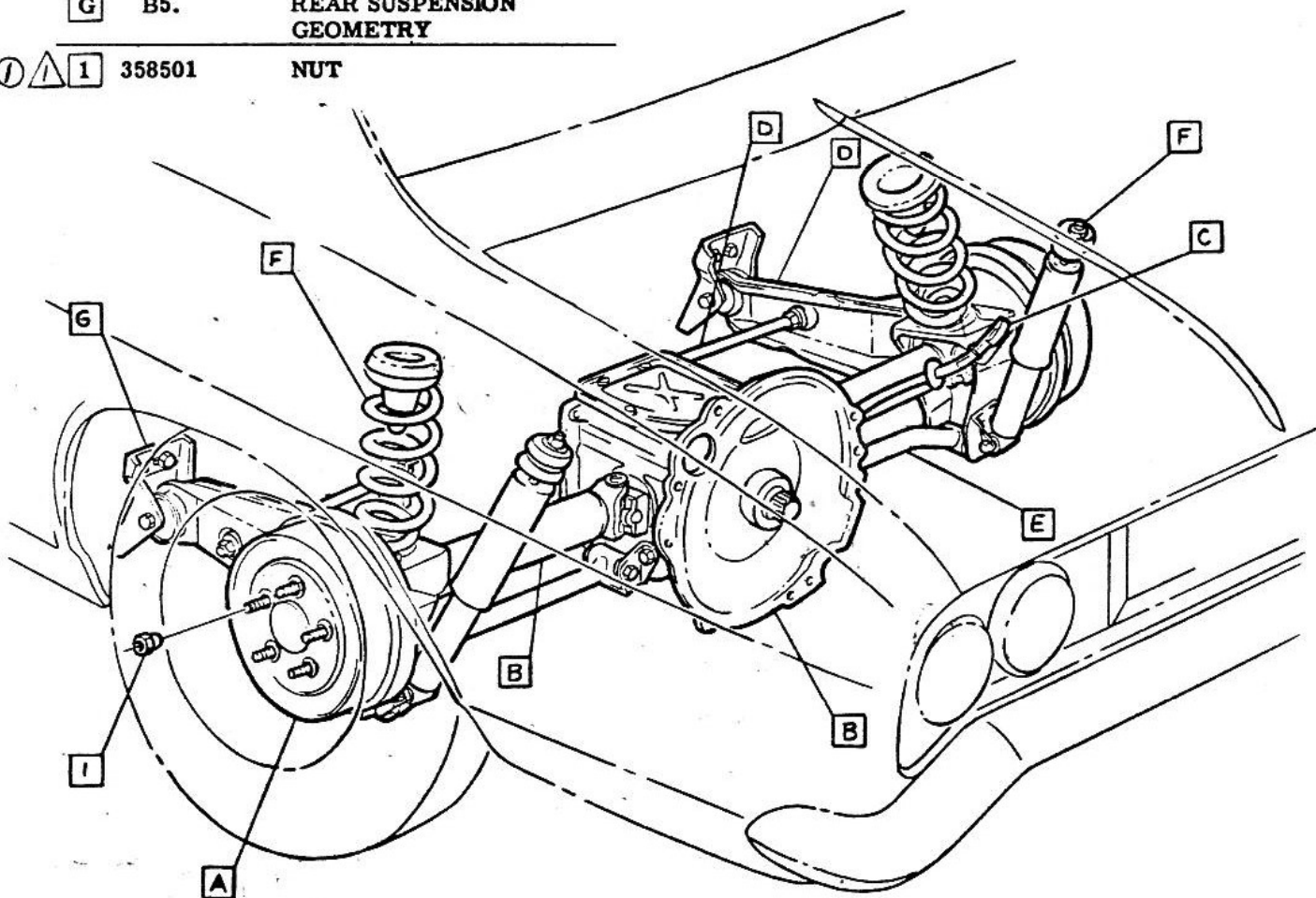

55-65 LBS.FT.
▲
▲
▲

CHEVROLET MOTOR DIVISION, GMC		UPC	DATE	SYM	REVISION RECORD	AUTH.	DR	CK
REAR SUSPENSION CONTENTS		4	2-23-65	1	TORQUE SYM. (1) ADDED	68894	JM	C1
10000		A1.						
DWG PREL 4-1	CS	REF: Prel. 1	L-73569	L-				
DATE REL 5-7		L-	L-	L-				
		SHEET						

1965-36



CHEVROLET

ASSEMBLY INSTRUCTIONS

3862100

CORVAIR 10000 SERIES

REAR SUSPENSION ASSEMBLY PROCEDURE

- 1 SUB-ASSEMBLE REAR STRUT TO STRUT BRACKET AT 81° AS SHOWN
- 2 ASSEMBLE STRUT BRACKET TO DIFFERENTIAL CASE
- 3 SUB-ASSEMBLE FRONT STRUT ROD TO FRONT STRUT BRACKET
- 4 ASSEMBLE FRONT STRUT BRACKET LOOSELY TO TRANSMISSION SUPPORT
- 5 PRESS (4) BOLTS INTO TORQUE ARM
- 6 SUB-ASSEMBLE TORQUE ARM BRACKET TO TORQUE ARM AT 62° AS SHOWN
- 7 ASSEMBLE TORQUE ARM TO REAR STRUT LOOSELY WITH CAM BOLT
- 8 ASSEMBLE HUB ASSEMBLY TO TORQUE ARM
- 9 ASSEMBLE AXLE SHAFT TO SPINDLE FLANGE
- 10 ASSEMBLE FRONT STRUT TO TORQUE ARM
- 11 ASSEMBLE AXLE SHAFT TO DIFFERENTIAL CARRIER
- 12 ALIGN CENTER MARK ON CAMBER ADJUSTING CAM WITH MARK ON CAM GUIDE & TIGHTEN NUT. **[NOTE]** Axle shaft should be approx horizontal when nut is tightened. SEE SHEET B2.
- 13 RAISE ENGINE INTO POSITION & ASSEMBLE TO FRONT & REAR ENGINE MOUNTS
- 14 ASSEMBLE TORQUE ARM BRACKET TO BODY ALIGNING CENTER MARKS ON TOP & BOTTOM OF BRACKET WITH ARROWS ON BODY. SEE SHEET B2.
- 15 TIGHTEN FRONT STRUT BRACKET TO TRANSMISSION SUPPORT ATTACHING BOLTS.
[NOTE] Tighten bolt with suspension approx at curb
- 16 ASSEMBLE REAR SHOCK ABSORBER TO CONTROL ARM.
- 17 SUB-ASSEMBLE JOUNCE BUMPER TO SPRING RETAINER
- 18 INDEX & RETAIN RUBBER INSULATOR TO SPRING RETAINER
- 19 PLACE RETAINER ON SPRING & INDEX STOP AGAINST END OF SPRING
- 20 COMPRESS SPRING & POSITION BETWEEN SPRING SEATS, INDEXING PIGTAIL 3/8± 1/8 FROM STOP ON LOWER SPRING SEAT. **[NOTE]** Spring must not be compressed to a gap between compressed coils under an average of .179
- 21 RELEASE SPRING

CHEVROLET MOTOR DIVISION, GMC				UPC	DATE	SYM	REVISION RECORD		AUTH.	DR	CX
REAR SUSPENSION ASSEMBLY PROCEDURE				4							
10000				A2.							
DWG PREL 5-8 CS REF: Prel. A4. L- L-				X SHEET							
DATE REL 5-22				L- L- L-							



3862100

ASSEMBLY INSTRUCTIONS

3862100

CORVAIR 10000 SERIES

- ④ ① 3875097 BOLT
 ② 3858093-4 REAR WHEEL SPINDLE, SUPPORT & BRAKE ASM L. & R.H.
 ① ③ 131099 L. WASHER (UPC 5) ② ⑤
 ① ④ 6255675 NUT (UPC 5) ② ⑥
 ⑦ ⑤

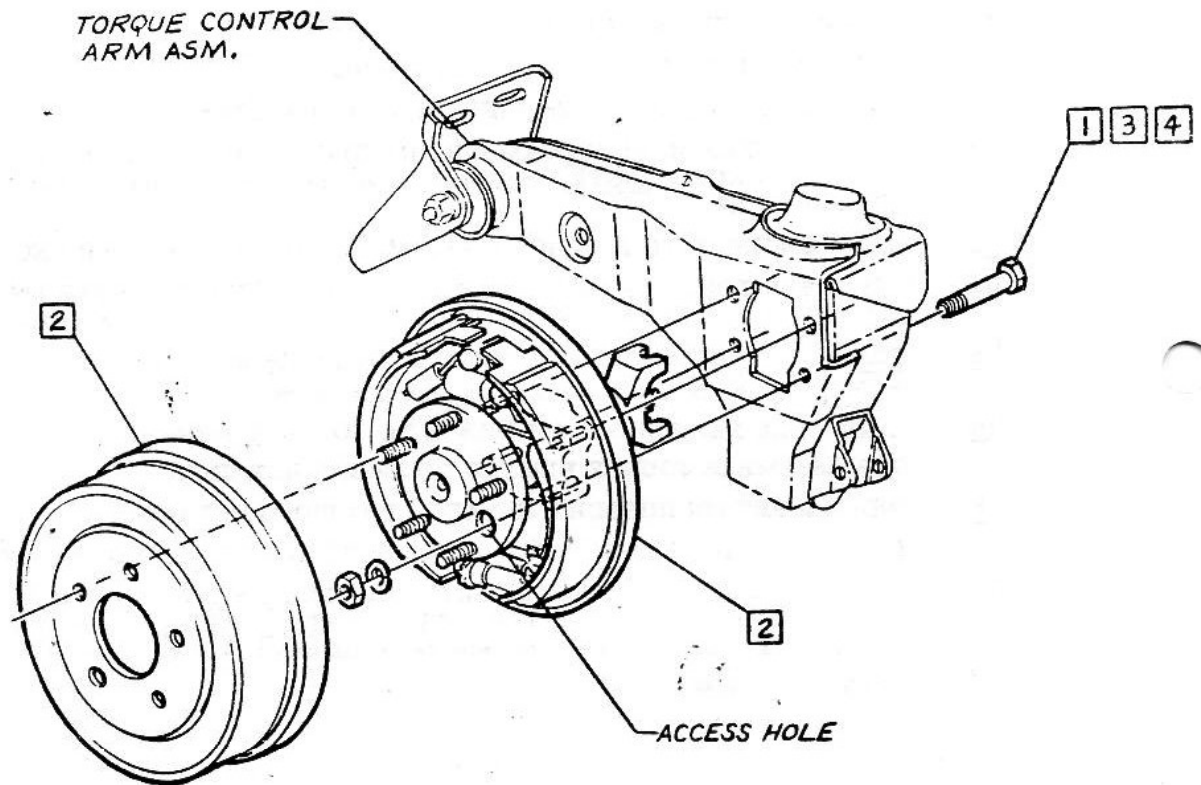

③ 35-45 LBS.FT.
 ▲
 ▲
 ▲

• CHEVROLET MOTOR DIVISION, GMC •			UPC	DATE	SYM	REVISION RECORD	AUTH.	DR	CK
REAR WHEEL SPINDLE, SUPPORT & BRAKE ASM.			4	12-24-64	1	WAS 103321 L. WASHER	—	CS	
					2	UPC NOTE ADDED (3 PLCS)	64798		HB
				1-10-64	3	TORQUE (1) WAS 25-35 LBS FT	66467	GB	HB
				12-7-64	4	WAS 3860235 BOLT	67676	BR	CI
				12-30-64	5	WAS 455509 WASHER	67889	BY	
					6	WAS 103026 NUT	67868		
					7	3656838 NUT REMOVED	15958	BR	CI
10000			A3.						
DWG PREL 3-14 CS REF: Prej. A1 L-65080 L-73569									
DATE REL 3-14 L-73570 L-									
			SHEET						

- 1 3855496 CARRIER ASM (EXC 10700)
3855497 10700
- 2 3877199 BOLT ②
- 3 3884902 LOCK - SPECIAL ⑪
- 4 3859430 DRIVE SHAFT & UNIVERSAL JOINT
- 5 3880102 STRAP
- 6 3834236 BOLT (ONE ONLY-THIS LOCATION)
- 7 3828782 BOLT

- 8 Suggested assembly sequence. Install these (2) bolts first in pilot holes to provide proper index for installation of remaining bolts.

NOTE See UPC 7 for lubrication of diff. carrier asm.

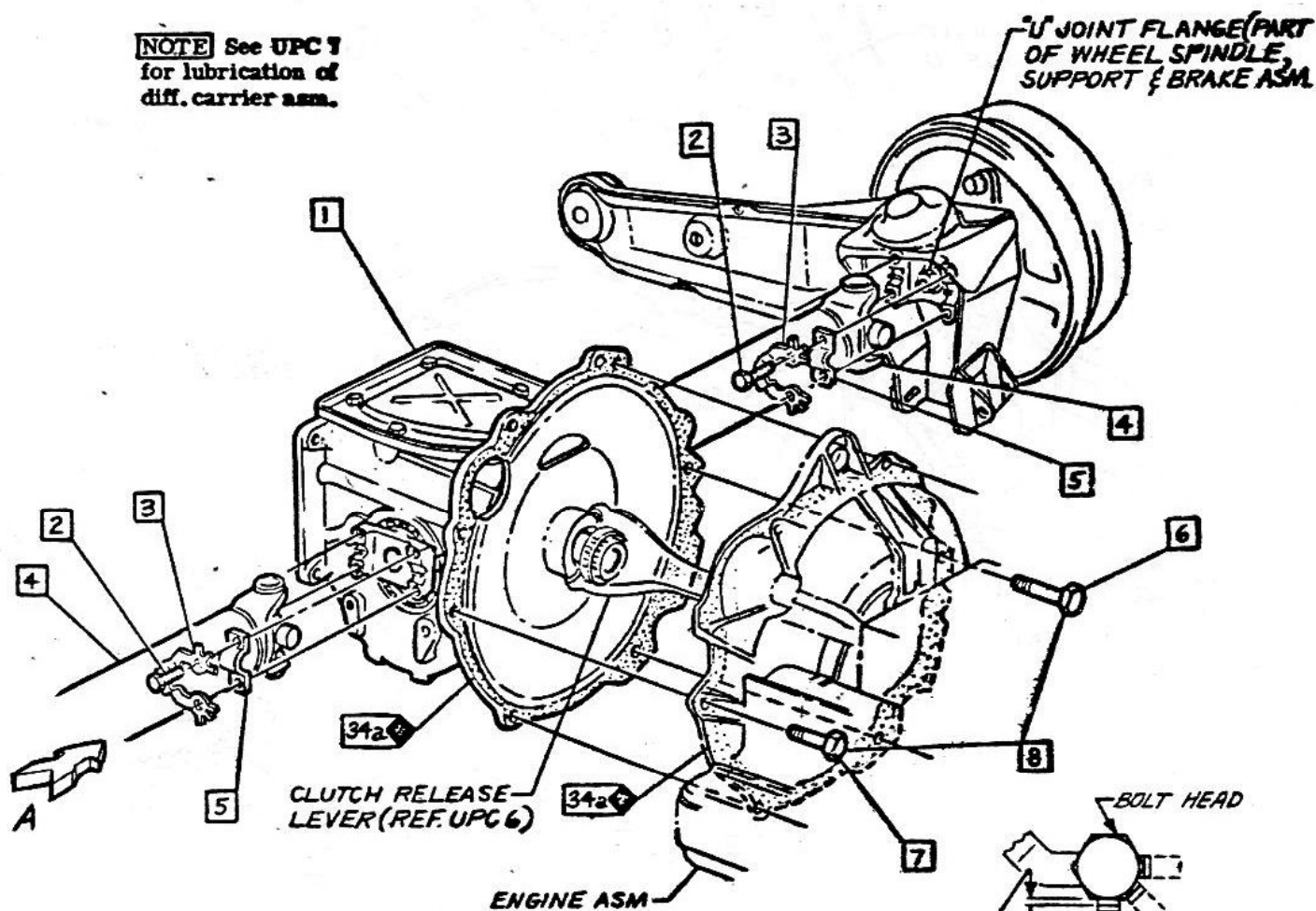

⑬ 86-106 LBS IN.
20-30 LBS. FT.

NOTE BEND ALL TAB'S TIGHT TO .020 MAX. GAP

⑫ **VIEW A**

• CHEVROLET MOTOR DIVISION, GMC •				UPC	DATE	SYM	REVISION RECORD	AUTL	DR	CK
DIFF. CARRIER & DRIVE SHAFT & UNIVERSAL JOINT				4	1-25-65	6	WAS 3871340 BOLT	6866	UT	
						9	WAS 3871347 LOCK	6879	MB	
						10	ITEM 9 REMOVED			CI
					4-23-65	11	WAS 108578 WASHER	7018	LS	
						12	VIEW A ADDED			
						13	TORQUE (1) WAS 95-120 LBS. IN.			
						14	WAS 3875779 STRAP	6955		CI
10000				A4.						
DWG PREL 3-18 CS REF: Prel. A2 L-73578 L-				X SHEET						
DATE REL 5-22 L- L- L-										

- | | | | |
|---|---|---------|-----------------------------|
| ① | 1 | 3874531 | GAGE ASM |
| | 2 | 3864013 | GROMMET |
| ② | 3 | 3874530 | TUBE ASM |
| | 4 | 3849736 | STICKER-DIFF OIL LEVEL INFO |
| ① | 5 | 140286 | CONNECTOR |

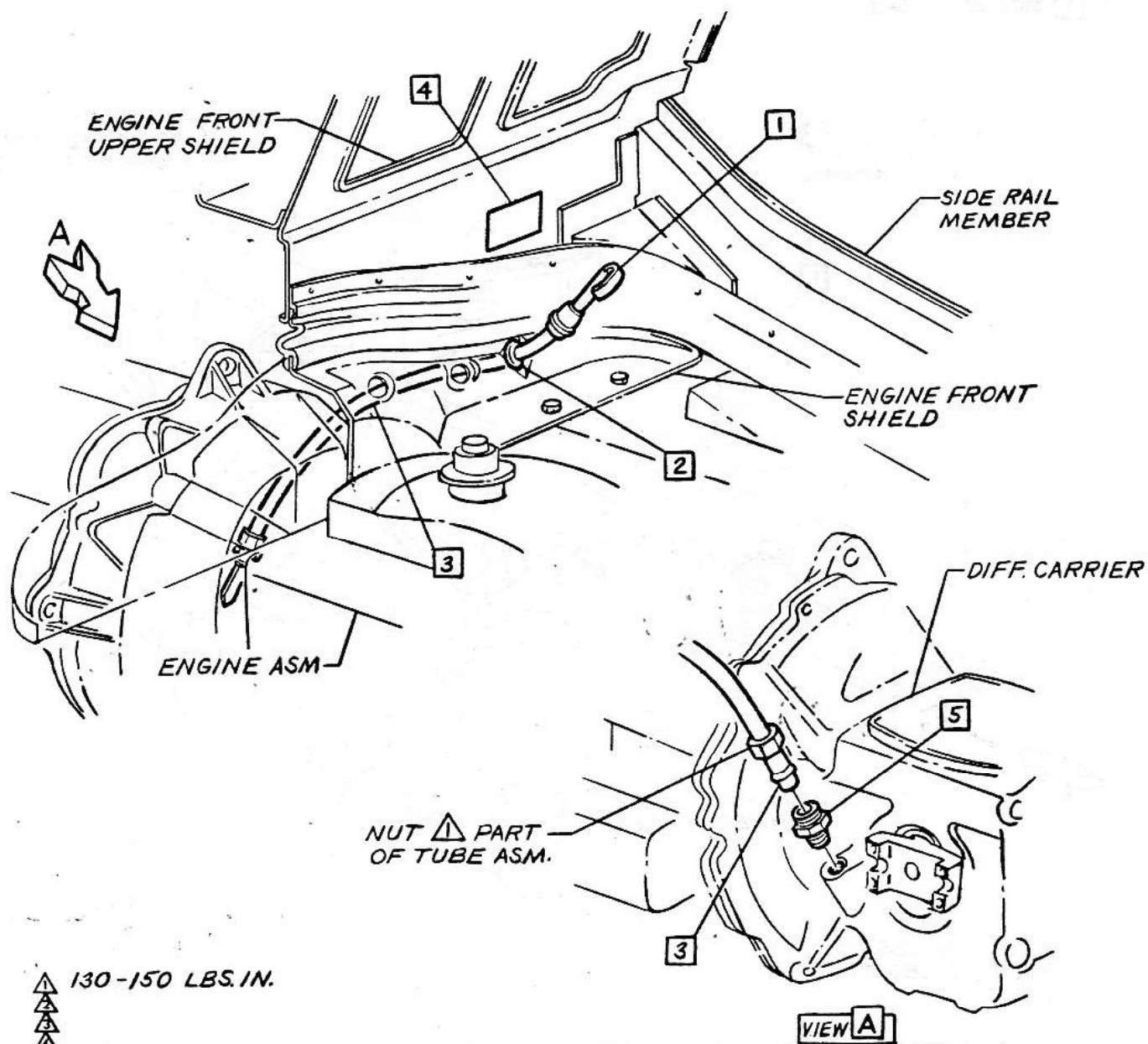

△ 130-150 LBS. IN.

• CHEVROLET MOTOR DIVISION, GMC •				UPC	DATE	SYM	REVISION RECORD	AUTH.	DR	CK
DIFF. CARRIER DIPSTICK				4	10-22-64	1	WAS 3864011 GAGE ASM.	66879	CS	
						2	WAS 3864012 TUBE ASM.			HR
10000				A5.						
DWG PREL 3-30 CS REF: Prel. A3 L-73563 L- DATE REL 3-30 L- L- L-										
				SHEET						

1965-40

- | | | | | | | | |
|----|-----------|------------------------|------------------|---------|--------|-----------|------------|
| ① | 3858018 | BRACKET | ⑨ | 3857928 | BOLT | | |
| ⑦① | ② | 3831892 | SCREW ASM | ⑩ | 103330 | L. WASHER | |
| ③ | 3858423-4 | STRUT-FRONT L. & R. H. | ③ | ⑪ | 103029 | NUT | |
| ④ | 3375055-6 | BRACKET-L. & R. H. | ⑫ | 102635 | NUT | | |
| ⑩ | ⑤ | 3880423-4 | TORQUE CONT. ARM | ⑧ | ⑬ | 3791421 | SCREW ASM. |
| | | ASM-L. & R. H. | | | | | |
| | ⑥ | 5544049 | RETAINER | | | | |
| | ⑦ | 5544296 | GROMMET | | | | |
| ② | ⑧ | 3816622 | NUT | | | | |

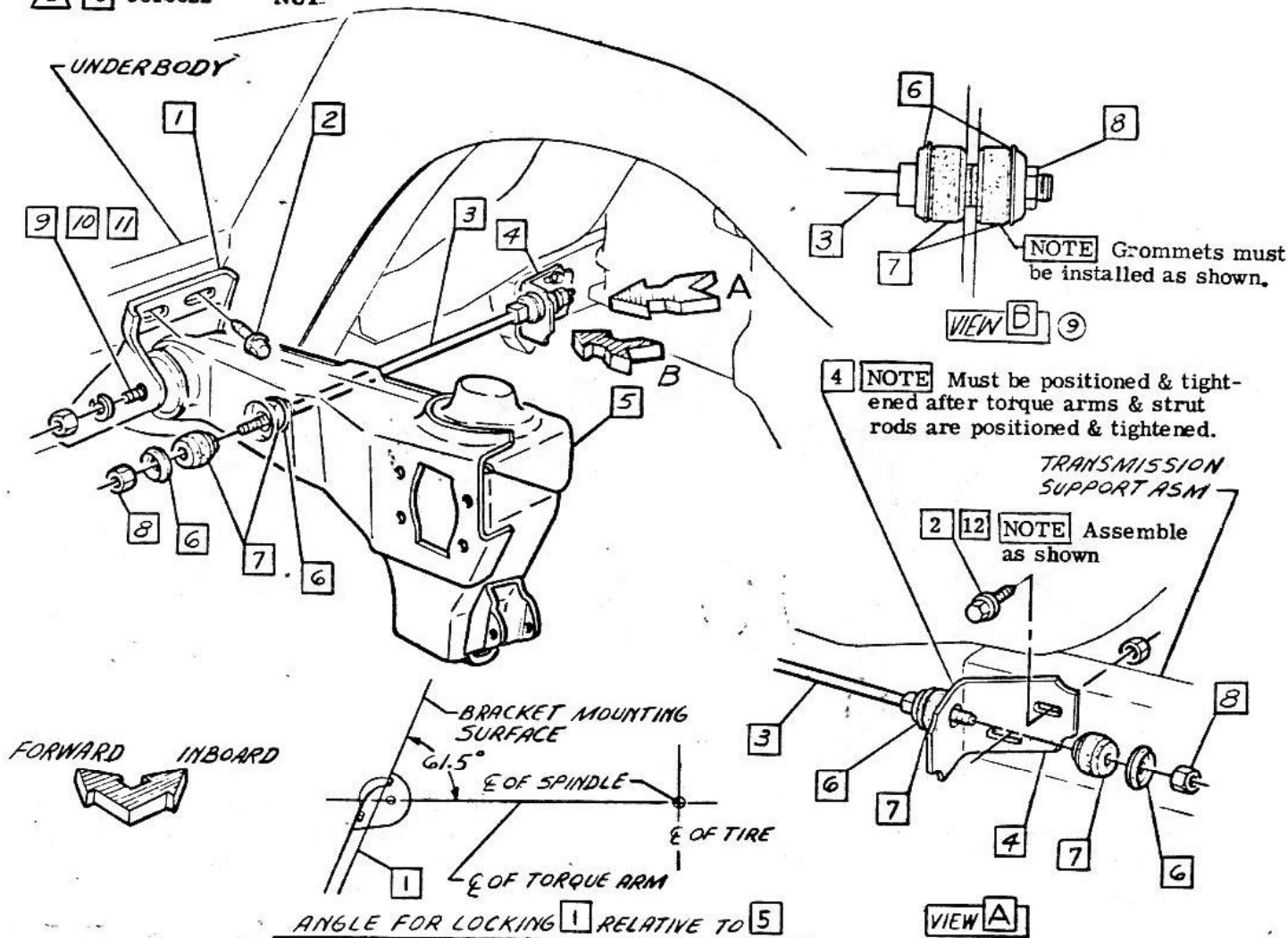

- ▲ 20-30 LBS FT
- ▲ 11-15 LBS FT
- ▲ 90-130 LBS FT

⑥

CHEVROLET MOTOR DIVISION, GMC				UPC	DATE	SYM	REVISION RECORD	AUTH.	DR	CK
TORQUE CONTROL ARM & FRONT STRUT				4	2-17-65	6	ASSEMBLY NOTE REMOVED	60854	JM	
10000						7	WAS 3791421 SCREW		JT	
						8	ITEM 13 ADDED			CI
					3-11-65	9	VIEW B ADDED		JC	CI
					2-23-65	10	WAS 3858019-20 ARM	69876	LS	CI
DWG PREL. 3-27 JA REF: Prel. B5 L-65090L-73569				B 1.						
DATE PREL. 5-21 L- L- L-				SHEET						



CHEVROLET

ASSEMBLY INSTRUCTIONS

3862100

CORVAIR 10000 SERIES

- ① 1 3792930 NUT
- 2 103329 L. WASHER
- ② 3 179838 BOLT
- 4 103321 L. WASHER
- 5 3858040 BRACKET
- 6 3857932 BOLT
- ③ 7 3877519 CAP

- 8 3858034 STRUT ASM-REAR
- 9 3790331 CAM
- 10 3858038 CAM ASM

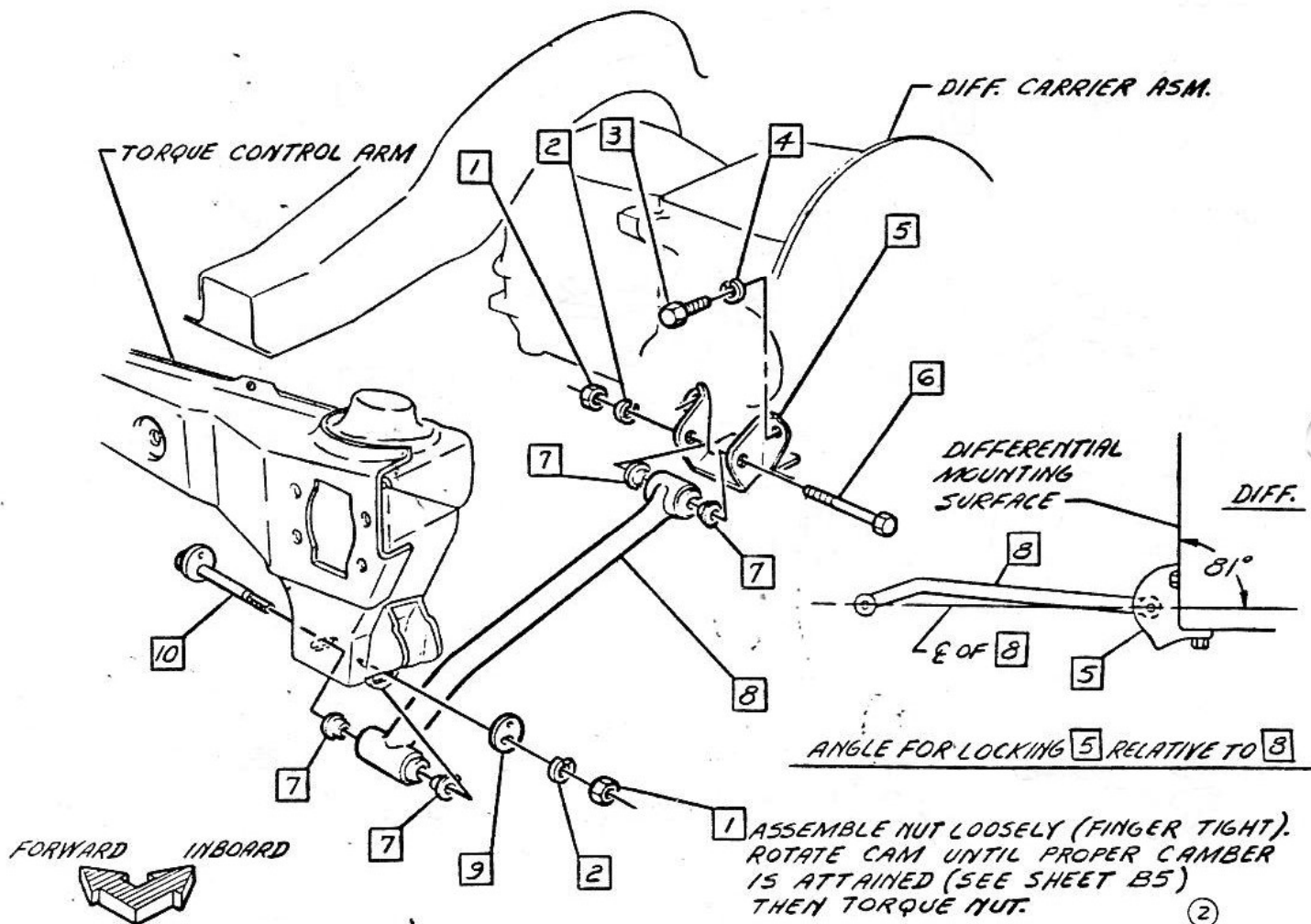

- ① ▲ 70-90 LBS FT
- ▲ 20-30 LBS FT
- ▲
- ▲

CHEVROLET MOTOR DIVISION, GMC				UPC	DATE	SYM	REVISION RECORD	AUTH.	DR	CK
REAR STRUT				4	8-4-64	1	TORQUE (1) WAS 75-90 LBS FT	65582	TH	DF
10000				B 2.	9-25-64	2	WAS PREL. B2	66467	GB	DF
DWG PREL. 3-19 JA REF: Prel. B4 L-65090 L-				☒ SHEET	12-19-64	3	WAS 3858039 CAP	15333	BR	CI
DATE PREL. 5-21										

- 1 3858016 CUSHION
2 3858015 RETAINER
① 3 1365067 NUT
4 3798007 RETAINER
5 5544296 GROMMET
6 3186936 SHOCK ABSORBER ASM
② 7 3857934 BOLT
③ 8 103328 L. WASHER

- 9 271500 NUT
① 10 3859201 SPRING (EXCEPT CONVERTIBLES)
3859202 CONVERTIBLE & C64
11 3858017 BUMPER ASM
12 103321 L. WASHER
③ 13 102635 NUT

ASSEMBLY SEQUENCE

LOAD ⑩, ② & ① IN SPRING COMPRESSOR WITH SPRING END AGAINST STOP IN RETAINER & CUSHION RETAINED TO TOP FACE OF RETAINER WITH LEDGE STOPS SEATED TO EACH OTHER. LOAD SPRING IN JOB & POSITION LOWER SPRING END IN SEAT AS SPECIFIED.

NOTE END OF COIL MUST BE $\frac{3}{8} \pm \frac{1}{8}$ FROM STOP

TORQUE CONTROL ARM

FORWARD INBOARD

- ▲ 75-100 LBS IN
▲ 35-55 LBS FT
▲ 15-24 LBS FT

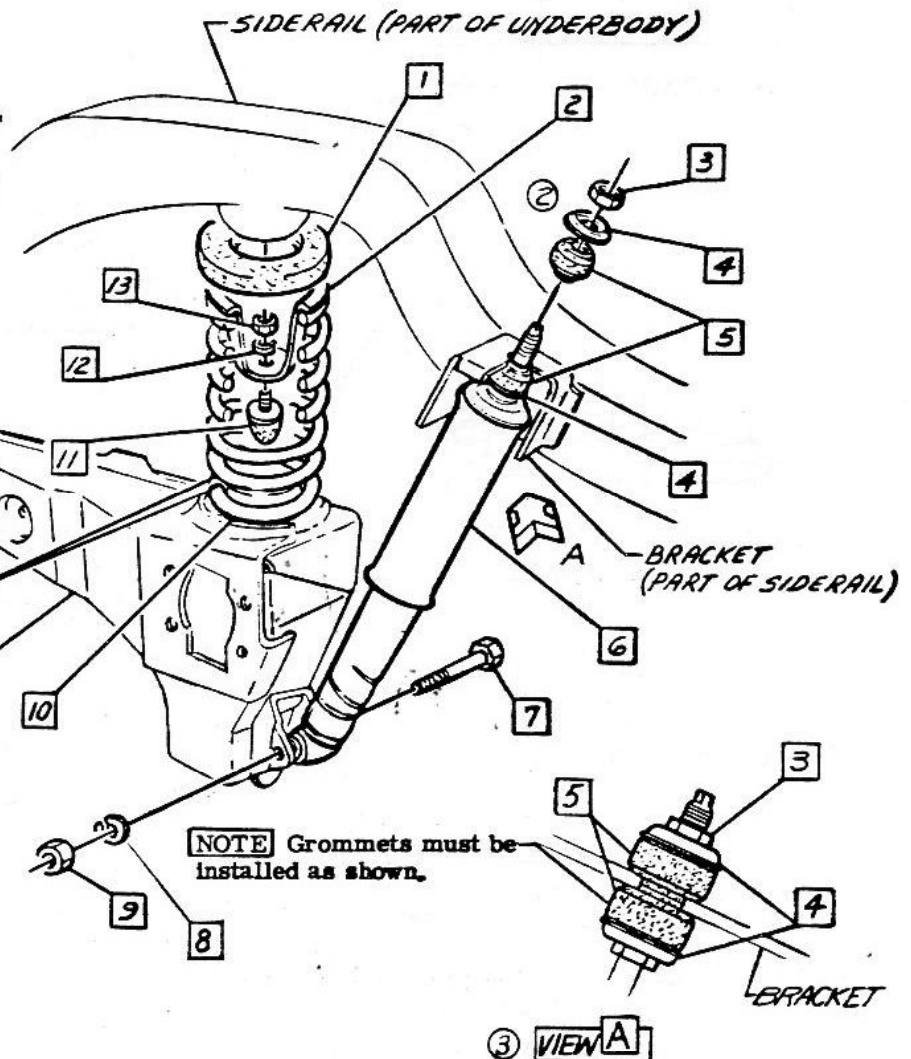

CHEVROLET MOTOR DIVISION, GMC		UPC	DATE	SYM	REVISION RECORD	AUTH.	DR	CK
REAR SPRING & SHOCK ABSORBER		4	10-22-64	1	CONV. EXCEPTIONS ADDED	66214	HM	HIS
10000		B3.	3-11-65	2	DRAWING REVISED		JC	
DWG PREL. 3-18 JA REF: Prel. B1 L-65090 L-		SHEET X		3	VIEW A ADDED			CI
DATE REL. 5-21 L- L- L-								



ASSEMBLY INSTRUCTIONS

3862100

CORVAIR 10000 SERIES

VEHICLE HEIGHTS

FIGURES INCLUDE AUTOMATIC TRANSMISSION, RADIO, & COMFORT & CONVENIENCE WITH WATER IN WINDSHIELD WASHERS.

NOTE PULL VEHICLE UP 3 OR MORE TIMES ALLOW TO SETTLE, THEN MEASURE "D" & "K" DIMENSIONS.

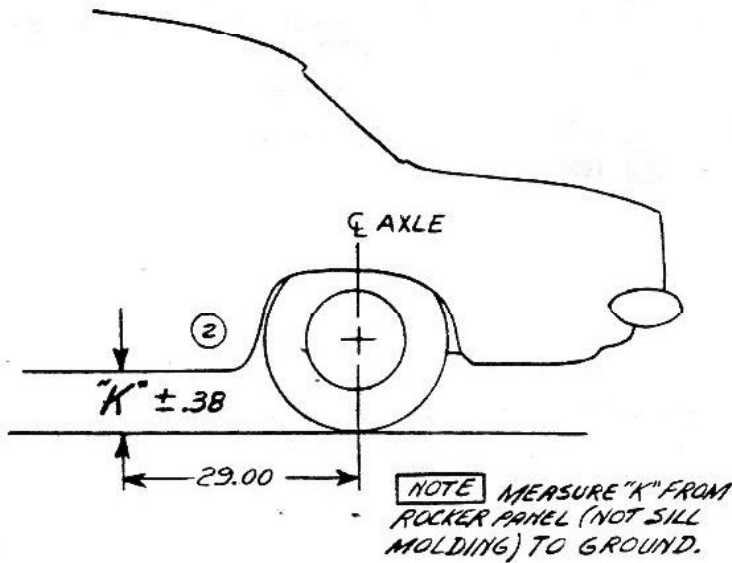

MODELS	DIM. "D"		DIM. "K"	
	★ AS SHIPPED	● CURB (REF)	★ AS SHIPPED	● CURB (REF)
10137	-.59	-.68	8.53	8.38
A/C	-.50	-.60	8.62	8.47
10139	-.69	-.78	8.40	8.24
A/C	-.61	-.70	8.49	8.34
10537	-.72	-.82	8.58	8.22
A/C	-.63	-.73	8.47	8.32
10539	-.80	-.90	8.27	8.11
A/C	-.72	-.80	8.36	8.21
10567	-.91	-1.00	8.15	8.01
A/C	-1.14	-1.21	7.89	7.77
* 10737	-.79	-.89	8.29	8.14
* 10767	-1.00	-1.09	8.07	7.92

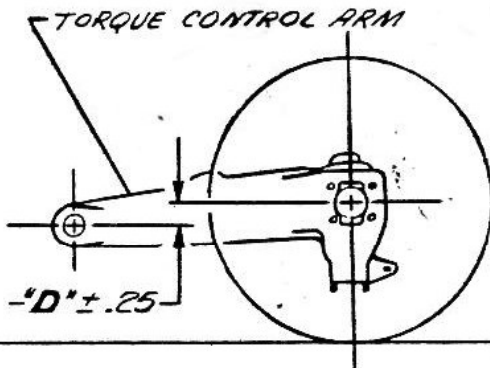

LOAD CONDITIONS

- ★ AS SHIPPED - OIL, 2 GALS. OF FUEL & RECOMMENDED TIRE PRESSURE
- CURB WEIGHT - OIL, FULL TANK OF FUEL & RECOMMENDED TIRE PRESSURE

RECOMMENDED TIRE PRESSURE

SEDAN & COUPE - 15 LBS. FRONT & 26 LBS. (EXC. A/C) ± 2 LBS REAR

CONVERTIBLE - 15 LBS. FRONT & 28 LBS. ± 2 LBS REAR

A/C - 15 LBS. FRONT & 28 LBS. ± 2 LBS REAR

WHEN VEHICLE HAS THE FOLLOWING EQUIPMENT - ADD OR SUBTRACT FROM CHARTS AS SHOWN BELOW.

	EQUIPMENT	DIM "D"	DIM "K"
PROD.	3 SPEED TRANS.	+ .03	+ .02
PROD.	4 SPEED TRANS.	0	0
PROD.	L-63 ENGINE	-.08	-.07
PROD.	L-87 ENGINE	-.03	-.04

* HEIGHTS FOR 10700 MODELS INCLUDE L-63 ENGINE

SEDAN & COUP	HEAVY DUTY SUSP. 217	AS SHIPPED	-.77	-.71
		CURB	-.74	-.66
CONV.	HEAVY DUTY SUSP. 217	AS SHIPPED	-.53	-.52
		CURB	-.50	-.48

RECOMMENDED TIRE PRESSURE

HEAVY DUTY SUSPENSION

ALL MODELS - 19 LBS FRONT & 30 LBS ± 2 LBS REAR

CHEVROLET MOTOR DIVISION, GMC		UPC	DATE	SYM	REVISION RECORD	AUTH	DR	CK
REAR TRIM HEIGHTS		4	12-7-64	7	REDRAWN & REDESIGNED	67258	JLC	CI
10000		B 4.						
DWG. PREL. 3-19	JA	REF: Prel. B3	L-	L-				
DATE REL. 4-24		L-	L-	L-				
		<input checked="" type="checkbox"/> SHEET						

1965-44

+

CAMBER-TOE IN ADJUSTMENT

- ④ 1. "ROTATE L. H. ADJUSTING CAM (1) ONE MARK COUNTERCLOCKWISE AND THE R. H. CAM ONE MARK CLOCKWISE FROM CENTER MARK ON CAM".
- ⑦ 2. ASSEMBLE TORQUE ARM BRACKET TO BODY ALIGNING POINTERS "B" ON UNDERBODY
- ③ MIDWAY BETWEEN ONE MARK OUTBOARD AND
- ⑤ CENTER MARK ON TORQUE ARM BRACKET.

NOTE: POINTERS MUST BE ALIGNED TO CENTERLINE OF INDEX MARKS $\pm .030$

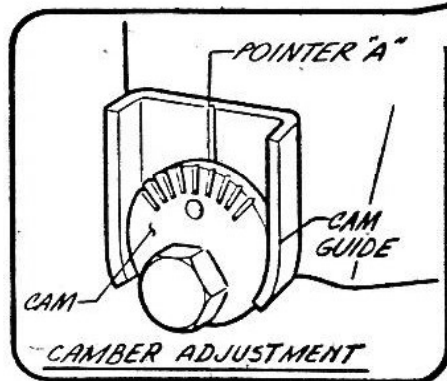
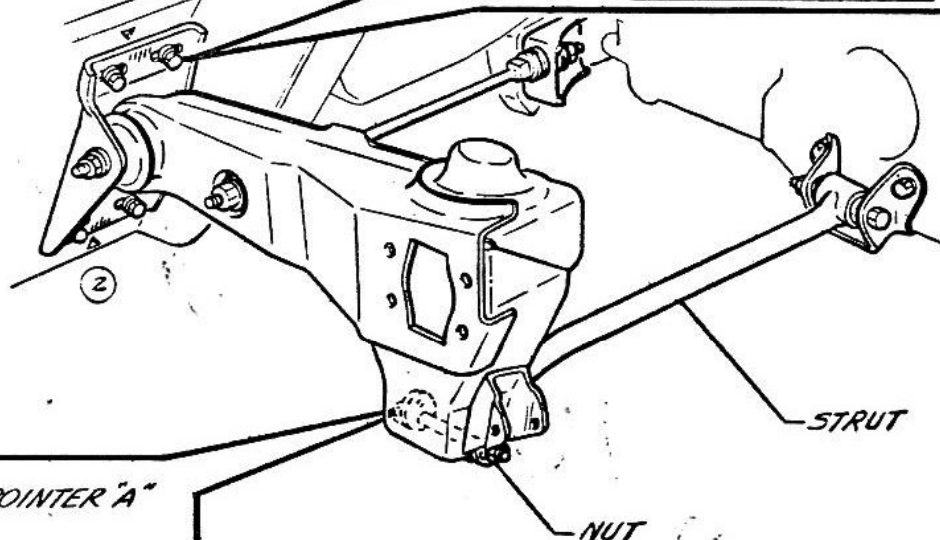
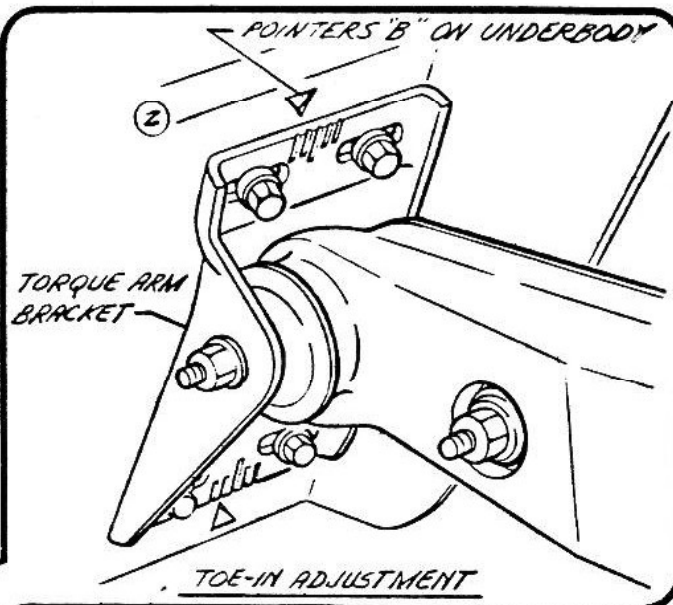
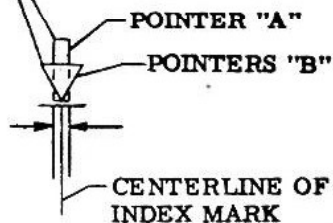

CHEVROLET MOTOR DIVISION, GMC				UPC	DATE	SYM	REVISION RECORD	AUTH.	DR	CK
REAR SUSPENSION GEOMETRY				4	8-25-64	1	NOTE REVISED	66260	NH	
						2	DRAWING REVISED			HR
					12-30-64	3	NOTE REVISED	68389	BR	CI
					2-23-65	4	NOTE REVISED	68094	JH	
						5	NOTE REVISED			CI
10000				B 5.						
DWG PREL. 3-19	JA	REF: Prel. B2	L-	L-						
DATE PREL. 5-21			L-	L-						
				SHEET						