

1966 FISHER BODY SERVICE MANUAL

FOR ALL
BODY STYLES

This publication contains the essential removal, installation, adjustment and maintenance procedures for servicing all 1966 Fisher Body Styles. All information, illustrations, and specifications contained in this publication are based on the latest product information available at the time of publication approval. The right is reserved to make changes at any time without notice.

Arrangement of the material is shown by the table of contents on the right-hand side of this page. Black tabs on the first page of each section can be seen on the edge of the book below the section title. A more detailed table of contents precedes each section, and an alphabetical index is included in the back of the manual.

FISHER BODY DIVISION
PART NO. 4226635

LITHO IN U.S.A.
AUGUST 1965

Reprinted with Permission of
General Motors Corporation

TABLE OF CONTENTS

SECTION	TITLE
1	GENERAL INFORMATION
2	LUBRICATION
3	FRONT END
4	HEADLINING
5	ROOF
6	FOLDING TOP
7	DOORS
8	REAR QUARTER
9	REAR END
10	SEATS
11	ELECTRICAL
12	EXTERIOR MOLDINGS
13	INDEX

"Portions of materials contained herein have been reprinted with permission of General Motors Corporation, Service Technology Group."

©1965 GENERAL MOTORS CORPORATION

REAR DOORS

DESCRIPTION

The procedures included in this section concern operations applicable to rear doors only. Procedures for the removal of trim, inside and outside door handles, and door weatherstrips, which are similar for both front and rear doors, are found in the "Front and Rear Door" section.

Illustrations 7-111, 7-112, 7-113, 7-114, 7-115, 7-116, 7-117 identify the individual hardware components and their relation to each other on the various style rear doors.

REAR DOOR HINGES—ALL STYLES

As the rear door hinges are secured with screws to both the door and center pillar, the door can be removed by either removing the door from the hinges or by removing the door and hinges as an assembly from the center pillar.

Removal

1. With a pencil, mark location of hinges on door or center pillar depending on removal method being used.

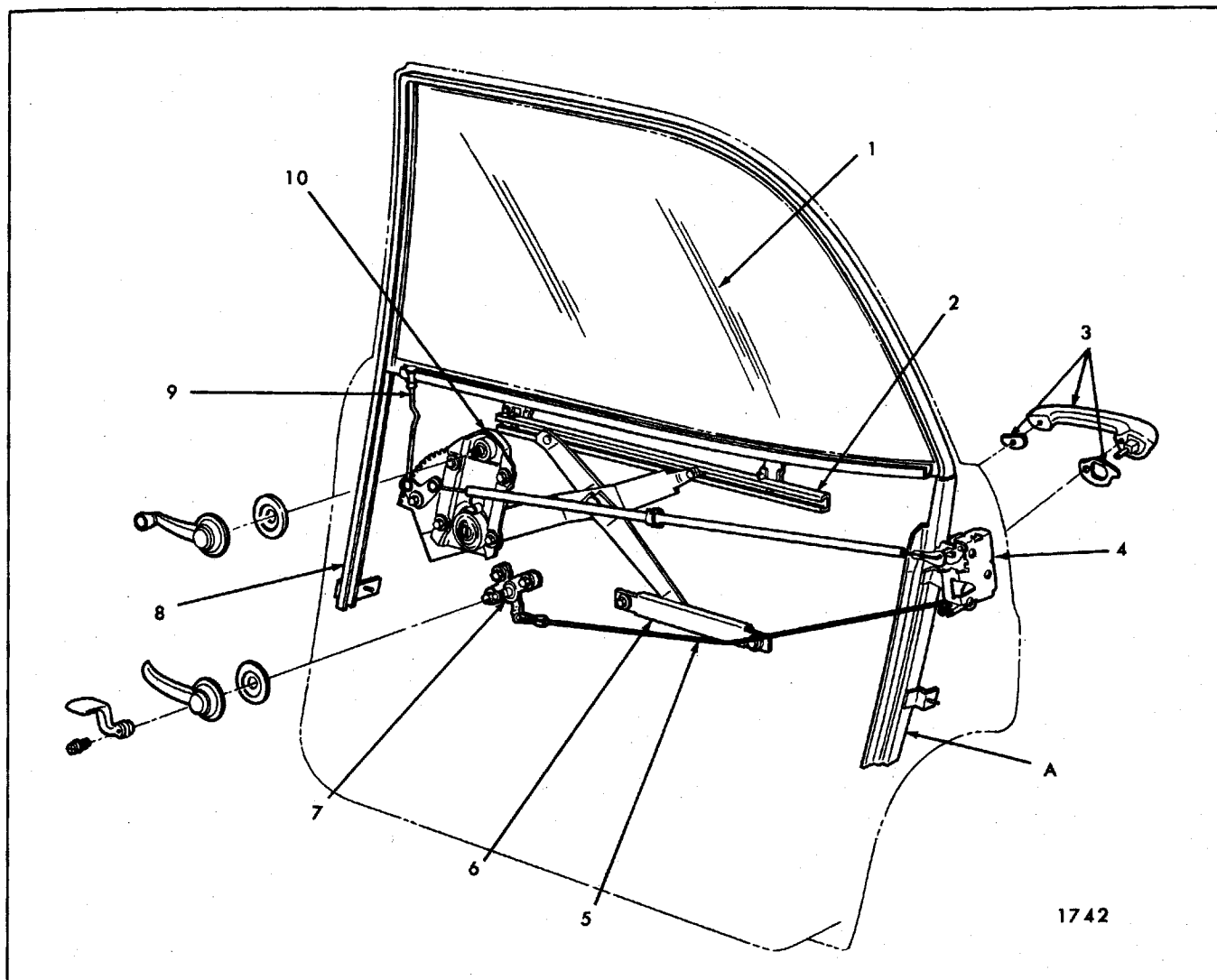

Fig. 7-111—Rear Door Hardware - "B" Closed Styles

- | | | |
|---------------------------------------|----------------------------------|--|
| 1. Window Assembly | 5. Remote Control Connecting Rod | 8. Glass Run Channel (Extends Completely Around Window to Point "A") |
| 2. Lower Sash Channel Cam | 6. Inner Panel Cam | 9. Inside Locking Rod |
| 3. Outside Handle and Sealing Gaskets | 7. Remote Control | 10. Window Regulator |
| 4. Door Lock | | |

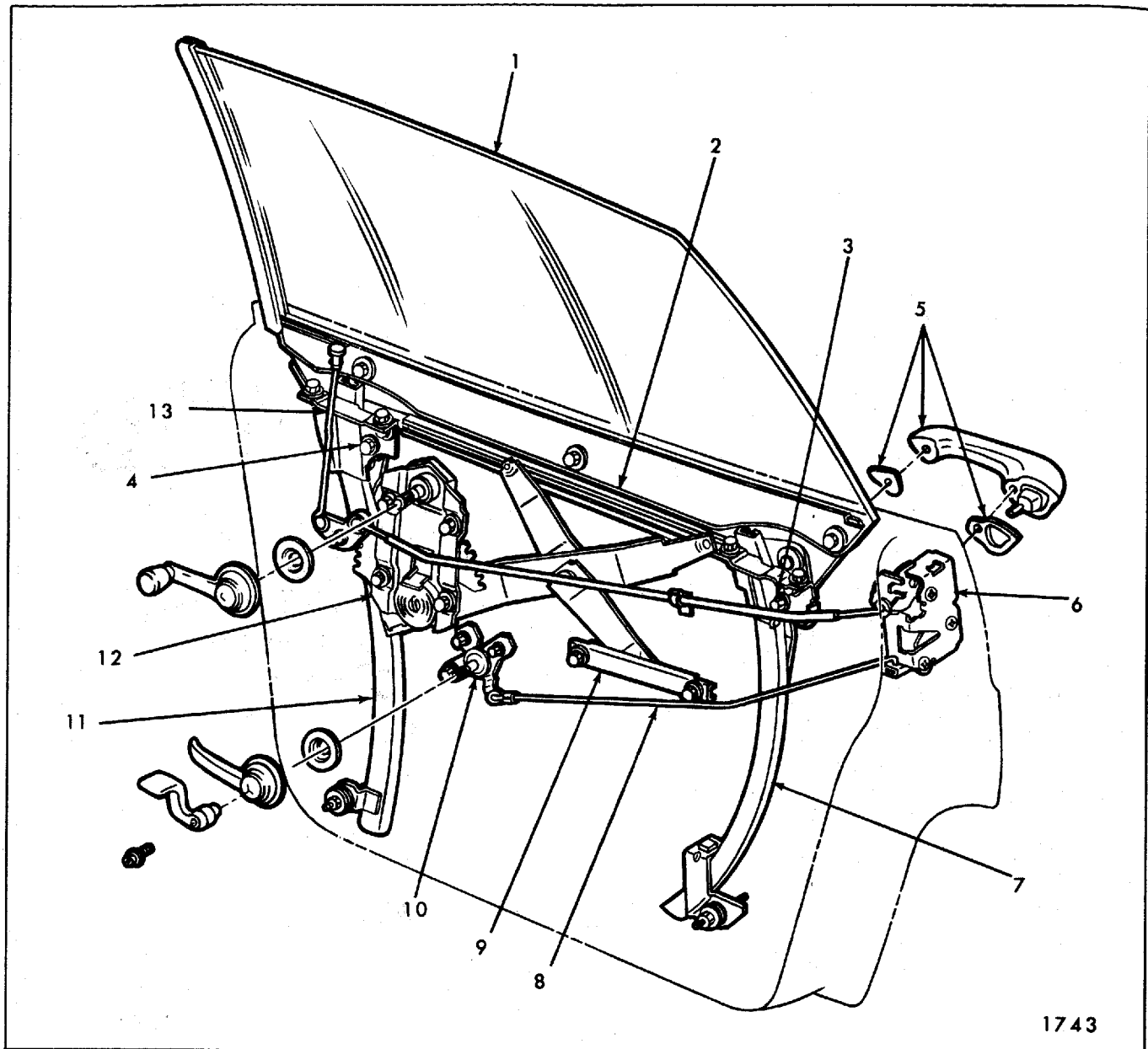

Fig. 7-112—Rear Door Hardware - "B-C 39" and "C-69" Except 68069 and 68169 Styles

- | | | | |
|---------------------------|---------------------------------------|----------------------------------|------------------------|
| 1. Window Assembly | 4. Window Front Upper Stop | 7. Window Rear Guide | 10. Remote Control |
| 2. Lower Sash Channel Cam | 5. Outside Handle and Sealing Gaskets | 8. Remote Control Connecting Rod | 11. Window Front Guide |
| 3. Window Rear Upper Stop | 6. Door Lock | 9. Inner Panel Cam | 12. Window Regulator |
| | | | 13. Inside Locking Rod |
2. On styles equipped with electric window regulators or vacuum operated locks, proceed as follows:
 - a. Remove door trim assembly and inner panel water deflector.
 - b. Disconnect wire harness connector from regulator motor and/or vacuum hoses from lock actuator.
 - c. Remove electrical conduit from door, then remove wire harness and/or vacuum hoses from door through conduit access hole.
 3. With door properly supported, remove upper and lower hinge attaching screws from door or center pillar (Fig. 7-118 or 7-119) depending on removal method being used. Then, remove door from body.

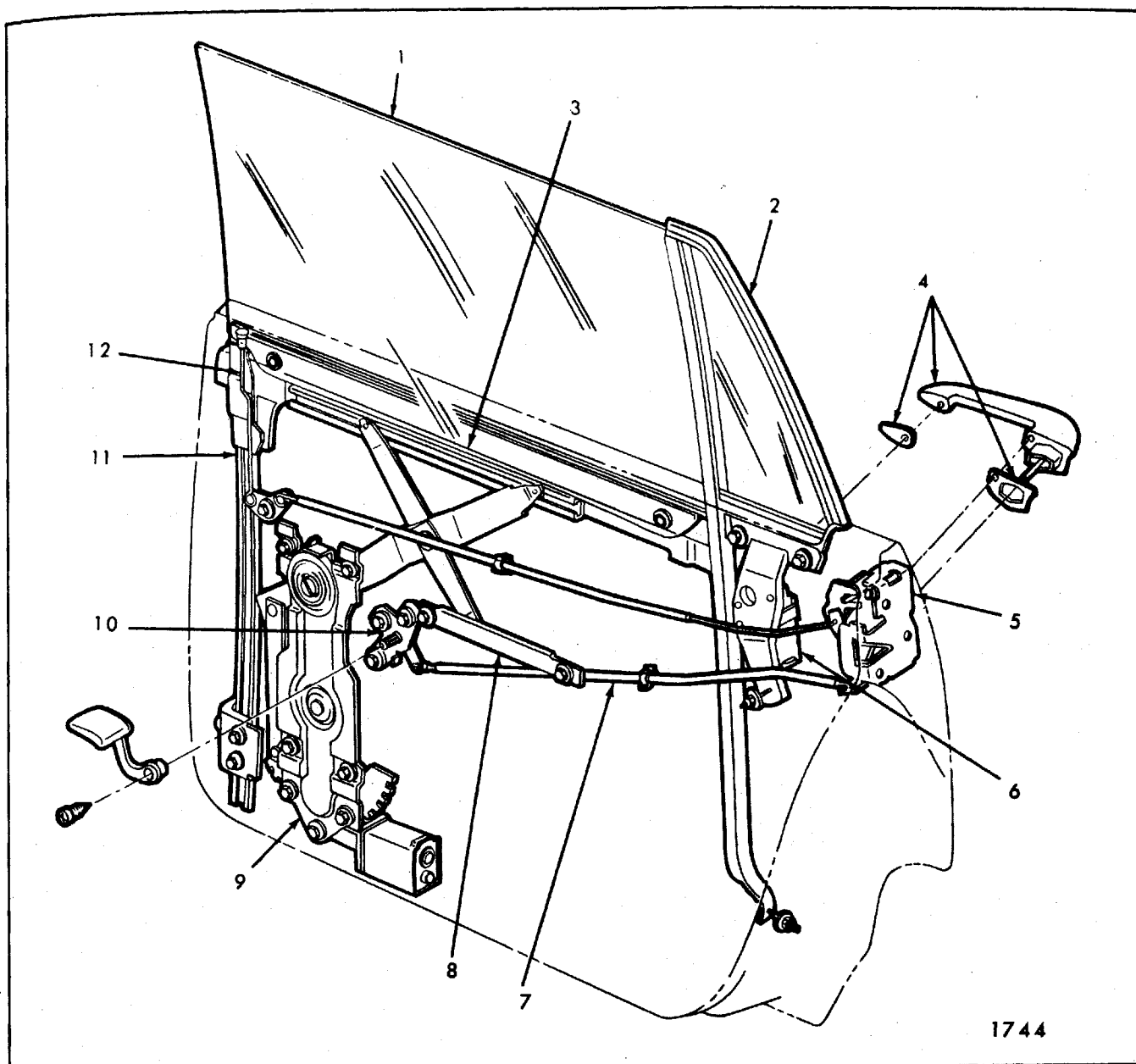
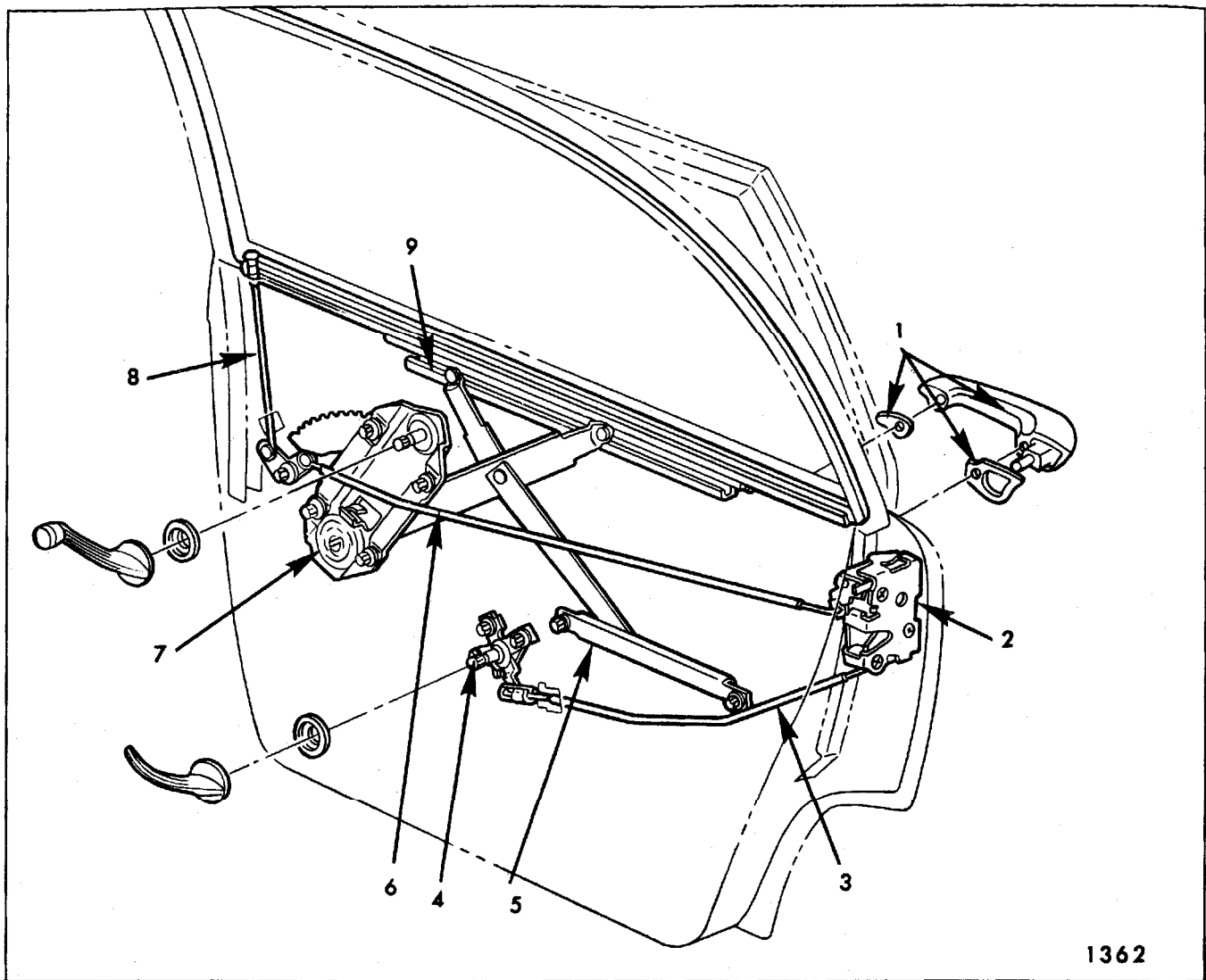

Fig. 7-113—Rear Door Hardware - 68069-68169 Styles

- | | | |
|---------------------------------------|--|--------------------------------------|
| 1. Window Assembly | 5. Door Lock | 9. Window Regulator (Power Operated) |
| 2. Ventilator Assembly | 6. Ventilator Regulator (Power Operated) | 10. Remote Control |
| 3. Lower Sash Channel Cam | 7. Remote Control Connecting Rod | 11. Window Front Guide |
| 4. Outside Handle and Sealing Gaskets | 8. Inner Panel Cam | 12. Inside Locking Rod |

Installation

1. Clean off old sealer at hinge attaching areas.
2. Apply a coat of heavy-bodied sealer to surface of hinge that mates with door or center pillar.
3. With aid of a helper, lift door into position and loosely install hinge screws. Align hinges within pencil marks previously made and tighten hinge screws.
4. Install all previously removed parts and check door for proper alignment.



1362

Fig. 7-114—Rear Door Hardware - "A" Closed Styles

- | | | | |
|---------------------------------------|----------------------------------|------------------------------|----------------------------------|
| 1. Outside Handle and Sealing Gaskets | 3. Remote Control Connecting Rod | 5. Inner Panel Cam | 8. Inside Locking Rod |
| 2. Lock Assembly | 4. Remote Control | 6. Lock to Locking Lever Rod | 9. Window Lower Sash Channel Cam |
| | | 7. Window Regulator | |

Adjustments

In-or-out and up-or-down adjustment is available at the door side hinge attaching screws. Fore-or-aft and a slight up-or-down adjustment is available at the body side (center pillar) hinge attaching screws except on "X" Styles.

CAUTION: On "B-C & Z" Styles, part or all of the upper hinge is made of die-cast aluminum. Therefore, when making adjustments do not subject hinge to excessive strain that could cause hinge to fail.

REAR DOOR LOCK REMOTE CONTROL

The remote control is secured to the door inner panel by three attaching bolts. On some styles it is mounted on the inboard surface of the door inner panel, and, on others, on the outboard surface. Figure 7-120 identifies "B" style installation, other styles are similar.

Removal and Installation:

1. Remove rear door trim assembly and inner panel water deflector.

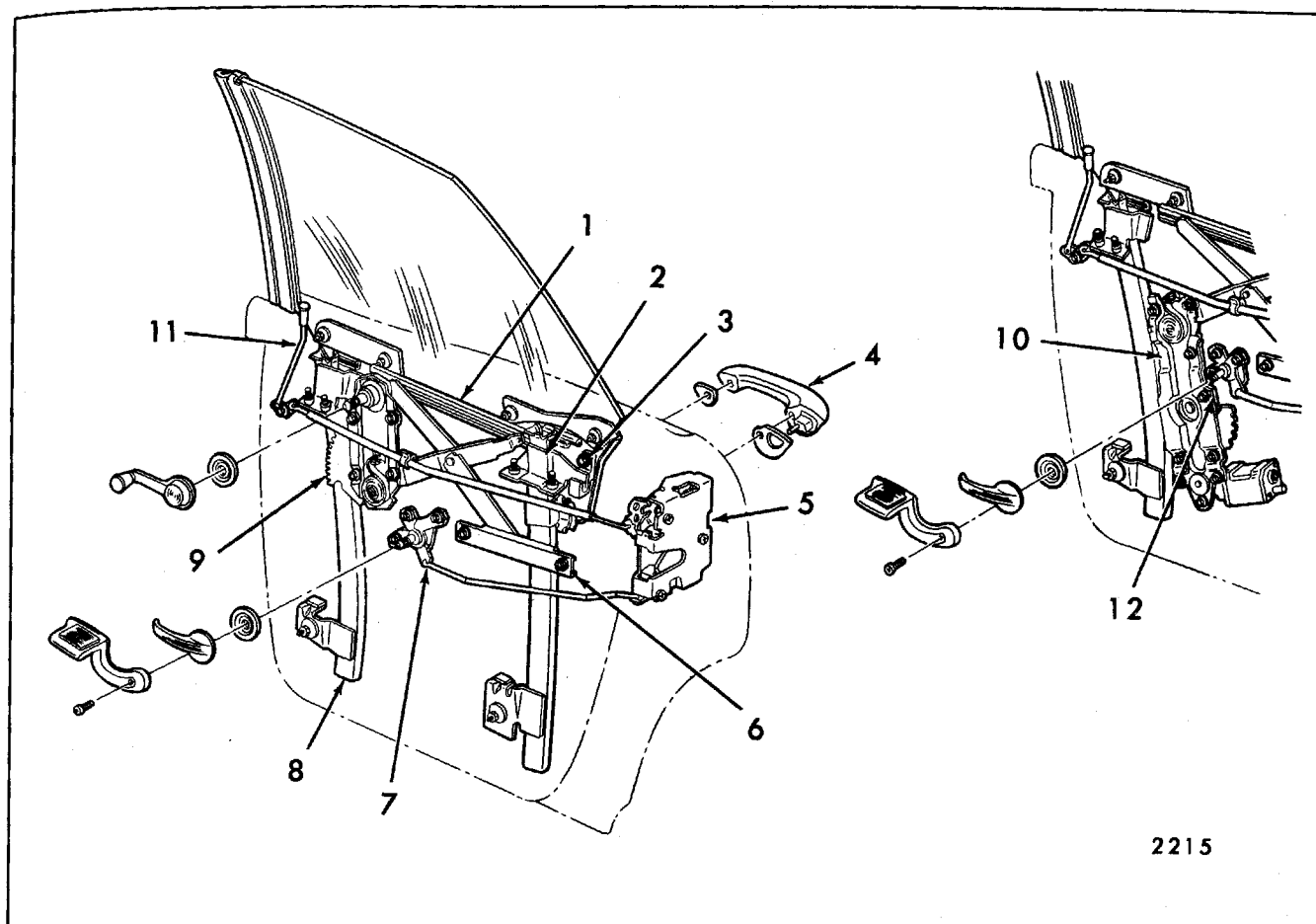

Fig. 7-115—Rear Door Hardware - "A-39" Styles

- | | | | |
|---------------------|---------------------------------------|-----------------------|--------------------------|
| 1. Sash Channel Cam | 4. Outside Handle and Sealing Gaskets | 6. Inner Panel Cam | 10. Regulator (Electric) |
| 2. Rear Guide | 5. Lock | 7. Remote Control | 11. Inside Locking Rod |
| 3. Rear Up-Stop | | 8. Front Guide | 12. Sector Gear Stop |
| | | 9. Regulator (Manual) | |

2. Remove remote control attaching bolts (Fig. 7-120).

3. Pivot remote to disengage it from remote control to lock connecting rod and remove remote control from door.

4. To install, reverse removal procedure. Make certain anti-rattle clip on lock connecting rod is properly positioned.

2. Remove door lock remote control.

3. Remove inside locking rod to lock connecting rod link attaching bolt (Fig. 7-120).

4. Remove lock attaching screws (Fig. 7-121 hardtop style shown, closed styles similar).

5. Disengage connecting rods from clips on door lock (for clip disengagement refer to "Door Lock Spring Clips" in Front and Rear door section) and remove lock from door.

REAR DOOR LOCK ASSEMBLY— "B-35-45 AND 69" STYLES

Removal and Installation:

1. Remove rear door trim assembly and inner panel water deflector.

6. To install, reverse removal procedure. Check lock for proper operation prior to installing water deflector.

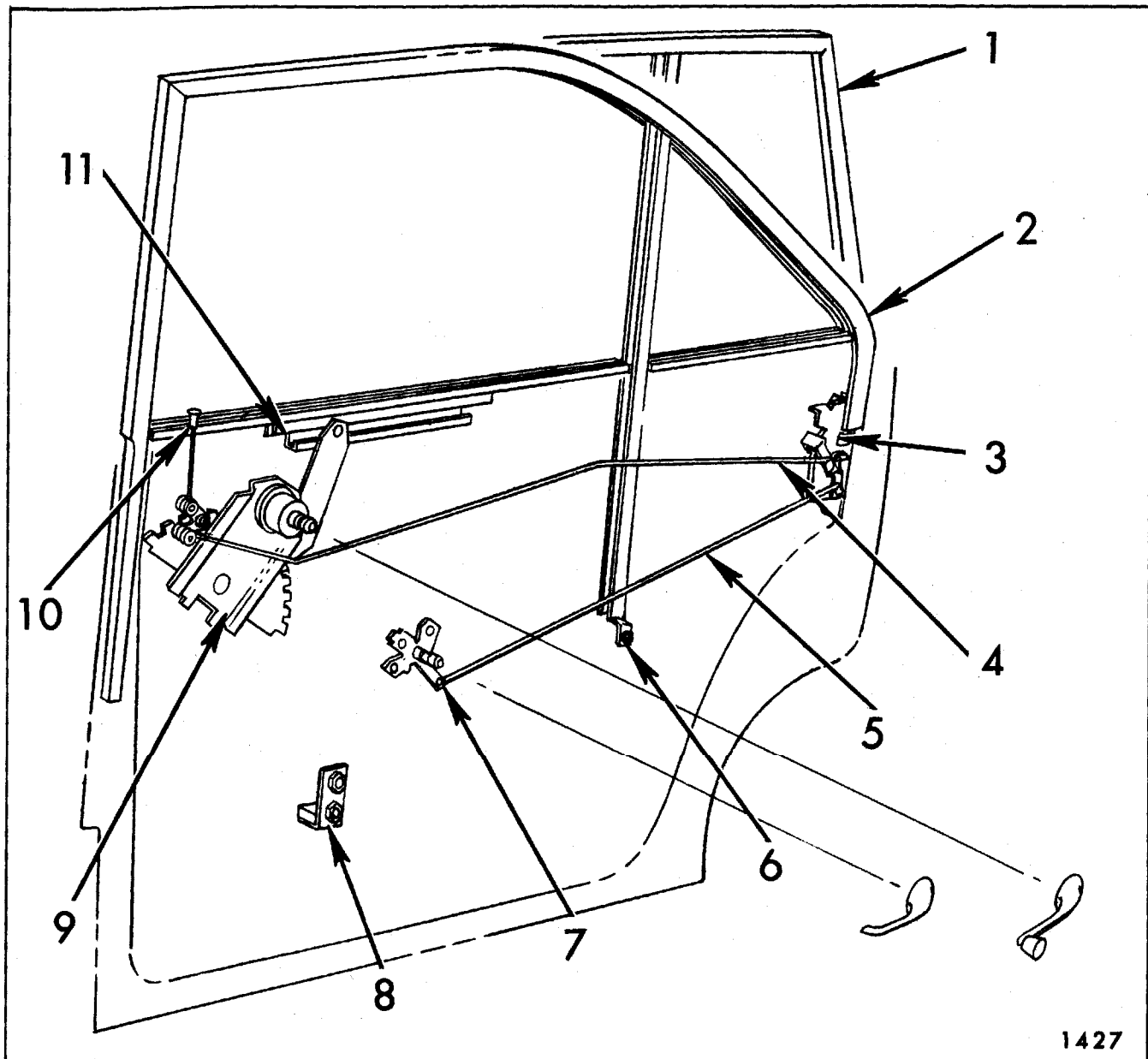

1427

Fig. 7-116—Door Hardware - "X-35 and 69" Styles

- | | | | |
|------------------------------|----------------------------------|------------------------------|-----------------------------------|
| 1. Upper Frame - "35" Styles | 4. Lock to Locking Lever Rod | 7. Remote Control Assembly | 10. Inside Locking Rod |
| 2. Upper Frame - "69" Styles | 5. Remote Control Connecting Rod | 8. Window Lower Stop | 11. Window Lower Sash Channel Cam |
| 3. Lock Assembly | 6. Ventilator Division Channel | 9. Window Regulator Assembly | |

REAR DOOR LOCK ASSEMBLY AND VACUUM ACTUATOR—ALL EXCEPT "B-35-45 AND 69" STYLES

Removal and Installation:

1. Remove door trim assembly and inner panel water deflector.
2. Operate glass to full-up position.
3. Working through access hole, disengage lock connecting rods from spring clips on door lock (for clip disengagement refer to "Door Lock Spring Clips" in Front and Rear Door Section).
4. Remove door lock attaching screws (Fig. 7-121) and remove lock from door.

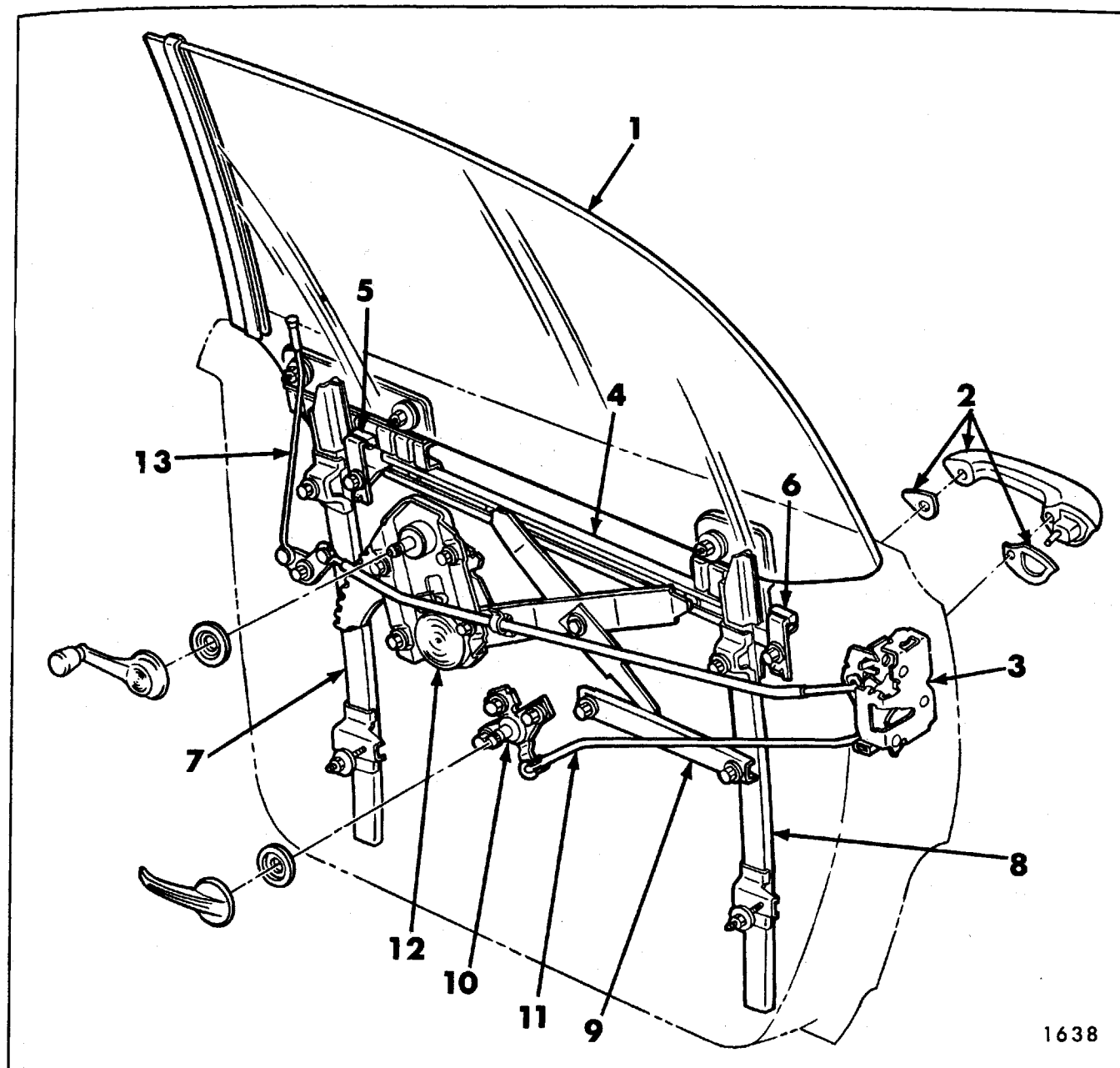

Fig. 7-117—Rear Door Hardware - "Z-39" Styles

- | | | | |
|---------------------------------------|---------------------------|-----------------------|-----------------------------------|
| 1. Window Assembly | 4. Lower Sash Channel Cam | 7. Window Front Guide | 11. Remote Control Connecting Rod |
| 2. Outside Handle and Sealing Gaskets | 5. Front Up-Travel Stop | 8. Window Rear Guide | 12. Window Regulator |
| 3. Door Lock | 6. Rear Up-Travel Stop | 9. Inner Panel Cam | 13. Inside Locking Rod |
| | | 10. Remote Control | |

5. To install, reverse removal procedure.

NOTE: On styles equipped with vacuum lock actuators (except 68069-169 Styles), disconnect vacuum hoses from actuator and remove lock and actuator as an assembly. Vacuum actuator

is attached to lock with screws which can be removed only in a bench operation (Fig. 7-122).

On 68069-169 Styles, remove vacuum actuator and link assembly screws (Fig. 7-123 and 7-124) and allow vacuum actuator to hang loose during lock removal

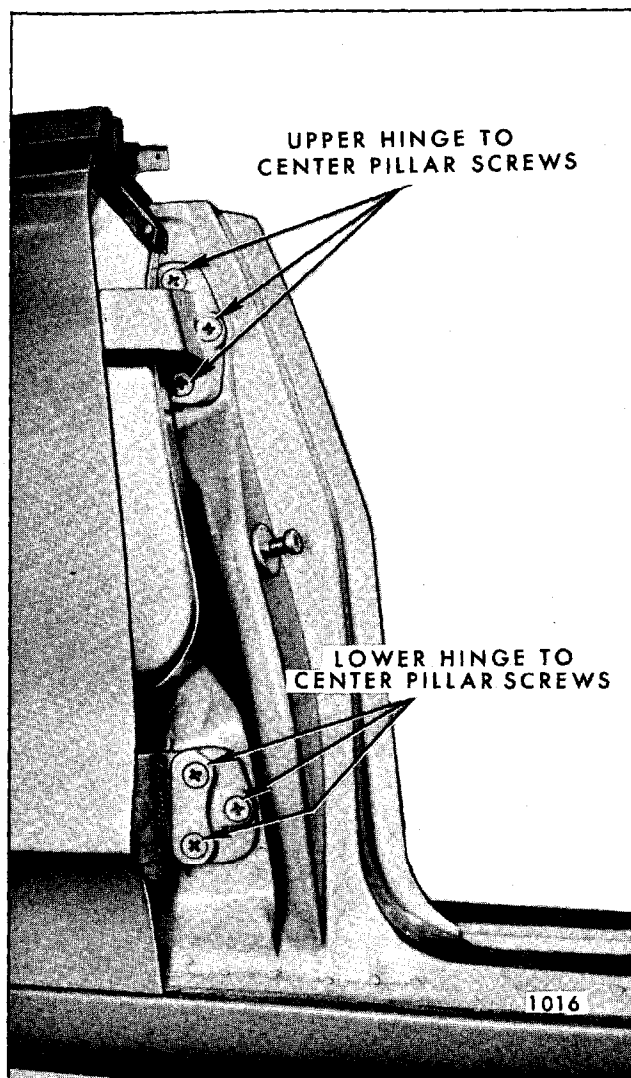

Fig. 118—Rear Door Hinge Attachment - "B" Style
Shown - Others Similar

REAR DOOR LOCK VACUUM ACTUATOR—68069 AND 68169 STYLES

Removal and Installation:

1. Remove door trim assembly and inner panel water deflector.
2. Disconnect inside locking rod from door lock spring clip (Refer to Front and Rear Door section under "Door Lock Spring Clips" for disengagement).
3. Remove inside locking to lock connecting rod link bolt (Fig. 7-123).
4. Disconnect vacuum hoses from vacuum actuator.

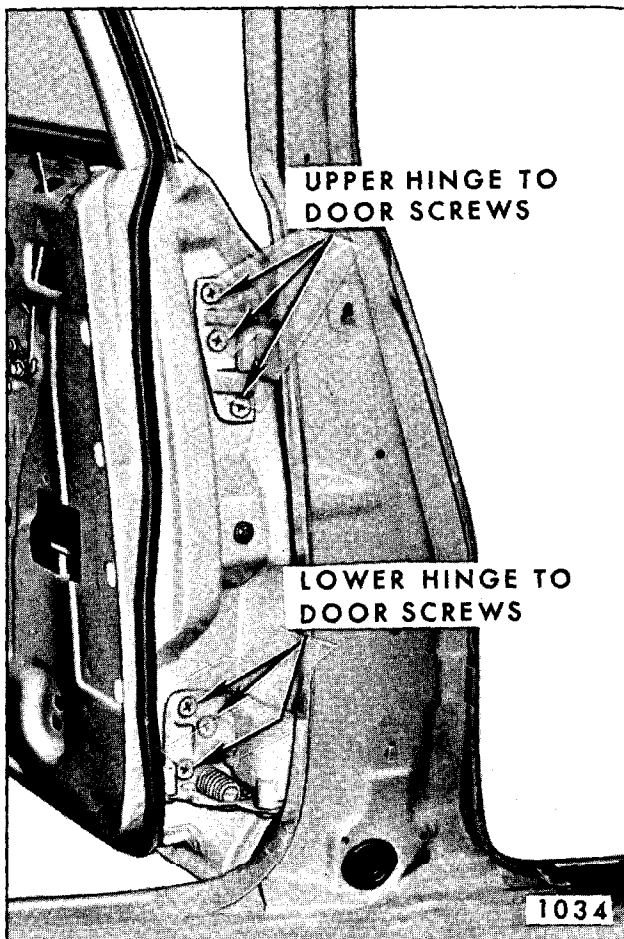

Fig. 7-119—Rear Door Hinge Attachment

5. Remove vacuum actuator and link assembly attaching screws (Fig. 7-123 and 7-124).
6. Pivot (rotate) actuator and linkage assembly, then, pull connecting rod forward through linkage. Remove actuator assembly from door.
7. To install, reverse removal procedure. Check lock operation prior to installing water deflector.

REAR DOOR INNER PANEL CAM— ALL EXCEPT "X" STYLES

Removal and Installation:

1. Remove door trim assembly and inner panel water deflector.
2. Remove inner panel cam attaching bolts (Fig. 7-125). Disengage cam from regulator balance arm roller and remove cam from door.

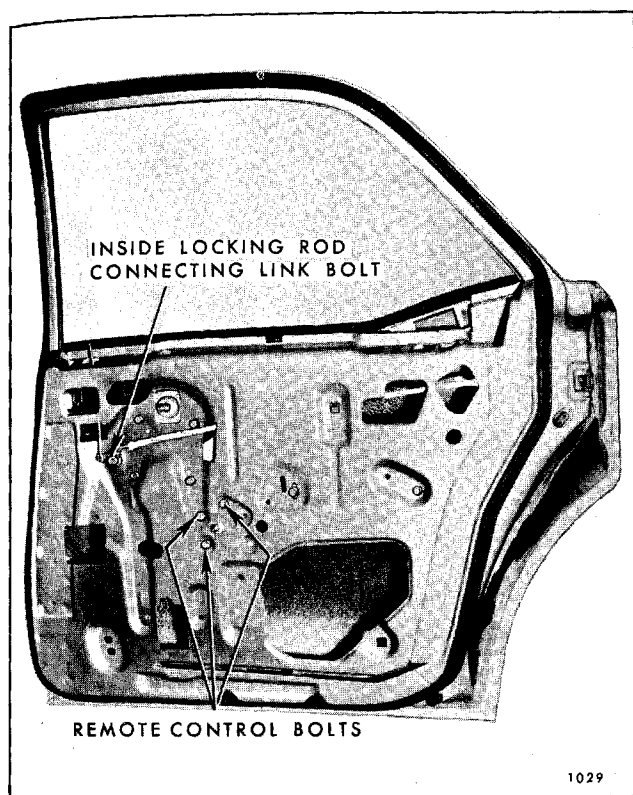

Fig. 7-120—Door Lock Remote Control - "B" Style
Shown - Other Similar

3. To install, reverse removal procedure. Adjust front end of cam for proper window operation. Correct adjustment of cam will prevent a rotated (cocked) door window.

WINDOW LOWER SASH CHANNEL CAM—ALL EXCEPT "X" STYLES

Removal and Installation:

1. Remove door trim assembly and inner panel water deflector.
2. Depending on body style and power options, operate window to position specified in Figure 7-125 for "A-B & C" Styles and Figures 7-126 and 7-127 for "Z" Styles.
3. On "Z" Styles, remove sash channel cam front screw first, then, raise window and remove rear screw. Support window and remove cam.
4. On "A-B & C" Styles, remove cam front and rear screws through access holes indicated and remove cam.
5. To install, reverse removal procedure.

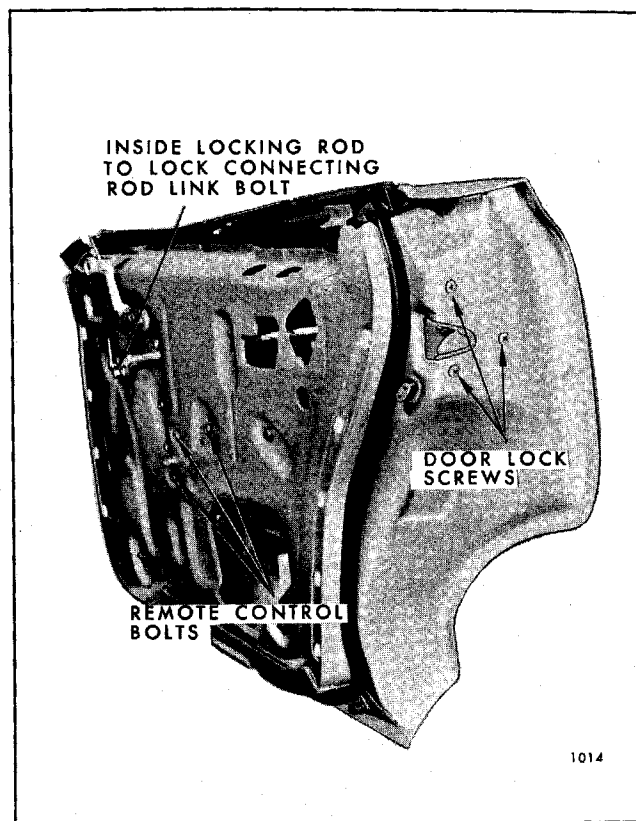

Fig. 7-121—Rear Door Lock Removal - Hardtop Style
Shown, Closed Style Similar

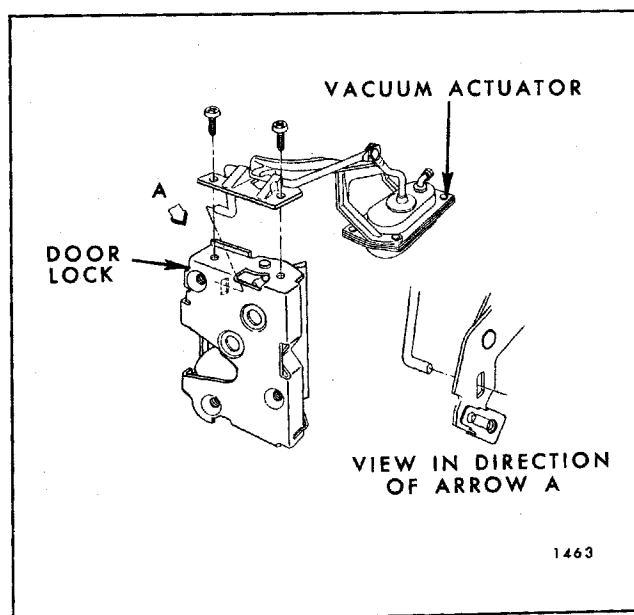

Fig. 7-122—Rear Door Vacuum Lock Actuator

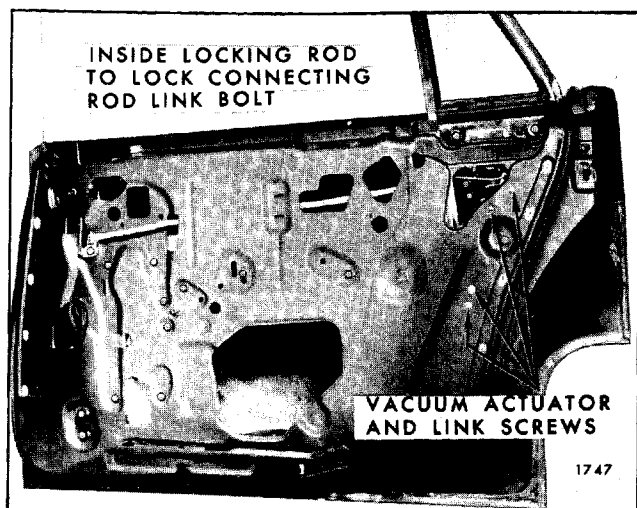

Fig. 7-123—Vacuum Lock Actuator Removal - 68069-68169 Styles

REAR DOOR WINDOW STATIONARY VENTILATOR DIVISION CHANNEL—“X-35 AND 69” STYLES

The stationary ventilator division channel is held into place by one division channel to door upper frame attaching screw and one lower adjusting stud and nut. This assembly acts as a rear door window rear glass run channel and also holds the stationary ventilator window in proper position.

Removal and Installation:

1. Remove door trim assembly and detach inner panel water deflector sufficiently to gain access to the lower adjusting stud and nut (see Fig. 7-128).
2. Remove door window lower stop.
3. Remove ventilator division channel lower adjusting stud and nut.
4. Carefully lower door window and remove division channel to door upper frame attaching screw (see Fig. 7-129).
5. Rotate upper section of division channel forward and inboard and remove assembly from door.
6. To install, reverse removal procedure. In or out and fore or aft adjustment of this part is available at the lower adjusting stud and nut only.

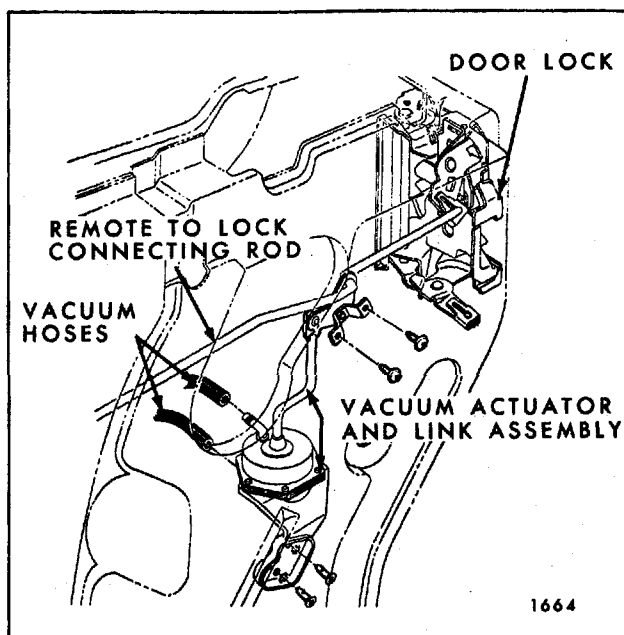

Fig. 7-124—Rear Door Vacuum Lock Actuator and Link Assembly - 68069-68169 Styles

REAR DOOR WINDOW STATIONARY VENTILATOR ASSEMBLY—“X-35 AND 69” STYLES

The rear door stationary ventilator assembly is set within a rubber channel and held into place by pressure of the ventilator division channel.

Removal and Installation:

1. Remove door trim assembly and detach inner panel water deflector.
2. Remove lower stop and carefully lower door window to extreme bottom of door.
3. Remove stationary ventilator division channel (see Fig. 7-128).
4. Pull stationary ventilator window forward and remove from door.
5. To install, reverse removal procedure.

GLASS RUN CHANNEL INNER AND OUTER STRIP ASSEMBLIES—“A-X & Z” STYLES

In order to remove the inner or outer strip assembly it is necessary to lower the window below its normal flush position with the belt line. The removal procedure varies according to body style.

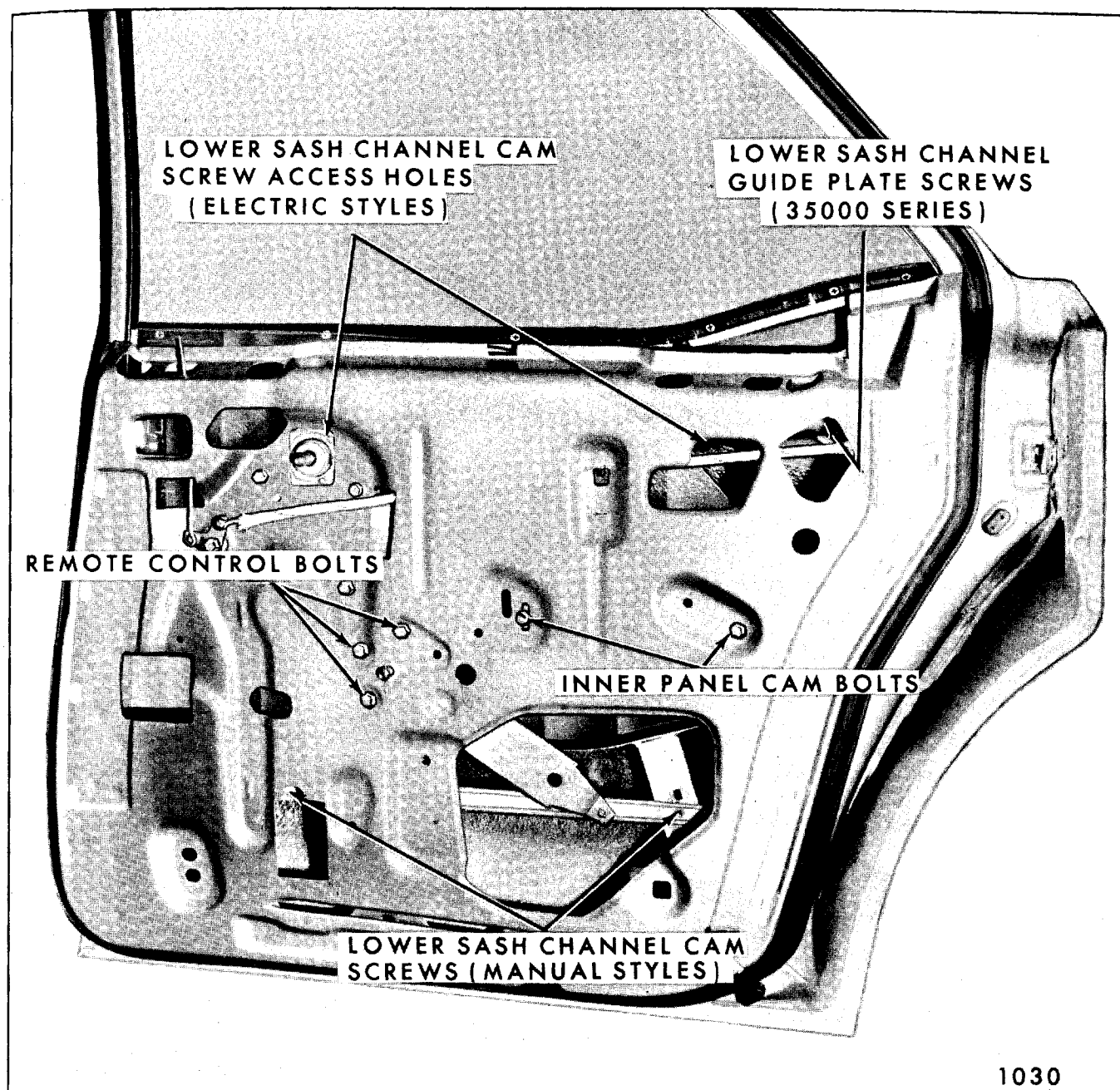

Fig. 7-125—Rear Door Hardware Attachment - "B" Styles Shown - "A" Styles Similar

1. On "Z" Body Styles, remove lower sash channel cam as previously described and lower window below its normal full-down position.
2. On "A" Closed Styles, remove rubber bumper from down-stop. On hardtop styles, loosen sector gear down-stop as specified in "Rear Door Window Adjustments".
3. On "X" Styles, remove bolt-on window lower stop.

When window has been lowered, proceed as follows:

1. Apply cloth-backed tape as protective cover to painted surfaces adjacent to strip assembly(ies) to be removed.
2. Insert a flat-blade tool that is slotted to fit over tang of clip between door panel return flange and strip assembly at clip locations (Fig. 7-130).

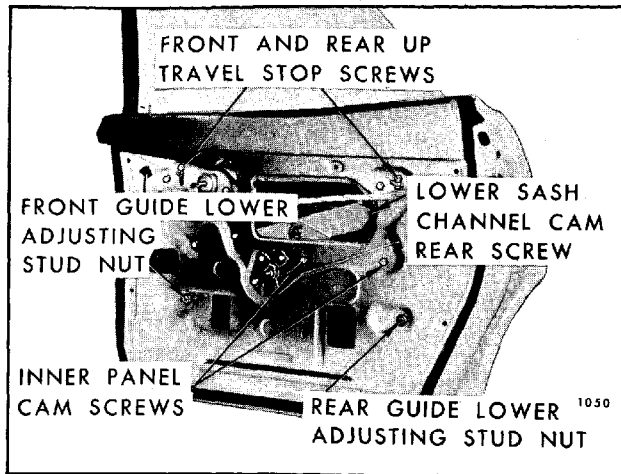

Fig. 7-126—Rear Door Hardware - "Z-39" Styles

3. Carefully pry clips from slots in panel and remove strip assembly.
4. To install, position strip assembly so that all clip tangs start into slots in door panel, then press at each clip location and engage clips.

Prior to installing strip assembly, reform clip tangs to assure positive retention when installed.

NOTE: To make strip assembly removal tool, make a 1/4" wide by 3/8" deep slot in a J-2272 headlining inserting tool or equivalent.

GLASS RUN CHANNEL OUTER STRIP ASSEMBLY—"B & C" STYLES

Removal and Installation:

1. Remove door trim assembly and inner panel water deflector.
2. Remove rubber bumper from door window lower stop and operate window to full-down position.
3. Remove screws securing glass run channel outer strip assembly to door outer panel return flange (Fig. 7-125) and remove strip assembly.
4. To install, reverse removal procedure.

REAR DOOR WINDOW ASSEMBLY—ALL CLOSED STYLES

The rear door window assembly consists of a frameless solid tempered safety plate glass window

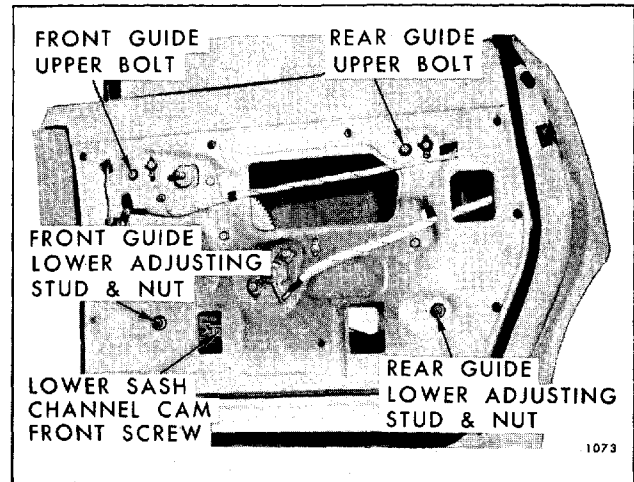

Fig. 7-127—Rear Door Hardware - "Z-39" Styles

and a pressed-on lower sash channel assembly. When handling window, make certain glass does not develop edge chips or deep scratches which could cause glass to shatter.

Removal and Installation ("B-35-45 and 69" Styles)

1. Remove door trim assembly and inner panel water deflector.
2. On 35000 Series "69" Styles, lower window approximately 3" down from full-up position. Remove lower sash channel rear guide plate attaching screws through upper rear access hole and remove guide plate (Fig. 7-125).
3. Operate window to position shown in Figure 7-125 and remove lower sash channel cam attaching screws (window slightly down on electric styles and full down on manual).
4. Remove glass run channel front and rear attaching bolts (Fig. 7-131 and 7-132).
5. Pivot window in opening (raise front edge) to disengage front and rear edges of glass from glass run channel, then remove window inboard of door upper frame.
6. To install, reverse removal procedure.

Removal and Installation ("X-35 and 69" Styles)

1. Raise door window; remove door trim assembly and detach inner panel water deflector.
2. Remove rear door window stationary ventilator assembly-division channel and glass.

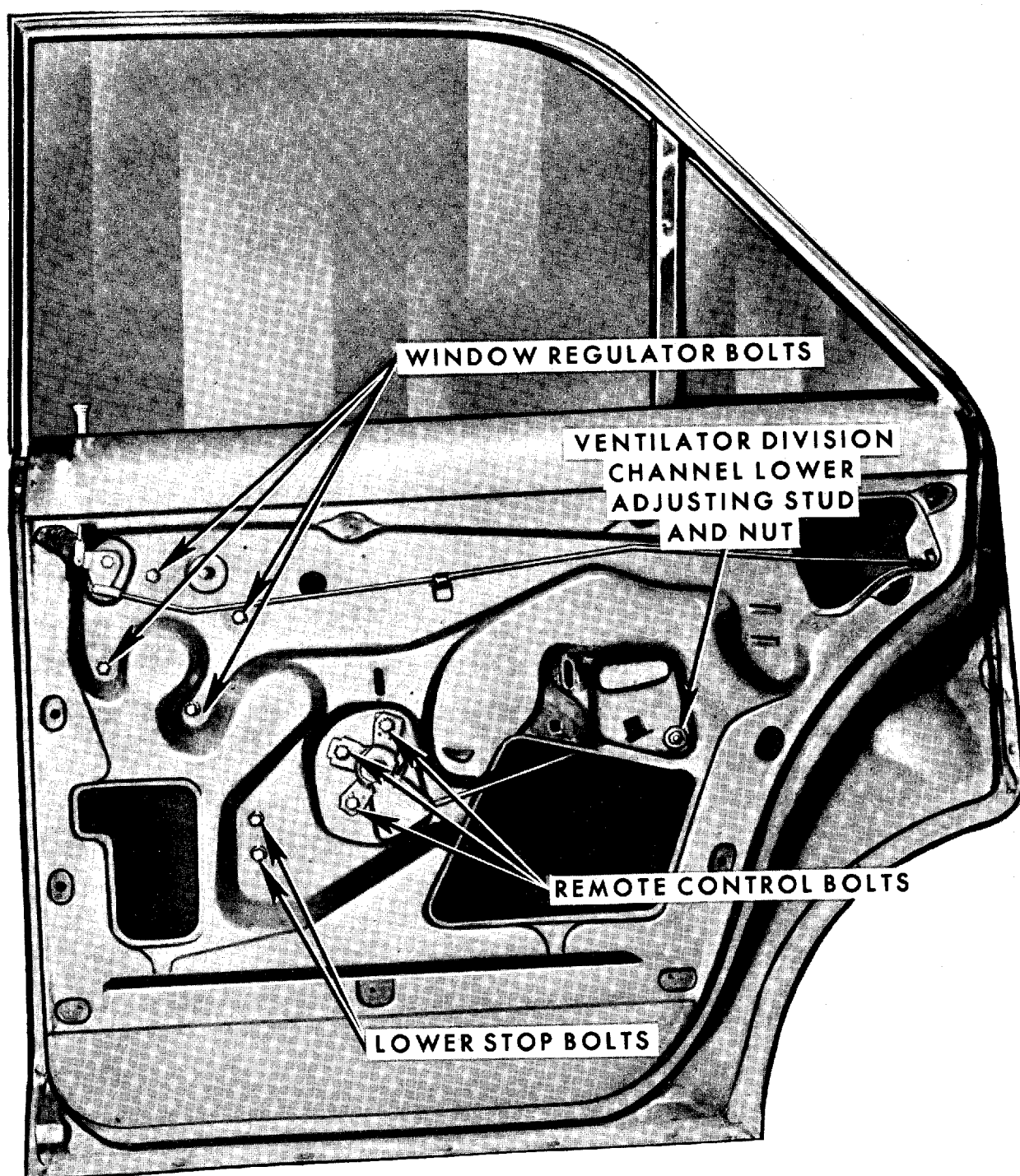

1432

Fig. 7-128—Rear Door Hardware - "X-35 and 69" Styles

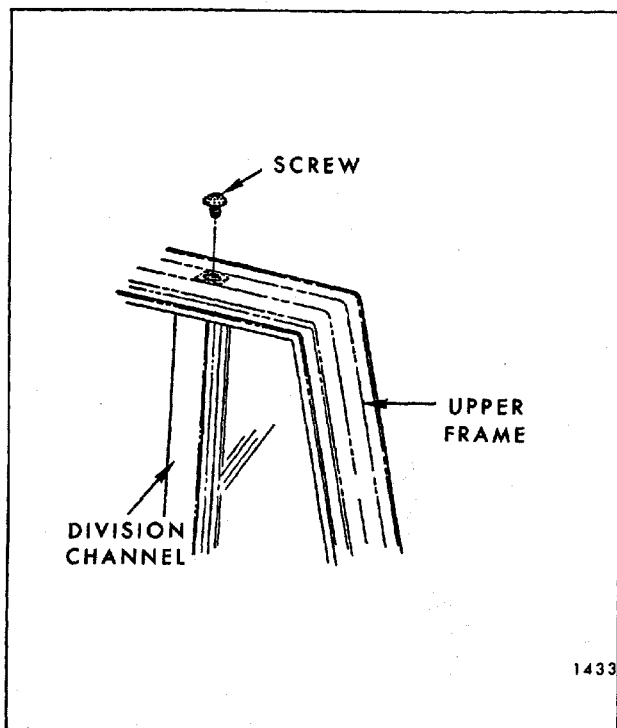

Fig. 7-129—Rear Door Ventilator Attachment - "X" Styles

3. Slide glass rearward to disengage regulator lift arm roller from lower sash channel cam and remove window from door inboard of door window frame (see Fig. 7-128).
4. To install, reverse removal procedure. Prior to installation of water deflector, lubricate sash channel cam with 630AAW Lubriplate or equivalent. Check operation of window and, where required, adjust window assembly as described under "Rear Door Window Adjustments".

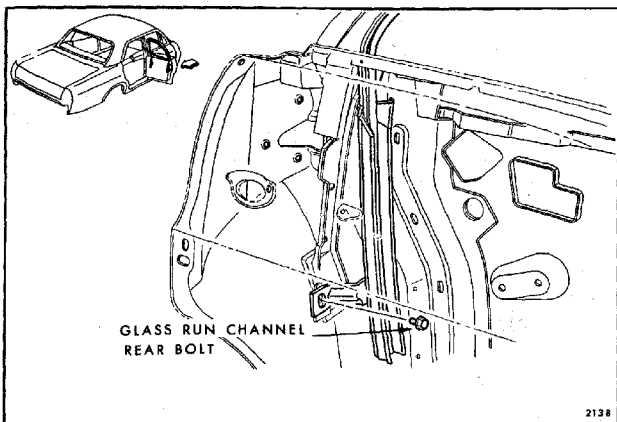

Fig. 7-131—Glass Run Channel Retention - "B" Closed Styles Except 45-46000 Series

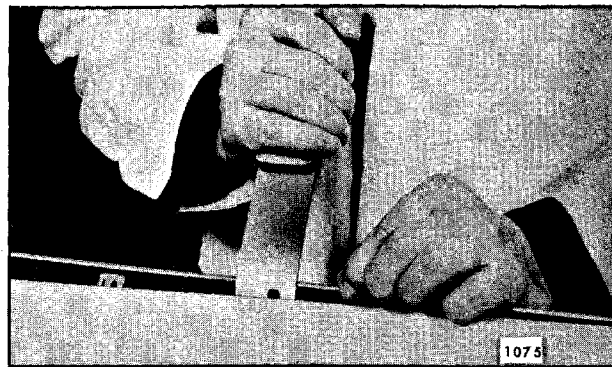

Fig. 7-130—Glass Run Channel Inner-Outer Strip Removal - "A-X & Z" Styles

Removal and Installation ("A-35-55-65 and 69" Styles)

1. Lower door window, remove door trim pad and detach inner panel water deflector.
2. Remove inner panel cam. On styles not equipped with a hang-on trim pad, remove inner belt seal (draft strip).
3. Rotate rear edge of glass downward until front edge is free of door upper frame and lower sash channel cam slides off of regulator balance arm roller.
4. Rotate glass upward and forward to disengage lower sash channel cam from regulator lift arm roller and remove door window outboard of door upper frame (See Fig. 7-133 View A and B).
5. To install, reverse removal procedure.

REAR DOOR WINDOW ASSEMBLY— ALL "B-C 39" STYLES AND ALL "C-69" STYLES EXCEPT 68069 AND 68169

The rear door window assembly consists of a frameless piece of solid tempered safety plate glass and a bolt-on lower sash channel. With this design, the window is removed from the door as an assembly and door glass replacement made in a bench operation.

Figures 7-134 and 7-135 are exploded views of the "39 and 69" Style (except 68069 and 68169 Styles) rear door window assemblies and identify the specific components and their assembly sequence.

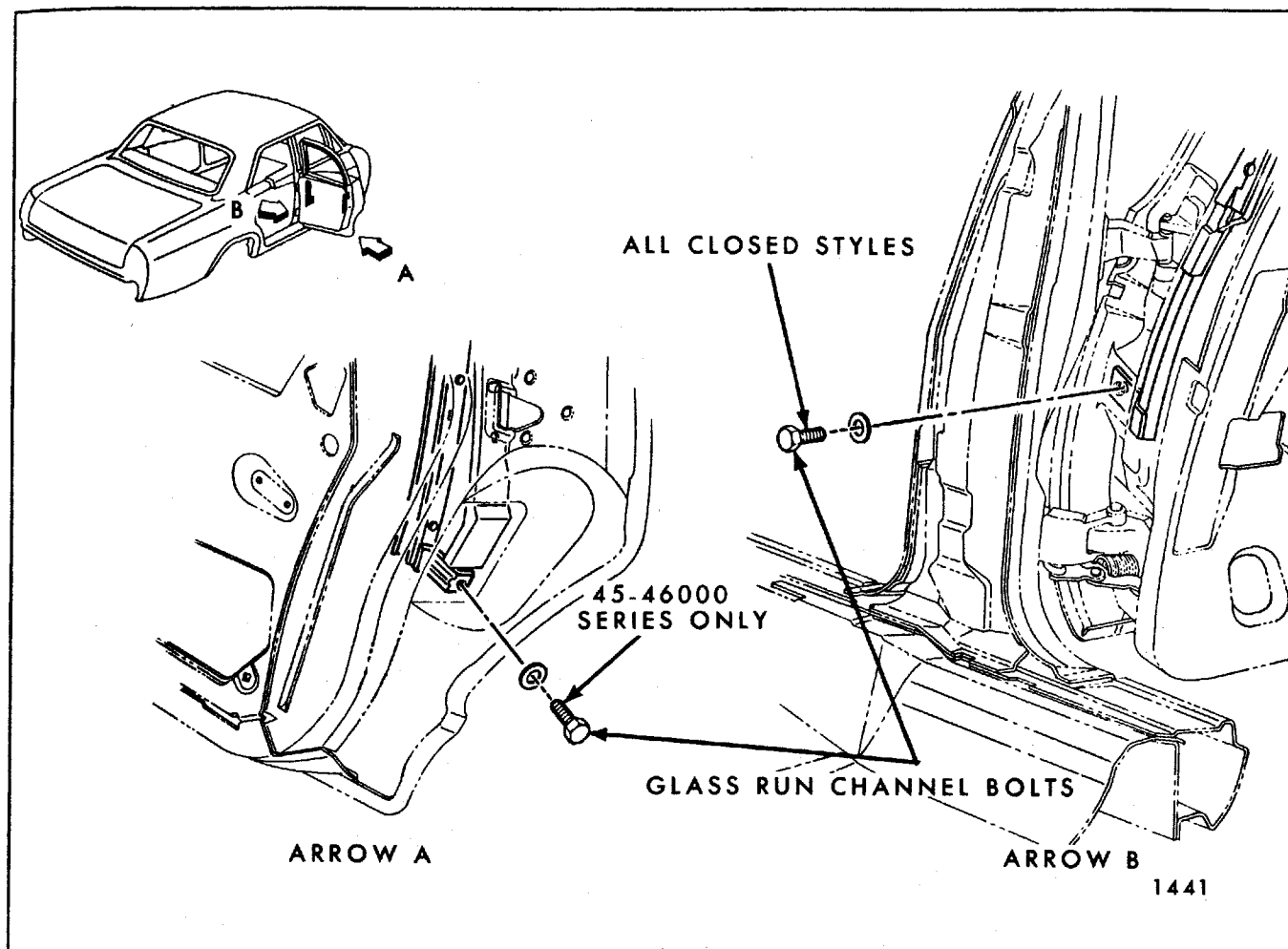

Fig. 7-132—Glass Run Channel Retention - "B" Closed Styles

NOTE: When replacing door glass, replace glass to sash channel spacers. When installing glass to sash channel nuts, torque to 60 inch lbs. (5 foot lbs.).

Removal and Installation:

1. Remove door trim assembly and inner panel water deflector.
2. Loosen front and rear upper stop attaching bolts "D & E" (Fig. 7-136) and rotate stops into vertical position (Fig. 7-137).
3. Loosen front and rear guide upper attaching bolts "A & C" and lower adjusting stud nuts "F & H" (Fig. 7-136).
4. Operate window to required position as shown in Figure 7-136 and remove rear lower sash channel cam attaching screws at "B" or "G". (Window almost full-down for manual styles, and almost full-up for electric styles).

NOTE: On electric styles it is necessary to remove electric switch plastic cover from inner panel to gain access to sash channel cam front attaching screw.

5. Lift window and remove it from door at belt line.
6. To install, reverse removal procedure. Adjust guides and wedge plates for proper window operation as described below.

Adjustments

1. To adjust the top of the door glass in-or-out in relation to the side roof rail weatherstrip, loosen the front and rear guide lower adjusting stud nuts "F & H" (Fig. 7-136). Adjust studs in-or-out as required and tighten stud nuts.
2. To adjust window assembly fore-or-aft, or in-or-out, loosen front and rear guide upper attaching bolts "A & C" and lower adjusting

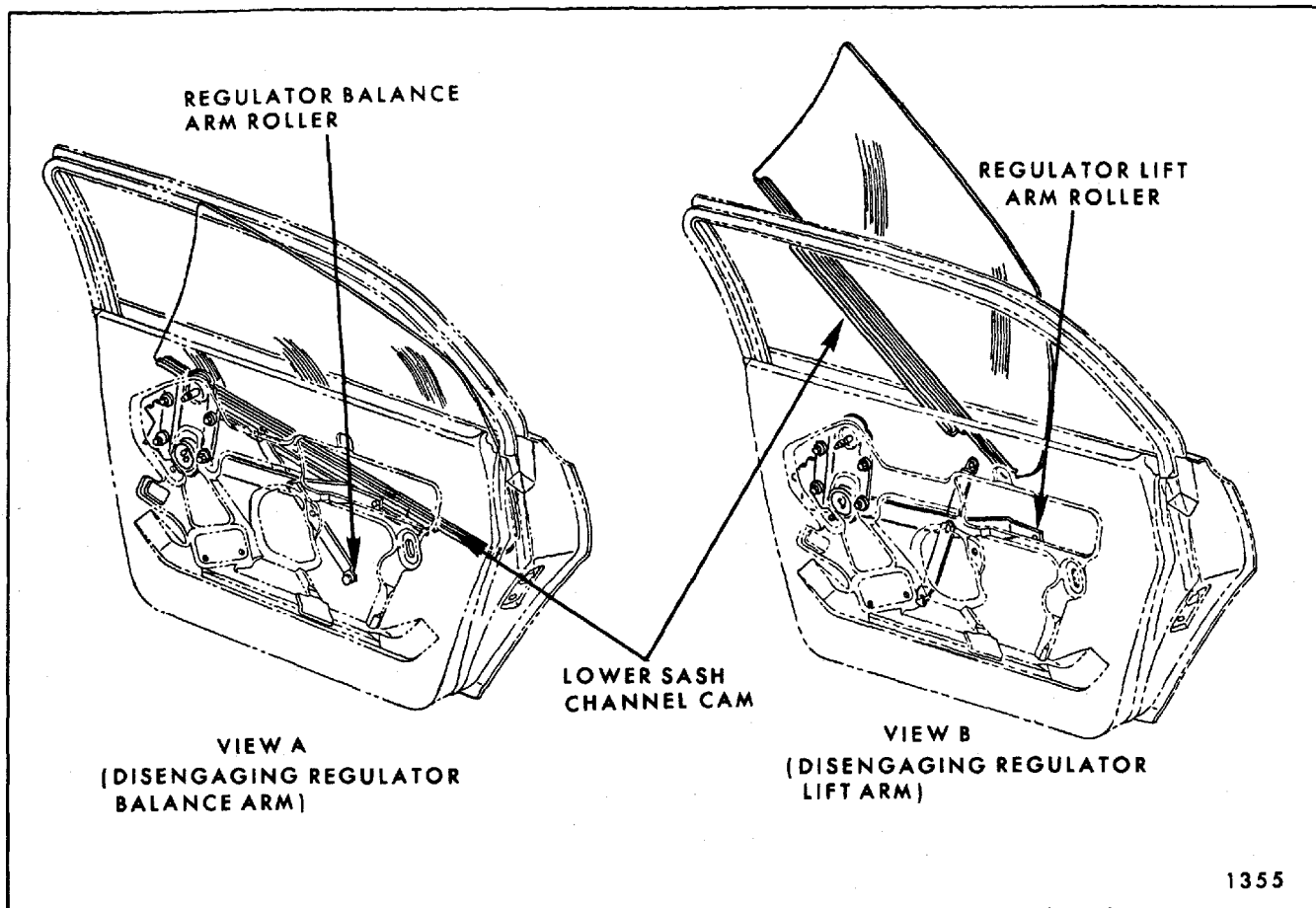

Fig. 7-133—Rear Door Window Removal - "A" Closed Styles

stud nuts "F & H" (Fig. 7-136). Position window as desired and tighten guide attachments.

3. To correct a window that is rotated (cocked) in the opening, loosen inner panel cam attaching bolts "I" (Fig. 7-136). Adjust front of cam up-or-down as required and tighten bolts.
4. To adjust front or rear edge of glass in-or-out, loosen front or rear guide upper attaching bolts "A & C" (Fig. 7-136). Adjust guide in-or-out as required and tighten bolts.
5. To obtain proper up-travel of window for good contact with side roof rail weatherstrip, loosen front and rear upper stop attaching bolts "D & E" (Fig. 7-136). Operate window to desired up position. Then, tighten stop bolts while exerting slight downward force on stops.

NOTE: Upper stop adjustment can correct a slightly rotated (cocked) window, however, for major adjustment of this type, use inner panel cam adjustment.

REAR DOOR WINDOW ASSEMBLY— 68069 AND 68169 STYLES

The rear door window assembly consists of a frameless piece of solid tempered safety plate glass and a bolt-on lower sash channel assembly. With this design, the window is removed as an assembly and door glass replacement made in a bench operation.

Figure 7-138 is an exploded view of the rear door window and identifies the various components and their assembly sequence.

NOTE: When replacing door glass, replace glass to sash channel spacers. When installing nuts on glass to sash channel attaching bolts, torque to 60 inch lbs. (5 foot lbs.).

Removal and Installation:

1. Remove rear door trim assembly and inner panel water deflector.

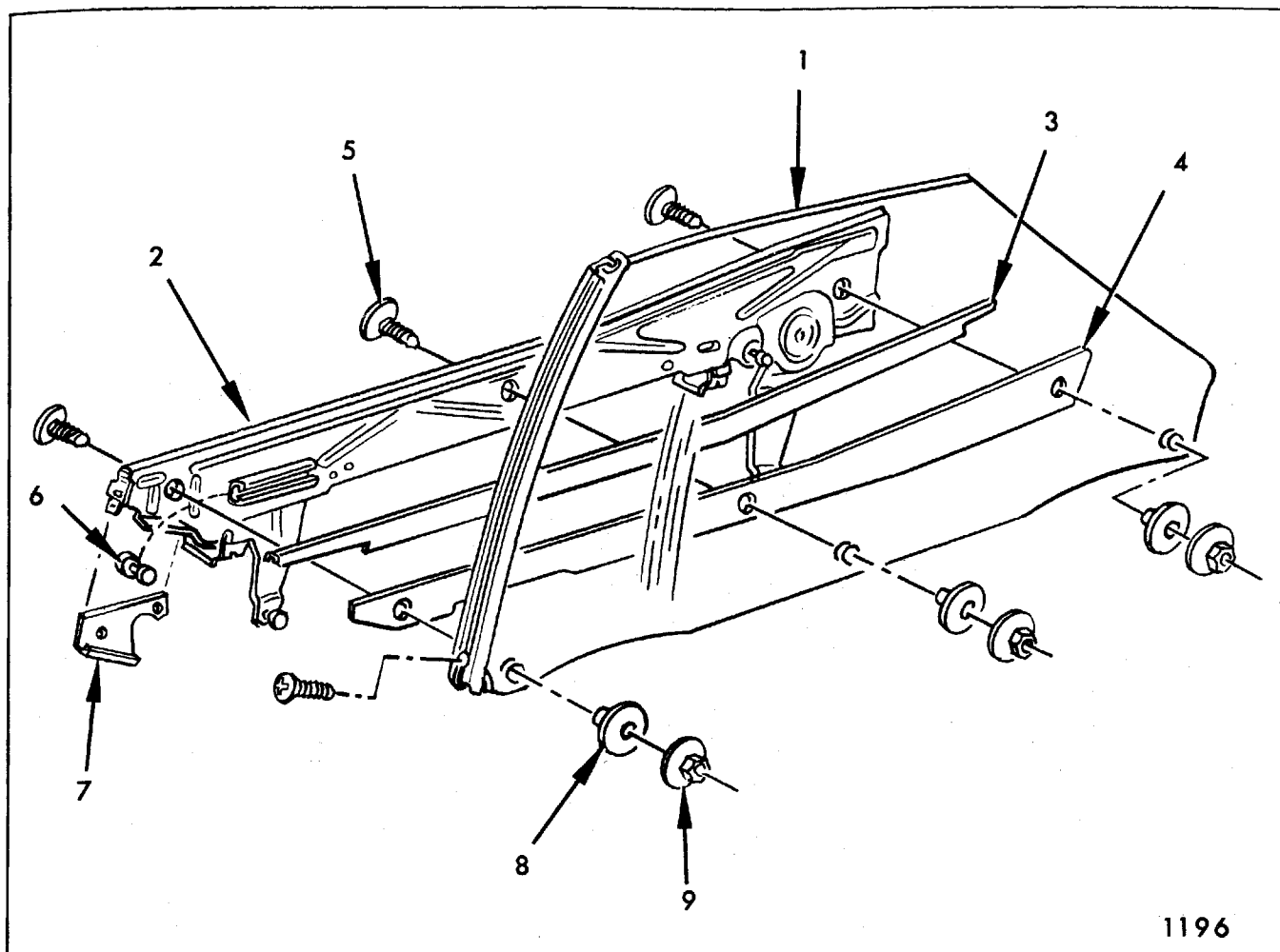

Fig. 7-134—Rear Door Window Assembly - "B & C-39" Styles Shown - "A" Similar

- | | | |
|------------------------------------|--|--|
| 1. Rear Door Window Assembly | 4. Lower Sash Channel Lower Filler | 7. Lower Sash Channel Front Filler Plate |
| 2. Lower Sash Channel Assembly | 5. Glass to Lower Sash Channel Bolts | 8. Glass to Lower Sash Channel Spacer |
| 3. Lower Sash Channel Upper Filler | 6. Lower Sash Channel Front Cam Roller | 9. Glass to Lower Sash Channel Nuts |

2. With glass in full-up position, remove front and rear up-travel stop attaching bolts, two bolts on front stop, one on rear (Figs. 7-139 and 7-140).
3. Lower glass approximately 2" and remove lower sash channel cam attaching screws (Fig. 7-141).
4. While supporting glass by pressing it rearward into ventilator division channel, remove lower sash channel to guide plate attaching nuts (Fig. 7-140).
5. Disengage lower sash channel from weld-on studs on sash channel guide plate and remove window assembly from door.

6. To install, reverse removal procedure. Adjust window for proper operation and alignment as described under "Rear Door Window and/or Ventilator Adjustments".

REAR DOOR VENTILATOR REGULATOR—68069 AND 68169 STYLES

Removal and Installation:

1. Remove door trim assembly and inner panel water deflector. Operate door glass to full-up position.
2. Disconnect ventilator regulator wire harness connector at regulator motor.

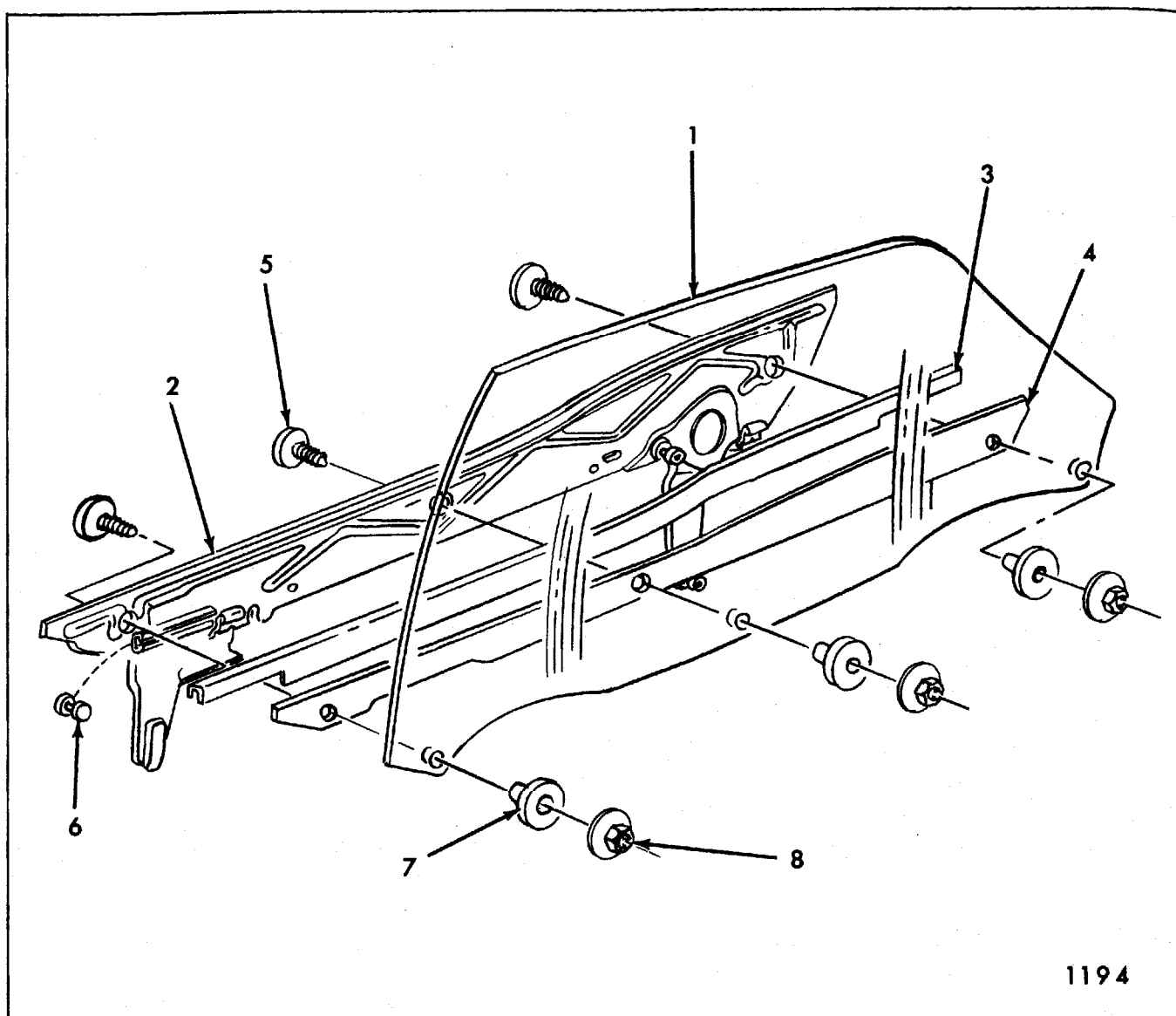

1194

Fig. 7-135—Rear Door Window Assembly "C-69" Styles Except 68069-68169 Styles

- | | | | |
|--------------------------------|--|--|--|
| 1. Rear Door Window Assembly | 3. Lower Sash Channel Upper Outer Filler | 5. Glass to Lower Sash Channel Bolts | 7. Glass to Lower Sash Channel Spacers |
| 2. Lower Sash Channel Assembly | 4. Lower Sash Channel Lower Outer Filler | 6. Lower Sash Channel Front Cam Roller | 8. Glass to Lower Sash Channel Nuts |

3. Remove ventilator "T-shaft" to regulator attaching bolt (Fig. 7-142).
4. Remove ventilator regulator to ventilator frame attaching bolts (Fig. 7-142).
5. Disengage ventilator regulator from ventilator "T-shaft" and remove regulator through access hole.
6. To install, reverse removal procedure.

REAR DOOR VENTILATOR ASSEMBLY— 68069 AND 68169 STYLES

Removal and Installation:

1. Remove rear door ventilator regulator as previously described.
2. Remove ventilator lower frame and ventilator division channel lower adjusting stud nuts (Fig. 7-142).

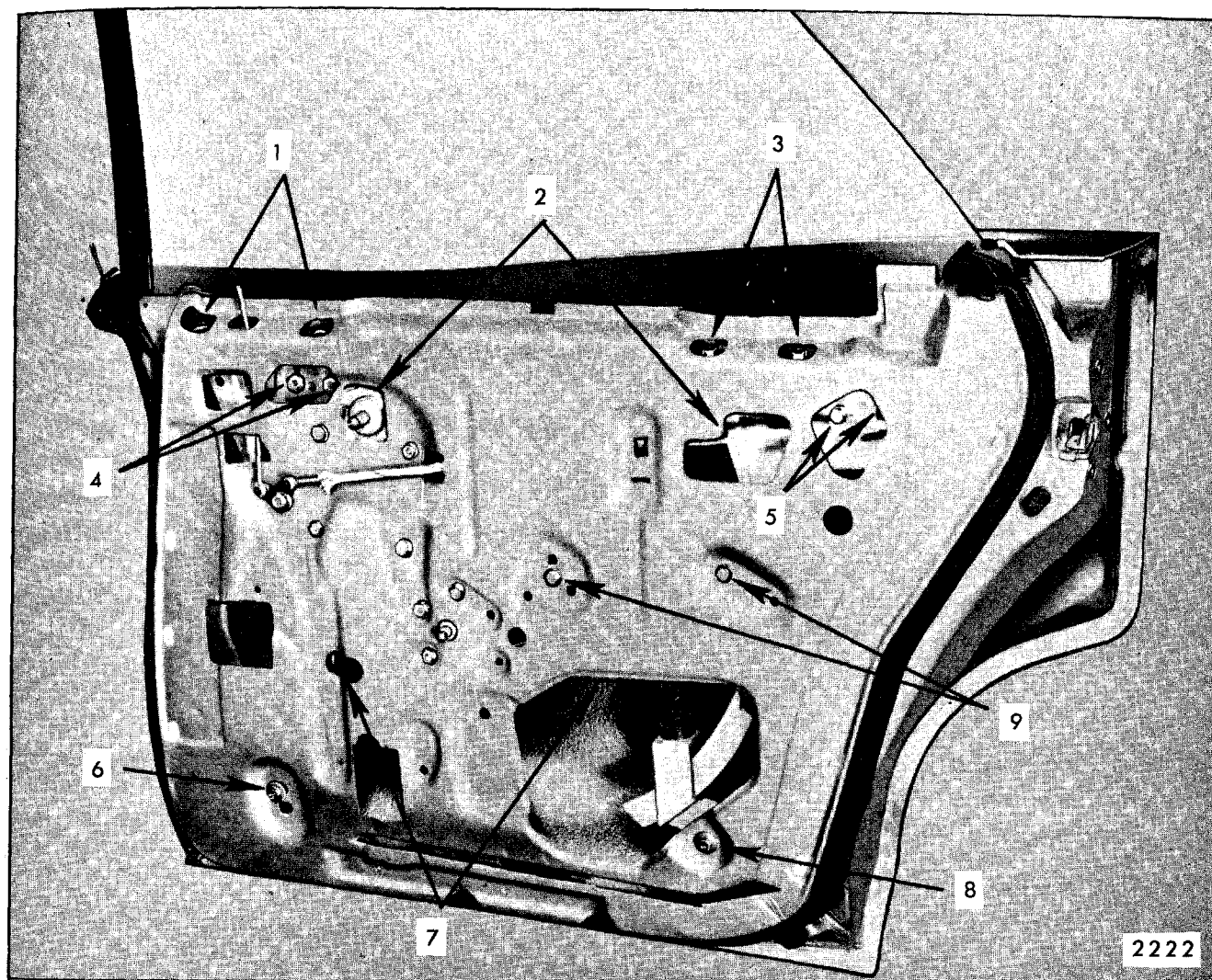

Fig. 7-136—Rear Door Hardware Attachment "B-C 39 and C-69" Except 68069-68169 Styles

- | | | | |
|---|---------------------------|---|--|
| 1. Front Guide Upper Bolts | 3. Rear Guide Upper Bolts | 6. Front Guide Lower Adjusting Stud Nut | 8. Rear Guide Lower Adjusting Stud Nut |
| 2. Lower Sash Channel Cam Screw Access Holes (Electric) | 4. Front Upper Stop Bolts | 7. Lower Sash Channel Cam Screw Access Holes (Manual) | 9. Inner Panel Cam Bolts |
| | 5. Rear Upper Stop Bolts | | |

3. Remove ventilator lower frame attaching bolts (Fig. 7-142).
4. Lift ventilator assembly up approximately 3" and remove ventilator lower frame adjusting stud through access hole.
5. Lift ventilator upward and remove from door. Twist ventilator 90° to remove division channel lower adjusting stud at belt.
6. To install, reverse removal procedures. Adjust ventilator for proper operation and align-

ment as described under "Rear Door Window and/or Ventilator Adjustments".

Ventilator Disassembly

1. Remove ventilator assembly from door as previously described.
2. Remove ventilator division pillar glass run channel strip assembly by disengaging lower end and pulling strip upward (Fig. 7-143).
3. Remove division pillar to ventilator stationary frame attaching screws (Fig. 7-143).

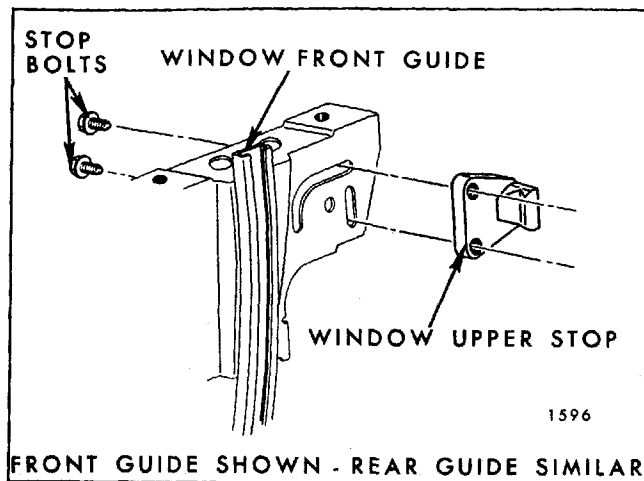

Fig. 7-137—Window Upper Stop Attachment

4. Remove division pillar to ventilator upper frame (and rubber bumper) attaching screw (Fig. 7-143) and separate ventilator frame and division channel.

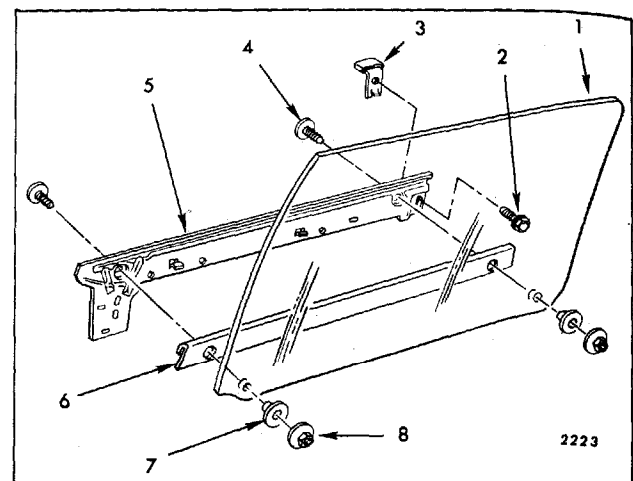

Fig. 7-138—Rear Door Window Assembly - 68069-68169 Style

- | | |
|-------------------------------------|---------------------------------------|
| 1. Door Window Glass | 5. Window Lower Sash Channel |
| 2. Rear Stop to Sash Channel Screw | 6. Window Lower Sash Outer Filler |
| 3. Window Rear Stop | 7. Glass to Lower Sash Channel Spacer |
| 4. Glass to Lower Sash Channel Bolt | 8. Glass to Lower Sash Channel Nut |

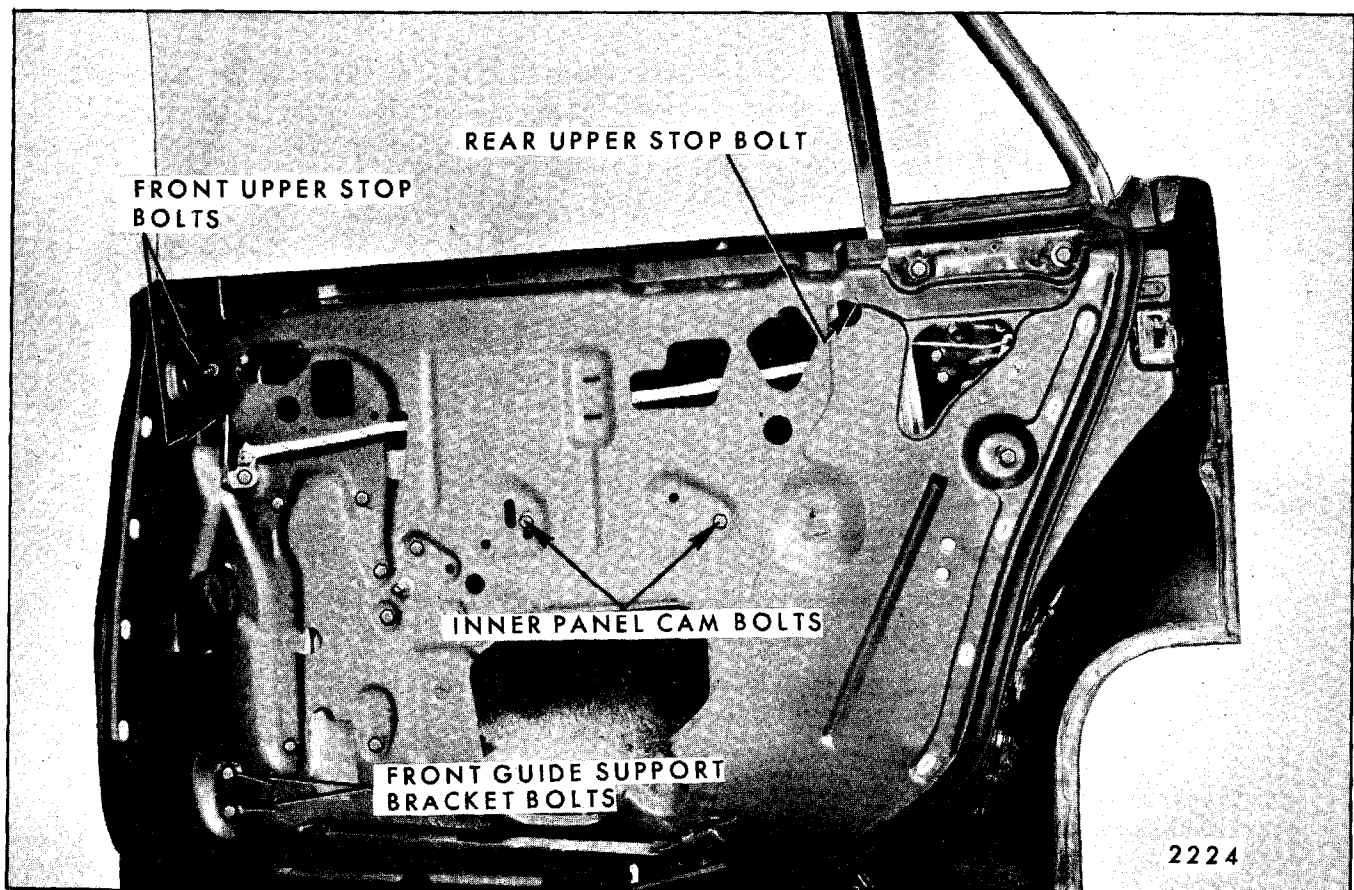

Fig. 7-139—Rear Door Window Removal - 68069-68169 Styles

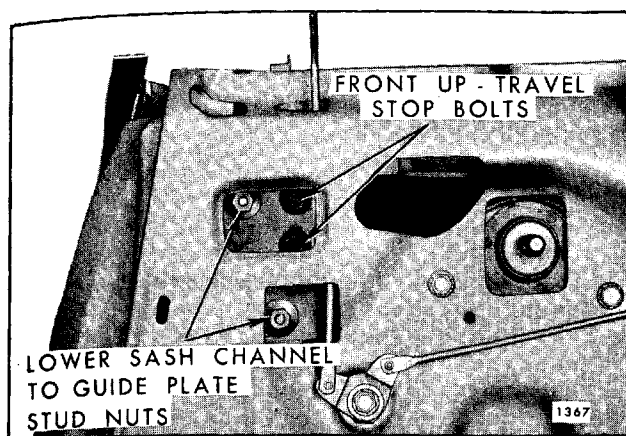

Fig. 7-140—Rear Door Window Removal - 68069-68169 Styles

5. Put ventilator window 90° to ventilator frame. Using hand pressure only, force ventilator downward to disengage ventilator upper pivot from ventilator frame.
6. Straighten division pillar weatherstrip bend-over tabs (Fig. 7-143) and remove weatherstrip.
7. Pull ventilator weatherstrip from front frame. Three clips retain it down front edge and it may be necessary to pry between weatherstrip and frame at these locations.
8. To assemble, reverse removal procedure.

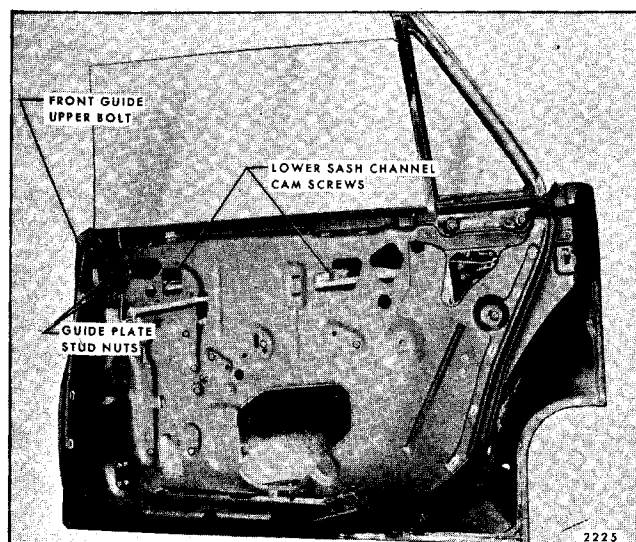

Fig. 7-141—Rear Door Window Removal - 68069-68169 Styles

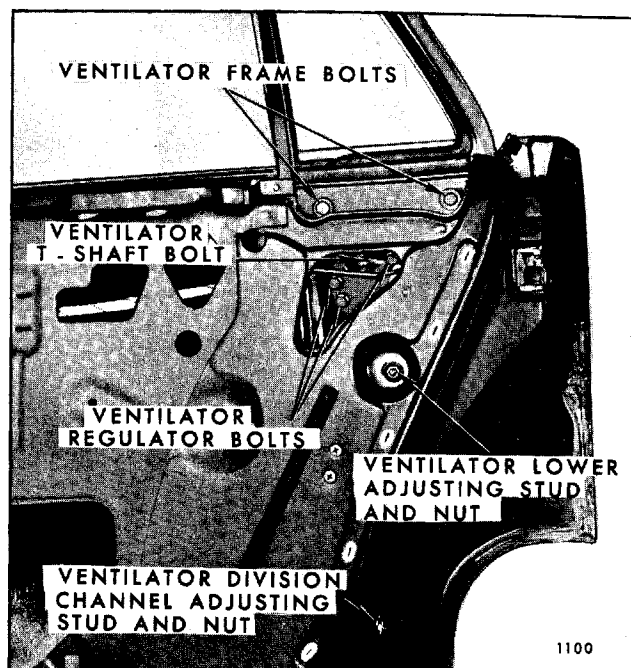

Fig. 7-142—Rear Door Ventilator Attachments - 68069-68169 Styles

NOTE: The above procedure covers complete disassembly of the ventilator, which in most cases, will not be required. When servicing a ventilator assembly, select only those steps necessary.

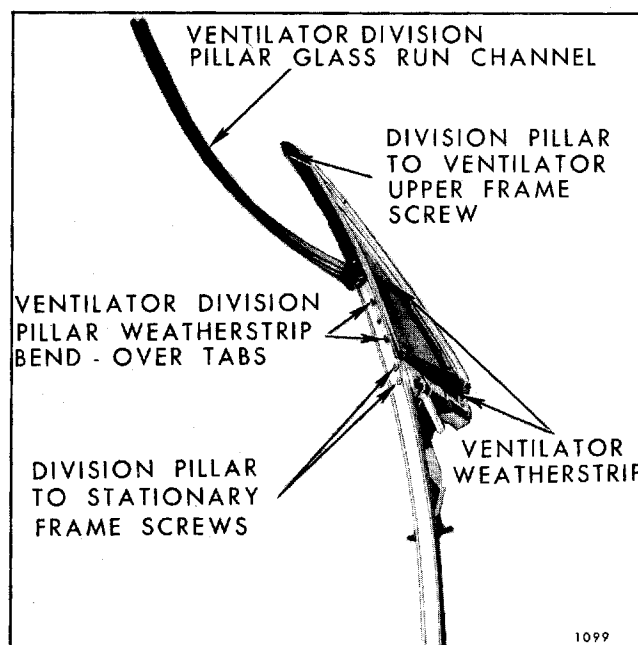

Fig. 7-143—Rear Door Ventilator Assembly - 68069-68169 Styles

REAR DOOR WINDOW AND/OR VENTILATOR ADJUSTMENTS— 68069 AND 68169 STYLES

1. To adjust door window or ventilator assembly in-or-out in relation to side roof rail, adjustment is provided at the following attachments:
 - a. Door window front guide to support assembly attaching bolt (Fig. 7-144). Access to this bolt can be gained through large access hole.
 - b. Front guide upper attaching bolt (Fig. 7-141).
 - c. Ventilator division channel and ventilator frame lower adjusting studs (Fig. 7-142).

These attachments can be adjusted in combination or individually to achieve desired adjustment. When adjusting ventilator adjusting studs, loosen ventilator lower frame attaching bolts prior to adjustment, then, retighten after adjustment.

2. To adjust door window fore-or-aft, loosen guide plate to lower sash channel attaching nuts (Fig. 7-140). Adjust window fore-or-aft as required and tighten nuts.
3. To adjust ventilator fore-or-aft, or to rotate it in opening, loosen ventilator attaching bolts, adjusting stud nuts, and "T-shaft" attaching bolt (Fig. 7-142). Position ventilator as required and tighten loosened attachments.
4. To correct a rotated (cocked) window, loosen inner panel cam attaching bolts (Fig. 7-139). Adjust cam as required and tighten bolts.

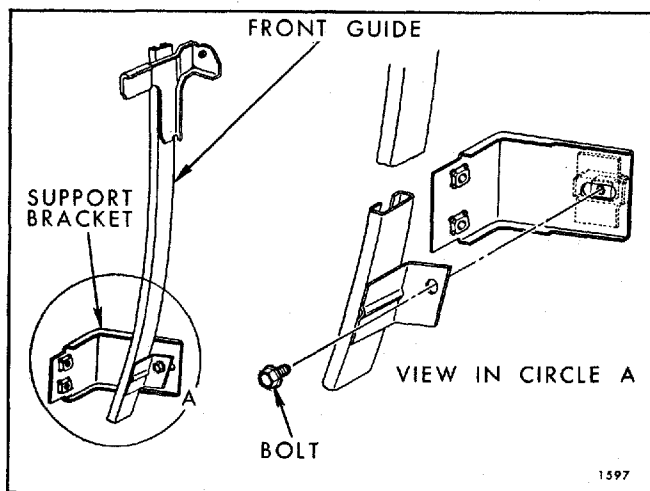

Fig. 7-144—Front Guide to Support Bracket Attachment - 68069-68169 Styles

5. To obtain proper up-travel of door window, loosen front and rear up-travel stop attaching bolts (Fig. 7-139). Operate window to desired position. While exerting upward force on stops, tighten stop attaching bolts.
6. To eliminate a bind between ventilator division channel and front guide (improve operation of a properly adjusted door window), loosen front guide support bracket attaching bolts and front guide to support bracket attaching bolt (Figs. 7-139 and 7-144). Operate glass to full-down position and tighten support bolts. Operate glass 1/3 up from down position and tighten guide to support attaching bolt.

REAR DOOR WINDOW ASSEMBLY— "A-39" STYLES

Removal and Installation:

1. Raise door window, remove trim pad and detach inner panel water deflector.
2. On styles not equipped with a hang-on door trim pad, remove inner and outer belt seal (draft strip).
3. Remove front and rear glass up-stops and window lower sash channel cam.
4. Pull rear door glass straight up and remove assembly from door (see Fig. 7-145).

NOTE: The window regulator lift and balance arms are designed with a slight outboard spring. When removing glass, pull regulator

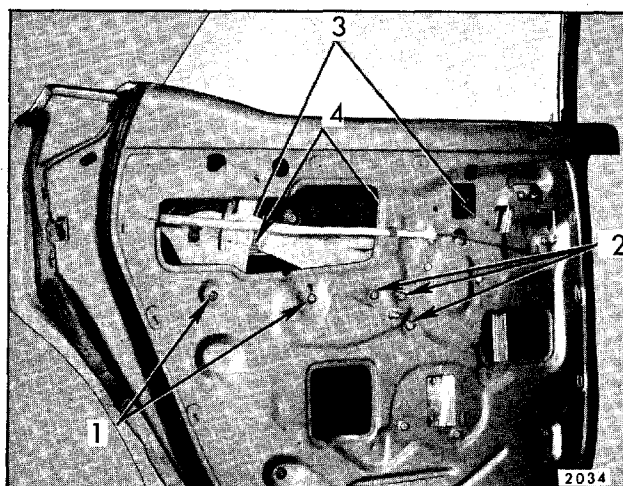

Fig. 7-145—Rear Door Hardware - "A-39" Style

- | | |
|--------------------------|--|
| 1. Inner Panel Cam Bolts | 3. Front and Rear Up-Stop Bolts (Hidden) |
| 2. Remote Control Bolts | 4. Sash Channel Cam Screws |

arms toward inner panel to ease removal procedure. If necessary, the front and rear guides can be loosened at upper attaching points (see Fig. 7-145).

5. To install, reverse removal procedures.

Adjustments

The up-travel and sector gear stops can be adjusted to control height of door glass; the inner panel cam is adjustable at the rear attaching bolt to correct a rotated window; the upper attaching bolts of front and rear guides provide fore or aft and in or out movement of glass. The lower adjusting studs can be positioned to tip the window inboard or outboard at top edge of glass to maintain proper seal and to ease window operation. (see Fig. 7-145).

The rear door is equipped with five separate window stops, consisting of: two up-travel stops (front and rear), two down travel stops (front and rear) and one regulator sector gear stop (used to additionally restrict up-travel of glass). The sector gear stop attaching point varies with the type of window operation. On manually operated windows, the sector gear stop is attached to the front guide. On electrically operated windows, this stop is attached to the regulator back plate. In either case, regulator sector gear stops are secured by a single attaching bolt and are adjustable.

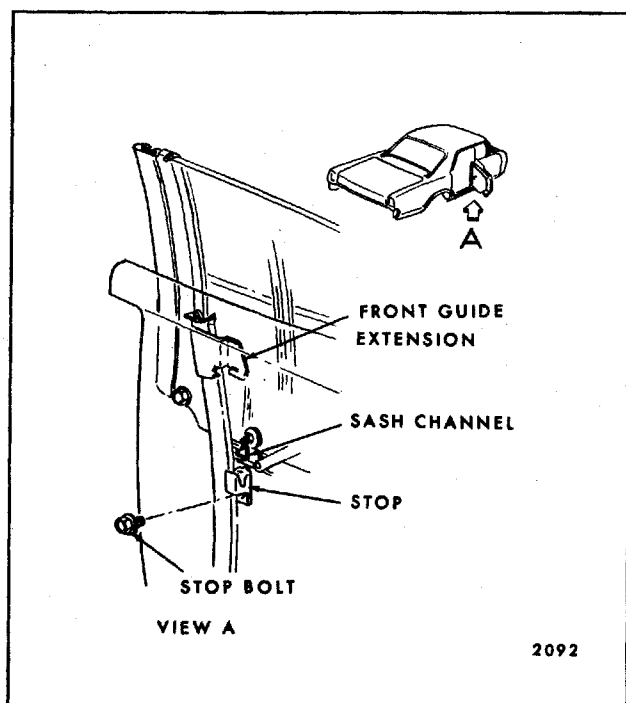

Fig. 7-146—Window Front Up-Stop - "A-39" Style

The two down-travel stops are integral components of either the front or rear window guides and are not separately adjustable.

The two up-travel stops (front and rear) are attached to the window lower sash channel. When glass is raised, the stop comes in contact with a designed extension of either the front or rear guide. Stops are secured by a single bolt and are adjustable up or down. See Figure 7-146 for front up-stop attachment and Figure 7-147 for rear up-stop attachment.

REAR DOOR WINDOW ASSEMBLY— "Z-39"

The rear door window assembly consists of a solid tempered safety plate glass window and a bolted-on lower sash channel. With this design, the door glass and sash channel are removed from the door as a unit and glass replacements made in bench operations. Figure 7-148 is an exploded view of the rear door window assembly and identifies the various components and their assembly sequence. When assembling window, torque sash channel nuts to 60 inch pounds (5 foot pounds). Also, replace glass to sash channel spacers.

CAUTION: Use care to make certain that glass does not strike hard objects. Edge chips or deep scratches can cause solid tempered safety plate glass to shatter. Do not attempt to drill or grind glass.

Removal and Installation:

1. Remove window lower sash channel cam and both inner and outer glass run channel strip assemblies as previously described.

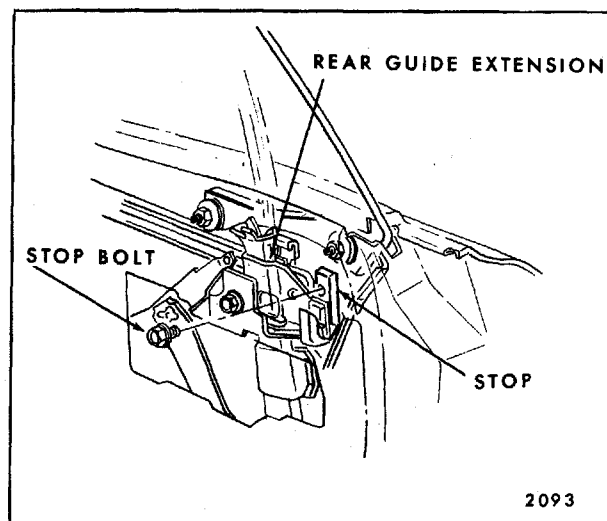

Fig. 7-147—Window Rear Up-Stop - "A-39" Style

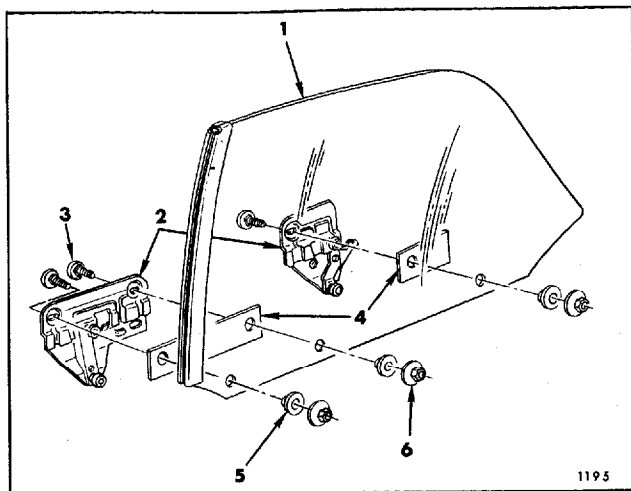

Fig. 7-148—Rear Door Window Assembly - "Z-39" Style

- | | |
|---|---|
| 1. Rear Door Window Glass | 4. Glass to Lower Sash Channel Support Filler, Front and Rear |
| 2. Window Lower Sash Channel Support Assemblies, Front and Rear | 5. Glass to Lower Sash Channel Support Spacers |
| 3. Glass to Lower Sash Channel Support Attaching Bolts | 6. Glass to Lower Sash Channel Support Nuts |

2. Loosen attaching screws for both front and rear up-travel stops and turn stops 45° into slots provided in inner panel.

3. Raise window and remove it from door at belt line.

4. To install, reverse removal procedure. Adjust window for proper alignment as described in "Rear Door Window Adjustments".

REAR DOOR WINDOW ADJUSTMENTS

To make any rear door window adjustments, it is first necessary to remove the trim pad and water deflector.

1. To adjust the top of the window in or out in relation to the side roof rail, loosen the front and rear guide lower adjusting stud nuts (Fig. 7-149). Adjust studs in or out as required, then tighten stud nuts.
2. To adjust up-travel of window, loosen front and rear up-travel stop attaching screws (Fig. 7-149). Adjust window to desired position; then, while exerting a slight downward force on stops, tighten attaching screws.
3. To rotate glass in the opening (raise or lower upper front corner of glass), loosen inner panel cam attaching screws (Fig. 7-149). Adjust

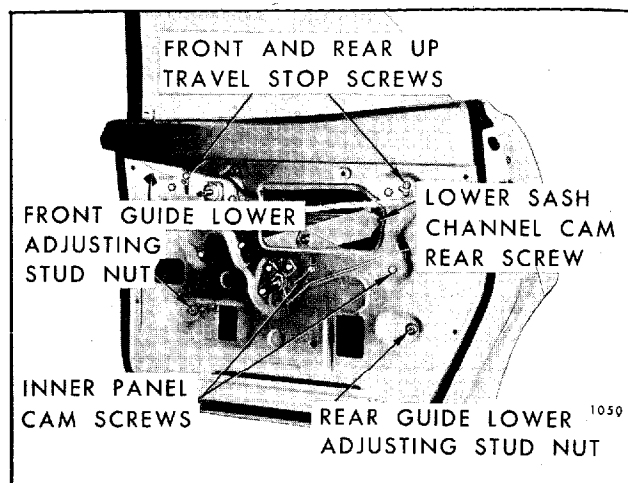

Fig. 7-149—Rear Door Hardware - "Z-39" Styles

front of cam up or down as required, then tighten attaching screws.

4. To relieve a bind within the guides or to adjust window assembly fore or aft, loosen front and rear guide upper attaching screws and lower adjusting stud nuts. With window in full up position and properly aligned with front door window, tighten upper attaching screws. Lower window to full down position and tighten adjusting stud nuts.

REAR DOOR WINDOW GLASS RUN CHANNEL ALL "B-35-45 AND 69" STYLES

Removal and Installation:

1. Remove rear door window assembly as previously described.
2. Remove glass run channel front attaching bolt located on door hinge pillar (arrow "B", Fig. 7-150).
3. On 45-46000 Series, remove glass run channel rear lower attaching bolt located on door lock pillar (arrow "A", Fig. 7-150).
4. On all "B & C" Closed Styles except 45-46000 Series, remove glass run channel rear attaching bolt (Fig. 7-151).
5. Pull run channel into window opening to disengage run channel clips from door upper frame and remove run channel from door.
6. To install, reverse removal procedure. Prior to installation, apply a continuous bead of caulking compound to door upper frame from belt line to belt line to effect a weathertight

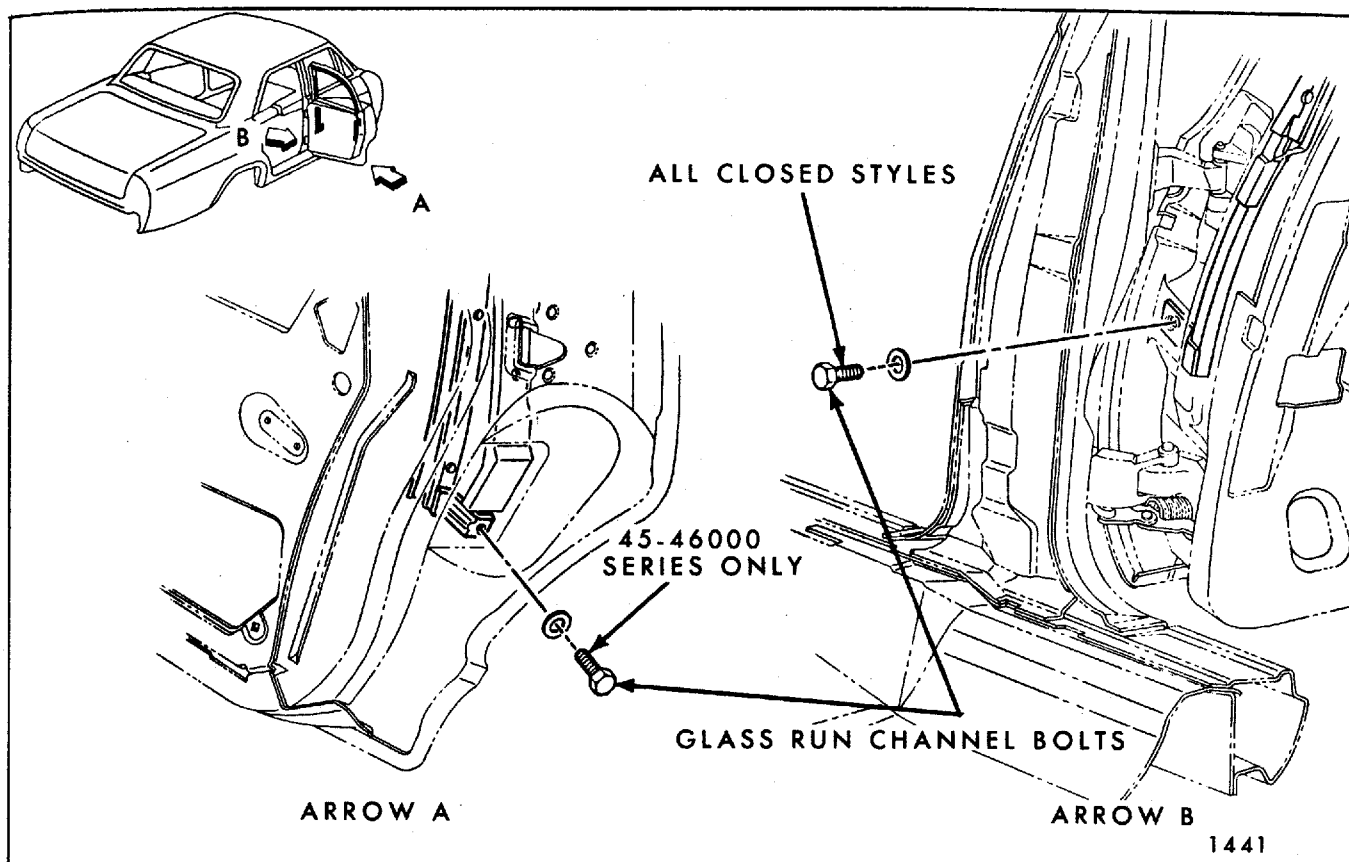

Fig. 7-150—Glass Run Channel Retention "B" Closed Styles

seal between door frame and run channel. If preferred, sealer can be applied to run channel rather than door upper frame.

REAR DOOR WINDOW GLASS RUN CHANNEL—"A-35-55-65 AND 69" STYLES

A soft "flocked" run channel is used for all rear door windows.

Removal and Installation:

1. Remove rear door trim pad and detach inner panel water deflector.
2. Remove rear door window.
3. With finger pressure, squeeze run channel together and gently pull run channel out of rear door upper frame and remove from door. (See Fig. 7-152).

4. To install, reverse removal procedure.

IMPORTANT: The glass run channel must be properly seated and conform to shape of door upper frame to achieve proper glass operation.

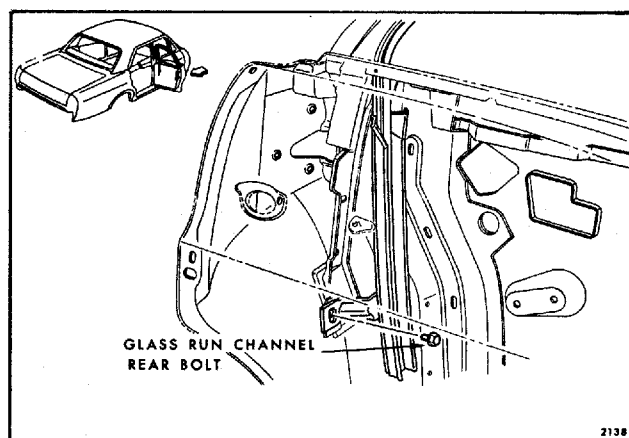

Fig. 7-151—Glass Run Channel Retention - "B" Closed Styles Except 45-46000 Series

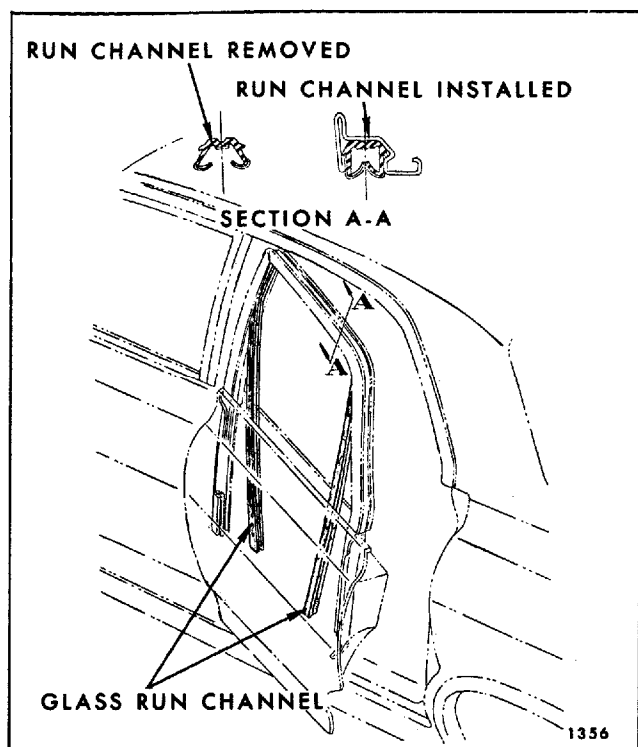

Fig. 7-152—Glass Run Channel - "A" Closed Styles

REAR DOOR WINDOW GLASS RUN CHANNEL—"X-35 AND 69" STYLES

Removal and Installation:

1. Remove rear door trim pad and detach inner panel water deflector.
2. Remove rear door window.
3. With finger pressure, squeeze run channel together at rear end and gently pull run channel out of rear door upper frame (See Fig. 7-153).
4. To install, reverse removal procedure.

IMPORTANT: The glass run channel must be properly seated and conform to shape of door upper frame to achieve proper glass operation.

REAR DOOR WINDOW FRONT GUIDE—ALL "B-C 39" STYLES AND ALL "C-69" STYLES EXCEPT 68069 AND 68169

Removal and Installation:

1. Remove rear door window assembly as previously described.

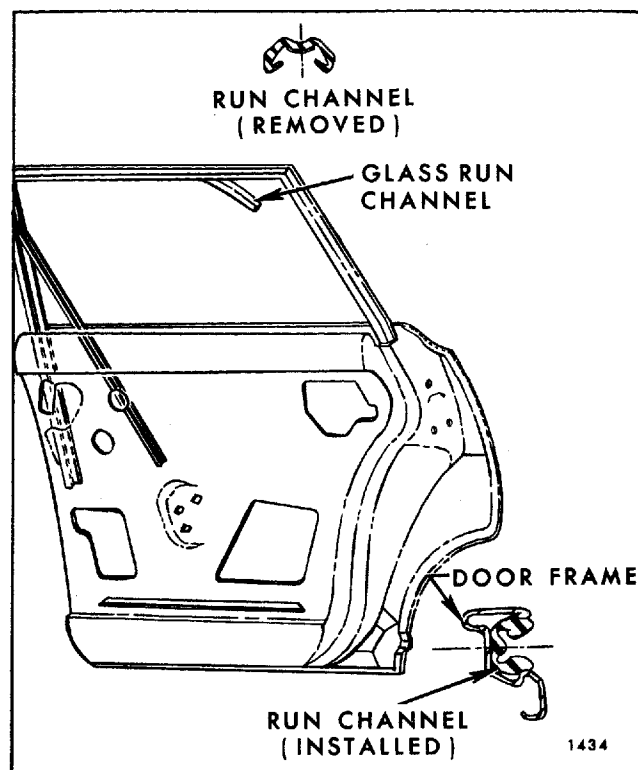

Fig. 7-153—Window Run Channel Installation - "X" Closed Styles

2. Remove front guide attaching bolts at belt line and lower adjusting stud nut (Fig. 7-154).
3. Remove inside locking rod connecting link attaching bolts (Fig. 7-154). Disengage guide from inside locking rod and remove guide through access hole.
4. To install, reverse removal procedure. Adjust guide for proper window operation as described in the window adjustment procedure.

REAR DOOR WINDOW REAR GUIDE—ALL "B-C 39" STYLES AND ALL "C-69" STYLES EXCEPT 68069 AND 68169

Removal and Installation:

1. Remove door trim assembly and inner panel water deflector.
2. Operate window to full-up position.
3. Remove rear guide upper attaching bolts (Fig. 7-154 - Locations "A" for 38-48-68000 Series, Locations "B" for remaining styles). Remove rear guide lower adjusting stud nut.

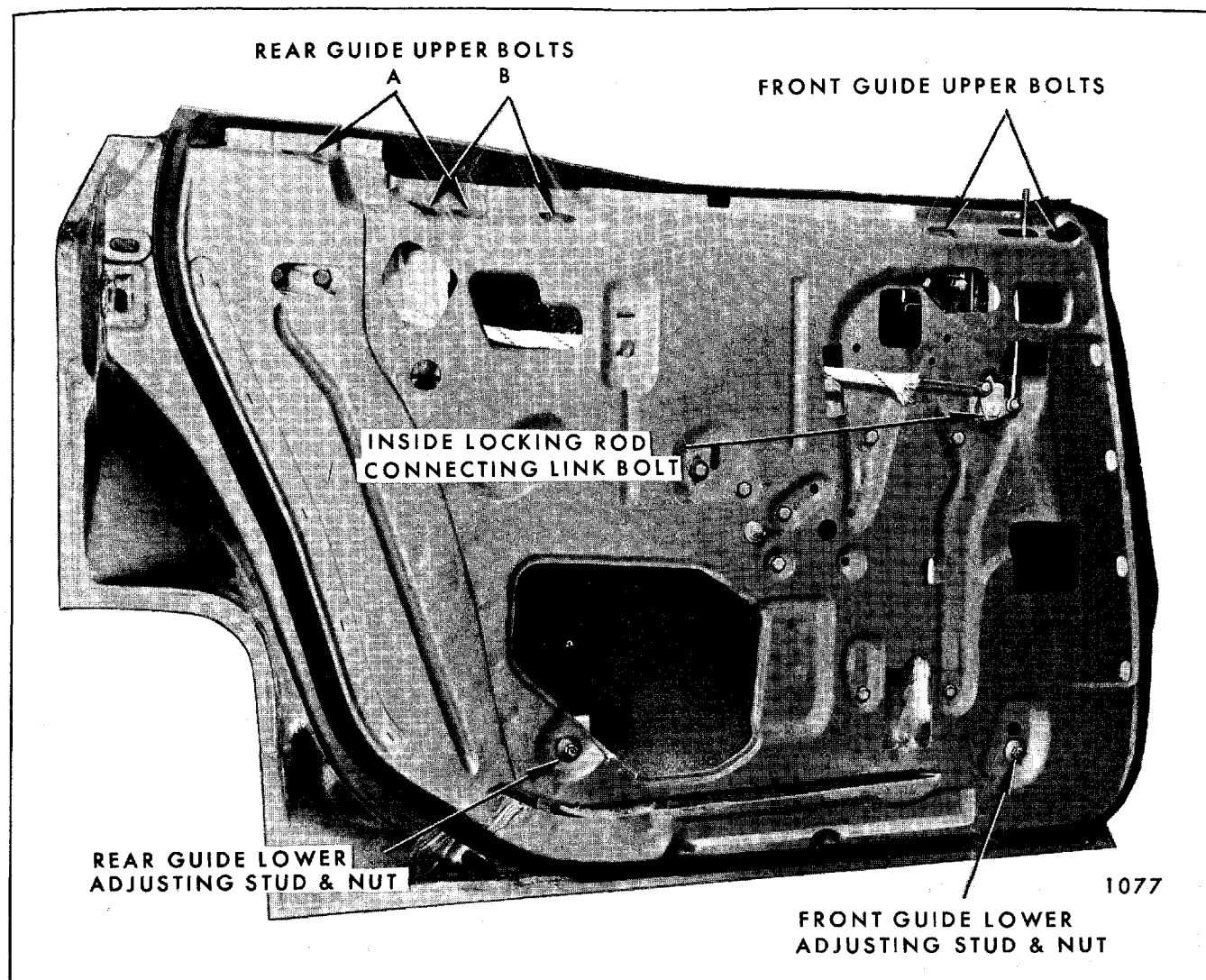

Fig. 7-154—Rear Door Window Guides - "B & C-39 and C-69" Except 68069-68169 Styles

4. Lower guide and swing bottom end forward to disengage guide from roller on lower sash channel and lower sash channel balance arm.
5. Remove guide, upper end first, through large access hole.
6. To install, reverse removal procedure. Adjust guide for proper window operation as described in the door window adjustment procedure.
2. Operate window to full-up position.
3. Remove front upper stop attaching bolts and remove stop (Fig. 7-155).
4. Remove front guide support bracket attaching bolt (Fig. 7-155).
5. Remove front guide upper attaching bolt (Fig. 7-156).
6. Remove guide plate to lower sash channel attaching stud nuts (Figs. 7-156 and 7-157).
7. Remove front guide and guide plate as an assembly through access hole (Fig. 7-158).
8. To install, reverse removal procedure. Adjust front guide for proper window operation

REAR DOOR FRONT GUIDE AND GUIDE PLATE—68069 AND 68169 STYLES

Removal and Installation:

1. Remove rear door trim assembly and inner panel water deflector.

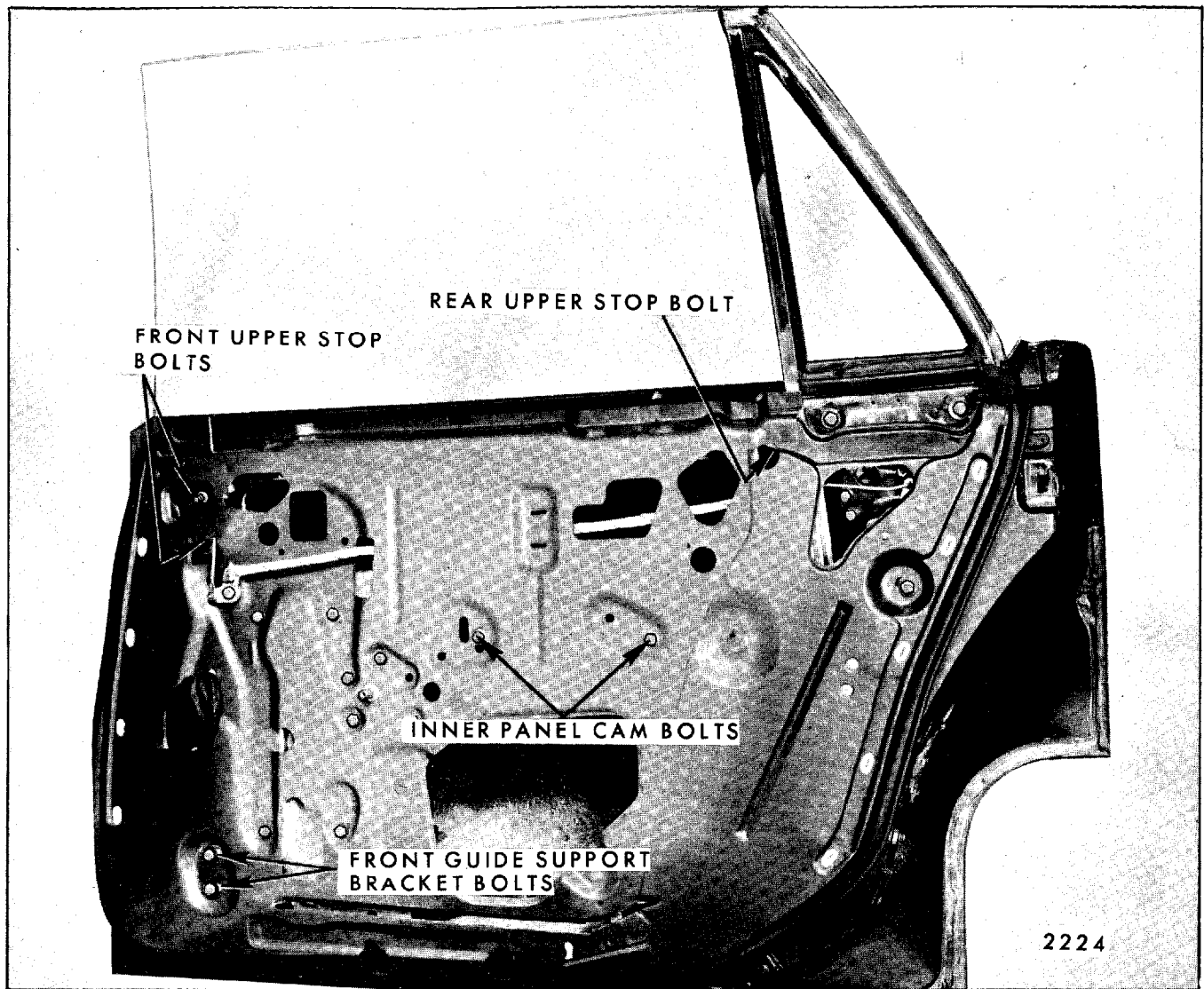

Fig. 7-155—Front Guide and Upper Stop Removal

as described in door window adjustment procedure.

REAR DOOR WINDOW GUIDE CHANNELS—"A-39" STYLES

Removal and Installation:

1. Remove door trim pad and detach inner panel water deflector.
2. Remove rear door window assembly.
3. On guide to be removed, remove upper attaching bolts and lower adjusting stud nut and remove guide (see Fig. 7-159).
4. To install, reverse removal procedure.

REAR DOOR WINDOW FRONT OR REAR GUIDE—"Z-39" STYLES

Removal and Installation:

1. Remove door trim pad and inner panel water deflector.
2. Loosen front and rear up-travel stop attaching screws (Fig. 7-125). Rotate stops so that stop tabs enter angled slots. Raise window as far as possible.
3. Remove upper attaching screw and lower adjusting stud nut from guide being removed. Lower guide to disengage it from sash channel roller, then remove guide through large access hole.
4. To install, reverse removal procedure.

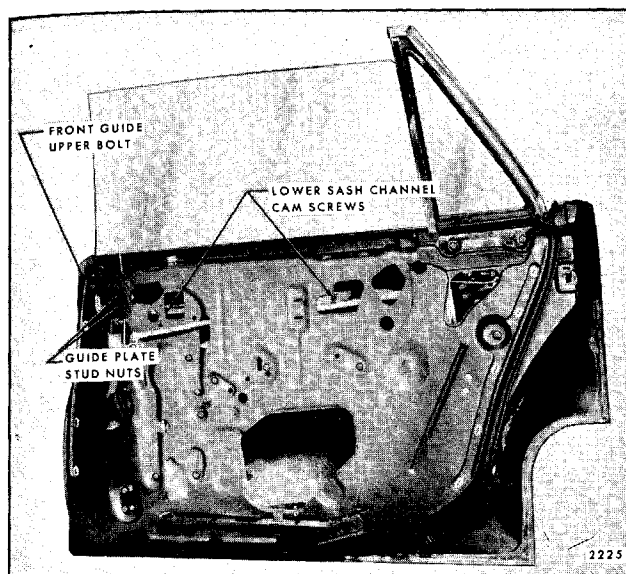

Fig. 7-156—Front Guide and Guide Plate Removal

REAR DOOR WINDOW REGULATOR— MANUAL AND ELECTRIC— ALL “B & C” STYLES

Removal and Installation:

1. Remove rear door trim assembly and inner panel water deflector.
2. Remove lower sash channel cam attaching screws (Fig. 7-160 for “closed” styles, 7-161 for “hardtop” styles).

While supporting glass, disengage cam from rollers on regulator lift and balance arms and remove cam.

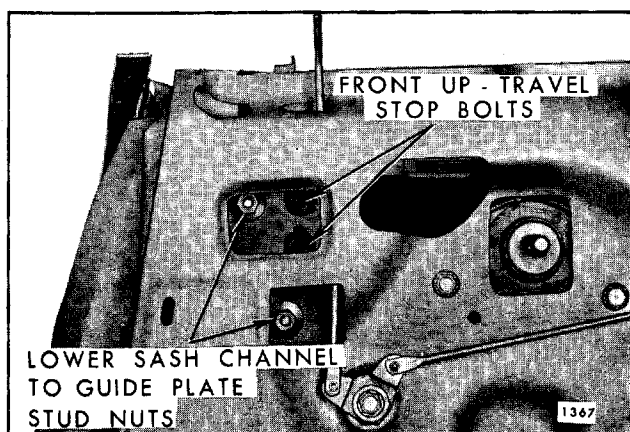

Fig. 7-157—Window Guide Plate Removal

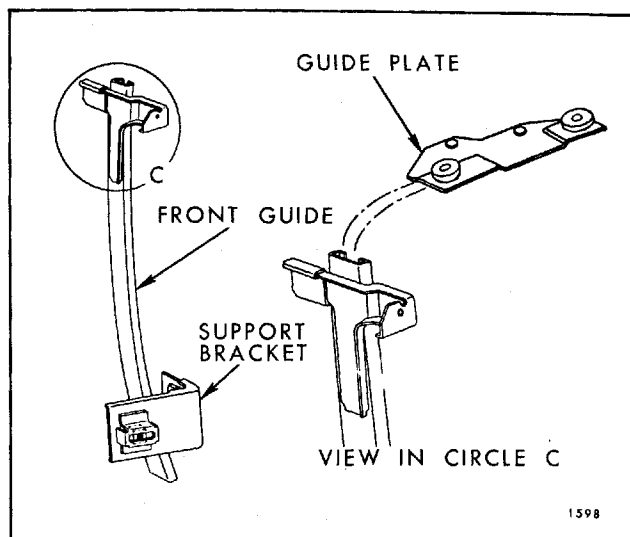

Fig. 7-158—Front Guide and Guide Plate - 68069-68169 Styles

3. Raise window and prop it in full-up position.
4. Remove inner panel cam attaching bolts (Fig. 7-160 for “closed” styles, Fig. 7-161 for “hardtop” styles).
5. On styles equipped with electric window regulators, disconnect body wire harness from window regulator at window regulator motor.
6. Remove window regulator attaching bolts and remove regulator through large access hole. (Figs. 7-161 and 7-160).

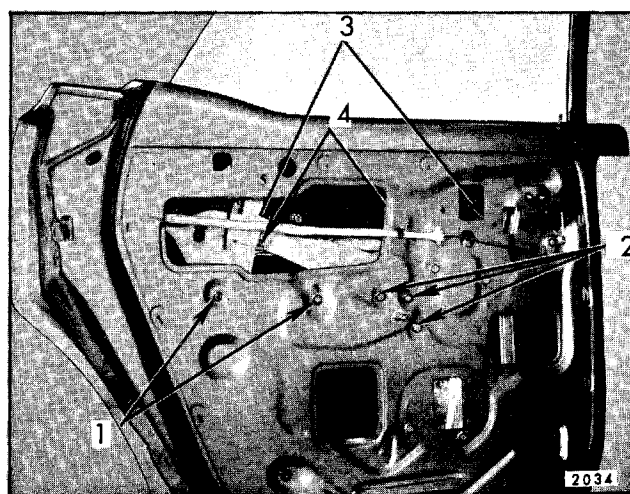

Fig. 7-159—Rear Door Hardware “A-39” Style

- | | |
|--------------------------|--|
| 1. Inner Panel Cam Bolts | 3. Front and Rear Up-Stop Bolts (Hidden) |
| 2. Remote Control Bolts | 4. Sash Channel Cam Screws |

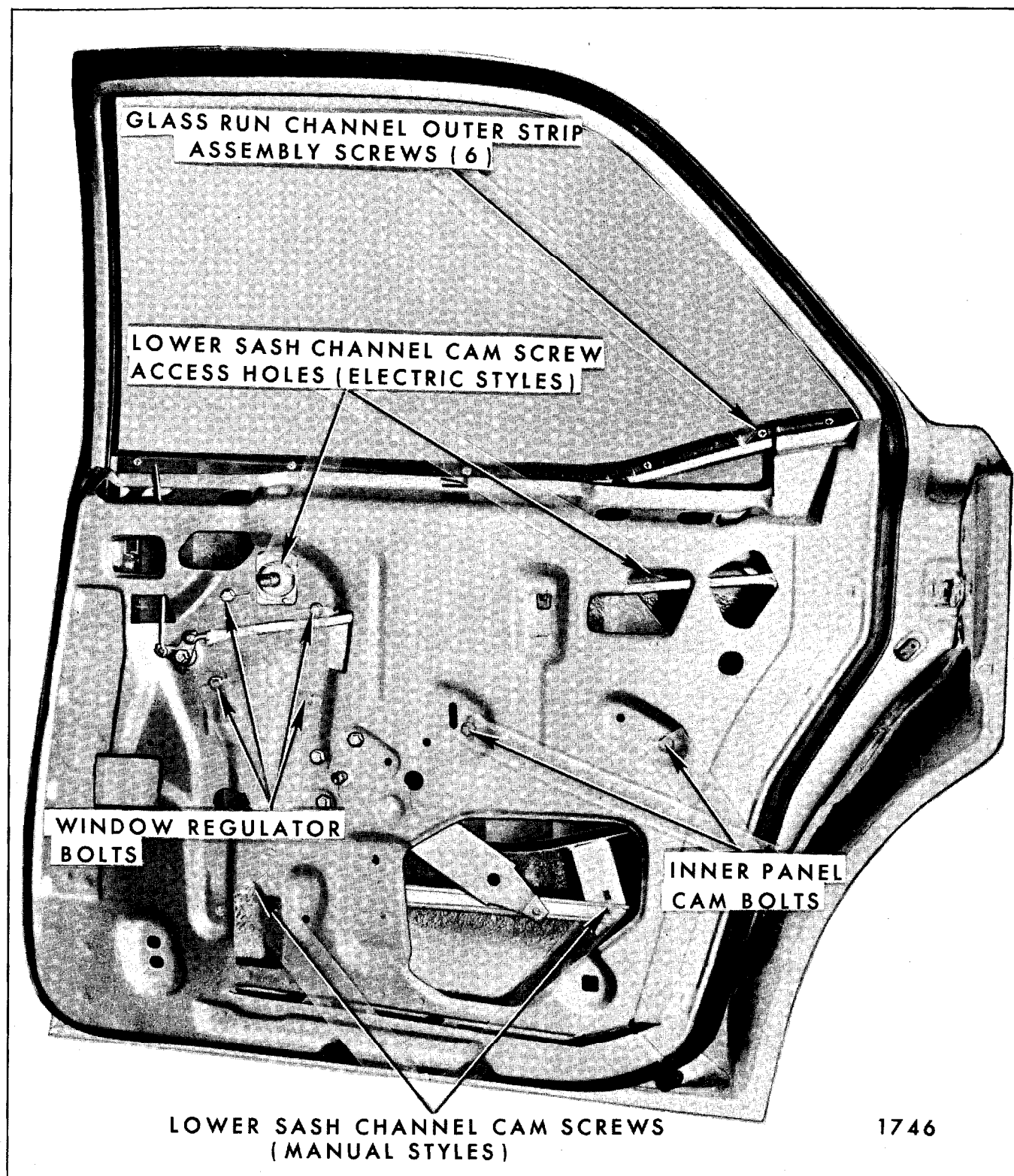

Fig. 7-160—Window Regulator Removal - "B" Closed Styles

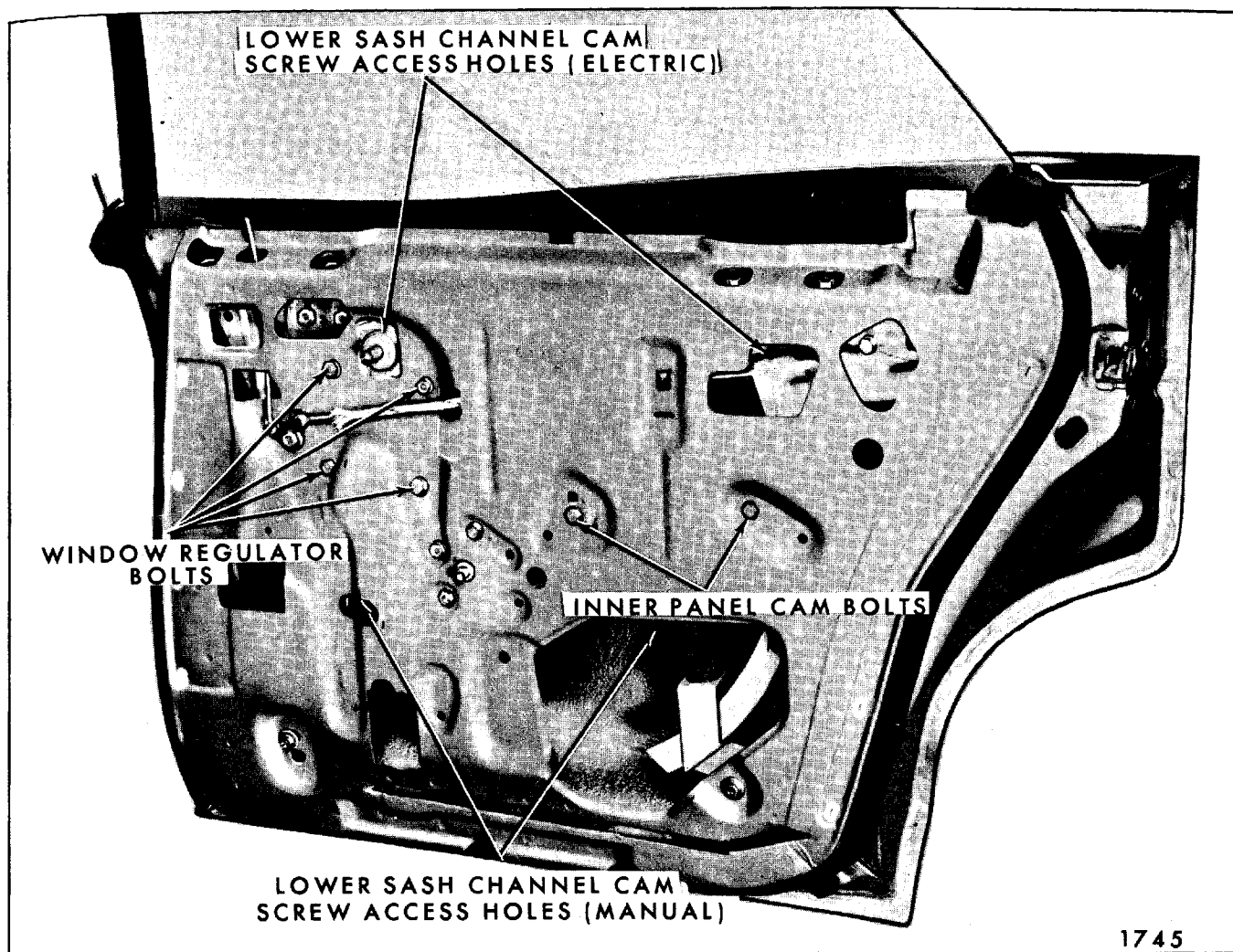

Fig. 7-161—Window Regulator Removal - "Hardtop" Styles

REAR DOOR WINDOW REGULATOR ASSEMBLY—"A-35-55-65 AND 69" STYLES AND "X-35 AND 69" STYLES

Removal and Installation:

1. Raise door window, remove door trim pad and detach inner panel water deflector.
2. Secure window in the full up position by installing a twelve to fifteen inch piece of body tape (2" or 2-1/2" in width) over window frame and firmly pressing tape to both sides of glass. This is necessary to positively hold glass in the up position during removal of window regulator.
3. Remove inner panel cam on "A" Body Styles.

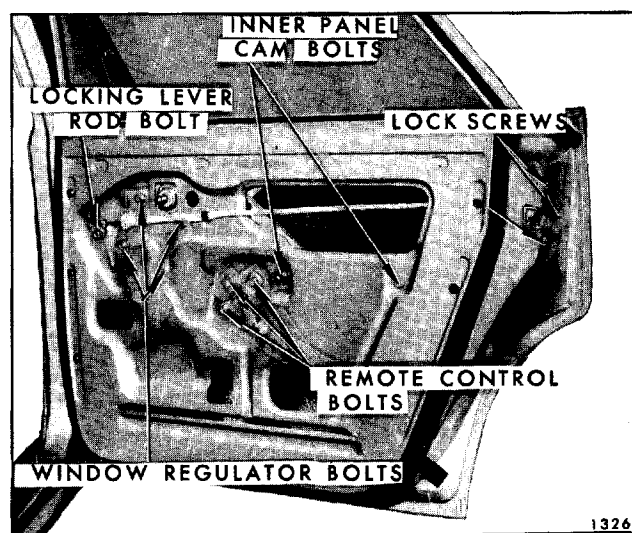

Fig. 7-162—Rear Door Hardware - "A" Styles Shown

4. Remove window regulator attaching bolts and move regulator assembly rearward to disengage lift arm rollers (and balance arm rollers on "A" Styles) from window lower sash channel cam and remove regulator through large access hole (See Fig. 7-162).
5. To install, reverse removal procedure. Cycle window several times to insure proper operation before installing water deflector and door trim pad.

REAR DOOR WINDOW REGULATOR ASSEMBLY "A-Z 39" STYLES

Removal and Installation:

1. Remove door trim pad and detach inner panel water deflector.

2. Remove rear door window.
3. On "A" Body Electric Styles, disconnect motor from wire harness.
4. Remove regulator attaching bolts and remove regulator assembly (See Fig. 7-159).
5. To install, reverse removal procedure.

REAR DOOR WINDOW REGULATOR ELECTRIC MOTOR REMOVAL— ALL STYLES

If it is necessary to remove the electric motor from the regulator, refer to "Front Door" section for the proper procedure. The tension on the lift arm assist spring can cause serious injury if the motor is removed without use of the cautionary measures described in the procedure.

This document was created with Win2PDF available at <http://www.win2pdf.com>.
The unregistered version of Win2PDF is for evaluation or non-commercial use only.
This page will not be added after purchasing Win2PDF.