

# **ASSEMBLY MANUAL**

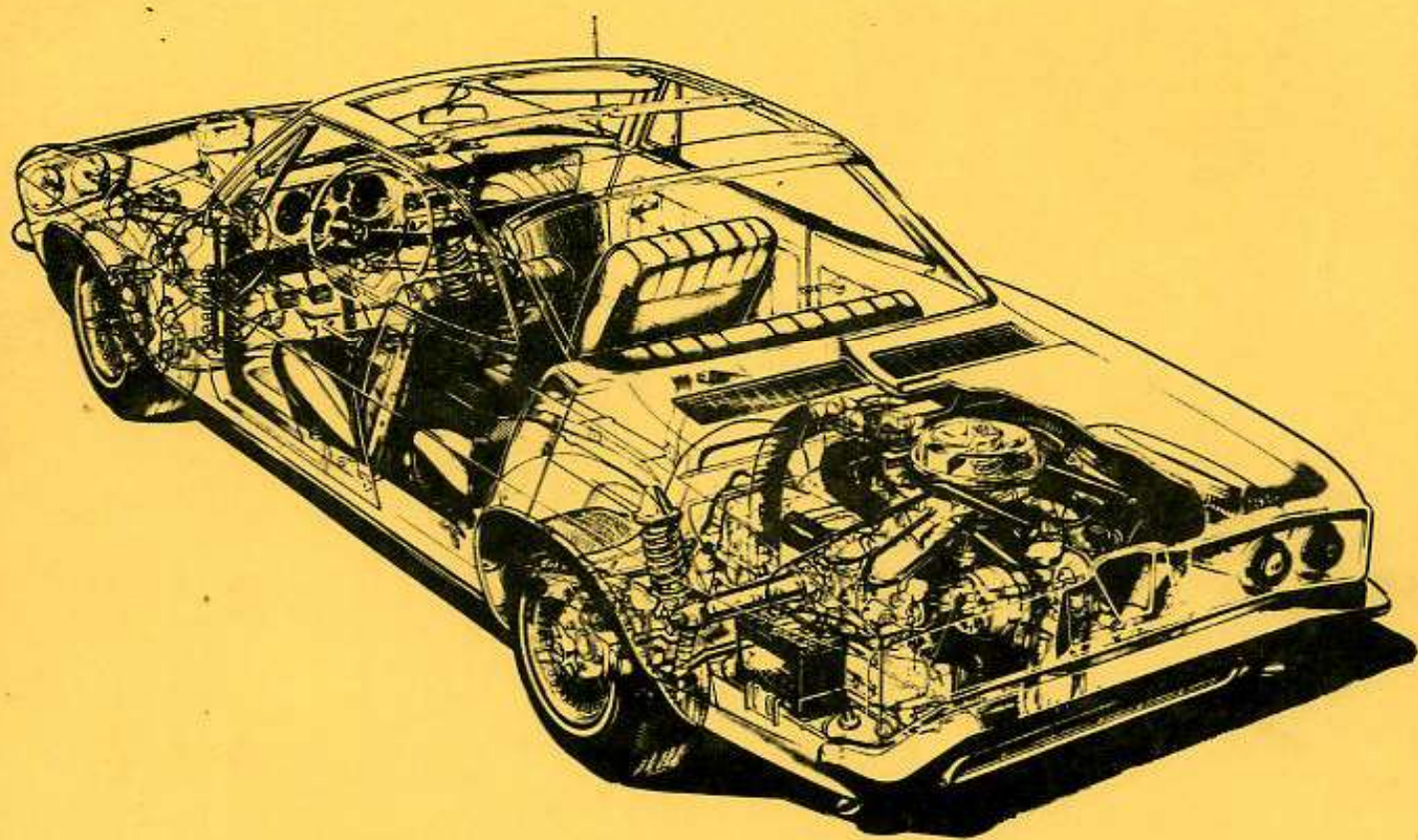

**1965  
CORVAIR**

**C7315**





CHEVROLET

# ASSEMBLY INSTRUCTIONS

3862100

CORVAIR 10000 SERIES

- |           |   |                 |                     |
|-----------|---|-----------------|---------------------|
| 1 3857221 | TUNNEL-TOE PAN                                  | 7 5 1 4 9423909 | SCREW               |
| 2 3858770 | SEAL L.H. ② ③                                   | 1 5 3858771     | CLAMP-MULTIPLE TUBE |
| 3 9981098 | CEMENT-APPROX .02 OZ<br>SEALS TO TUNNEL TOE PAN | 4 6 3869870     | SEAL R.H.           |

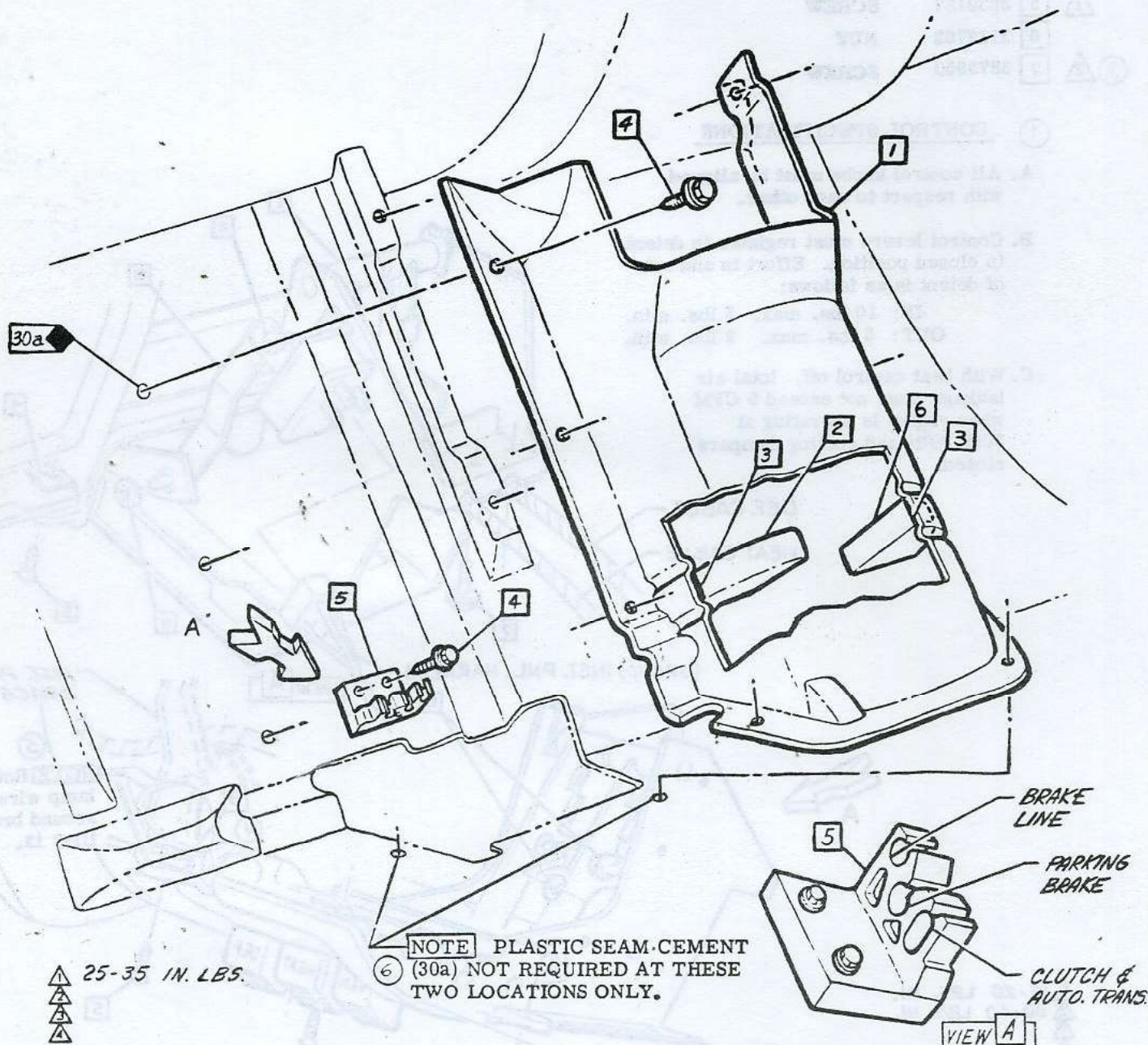

* CHEVROLET MOTOR DIVISION, GMC *				UPC	DATE	SYM	REVISION RECORD		AUTH	DR	CK
TOE PAN TUNNEL COVER, CLAMP & SEAL				1	7-8-64	1	WAS 3858771 CLAMP		—	CC	DP
					9-25-64	2	L.H. ADDED		65232	CC	
10000				A 4.		3	WAS .01 OZ.				
						4	ITEM 6 ADDED				GE
DWG PREL. 2-21 DATE REL. 2-21				X SHEET 1	12-14-64	5	WAS 9421803 SCREW		15932	BR	CI
					12-30-64	6	CEMENT NOTE ADDED		15944	BR	CI
					4-23-65	7	WAS 9418799 SCREW		15955	BR	CI
REF: Prel. A6 L-65029 L- L- L- L-											



- |   |   |   |         |              |   |         |                    |
|---|---|---|---------|--------------|---|---------|--------------------|
| ② | ① | 1 | 3855623 | CONTROL ASM. | 8 | 3126659 | WASHER-SPRING GRIP |
|   |   | 2 | 9420890 | SCREW        | 9 | 9420137 | "J" NUT            |
|   |   | 3 | 3854799 | SWITCH ASM   |   |         |                    |
|   |   | 4 | 3860140 | "J" NUT      |   |         |                    |
| ① |   | 5 | 3839187 | SCREW        |   |         |                    |
|   |   | 6 | 3132762 | NUT          |   |         |                    |
| ③ | ② | 7 | 3873950 | SCREW        |   |         |                    |

① **CONTROL SPECIFICATIONS**

- A. All control knobs must be aligned with respect to each other.
- B. Control levers must register in detent in closed position. Effort in and out of detent is as follows:  
IN: 10 lbs. max. 5 lbs. min.  
OUT: 5 lbs. max. 2 lbs. min.
- C. With heat control off, total air leakage must not exceed 5 CFM when engine is operating at 3000 RPM and cooling dampers closed.

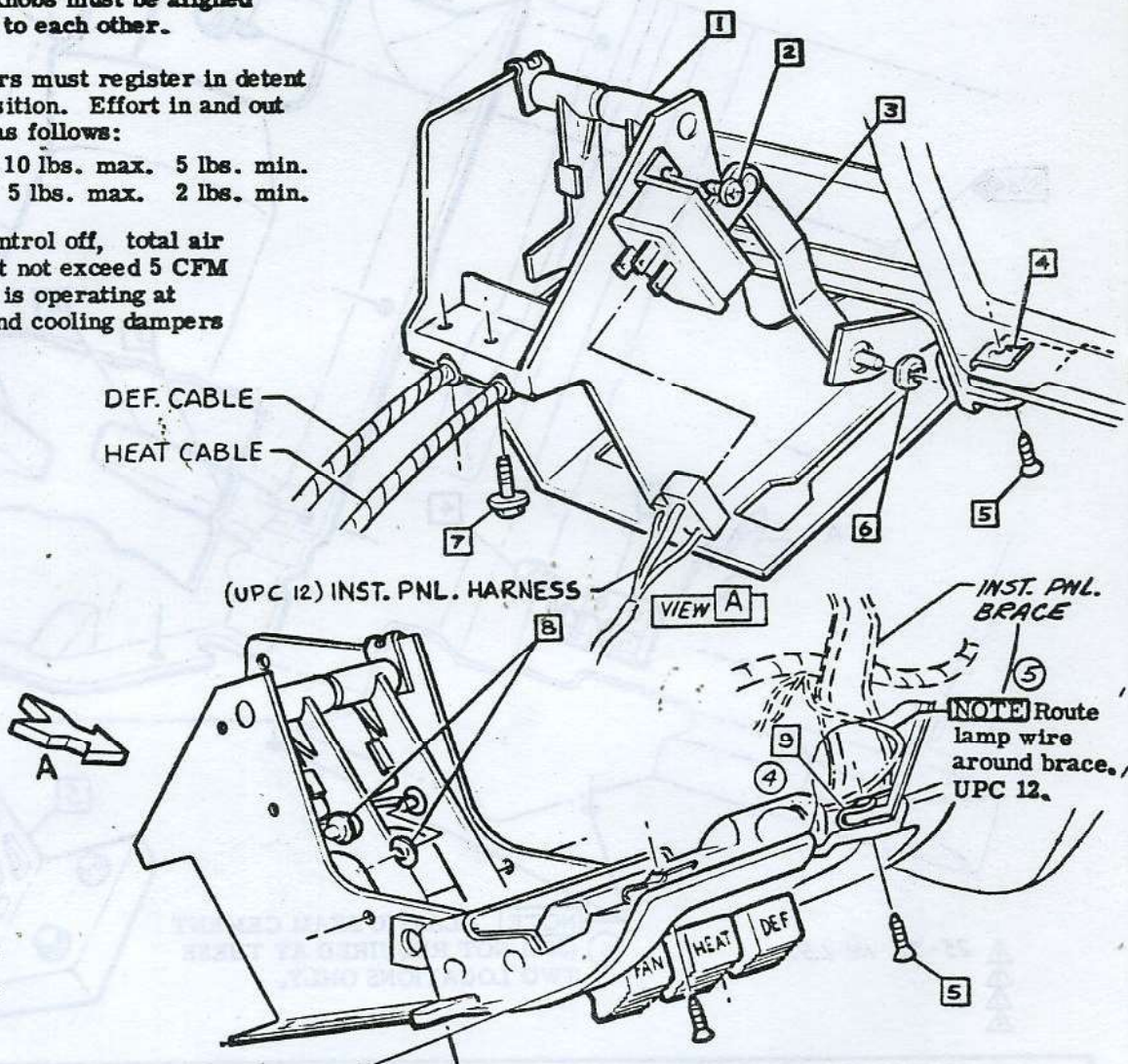

- ① 15-20 LBS. IN.  
② 30-40 LBS. IN.  
③

• CHEVROLET MOTOR DIVISION, GMC •				UPC	DATE	SYM	REVISION RECORD	AUTH	DR	CK
HEATER CONTROL ASM.				1	7-15-64	1	"CONTROL SPECS" ADDED	64798	AM	DP
					9-25-64	2	WAS 273445 SCREW	65827	CC	DF
10000				A 5.	12-30-64	3	WAS 3861264 SCREW	66967	JC	CJ
					1-25-65	4	"BULB" DWG. REVISED	68389	BY	
						5	"WIRE" NOTE ADDED			CI
DWG PREL. 1-16				SHEET X						
DATE REL. 5-19										
CMC REF: Prel. A2 L-73722 L-										
L- L- L-										



- |   |         |                     |
|---|---------|---------------------|
| 1 | 3859395 | DEF DUCT ASM-REAR   |
| 2 | 3859772 | DEF DUCT ASM-FRONT  |
| 3 | 3873950 | SCREW               |
| 4 | 3846854 | "U" NUT - SPECIAL   |
| 5 | 3866429 | RESISTOR            |
| 6 | 9985029 | WIRE APPROX. 8 INS. |
| 7 | 3866874 | BAFFLE              |

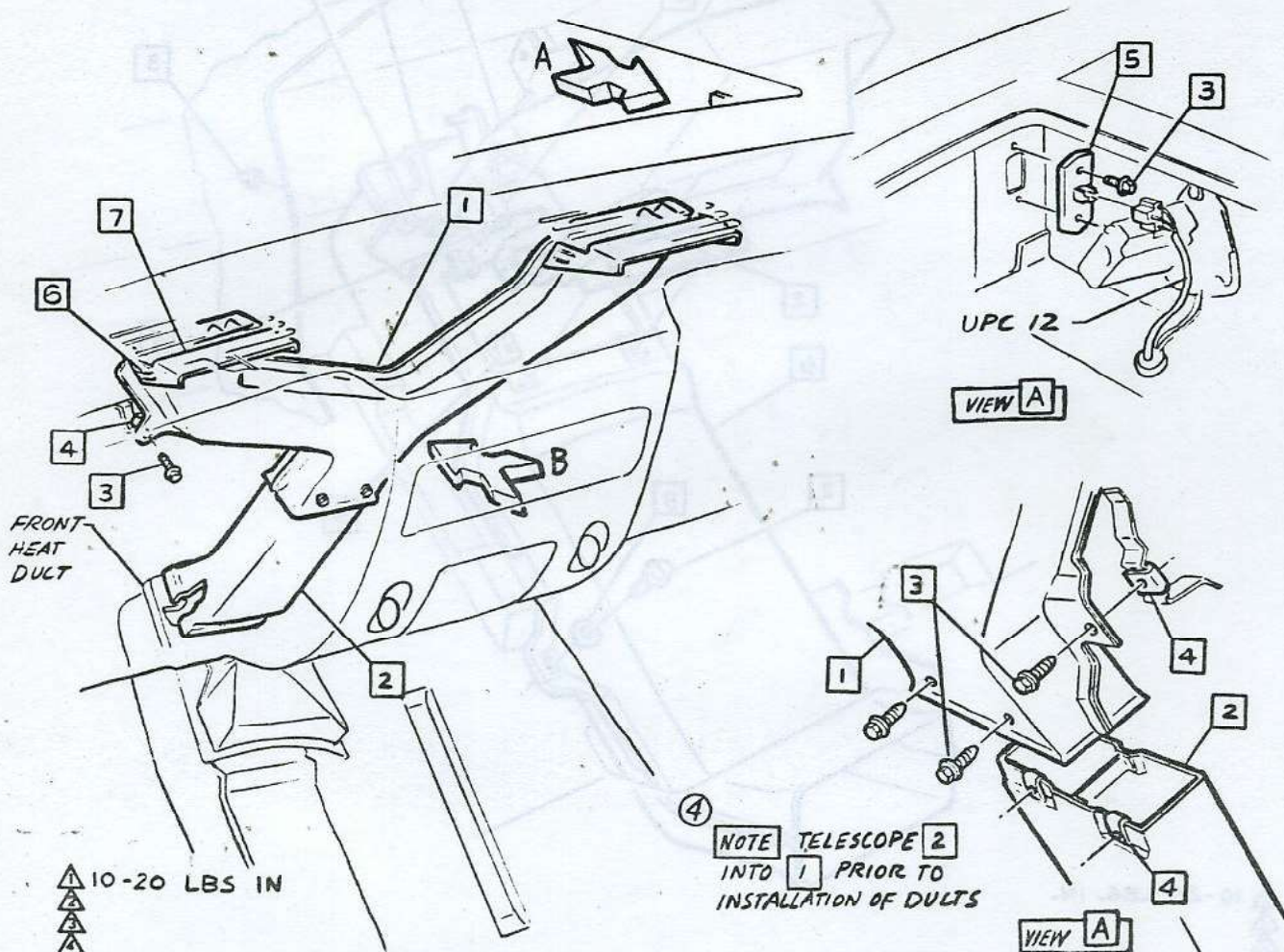

• CHEVROLET MOTOR DIVISION, GMC •				UPC	DATE	SYM	REVISION RECORD		AUTH.	DR	CK
DEFROSTER DUCTS				1	7-15-64	1	WAS 3859317 RESISTOR		64758	CC	
10000						2	ITEM 6 & 7 ADDED		63828		DP
DWG PREL 2-13 DATE REL 5-15				A 6.	2-25-64	3	WAS 9420856 NUT		65484	CC	
GMC REF: Prel. 45 L-73525 L- L- L- L-						4	DUCT NOTE ADDED				DF
					12-30-64	5	WAS 3861264 SCREW		66967	X	CI
					3-31-65	6	WAS 9422 B36 NUT		70200	DA	CI
				<input checked="" type="checkbox"/> SHEET							





CHEVROLET

## ASSEMBLY INSTRUCTIONS

3862100

CORVAIR 10000 SERIE

- |     |         |   |       |         |           |
|-----|---------|---|-------|---------|-----------|
| 1   | 3854695 | VALVE ASM.  | 6     | 3854277 | DUCT ASM. |
| ① 2 | 3873950 | SCREW ASM.  | 7     | 3864366 | SEAL      |
| 3   | 4770719 | CAP   | ① ③ 8 | 120392  | WASHER    |
| 4   | 9981098 | CEMENT (.03 oz. per job)<br>Used to cement seal to valve asm. |       |         |           |
| 5   | 9420856 | "U" NUT   |       |         |           |

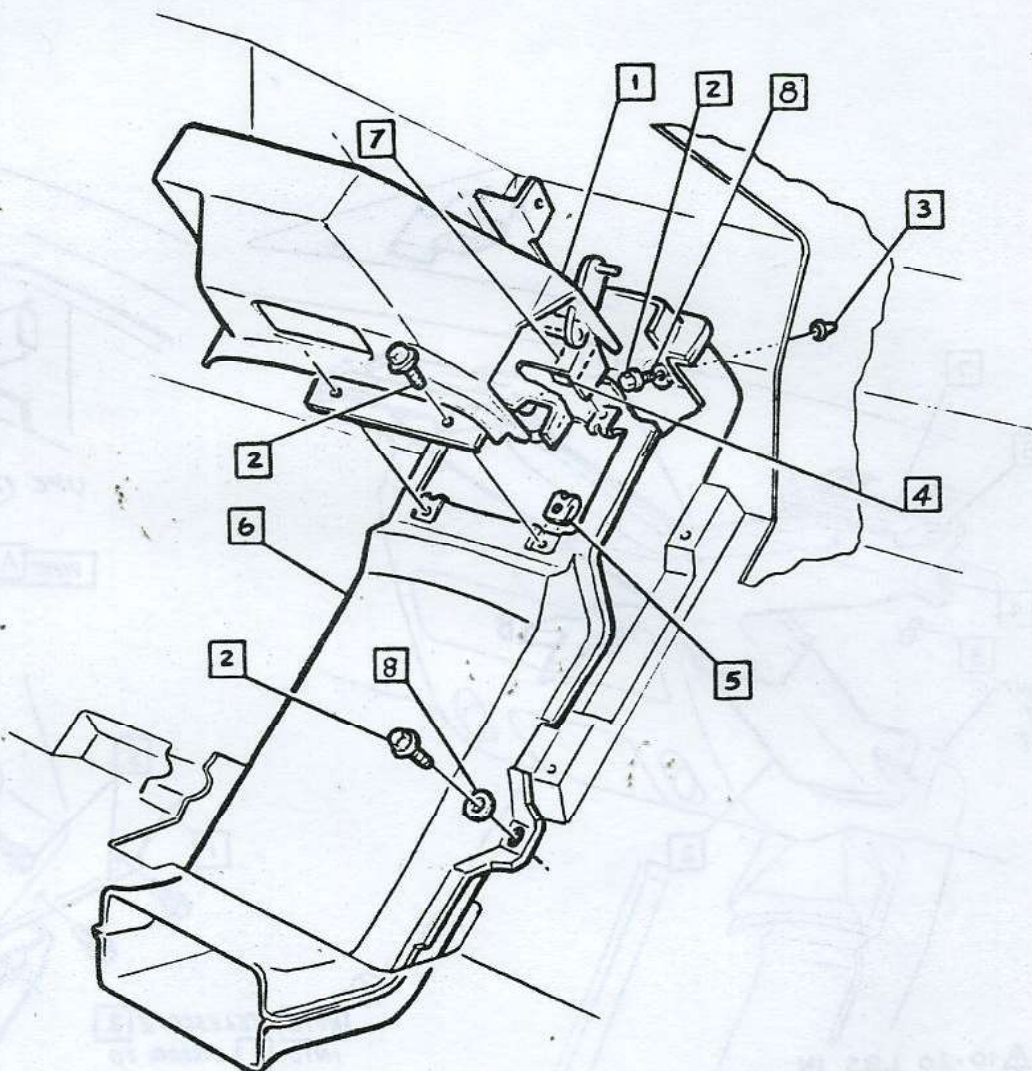

▲ 10-20 LBS. IN.



CHEVROLET MOTOR DIVISION, GMC		UPC	DATE	SYM	REVISION RECORD	AUTH.	DR	CK
FRONT HEATER DUCT & VALVE ASM.		1	7-8-64	1	3724851 TAPE REMOVED	CC	DP	
			11-4-64	2	WAS 3861264 SCREW	66967	CK	
				3	ITEM 8 ADDED	15835	QF	
10000		A7.						
DWG. PREL. 2-21	GMC	REF: PreL. A7	L-72621	L-				
DATE REL. 5-15		L-	L-	L-				
		SHEET 1						





CHEVROLET

## ASSEMBLY INSTRUCTIONS

3862100

CORVAIR 10000 SERIES

- 1 3868673-4 INSULATOR-ENG COMPT SIDE L. & R.H.
- 2 3857962 CEMENT (2.0 OZ. PER JOB)

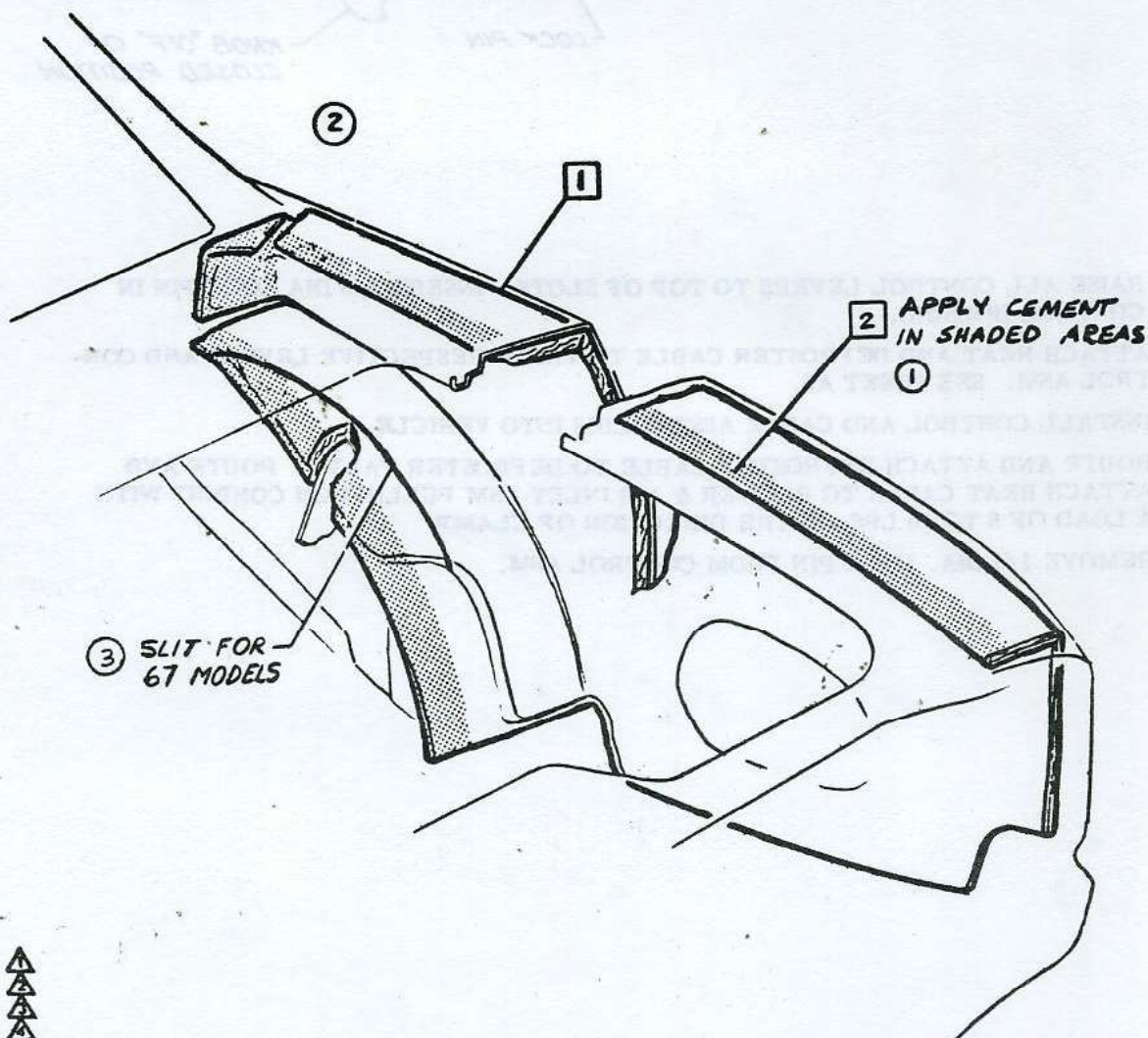

CHEVROLET MOTOR DIVISION, GMC		UPC	DATE	SYM	REVISION RECORD	AUTH	DR	CK
INSULATOR-ENG COMPT SIDE		1	3-25-64	1	CEMENT NOTE ADDED & DWG REV	66467	CC	DF
			11-4-64	2	TRIM PERFORATIONS REMOVED	15920	CK	
			3	WAS PERFORATED			DF	
10500-700		A8.						
DWG —	GMC REF: ECR 64127 L-76097 L-							
DATE REL 7-25	DF L- L- L-							
		X SHEET						

1965-15





# ASSEMBLY INSTRUCTIONS

3862100

CORVAIR 10000 SERIES

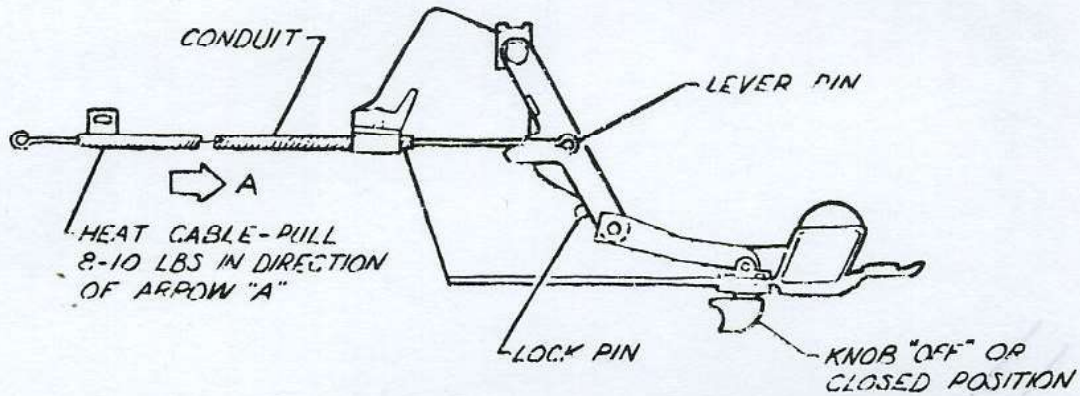

1. RAISE ALL CONTROL LEVERS TO TOP OF SLOTS. INSERT 1/8 DIA LOCK PIN IN CONTROL HOUSING.
2. ATTACH HEAT AND DEFROSTER CABLE TO THEIR RESPECTIVE LEVERS AND CONTROL ASM. SEE SHEET A5.
3. INSTALL CONTROL AND CABLE ASSEMBLIES INTO VEHICLE.
4. ROUTE AND ATTACH DEFROSTER CABLE TO DEFROSTER VALVE. ROUTE AND ATTACH HEAT CABLE TO BLOWER & AIR INLET ASM PULLING ON CONDUIT WITH A LOAD OF 8 TO 10 LBS. IN THE DIRECTION OF CLAMP.
5. REMOVE 1/8 DIA. LOCK PIN FROM CONTROL ASM.



CHEVROLET MOTOR DIVISION, GMC		UPC	DATE	SYN	REVISION RECORD	APPROV.	DR	CK
CABLE CONTROL ADJUSTMENT		1						
10000		A9.						
DWG NO. 8-12	CNC	PER. ECR 430421	1-					
DATE			1-	1-	1-			
		SHEET 10						

1965-16



- |   |   |   |         |               |
|---|---|---|---------|---------------|
| ⑦ | ① | 1 | 3854278 | DUCT ASM-REAR |
|   |   | 2 | 3873950 | SCREW         |
|   | ⑧ | 3 | 3873979 | SUPPORT       |
|   |   | 4 | 9422836 | "U" NUT       |
|   |   | 5 | 3854697 | ADAPTER ASM   |
|   | ② | 6 | 3869521 | CLAMP         |
|   | ② | 7 | 9417226 | SCREW         |
|   |   | 8 | 3863860 | HOSE          |
|   |   | 9 | 120392  | P. WASHER     |

**NOTE** INSTALL CLAMP SCREW IN DIRECTION SHOWN.

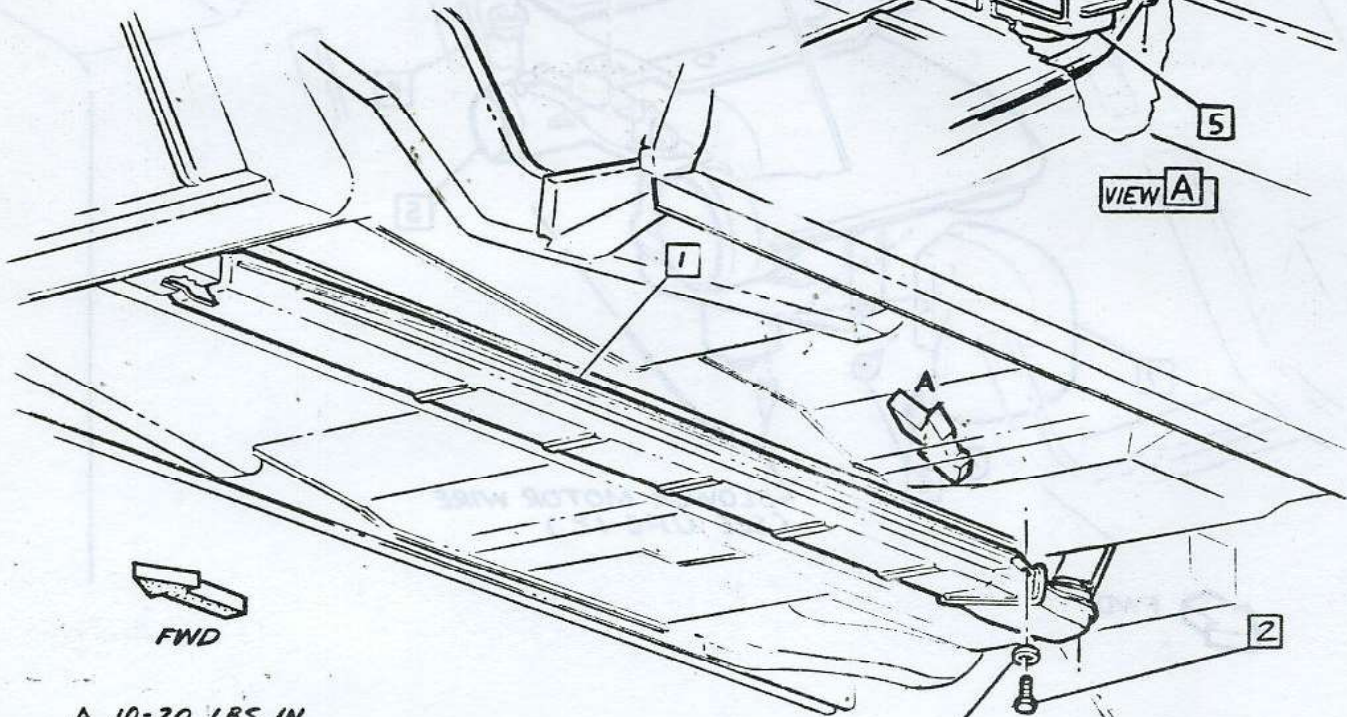
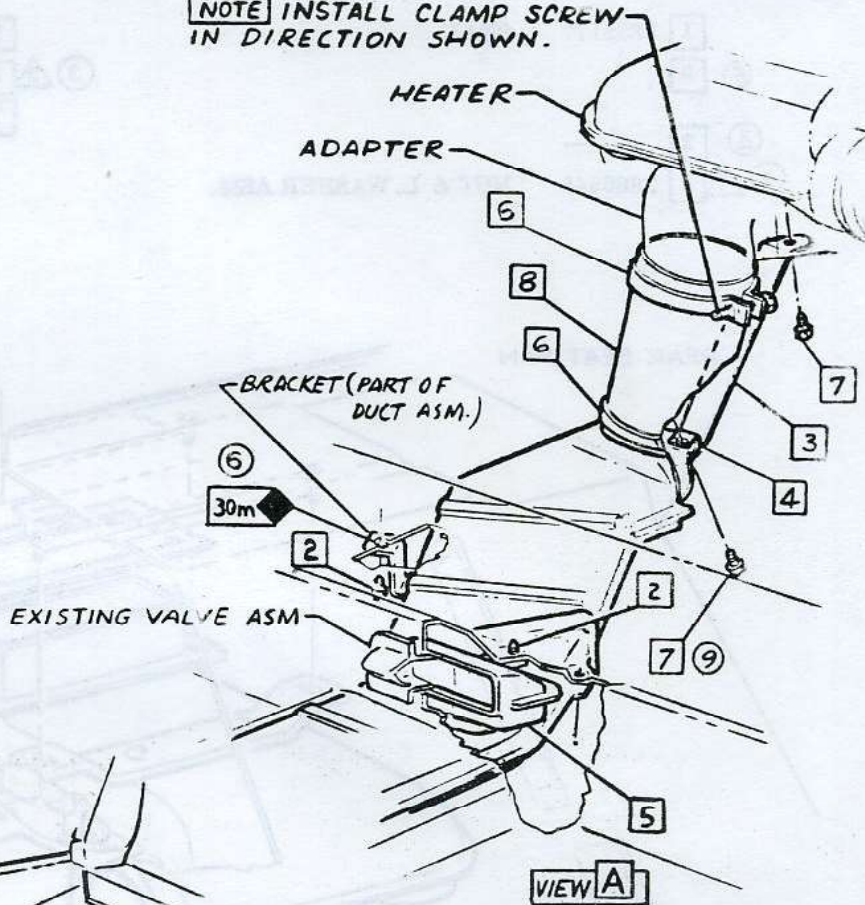

- ▲ 10-20 LBS. IN.  
 ▲ 22-30 LBS. IN.  
 ▲ 16-22 LBS. IN.  
 ▲

CHEVROLET MOTOR DIVISION, GMC				UPC	DATE	SYM	REVISION RECORD	AUTH	DATE
REAR DUCT ASM.				1	10-22-64	6	LUB SYMBOL ADDED	156761AM	
10000				B1.	11-19-64	7	WAS 3861264 SCREW	65037	
DWG PREL. 2-29 AM					2-23-65	8	WAS 3857608 SUPPORT	675691AM	
DATE REL 4-29						9	WAS SYM. (2)	680721	
REF: Prel. B3 L-72397 L-72621									
L- L- L-									
SHEET X									





CHEVROLET

# ASSEMBLY INSTRUCTIONS

3862100

CORVAIR 10000 SERIES

- 1 3855177 SEAL  
 5 2  
 2 3  
 1 1 4 3866846 NUT & L. WASHER ASM.

- 5 3866060 BLOWER & AIR INLET ASM  
 3 2 6 3873950 SCREW  
 7 3852891 ADAPTER

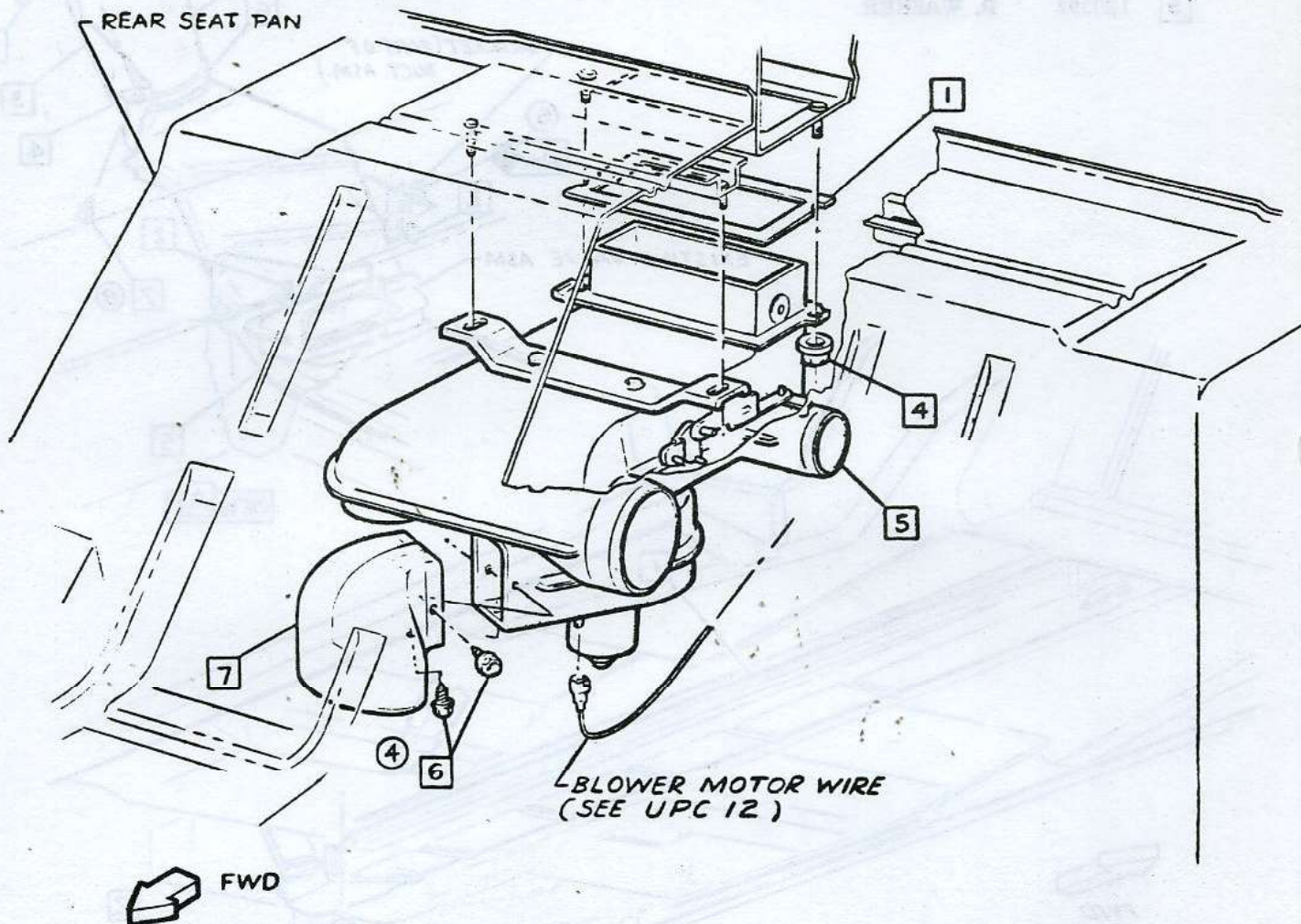

- ▲ 45-65 LBS. IN.  
 ▲ 10-20 LBS. IN.  
 ▲

CHEVROLET MOTOR DIVISION, GMC				UPC	DATE	SYM	REVISION RECORD	AUTH	DR	CK
BLOWER & AIR INLET ASM				1	7-6-64	1	WAS 271172 NUT	63828	AM	
10000						2	120392 F WASHER RMVD			DP
DWG PREL 1-23 AM					10-22-64	3	WAS 3861264 SCREW	66967	AM	
DATE REL 4-8						4	SCREW ADDED	15863		HB
REF: Prel. B1 L-72397 L-					2-23-65	5	3981038 CEMENT REMOVED	15961	MB	CI
L- L- L-										
B2.										
SHEET 1										





CHEVROLET

## ASSEMBLY INSTRUCTIONS

3862100

CORVAIR 10000 SERIES

1 3785549-50 CONNECTOR ASM L. &amp; R.H.

2 9417226

SCREW

2 3816026 SEAL

5 3868700

COVER

① 1 3780162 SCREW

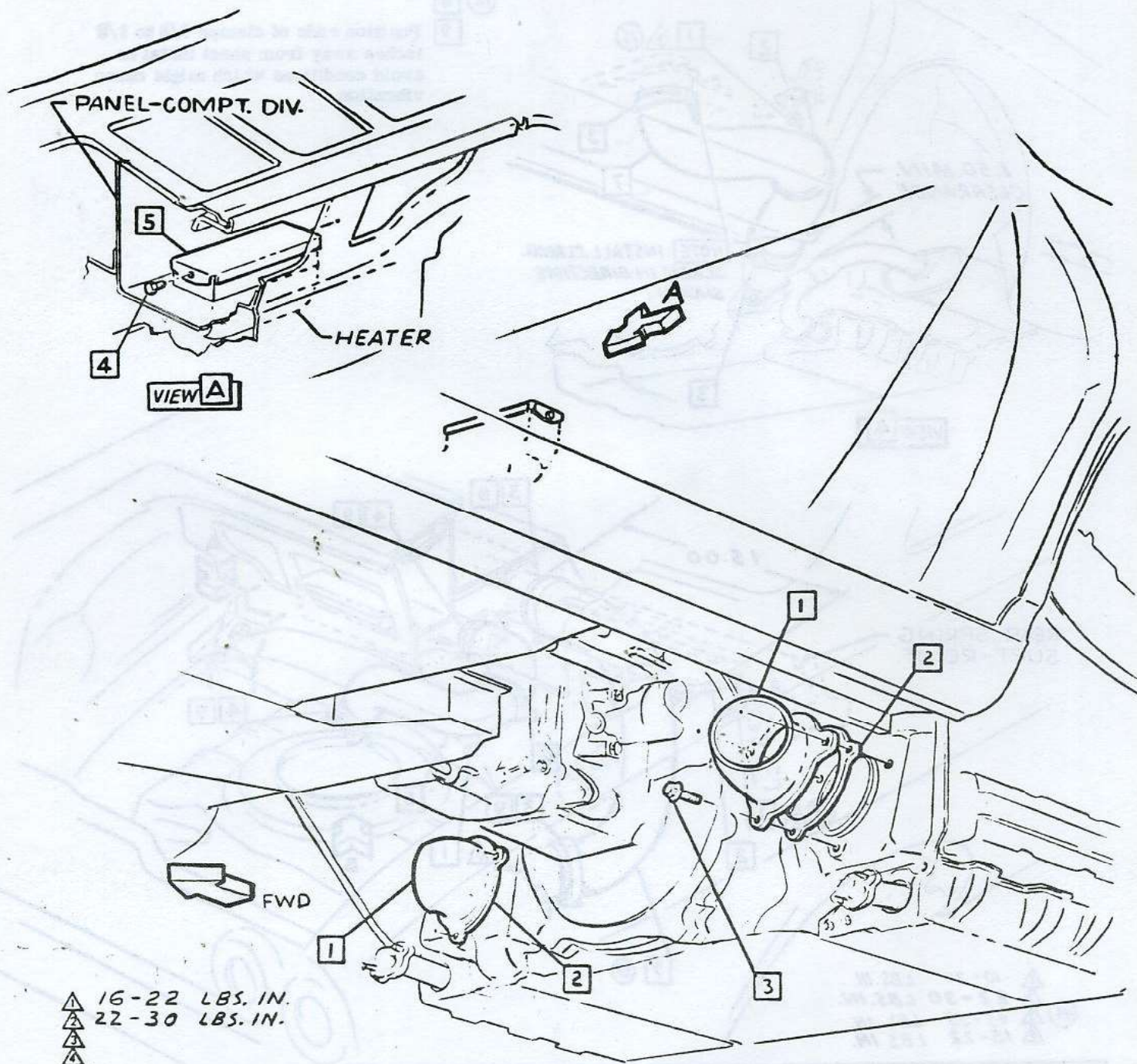

▲ 16-22 LBS. IN.  
▲ 22-30 LBS. IN.  
▲

CHEVROLET MOTOR DIVISION, GMC		UPC	DATE	SYM	REVISION RECORD	AUTH.	DR	CK
HEATER HOSE CONNECTORS		1	7-2-64	1	WAS 9417558 SCREW	15768	AM	DP
10000		B 3.						
DWG PREL 3-7	AM	REF: Prel. B5	L-72621	L-72397				
DATE REL 5-12		L-	L-	L-				
		SHEET						



- 1 3873950 SCREW
- 2 3870281 STRAP
- 3 9420907 CLAMP
- 16 4 9423255 CLAMP

- 5 3864393 HOSE
- 6 3866847 GROMMET
- 7 3870283 HOSE L.H.  
3866844 R.H.

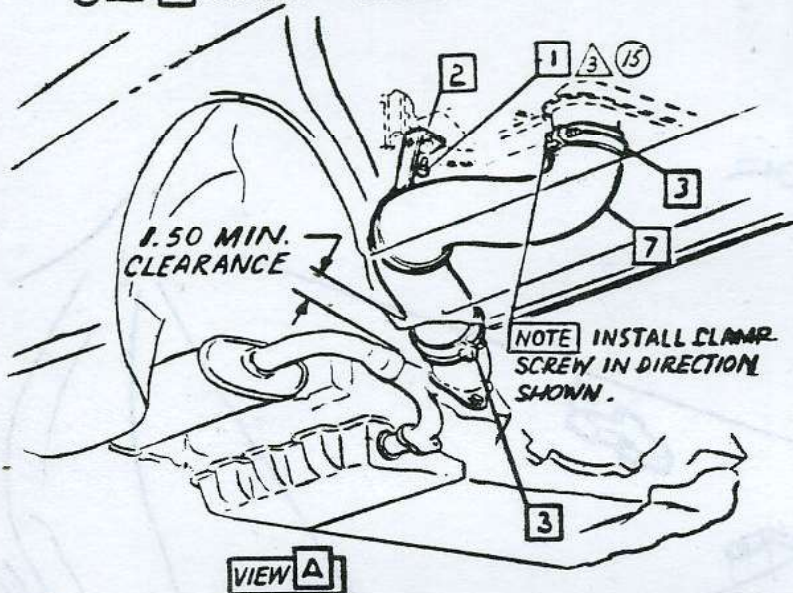

- 12 8
- 9 Position ends of clamps 3/8 to 1/2 inches away from sheet metal to avoid conditions which might cause vibration.

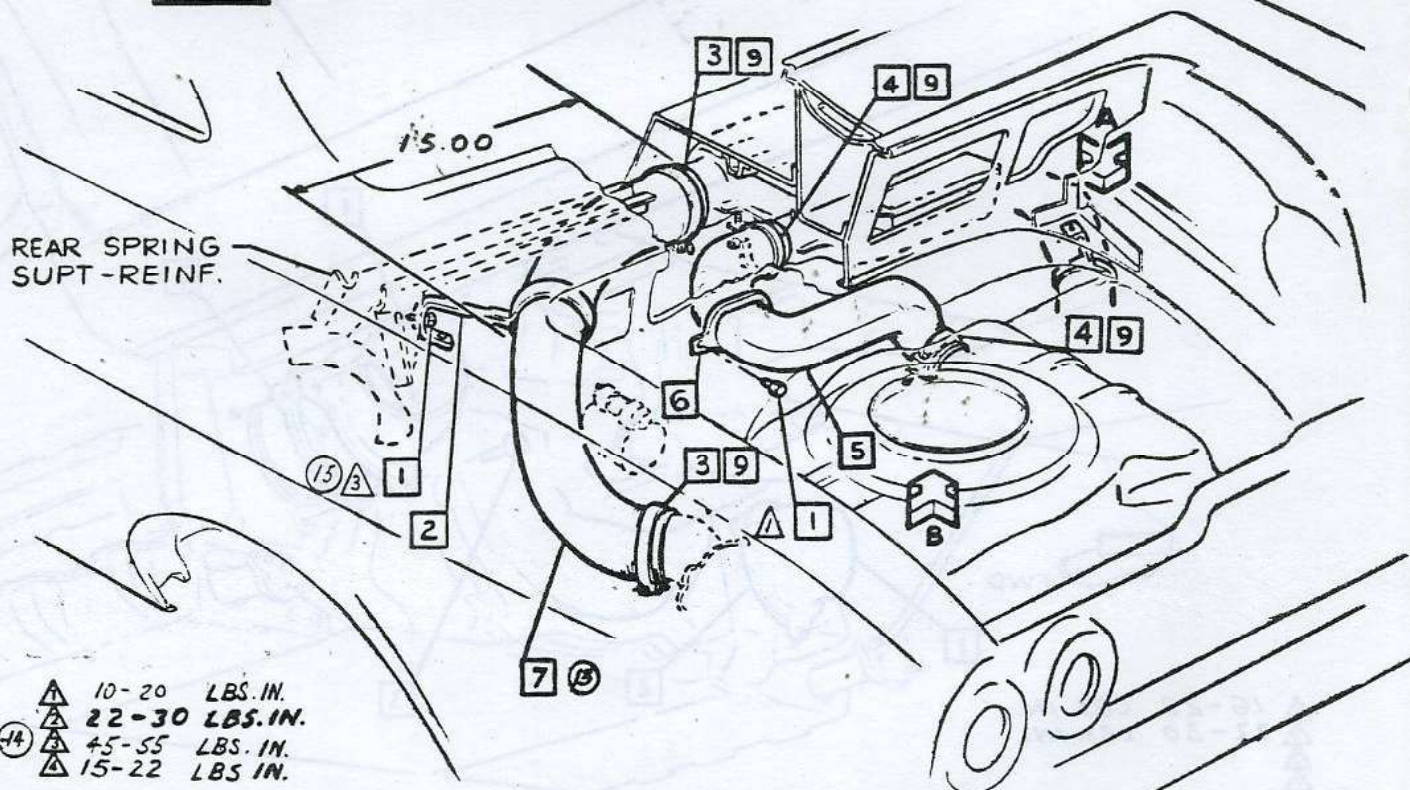

- 10-20 LBS. IN.
- 22-30 LBS. IN.
- 45-55 LBS. IN.
- 15-22 LBS. IN.

CHEVROLET MOTOR DIVISION, GMC				UPC	DATE	SYM	REVISION RECORD	AUTH.	DR	CK
HEATER & DEFROSTER HOSES				1	5-19-65	12	STO-229 SLEEVE REMOVED	1595	UN	
10000				B4.	5-19-65	13	"HOSE" NOTE REMOVED			CI
DWG PREL 3-11 AM REF: Prel. B6 L-72621 L-72397				X SHEET	5-19-65	14	TORQUE (3) HOSES	70038	KA	
DATE REL 5-8					5-4-65	15	WAS 12-20 LBS. IN. (2) PLACES			CI
					5-4-65	16	TORQUE WAS 22-30 LBS. IN.	70791	LS	CI





CHEVROLET

## ASSEMBLY INSTRUCTIONS

3862100

CORVAIR 10000 SERIES

- |   |         |                           |
|---|---------|---------------------------|
| 1 | 3859764 | CABLE ASM. - DEFR. CABLE  |
| 2 | 3859762 | CABLE ASM. - HTR. CONTROL |
| 3 | —       | —                         |
| 4 | 3126659 | NUT                       |
| 5 | 3873950 | SCREW                     |

NOTE FORM CLIP TO SECURELY  
RETAIN CABLE ASM.

VIEW B

EXISTING CLIP

EXISTING CLIP

BRAKE PIPE

CLUTCH CABLE

BODY  
HARNESSEXISTING  
CLIPEXISTING  
CLIP

VIEW A

- 6  $\Delta$  20-30 LBS. IN.  
7  $\Delta$  30-40 LBS. IN.

CHEVROLET MOTOR DIVISION, GMC

UPC

DATE SYM

REVISION RECORD

AUTH. DR CK

HEATER CONTROL CABLES

1

1-25-65	6	TORQUE WAS 10-20 LBS. IN	68894 JM
	7	TORQUE (2) ADDED	
	8	VIEW "A" REVISED	
	9	TORQUE SYM. REMOVED	CI

10000

B5.

SHEET 1

DWG PREL 3-5 AM REF: Prel. B4 L-72621 L-72397  
DATE REL 5-20 L-65030 L-65004 L-

1965-21



This document was created with Win2PDF available at <http://www.win2pdf.com>.  
The unregistered version of Win2PDF is for evaluation or non-commercial use only.  
This page will not be added after purchasing Win2PDF.