

ASSEMBLY MANUAL

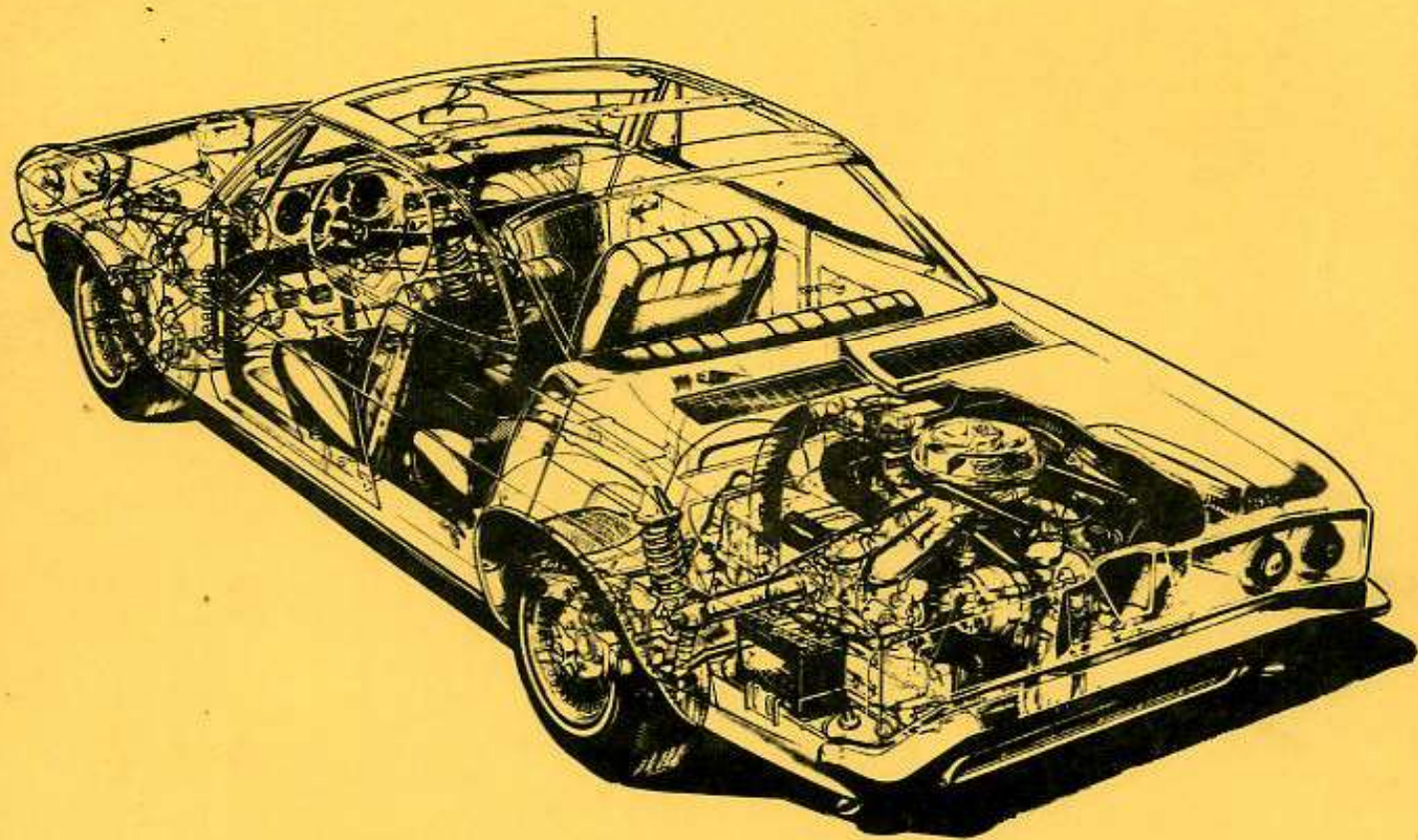

**1965
CORVAIR**

C7315

SECTION 6
ENGINE



P R E P A R E D

ASSEMBLY INSTRUCTIONS

3862100

CORVAIR 10000 SERIES

SHEET

TITLE

SHEET

TITLE

- | | | | | |
|----------|----------------------------------|-------------|-----|---------------------------------|
| A1. | CONTENTS | [R] | C3. | AIR CLEANER & VACUUM TUBES |
| [A] A2. | BLOWER & PULLEY . | [S] | C4. | FUEL LINES |
| [B] A3. | GENERATOR MOUNTING | [T] | C5. | FUEL PUMPS & FUEL PIPES |
| [C] A4. | BELT GUIDE & BELT ADJUSTMENT | [U] | C6. | CLOSED ENG POSITIVE VENT |
| [D] B1. | SHROUD ASM-UPPER | [V] | C7. | |
| [E] B2. | OIL FILLER & OIL LEVEL GAGE | [W] | C8. | VACUUM BALANCE TUBES |
| [F] B3. | EXHAUST DUCT ASM & LWR SHROUD | [X] | C9. | VACUUM GAGE HOSE |
| [G] B4. | EXHAUST DUCT HEAT THERM | [Y] | D1. | ACCELERATOR PEDAL & LINKAGE |
| [H] B5. | SHROUD LWR & EXH DUCT ASM TO ENG | [Z] | D2. | ACCEL CONT LINKAGE & ADJUSTMENT |
| [J] B6. | EXH DUCTS TO ENG & HEAT SHLD | [AA] | D3. | |
| [K] B7. | STARTING MOTOR MOUNTING | [2] [1] [1] | D4. | |
| [L] B8. | SPARK PLUG WIRING & COIL MTING | | D5. | ACCELERATOR LINKAGE |
| [M] B9. | ENGINE FRONT MOUNTING | | D6. | ACCELERATOR LINKAGE ADJUSTMENT |
| B10. | REAR | | D7. | CARBURETOR ADJUSTMENT |
| [P] B11. | IGN SWITCH & VOLTAGE REGULATOR | | | |
| [Q] C1. | CARBURETOR & SPARK HOSE | | | |
| | C2. | | | |

3873861 ENG AS SHIPPED(Exc 10700)
3873863 10700

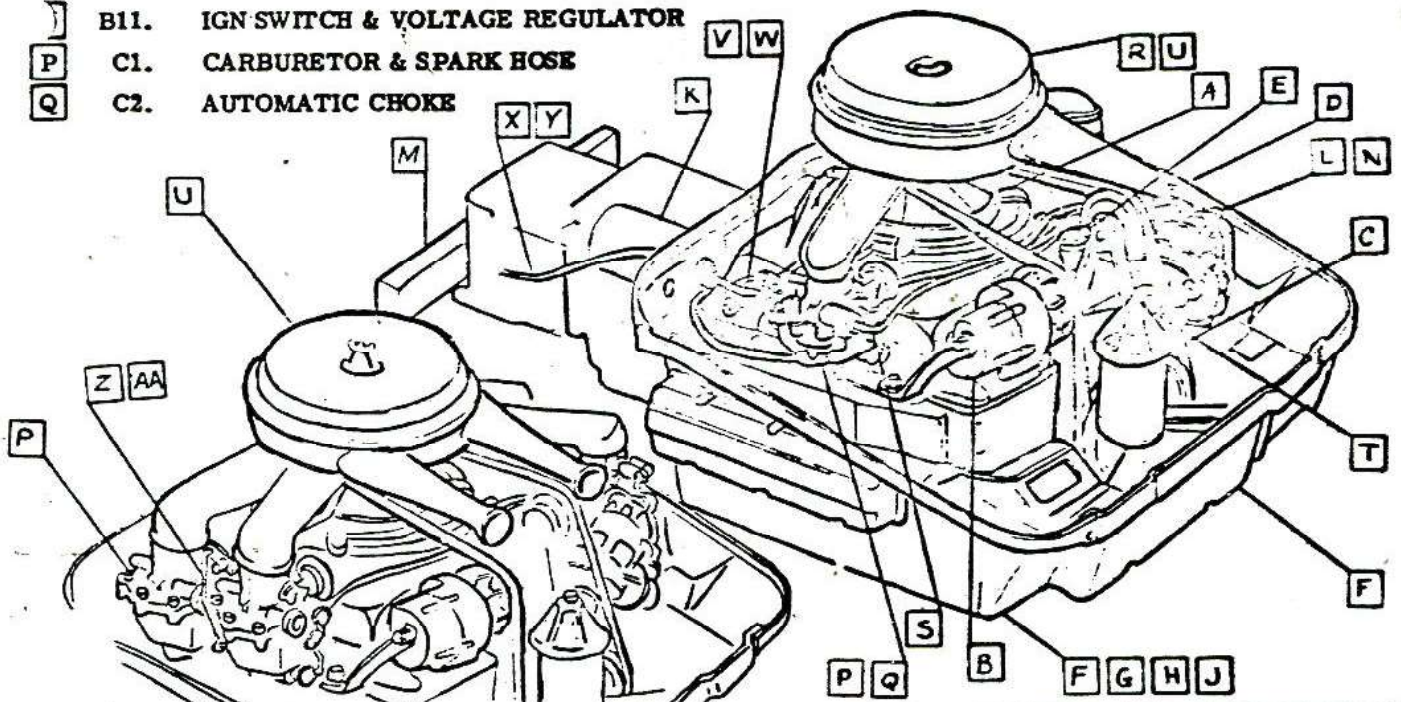

• CHEVEOLET MOTOR DIVISION, GMC •		UPC	DATE	SYM	REVISION RECORD	AUTH	DR	CK
CONTENTS-ENGINE		6	11-3-64	1	3870295 WAS 3871859 E	65836	GA	
					3870297 WAS 3856740			DF
			12-14-64	2	3873861 WAS 3870255 E	65521	BR	
					3873863 WAS 3870297			CI
			5-11-66	3	SHEET D7. ADDED			AS CI
10000		A1.						
DWG PREL. 3-11 6W REF: Prel. A4 L-71204 L-75672								
DATE REL. 5-20 L- L- L-		SHEET 1						

1965-54



CHEVROLET

ASSEMBLY INSTRUCTIONS

3878200

CORVAIR 10000 SERIE

- ⚠ 1 3856672 SCREW ASM. ②
① 2
3 3856616 PULLEY
4 3856615 BLOWER

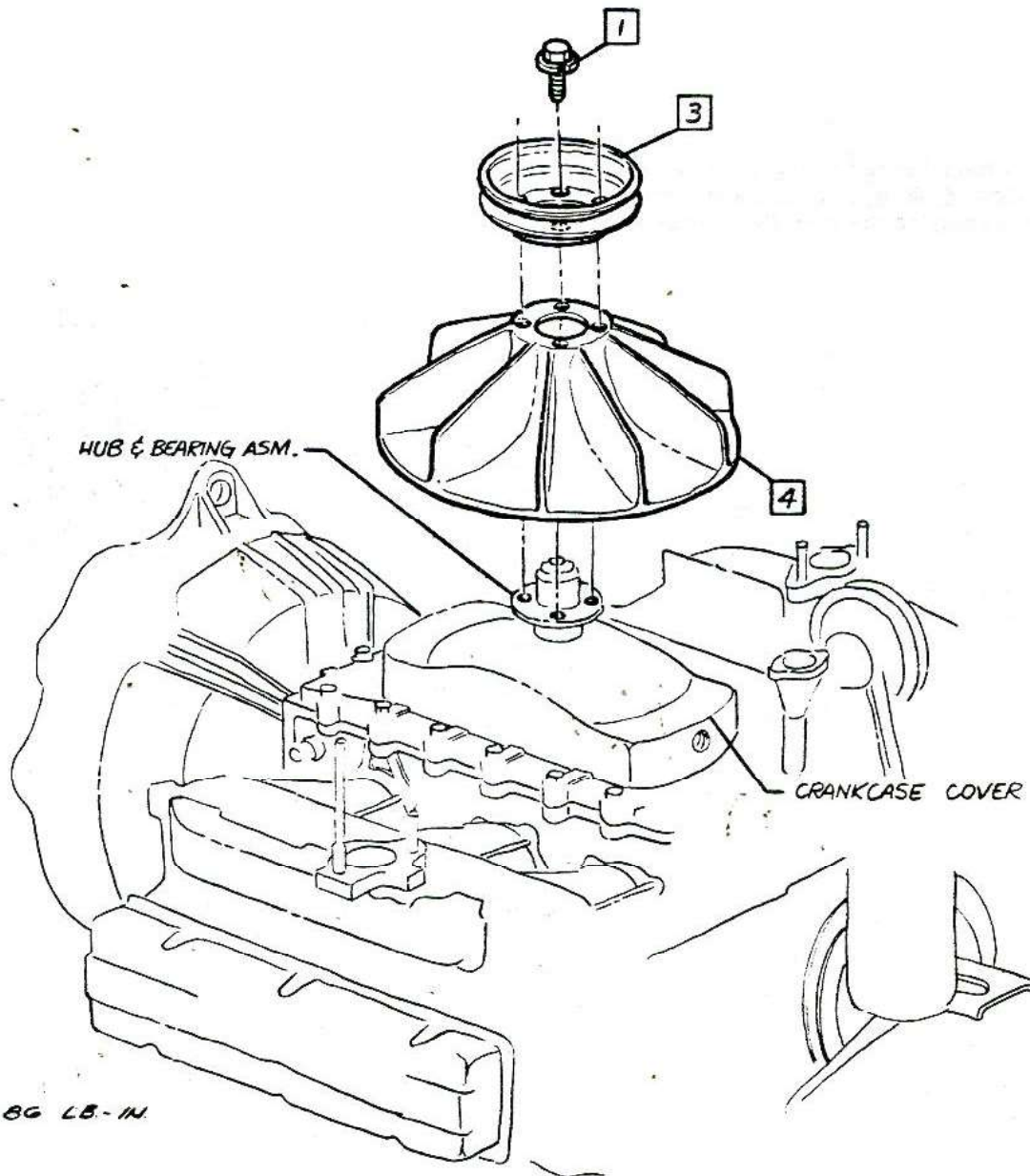

70-86 LB.-IN.

CHEVROLET MOTOR DIVISION, GMC		UPC	DATE	SYN	REVISION RECORD	AUTH.	DR	CR
ENGINE BLOWER & PULLEY		6	6-19-64	1	120355 N-55-56 REMOVED	63216	GM	
				2	"SCREW ASM." WAS "SCREW"			DE
			1-25-65	3	70-86 LB.-IN. ADDED			GM
10000		A2.						
DWG PREL. 3-7	GMW	REF: Pmt. A1	L-72225	L-				
DATE REL. 3-7			L-72299	L-				
		<input checked="" type="checkbox"/> SHEET 1						

1965-55

+



ASSEMBLY INSTRUCTIONS

3862100

CORVAIR 10000 SERIES

- 1 1100839 GENERATOR ASM
- 2 3856602 PULLEY ASM
- 3 3765135 L. WASHER
- 4 427559 BOLT
- 5 3883889 BRACE
- 6 3883890 SPACER

- 7 103321 L. WASHER
- 8 122138 BOLT
- 9 122017 BOLT
- 10 103320 L. WASHER
- 11 446363 P. WASHER
- 12 178556 L. WASHER

NOTE Attach brace 5 to generator asm. 1
finger tight 8 & 9. Install and torque screw
8 before applying the specified torque to screw
9

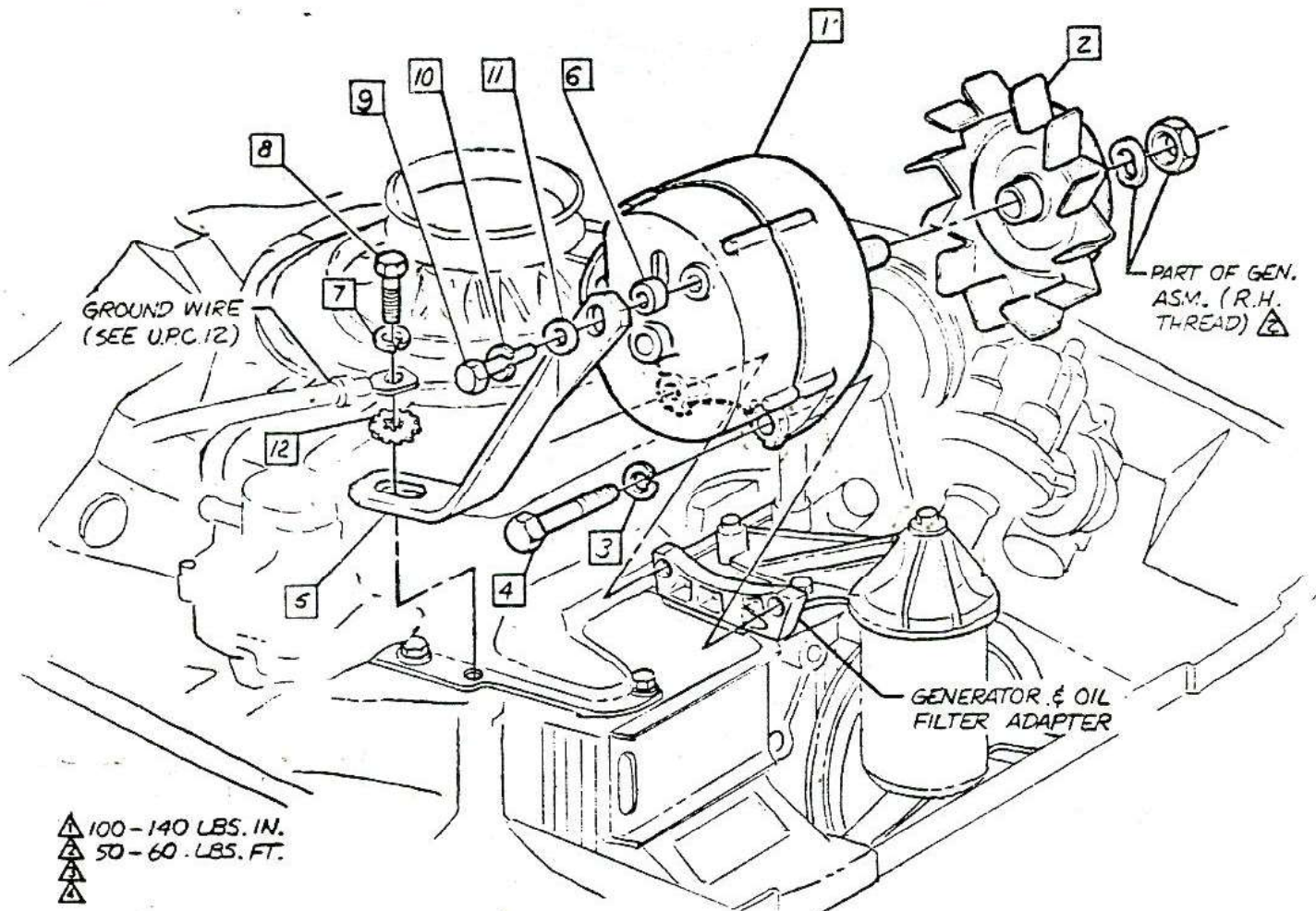

CHEVROLET MOTOR DIVISION, GMC		UPC	DATE	SYM	REVISION RECORD	AUTH.	DR	CK
GENERATOR MOUNTING		6	9-23-65	8	ITEM 6 ADDED			
10000		A3.		9	WAS 3867220 BRACE			
DWG PREL 3-10 GNV REF: Prel. A2 L-74597 L-75862		SHEET		10	WAS 122007 BOLT			CI
DATE REL. 5-11								
L-74795 L-72271 L-								

1965-56

②	1	423553
③	2	3870289
	3	3780981
		3779672

SCREW ASM
GUIDE-BELT FRONT
BELT
OPT.

SUGGESTED BELT TENSIONING PROCEDURE

1. Tension belt on engine line by loading idler pulley until a belt tension of 80 ± 10 lbs. is obtained.
2. Crank engine for approximately 6 seconds to seat belt in pulleys.
3. Torque idler pulley adjusting bolts to specified torque & remove idler pulley load.
4. If belt strand tension is below 65 lbs. after all normal engine running has been completed, retension belt as required.

CAUTION Insufficient strand tension results in belt "slip" on pulleys, belt "turn over" on air conditioned vehicles where no belt guides are used & belt "rumble" on powerglide equipped vehicles. Sufficient strand tension also results in increased belt life.

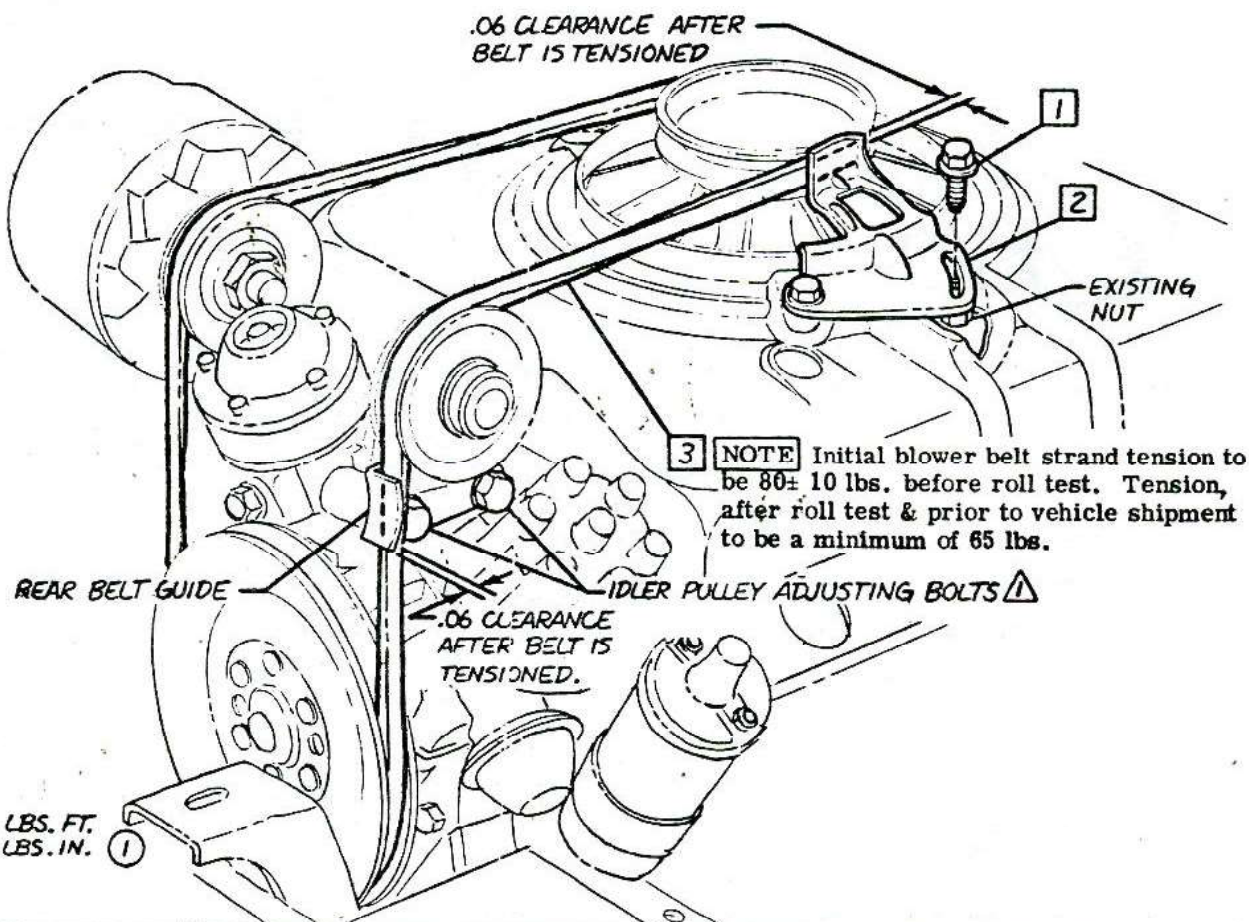

• CHEVROLET MOTOR DIVISION, GMC •				UPC	DATE	SYM	REVISION RECORD	AUTH.	DR	CK
BELT, GUIDES & BELT ADJUSTMENT				6	7-26-64	1	TORQUE (2) ADDED	62777	GN	
						2	WAS TORQUE (1)			
10000				A4.	11-4-64	3	WAS 3851844 GUIDE	15896	GN	HB DF
DWG PREL. 3-11										
DATE REL. 3-11										
REF: Prel. A3										
L-65936										
L-										
L-										
L-										
X SHEET										



CHEVROLET

ASSEMBLY INSTRUCTIONS

3862100

CORVAIR 10000 SERIES

- ① 1 274840 BOLT
- ② 2 9417881 SCREW
- ③ 3 3780162 SCREW
- ④ 4 3851893 SHROUD ASM-10100-500
- ① 3856773 10700
- ⑤ ② 5 3870384 "U" NUT
- ③ 6 6257105 COVER- 10100-500
- 3848396 10700
- ④ 7 9417558 SCREW

- 8 3787440 CONNECTOR
- ④ 9 3861264 SCREW
- ⑥ 10 3870384 "U" NUT

NOTE Use special hand tool to acquire a .030 total indicator reading relationship between Q_1 of upper shroud as established by dia. & pulley centerline.

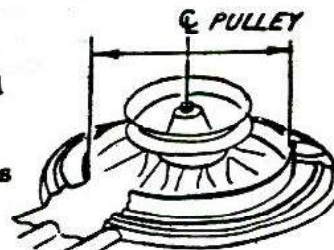

VIEW B

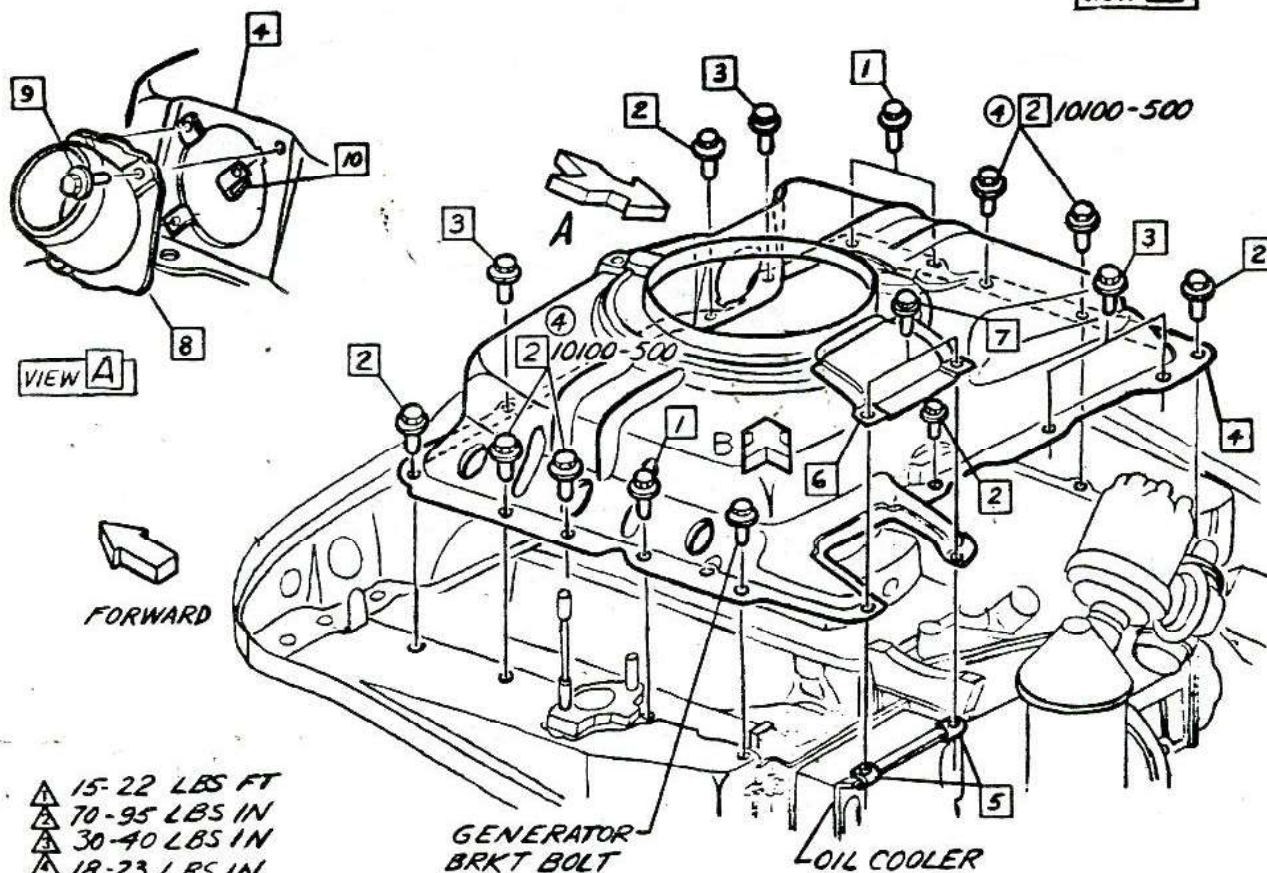

- ① 15-22 LBS FT
- ② 70-95 LBS IN
- ③ 30-40 LBS IN
- ④ 18-23 LBS IN

• CHEVROLET MOTOR DIVISION, GMC •				UPC	DATE	SYM	REVISION RECORD	AUTH.	DR	CR
SHROUD ASM. - UPPER				6	7-23-64	1	3856773 ADDED	64798	63687	JB
						2	WAS 9818153 NUT			
10000				B1.		3	3848396 ADDED			
						4	10100-500 ADDED (2) PLCS			DF
DWG/REL 3-9 JB REF: Prel. 87 L-73036 L- DATE/REL 5-18 L- L- L-				SHEET <input checked="" type="checkbox"/>	9-3-64	5	WAS 9418159 NUT	65484	JB	
						6	WAS 9420856 NUT			DF

ASSEMBLY INSTRUCTIONS

3862100

CORVAIR 10000 SERIE

- | | | | |
|-----|---|---------|--|
| (1) | 1 | 3860444 | GAGE ASM 10100-500 COLOR CODE(NONE OPT ORANGE) |
| (2) | | 3860445 | 10700-COLOR CODE(NONE OPT ORANGE) |
| (3) | 2 | 3856695 | TUBE-OIL LEVEL 10100-500 |
| | | 3867215 | 10700 |
| (4) | 3 | 3867245 | GROMMET |

- | | | |
|----------|----------------|------------------------|
| 4 | 3849800 | CAP ASM |
| | 3849802 | OPT |
| 5 | 3785359 | TUBE-OIL FILLER |
| | 3782032 | OPT |

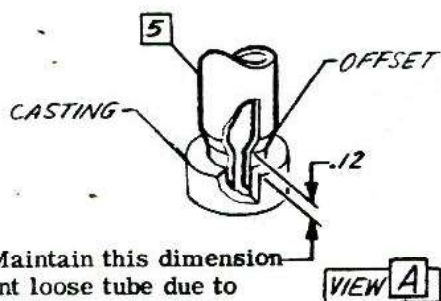

NOTE Maintain this dimension to prevent loose tube due to bottoming of tube offset on casting

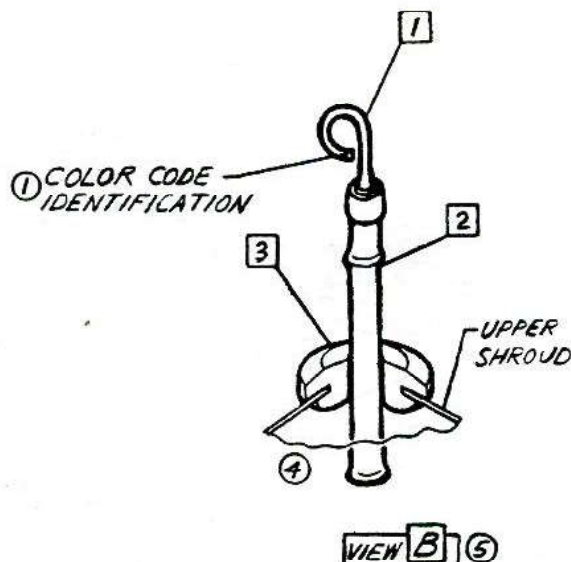

NOTE Gage handle—must point rearward.

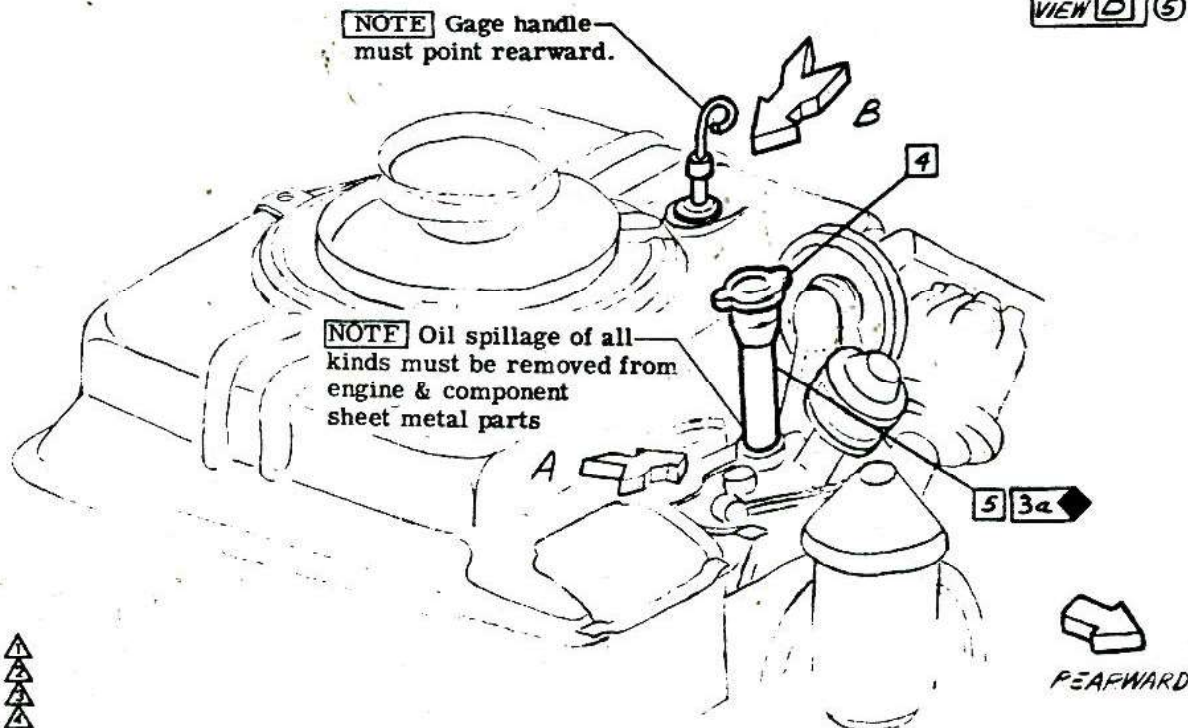

NOTE Oil spillage of all—
kinds must be removed from
engine & component
sheet metal parts

PEAFWARD

* CHEVROLET MOTOR DIVISION, GMC *				UPC		DATE SYM		REVISION RECORD		AUTH DR CX	
OIL FILLER & OIL LEVEL GAGE				6		7-2-64 1		SCREW REPLACED 2 PLACES		63687 JB	
						2		3867215 ADDED			
						3		WAS 625713 BOOT		64586	
						4		LUB SYM 606 REMOVED		64798	
				B 2.		5		VIEW B REVISED		DF	
						6		ORANGE WAS GREEN 2 PLCS		JB DF	
10000											
DWG PREL 3-10		JB		REF: Prel. B B L 74520 L-75836							
DATE REL 3-10		L-		L-							
						X		SHEET			



CHEVROLET

ASSEMBLY INSTRUCTIONS

3862100

CORVAIR 10000 SERIES

- ① 1 3867225 DUCT & DAMPER ASM.-L.H. (10100-500)
3867231 (10700)
3867226 R.H.
- ② 2 9417558 SCREW
- ③ 3 3867251-2 SHROUD-LWR-L. & R.H.

SUGGESTED ASSEMBLY SEQUENCE

1. Fixture exhaust duct asm. & lower shroud in the thermostat setting fixture to hold locating dimensions shown.
2. Attach exhaust duct asm. to lower shroud.
3. Remove assembly from fixture.

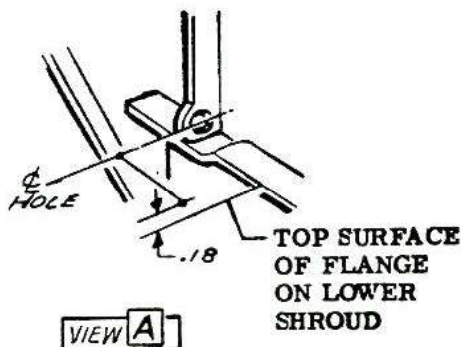
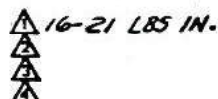
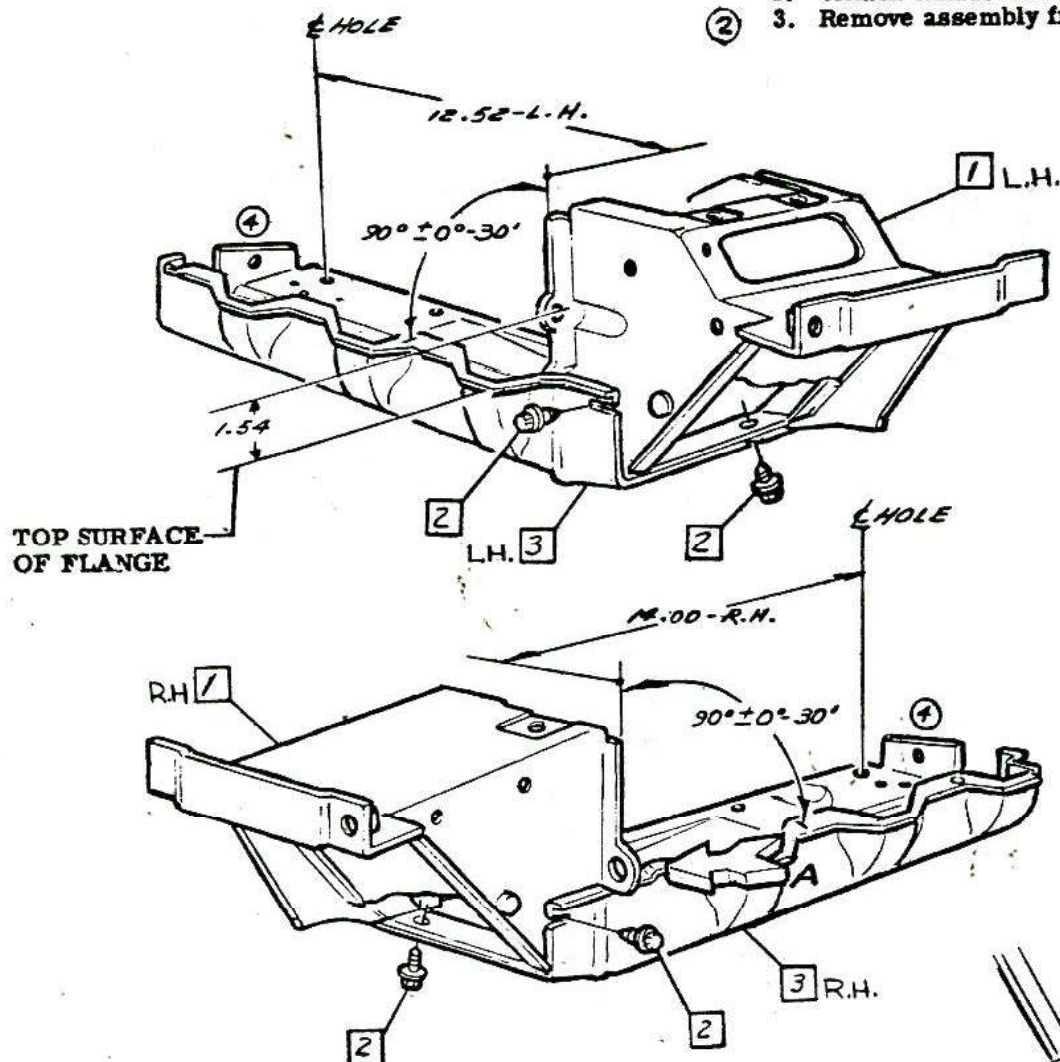

CHEVROLET MOTOR DIVISION, GMC				UPC	DATE	SYM	REVISION RECORD		AUTH.	DR.	CK.
EXHAUST DUCT ASM. & LOWER SHROUD				6	8-13-64	1	3867225, 3867231, & 3867226	6367	JB		
							WAS 3851957, 3851971, & 3851958	63687			
						2	SEQUENCE NOTE REVISED			DF	
					9-3-64	3	WAS 3856791-2 SHROUD	65521	JB		
						4	DWG REVISED 2 PLACES			DF	
10000				B3.							
DWG PEEL 3-10 JB REF: Prel. B9 L-73743 L-				SHEET							
DATE REL 5-15 L- L- L-											

1965-60

- | | | | | | |
|-----|---------|----------------------------|-----|---------|------------------|
| ⚠ 1 | 103025 | NUT | ⚠ 6 | 3356795 | SWIVEL |
| 2 | 3856793 | BRACKET | 7 | 441310 | RIVET |
| 3 | 3156784 | THERMOSTAT ASM (10100-500) | 8 | 3830431 | SHIELD-HEAT-L.H. |
| | 3156432 | (10700) | | 3856798 | R.H. |
| 4 | 3856794 | ROD-ACTUATING | | | |
| 5 | 3711177 | CLIP | | | |

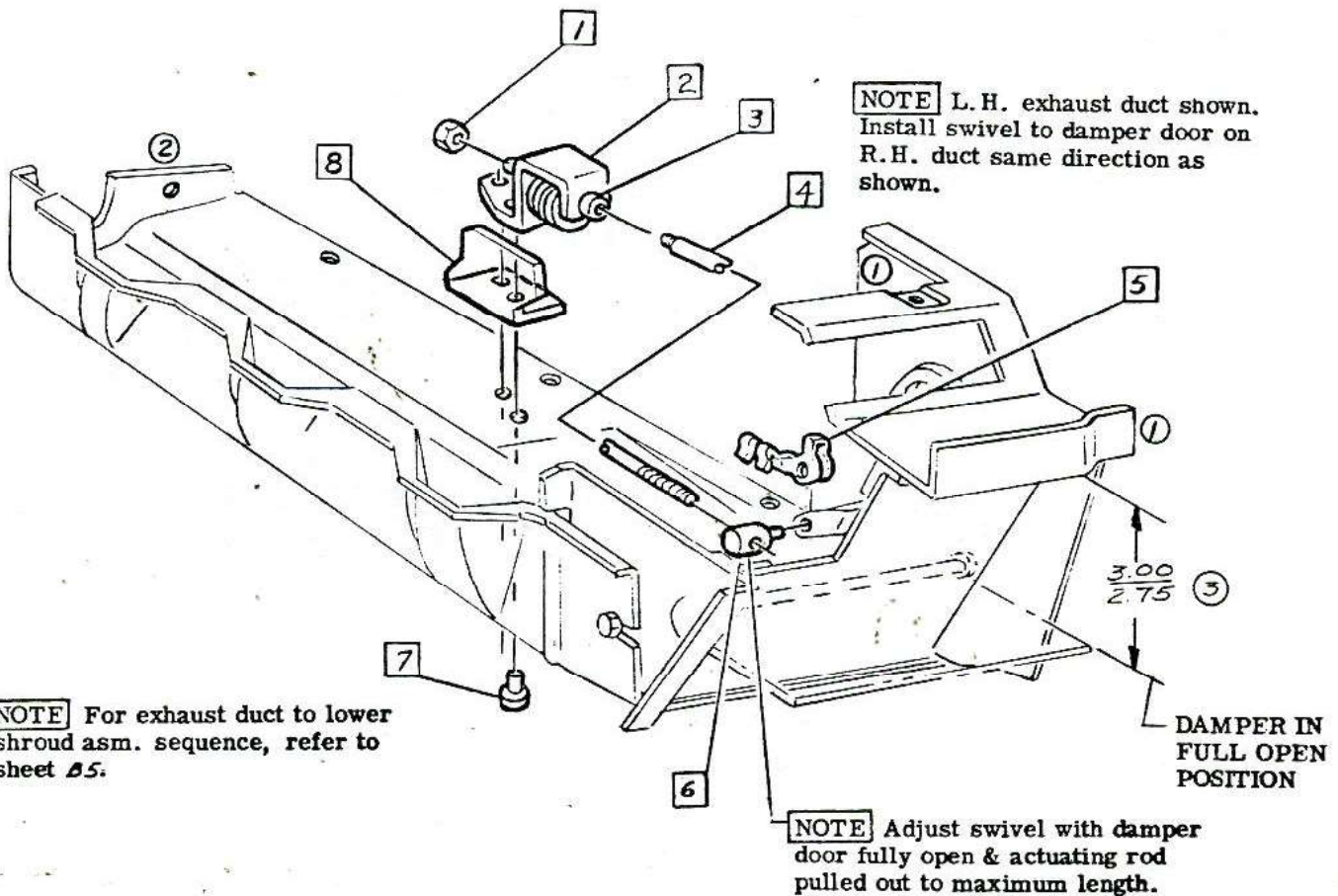

- ⚠ 70-110 LBS IN.
- ⚠ 13-17 LBS IN.
- ⚠

CHEVROLET MOTOR DIVISION, GMC				UPC	DATE	SYM	REVISION RECORD	AUTH	DR	CK
EXHAUST DUCT HEAT THERMOSTAT				6	3-12-64	1	DWG REVISED 2 PLACES	63867	JB	DF
10000				B4.	3-3-64	2	DWG REVISED	65321	JB	DF
DWG PREL 3-10 JB REF: Prel. B5 L-72375 L-				✓ SHEET	3-31-65	3	WAS 3.16	70038	DA	CI
DATE REL 5-18 L- L- L-										



CHEVROLET

ASSEMBLY INSTRUCTIONS

3862100

CORVAIR 10000 SERIES

- 1 3822936 SEAL
2 3788090 SEAL
② ① 3 9419385 SCREW AFM

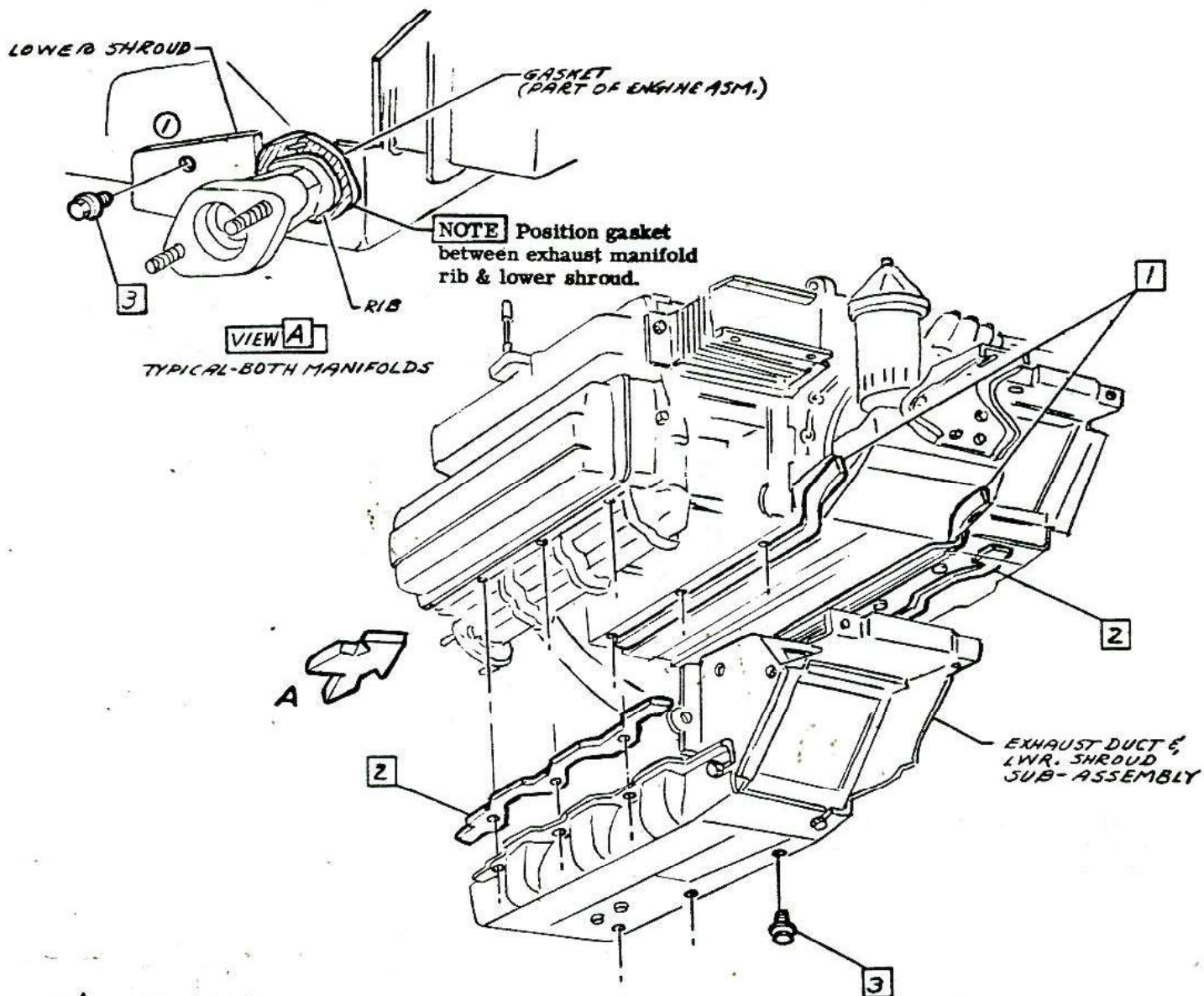

70-95 LBS IN.

• CHEVROLET MOTOR DIVISION, GMC •				UPC	DATE	SYM	REVISION RECORD	AUTH.	DR.	CK.
SHROUD-LOWER & EXHAUST DUCT ASM. TO ENG.				6	3-64	1	DWG REVISED	65521	JB	
						2	WAS 9417881 SCREW	65836		DF
10000				B5.						
DWG PREL 3-10 J.B. REF: Prel. B6 L-53956 L-23793										
DATE REL 3-10 L- L- L-				SHEET						

1965-62



CHEVROLET

ASSEMBLY INSTRUCTIONS

3862100 CORVAIR 10000 SERIES

- ⑤②① 9419303 SCREW
- ② 9422836 NUT "U"
- ③ 274840 BOLT
- ④ 3780162 SCREW
- ⑤ 3851972 COVER (10700)
- ⑥ 273624 SCREW (10700)

- ⑦ 9419385 SCREW
- ⑧ 3851898 SHIELD ASM-HEAT 10100-10700
- ⑨ 120380 L. WASHER
- ⑩ 120706 BOLT

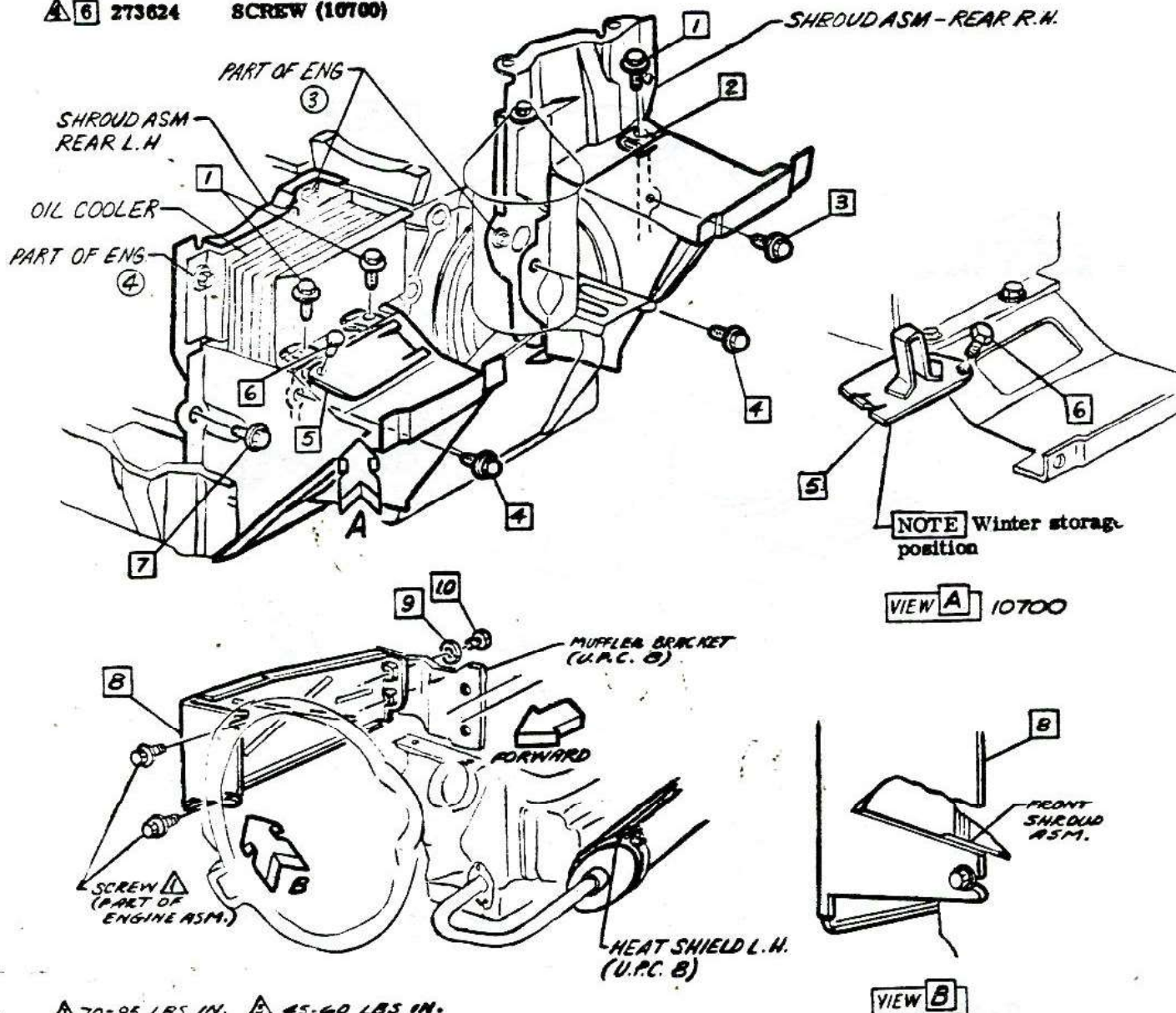

- ① 70-95 LBS IN.
- ② 18-23 LBS IN.
- ③ 15-22 LBS FT
- ④ 30-40 LBS IN
- ⑤ 45-60 LBS IN.
- ⑥ 25-35 LBS IN.

CHEVROLET MOTOR DIVISION, GMC				UPC	DATE	SYM	REVISION RECORD	AUTH	DR	CK
EXHAUST DUCTS & ROCKER COVER HEAT SHIELD TO ENGINE				6	2-3-62	1	REDRAWN & REVISED 65826 65484 JEB			
							63B67			
10000				B6.	12-30-64	2	WAS 9417881 SCREW	68486	BR	
						3	WAS SYM (1) 2 PLACES			
DWG PREL 3-10 JB REF: Pmt. B10 L-73743 L-				X SHEET 1		4	WAS SYM (7)			CI
					5-4-65	5	TORQUE WAS 70-95 LBS. IN. 70791 45 CI			
DATE 5-15 L- L- L-										



CHEVROLET

ASSEMBLY INSTRUCTIONS

3862100

CORVAIR 10000 SERIES

- 1 1108306 MOTOR ASM. -STARTING
2 179845 BOLT
3 WIRE ASM. - SEE UPC 12

FORWARD OUTBOARD

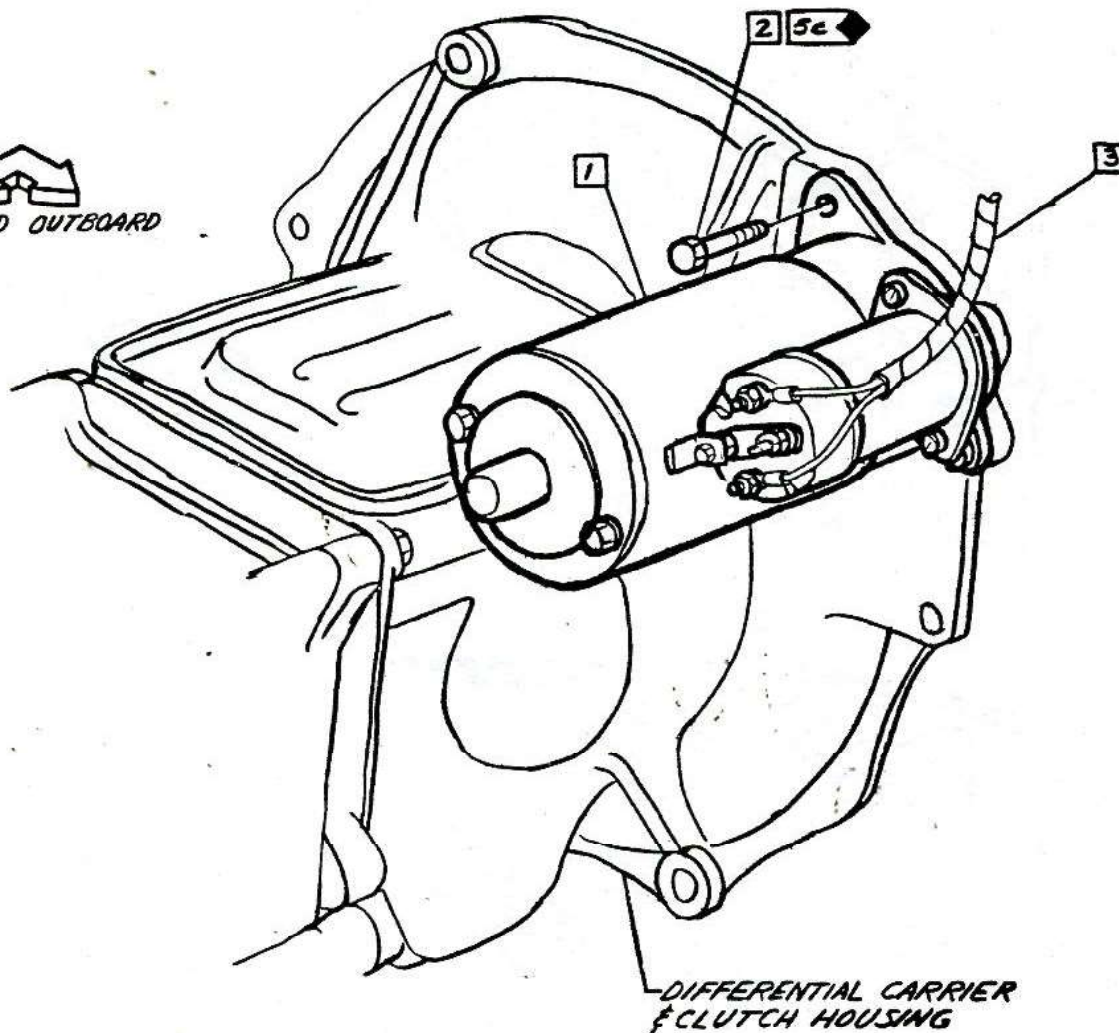

20-30 LBS FT

CHEVROLET MOTOR DIVISION, GMC				UPC	DATE	SYM	REVISION RECORD	AUTH.	DR.	CK.
STARTING MOTOR MOUNTING				6						
10000				B7.						
DWG/PREL 2-24	JB	REF: Prel. B-1	L-	L-						
DATE/REL 5-21		L-	L-	L-						
SHEET 1										

1965-64

- 1 2985993 WIRE ASM (CYL NO 1)
- 2 2985996 WIRE ASM (CYL NO 2)
- 3 2985994 WIRE ASM (CYL NO 3)
- 4 2985997 WIRE ASM (CYL NO 4)
- 5 2985995 WIRE ASM (CYL NO 5)
- 6 2985998 WIRE ASM (CYL NO 6)
- 7 2985951 WIRE ASM (HI TENS)
- 8 1115200 COIL
- 9 3815414 SUPPORT

- 10 9417227 RIVET
- 11 2965736 RETAINER R.H. SIDE
- 12 3702799 RETAINER

NOTE Spark plug wires 4 & 6 must be routed horizontally as shown to allow T.V. Rod clearance

NOTE Route No's 2, 4 & 6 spark plug wires under oil inlet pipe (10700)

NOTE position retainer 1.00 to rear of #4 spark plug boot

NOTE Position white mark on cable assemblies 2, 4 & 6 into R.H. support as shown

NOTE Wire from dist to neg post loosen nut & insert terminal between nut & clip

NOTE Route No 5 spark plug wire below the lowest position of the carb. choke vacuum hose on the R.H. primary carb. on 10700 models.

NOTE Route spark plug above carb. fuel pipe & through R.H. retainer as shown, on 10700 & 10100-500 with L63.

NOTE Position retainer .76 to rear of gas feed pipe.

NOTE 10700 & 10100-500 WITH L63

CHEVROLET MOTOR DIVISION, GMC		UPC	DATE	SYM	REVISION RECORD	AUTH	DR	CK
SPARK PLUG WIRING & COIL MOUNTING		6	1-65	6	REWORKING & REDESIGNED	65389	JLC	1
10000		B8.						
DWG PREL 2-28	JB	REF: Prel. B-2	L-	L-				
DATE REL 5-21		L-	L-	L-				
		1 SHEET						



CHEVROLET

ASSEMBLY INSTRUCTIONS

3862100

CORVAIR 10000 SERIES

- ③ 1 3872898 MOUNTING ASM
- ① 2 3868692 SUPPORT ASM
- ⚠ 3 9414262 NUT
- 4 103374 C. PIN
- 5 103321 L. WASHER

- ⚠ 6 179841 SCREW
- 7 179838 BOLT
- ⚠ 8 102635 NUT

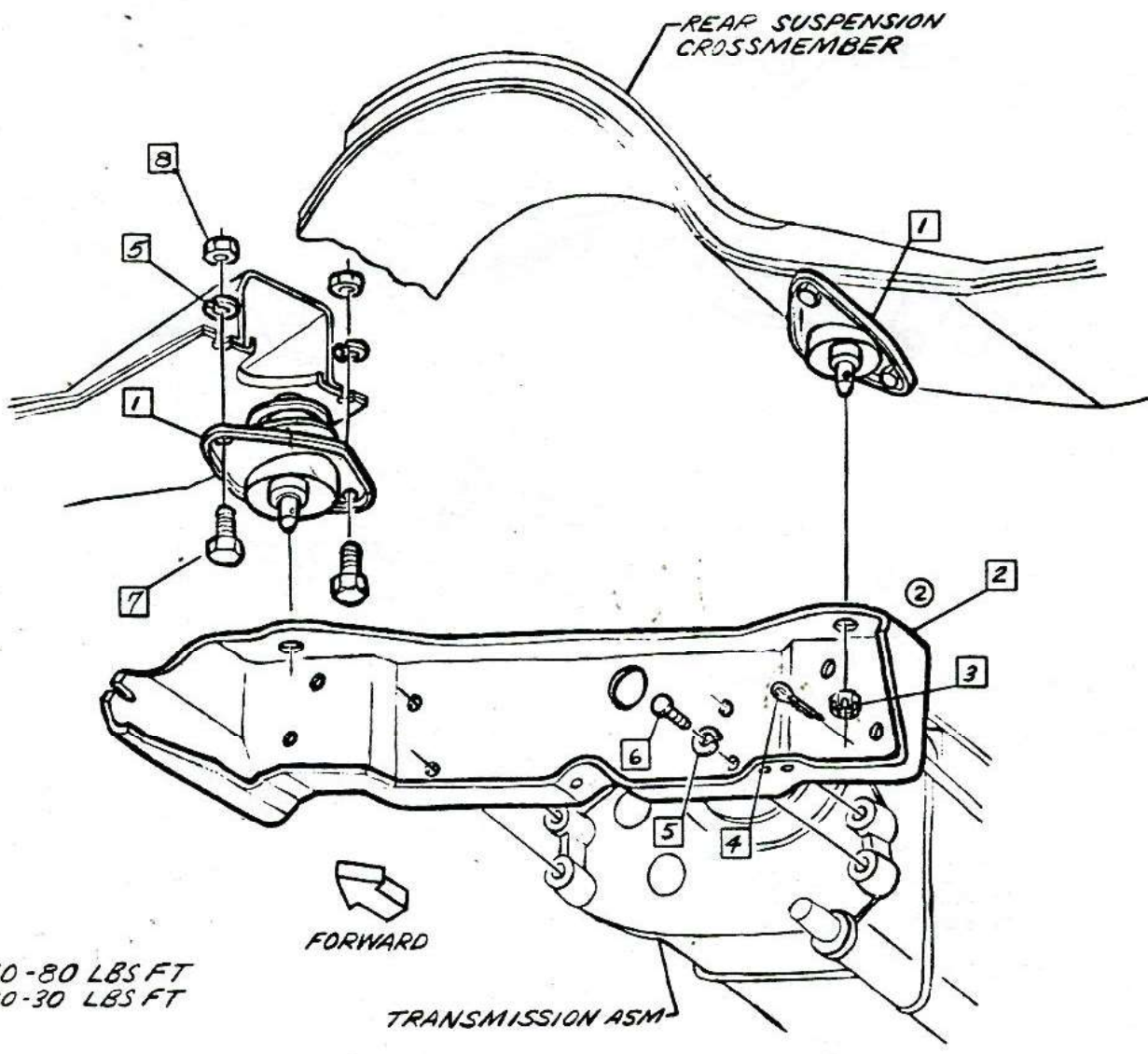

⚠ 60-80 LBS FT
 ⚠ 20-30 LBS FT
 ⚠

• CHEVROLET MOTOR DIVISION, GMC •		UPC	DATE	SYM	REVISION RECORD	AUTH.	DR	CK
ENGINE FRONT MOUNTING		6	7-28-64	1	WAS 3858043 SUPPORT	64639	JB	
				2	DWG REVISED			DF
			9-24-64	3	WAS 3858041 MOUNTING	66563	SB	DF
10000		B9.						
DWG PREL 3-13 JB REF: Prel. B-11 L-73569 L-								
DATE REL 5-21 L- L- L-								
		SHEET						

1965-66



F H B I D O C E

+
ASSEMBLY INSTRUCTIONS

3862100

CORVAIR 10000 SERIES

- ⑤ ④ ③ ① 3880558 MOUNTING ASM
② 3866517 SPL WASHER
⚠ ③ 9422298 NUT
⚠ ④ 3847758 SCREW ASM

NOTE Screws must be tightened
before torquing nut ③

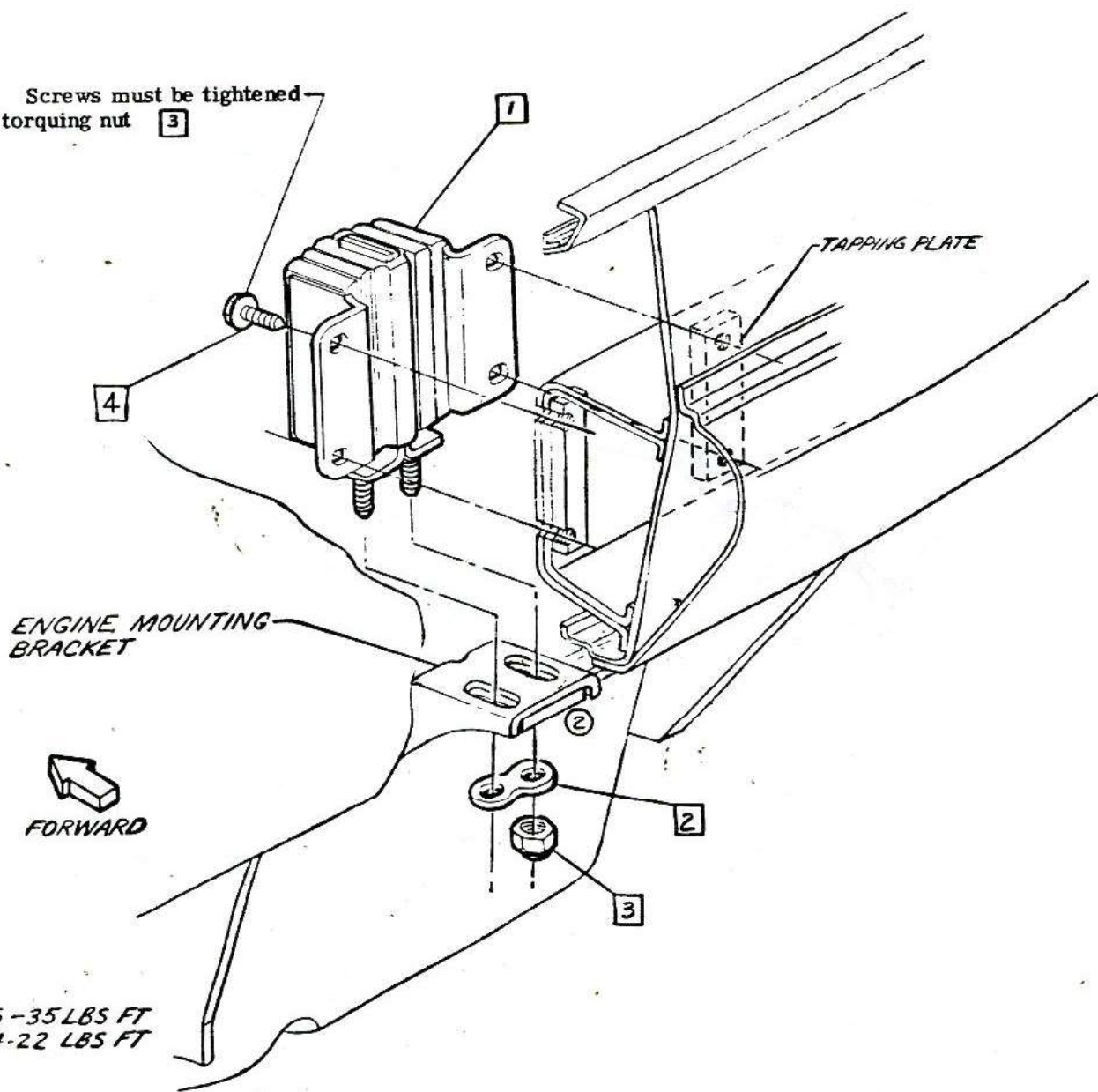

- ① ⚠ 25-35 LBS FT
⚠ 14-22 LBS FT
⚠

• CHEVROLET MOTOR DIVISION, GMC •				UPC	DATE	SYM	REVISION RECORD	AUTH.	DR	CK
ENGINE MOUNTING-REAR				6	3-30-64	1	TORQUE (1) WAS 50-60 LBS. FT.	65582 EC	DF	
					5-17-64	2	DWG REVISED 2 PLACES	65882 JB		
						3	WAS 3859833 MOUNTING			DF
					3-24-64	4	WAS 3872035 MOUNTING	66585 SB	DF	
					3-4-65	5	WAS 3872857 MOUNTING	66826 JC		
							& DRAWING REVISED			CI
10000				B10.						
DWG PREL 3-16	JB	REF: Prel. B-12L-73569 L-75755			SHEET 1					
DATE REL 5-8		L-	L-	L-						

1965-67

- ①

①	13-18 LBS IN
②	16-22 LBS IN
③	2-5 LBS IN
④	32-40 LBS IN

1965-68



CHEVROLET

ASSEMBLY INSTRUCTIONS

3862100

CORVAIR 10000 SERIES

- 1 7025023 CARBURETOR ASM
 2 7025227 CARB ASM-SECONDARY -10700
 3 3767304 PLUG-CARB VAC
 4 120368 NUT
 5 9419275 P. WASHER

- 6 3787453 INSULATOR
 3826302 OPT
 7 3814338 HOSE
 8 3786683 STUD
 9 3786684 STUD

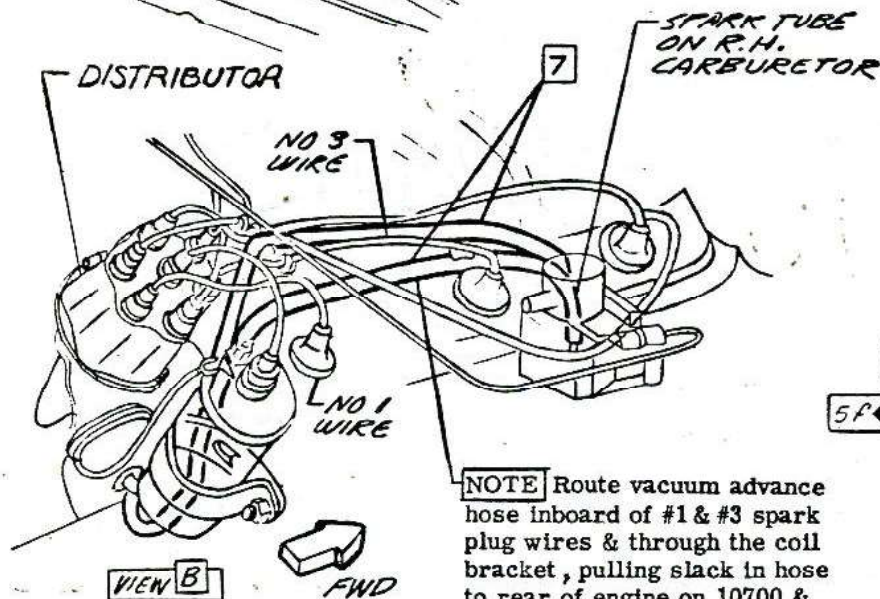
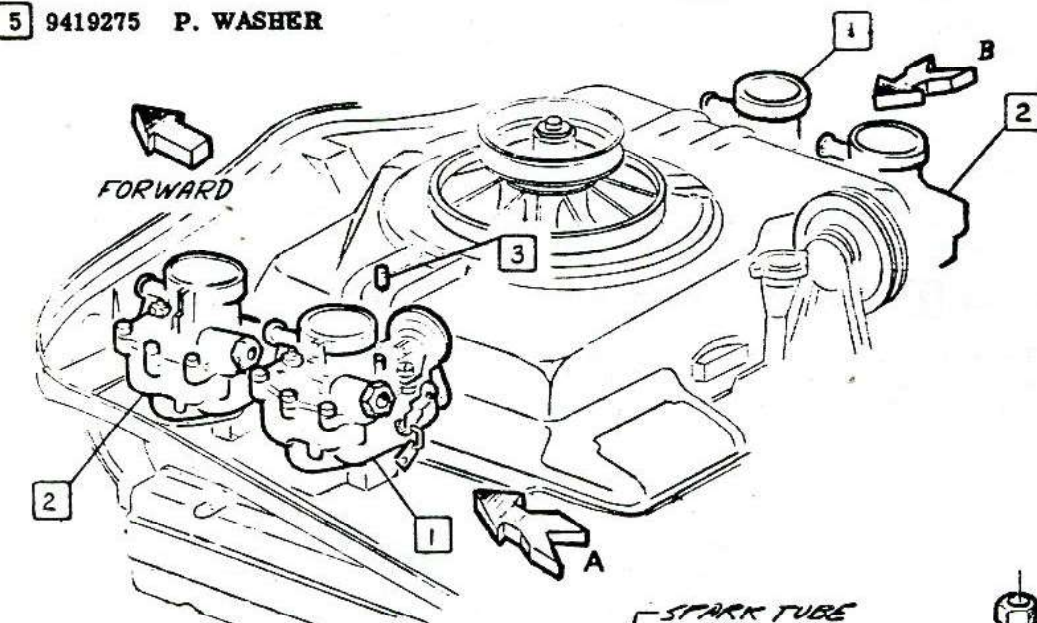

- 7 - 13 LBS FT
 100 - 140 LBS IN

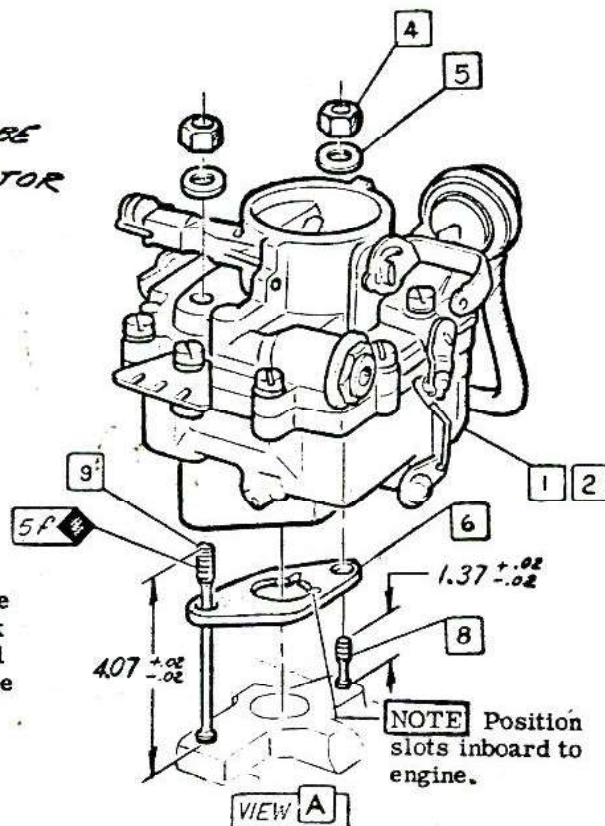

CHEVROLET MOTOR DIVISION, GMC

UPC

DATE SYM

REVISION RECORD

AUTH. DR. CK.

CARBURETOR-SPARK HOSE

6

2-25-65 G 7025023 CARB. ASM - 10700 RHYD. 60014-11

7 WAS 7025226 CARB.

C1

10000

C1.

DWG PREL 3-2 RS REF: Prel. C1 L-75671 L-
 DATE REL 5-11 L- L- L-

SHEET 1

1965-69



CHEVROLET

ASSEMBLY INSTRUCTIONS

3862100

CORVAIR 10000 SERIES

1 3819238

ROD-UPPER

2 6255773

CLIP

AUTOMATIC CHOKE ADJUSTMENT PROCEDURE

1. Before installing carburetor & fuel lines, thread upper choke rod into choke rod coupling for about 26 turns. Lower rod need not be held for this operation.
2. After installing carburetor, hold choke blade in closed position & while holding choke rod asm. upward against the internal stop, adjust upper rod in coupling until the upper end is in alignment with & freely enters the carburetor choke shaft lever hole, then back out upper rod two (2) turns.
3. Install clip **2** when proper adjustment has been determined.

CAUTION To minimize possibility of deforming upper rod, when adjusting length turn vertical portion of rod which is in line with lower rod. Do not "CRANK" rod from top of offset portion.

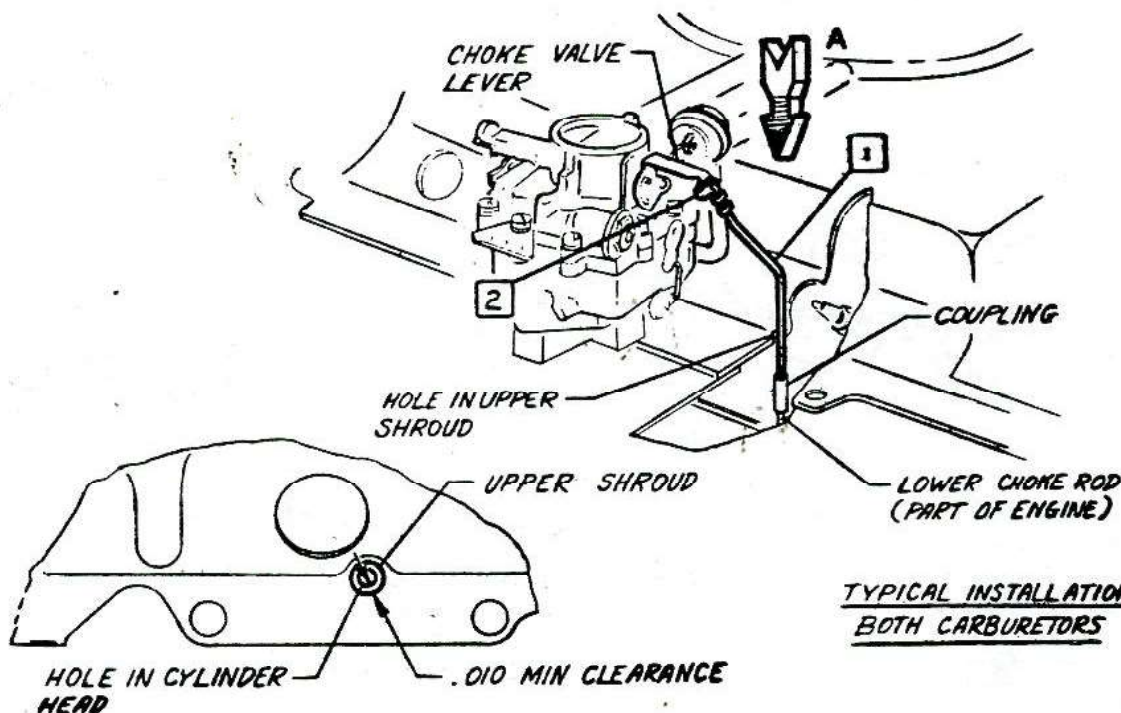

VIEW A

CHEVROLET MOTOR DIVISION, GMC				UPC	DATE	SYN	REVISION RECORD	AUTH.	DR	CK
AUTOMATIC CHOKE				6						
10000				C 2.						
DWG PREL 3-3	RS	REF: Prel. C 2	L- 75671	L-						
DATE PREL 5-11		L-	L-	L-						
				X SHEET						

1965-70



CHEVROLET

ASSEMBLY INSTRUCTIONS

3862100

CORVAIR 10000 SERIES

- ④ ① 1
① 2 3856780 PIPE ASM
⑤ ① 3 3878594 PIPE ASM R.H.
① 4 3867248 PIPE ASM L.H.
① 5 127927 TEE

- ⑥ ① 6 3870279 PIPE ASM
① 7 3785694 CLIP

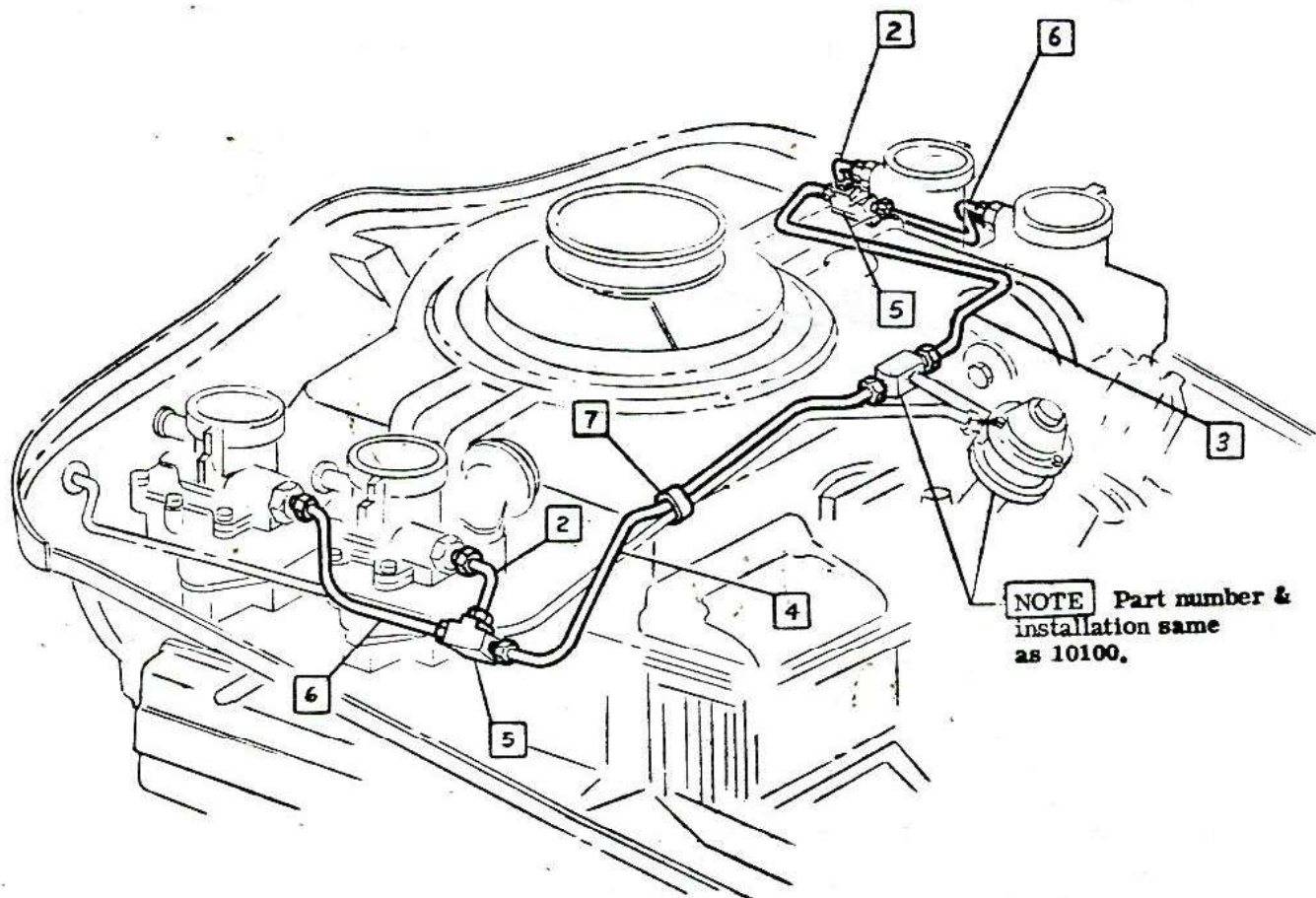

NOTE Part number &
installation same
as 10100.

▲ 85-105 LBS IN
▲
▲
▲

CHEVROLET MOTOR DIVISION, GMC		UPC	DATE	SYM	REVISION RECORD	AUTH.	DR	CK
FUEL LINES		6	2-11-65	4	3856754 PIPE REMOVED & DRAWING REVISED	69069	CH	
10700		C4.		5	WAS 3856782 PIPE (DRAWING REVISED			
DWG PREL 3-10 DATE REC 5-12		REF: Prel. C B L-75672 L-75671 L- L- L-		6	WAS L.H. ONLY			CI
		☑ SHEET						

1965-71

- 1 3785616 PIPE ASM-R.H. - 10100-500
- 2 178910 FEE
- 3 192044 NIPPLE
- 4 5656774 FUEL PUMP ASM
- 5 6256367 SCREW ASM

- 6 3814025
- 7 3785694

- PIPE ASM L.H. - 10100-500
- CLIP - 10100-500

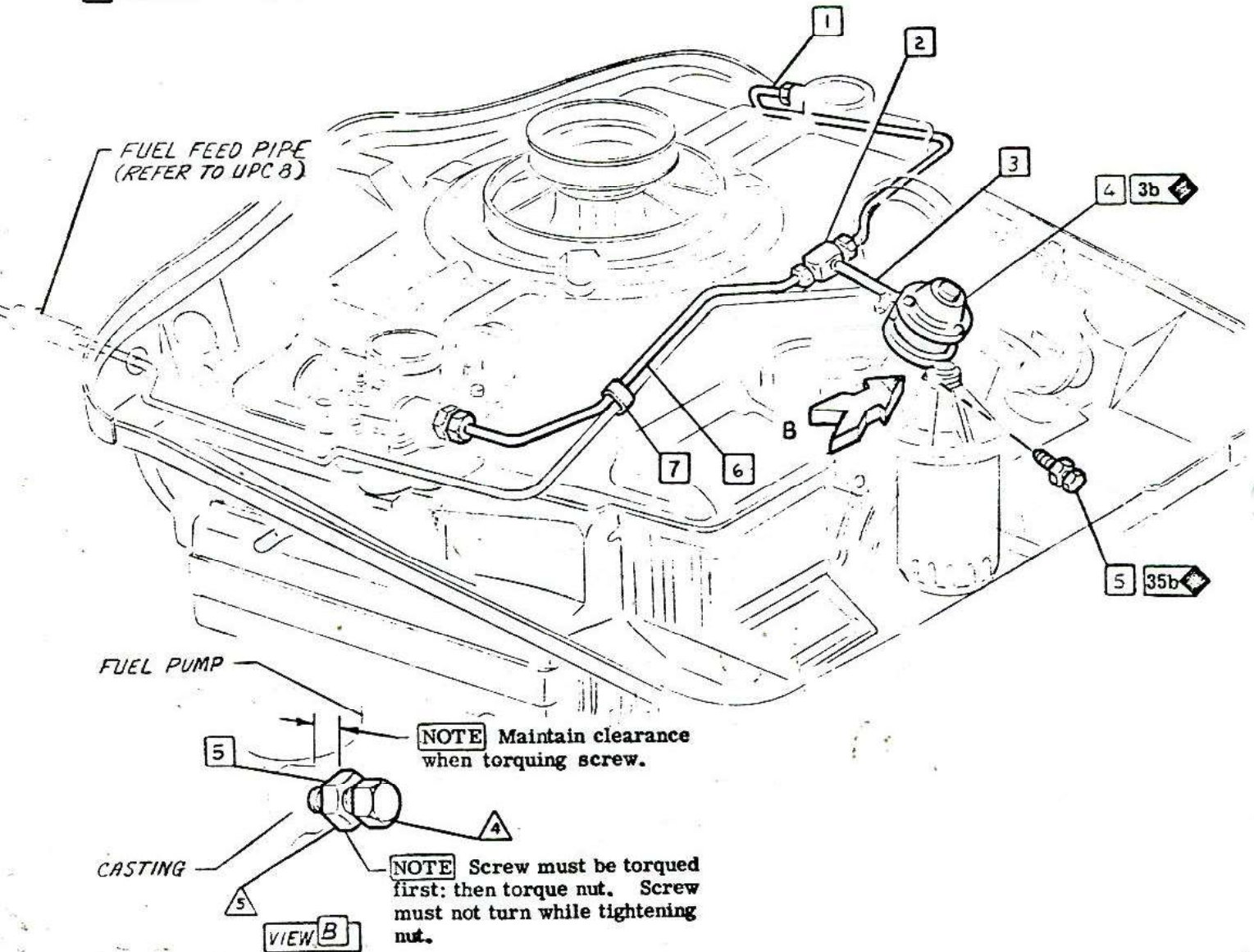

- 85 - 105 LBS IN
- 110 - 130 LBS IN
- 45 - 60 LBS IN
- 5 - 10 LBS FT
- 9 - 15 LBS FT

2

CHEVROLET MOTOR DIVISION, GMC				UPC	DATE	SYM	REVISION RECORD	AUTH	DR	CK
FUEL PUMP & FUEL PIPES				6	7-20-64	1	5851821 & 5850735 DECAL REMOVED	64271	RS	
10000				C5.		2	VIEW (A) REMOVED			HB
DWG PREL 3-3 RS REF: Prel. C3 L-74795 L-				SHEET	3-16-69	3	ITEM (7) ADDED	15867	RS	DF
DATE REL 5-8										



10000

ASSEMBLY INSTRUCTIONS

3862100

CORVAIR 10000 SERIES

- ① 1 9418699 WING NUT
 2 6419705 AIR CLEANER
 3 3708408 GASKET
 4 3845685 GASKET
 5 3856700 TUBE ASM
 6 5646135 GASKET
 7 3845686 TUBE ASM
 8 3845683 SUPPORT ASM
 9 3845682 BOLT-J
 10 3829058 CLAMP
 11 3851856 HOSE-Position hose till stop to insure perfect seal on tubes

- 14 3851855 GROMMET
 ② 15 3851821 DECAL COMANIA-10100-500
 3867213 10700

- ② 12 190254 NUT
 13 Position air cleaner into slot before tightening

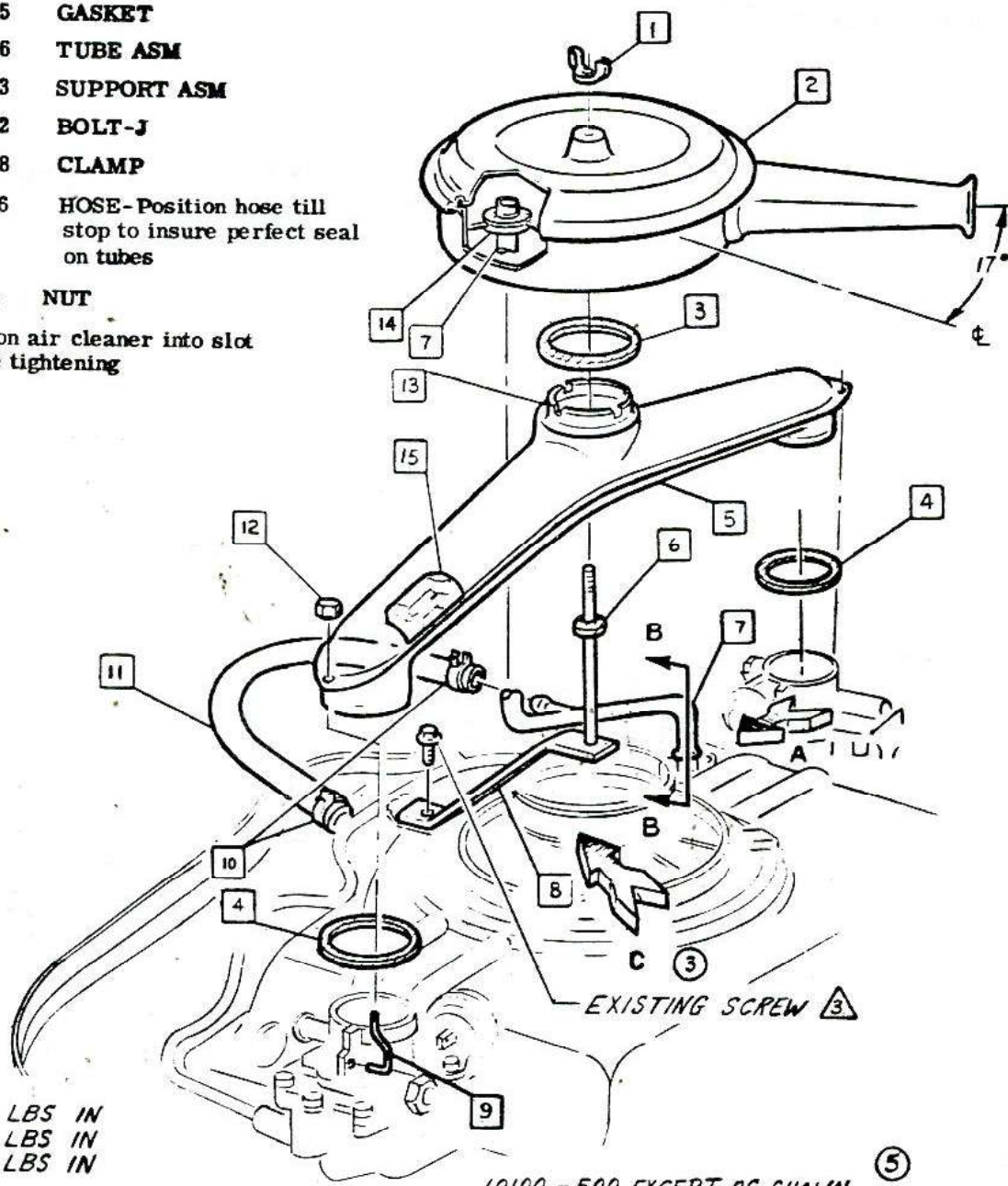

- ④ ① 15-20 LBS IN
 12-15 LBS IN
 70-95 LBS IN

10100-500 EXCEPT AS SHOWN

• CHEVROLET MOTOR DIVISION, GMC •		UPC	DATE	SYM	REVISION RECORD	AUTH	DR	CX
CLOSED ENGINE POSITIVE VENTILATION		6	7-20-64	1	TORQUE (1) WAS 5-8 LBS IN	64796	RS	
				2	ITEM (15) ADDED	64271		
				3	VIEW (C) ARROW ADDED			HR
			8-4-64	4	TORQUE (1) WAS 5-20 LBS IN.	64796	RC	DF
			10-6-64	5	MODEL NOTE ADDED		RS	
				6	WAS 10100-500 MODELS			DF
10000 ⑥		REF C7.						
DWG PREL 3-6 RS		REF: Prel. C5	L-71204	L-71020				
DATE REL 5-21		L-71747	L-	L-				
		REF C6.						
		④ SHEET						

1965-73



CHEVROLET

ASSEMBLY INSTRUCTIONS

3862100

CORVAIR 10000 SERIES

- 3 21 9417558 SCREW
22 3830641 CLAMP
23 3831574 GASKET
24 3830640 TUBE
4 25 100121 BOLT
26 6257098 CLAMP

- 27 3849320 "O" RING
28 3819252 "O" RING

NOTE Tubes to be assembled as shown to provide proper hose alignment.

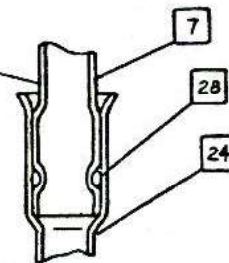

SECTION B-B

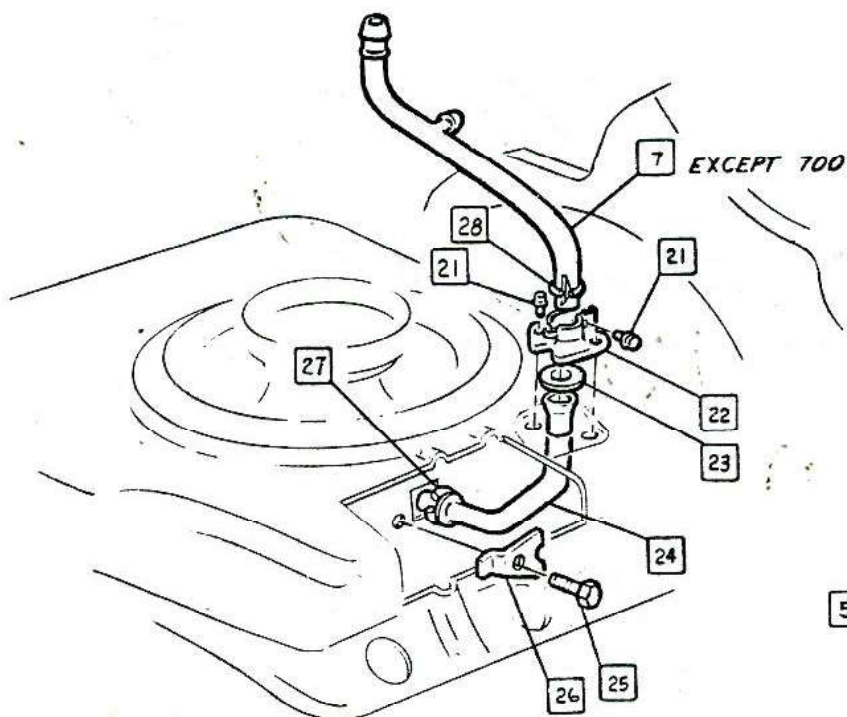

VIEW A

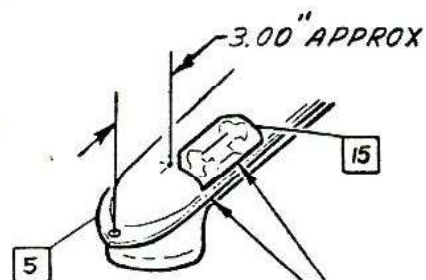

NOTE PARALLEL & ADJACENT

1 VIEW C

- 15 - 25 LBS IN
100 - 132 LBS IN

CHEVROLET MOTOR DIVISION, GMC		UPC	DATE	SYM	REVISION RECORD	AUTH.	DR	CK
CLOSED ENGINE POSITIVE VENTILATION		6	7-20-64	1	VIEW (C) & NOTE ADDED	64271	KS	HB
10000.		REF C6.						
DWG PREL 3-7		C 7.						
DATE REL 5-11		SHEET						

1965-74



CHEVROLET

ASSEMBLY INSTRUCTIONS

3862100

CORVAIR 10000 SERIES

- ① 1 9417881 SCREW
- ② 1 3867223 TUBE ASM 10100-500
- ③ 1 3870298 -10700
- ③ 3828954 HOSE

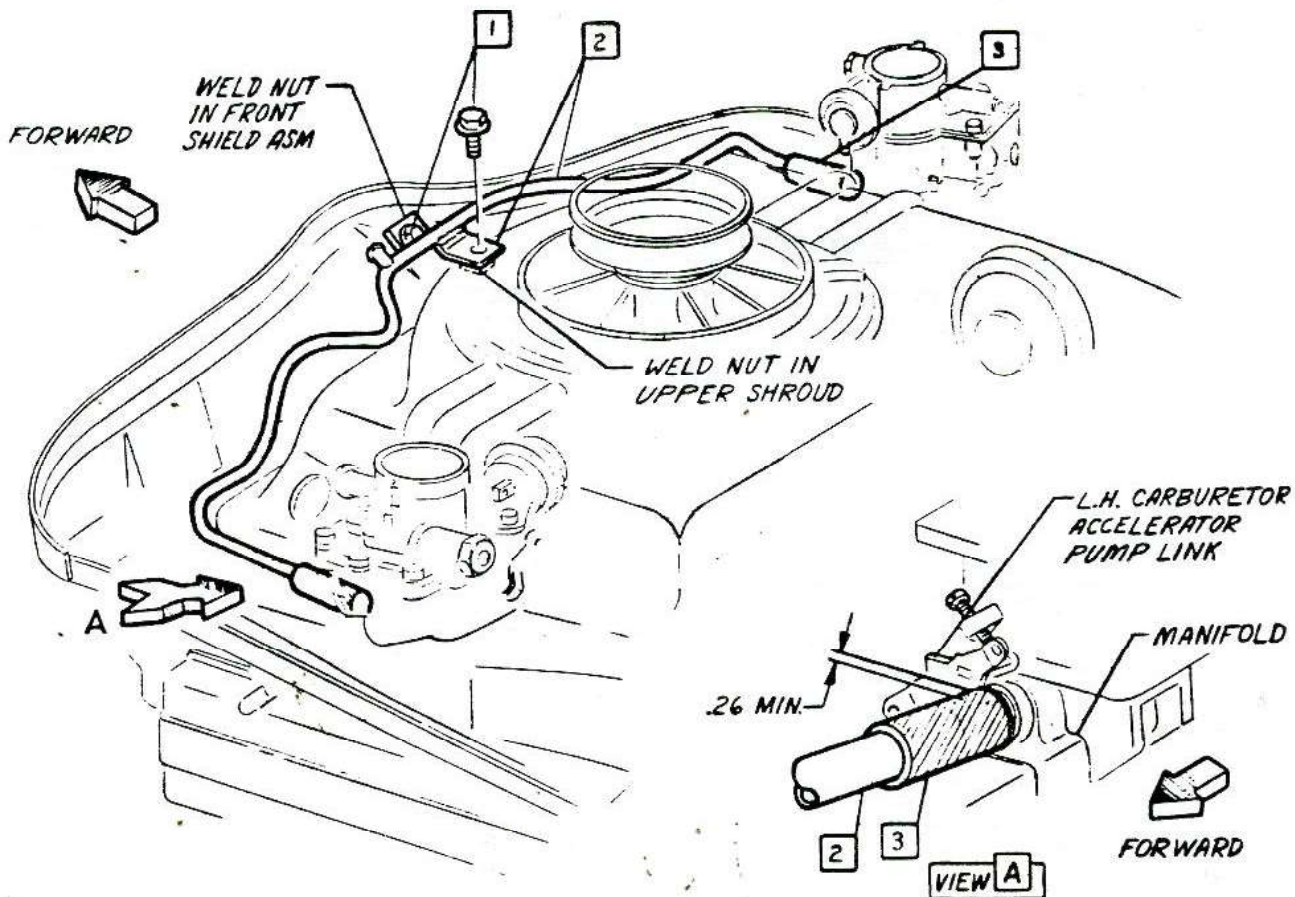

RECOMMENDED ASSEMBLY PROCEDURE

1. Assembly right & left side of tube asm. to engine manifold.
2. Assemble tube assembly to front shield asm. & upper shroud asm.

70 - 95 LBS IN

• CHEVROLET MOTOR DIVISION, GMC •				UPC	DATE	SYM	REVISION RECORD		AUTH.	DR	CK
VACUUM BALANCE TUBE				6	7-10-64	1	3856739 WAS 3856719		64796	RS	HR
					10-5-64	2	3870298 WAS 3856739		66829	RS	DF
10000				C 8.							
DWG PREL 3-5											
DATE REL 5-11											
REF: Prel. C 4 L-73370 L-											
L- L- L-				<input checked="" type="checkbox"/> SHEET							

1965-75



CHEVROLET

ASSEMBLY INSTRUCTIONS

3862100

CORVAIR 10000 SERIES

- ④ ①
⑤ ② 3886604 NUT & FERRULE ASM.
⑥ ③

- ④ 3324378 HOSE

- ⑤ Position identification mark on vacuum hose adjacent to gasoline meter unit wire lead breakout of harness asm main wire.

- ⑦ ⑥ 3724851

- TAPE a. 3 IN.
b. 6 IN.

HOSE TO FITTING INSTRUCTIONS

INSERT HOSE INTO FITTING BOTTOMING HOSE OUT. ROTATE NUT UNTIL FINGER TIGHT. THEN MAKE TWO FULL TURNS.
NOTE Flat of hex on body ① must be on top to clear lamp socket.

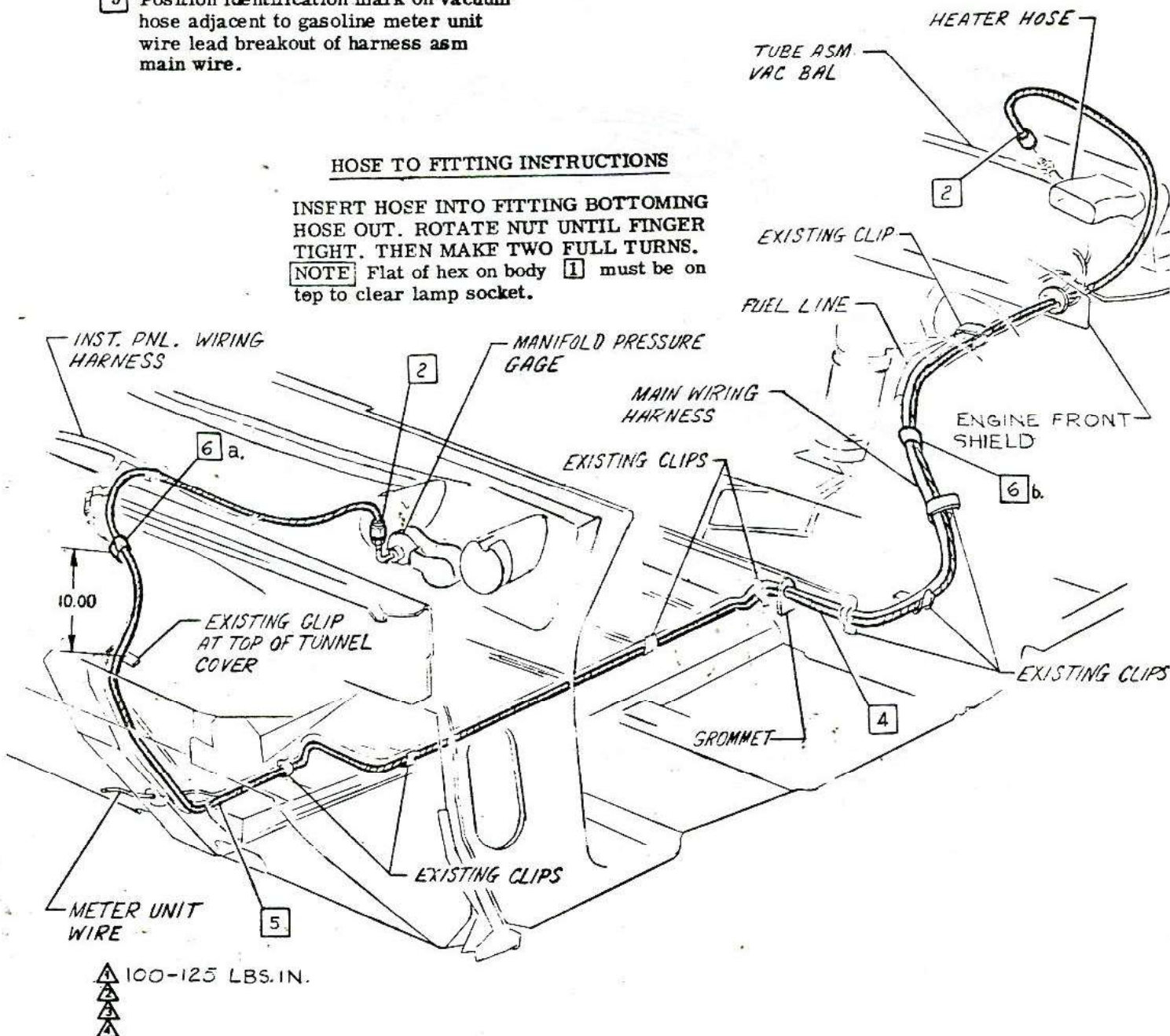

CHEVROLET MOTOR DIVISION, GMC				UPC	DATE	SYM	REVISION RECORD	AUTH	DR	CK
VACUUM GAGE HOSE				6	4-23-65	+	3866225 FERRULE REMOVED	15977	SM	
10700				C9.			5 WAS 3866222 NUT			
							6 3819070 CLIP REMOVED			
							7 ITEM 66 ADDED			CI
DWG P&EL 3-16 RS REF: Prel. C11 L-72621 L-0990				SHEET IX						
DATE P&EL 5-18 L-72625 L-										



CHEVROLET

ASSEMBLY INSTRUCTIONS

3862100

CORVAIR 10000 SERIES

1	3846201	SCREW	11	7	3878071	PEDAL ASM.
2	3710620	BUSHING	9	8	9422276	NUT
3	3861873	ROD-ACCELERATOR PEDAL	9	9	3861874	SUPPORT ASM.
4	6255952	BUSHING				
5	3868644	ROD-ACCELERATOR CONTROL				
10	6	214612				
		RING - RETAINER				

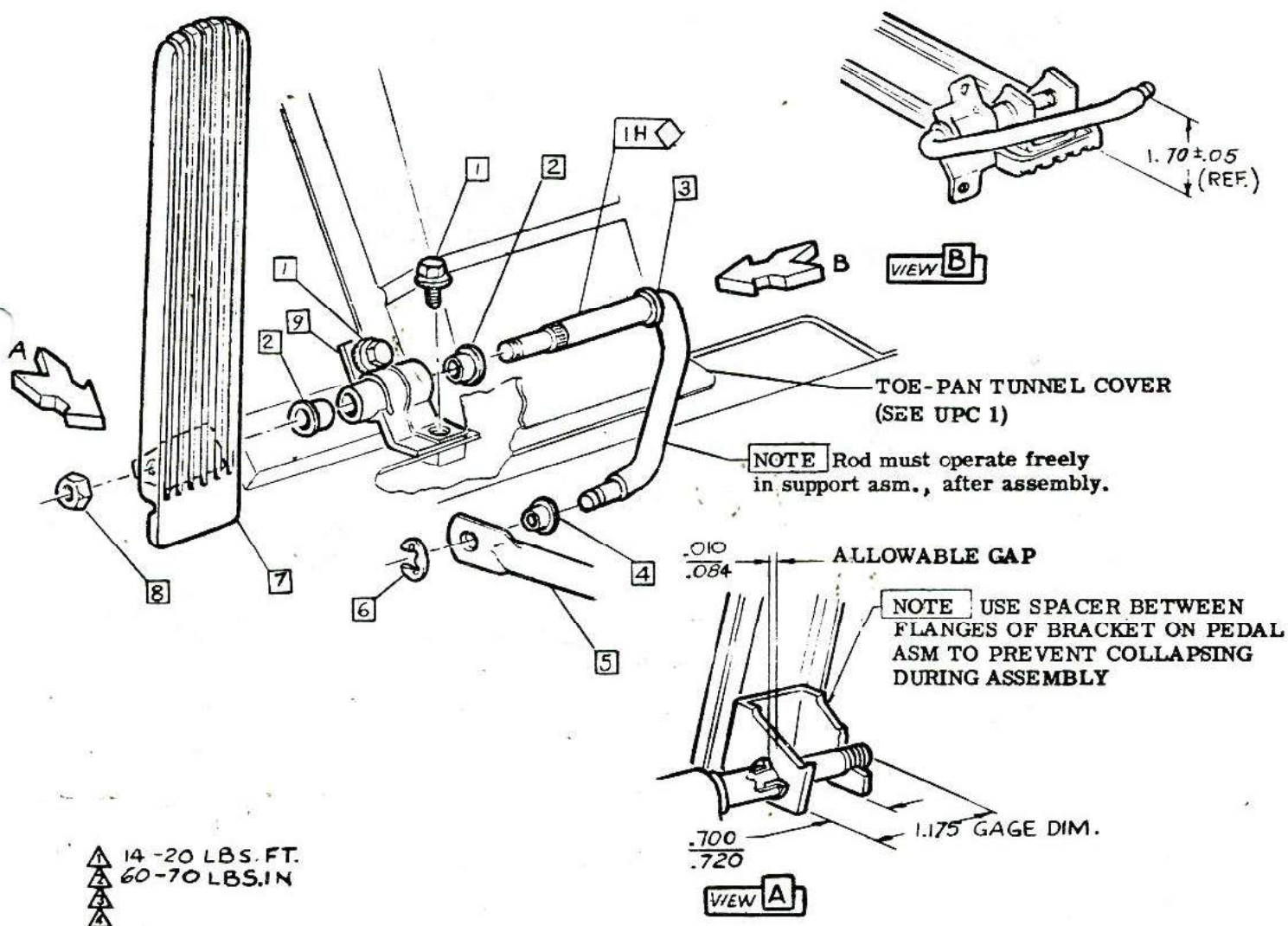

CHEVROLET MOTOR DIVISION, GMC				UPC	DATE	SYM	REVISION RECORD	AUTH.	DR	CK
ACCELERATOR PEDAL & LINKAGE				6	11-11-64	9	WAS 9414072 NUT	67286	RC	DE
10000				D1.	12-14-64	10	WAS 276412 RING	—	BR	CI
DWG PREL 1-31 RC REF: Preb. D1 L-71490 L-				SHEET X	12-30-64	11	WAS 3783566 PEDAL & DRAWING REVISED	15957	BR	CI
DATE REL 1-31 L- L- L-										

1965-77



CHEVROLET

ASSEMBLY INSTRUCTIONS

3862100

CORVAIR 10000 SERIES

- 1 3861879 ROD
2 3875095 ROD ⑦
3 3873990 SPRING-PULLBACK

- 4 3785360 SWIVEL
① 5 6256998 BOOT

ACCELERATOR CONTROL LINKAGE ADJUSTMENT ③

ROTATE REAR IDLER LEVER ③ AT TRANSMISSION CLOCKWISE UNTIL LEVER HITS STOP ON BRACKET ②⑨ & HOLD IN THAT POSITION. ACTUATE CARB. CROSS SHAFT THROTTLE VALVE LEVER UNTIL L.H. CARB. IS IN WIDE OPEN THROTTLE POSITION. ALIGN SWIVEL ④ AT UPPER END OF CARB. CROSS SHAFT ROD ② UNTIL IT ENGAGES HOLE IN CROSS SHAFT LEVER FREELY. REMOVE SWIVEL FROM HOLE & RELEASE IDLER LEVER & CROSS SHAFT LEVER TO IDLER POSITION & BACK OFF SWIVEL ④ FIVE FULL TURNS. RE-ENGAGE SWIVEL ② IN CROSS SHAFT LEVER HOLE & ATTACH SPRING ③ RECHECK ADJUSTMENT BY OPENING REAR IDLER LEVER ③ TO WIDE OPEN THROTTLE POSITION & CHECK THAT CARB. VALVE IS AT WIDE OPEN THROTTLE POSITION. (WIDE OPEN THROTTLE POSITION MAY BE ESTABLISHED BY EITHER L.H. OR R.H. CARBURETOR IF CROSS SHAFT LINKAGE ADJUSTMENT HAS BEEN MADE. SEE SHT. D4.00) WITH THE REAR IDLER ROD SWIVEL REMOVED FROM THE HOLE IN REAR IDLER LEVER ③ HOLD THE REAR IDLER LEVER IN WIDE OPEN THROTTLE POSITION. DEPRESS ACCELERATOR PEDAL TO WITHIN 2.00 ⑤ ④ INCHES OF THE TOE PAN ON JOBS WHICH COMBINE L63 & M35, SET TO WITHIN 1.50 INCHES OF THE TOE PAN ON ALL OTHER JOBS. (CARPET REMOVED). MEASURE FROM UNDERSIDE OF RUBBER FLANGE AT TOP END OF PEDAL. A SLIGHT PRESSURE IS REQUIRED ON ROD ① UNTIL ACCELERATOR PEDAL BOTTOMS ON SPACER. ADJUST SWIVEL ③ UNTIL IT FREELY ENGAGES HOLE IN BOTTOM OF REAR IDLER LEVER ③ & ASSEMBLE WITH RETAINING RING ③⑥.

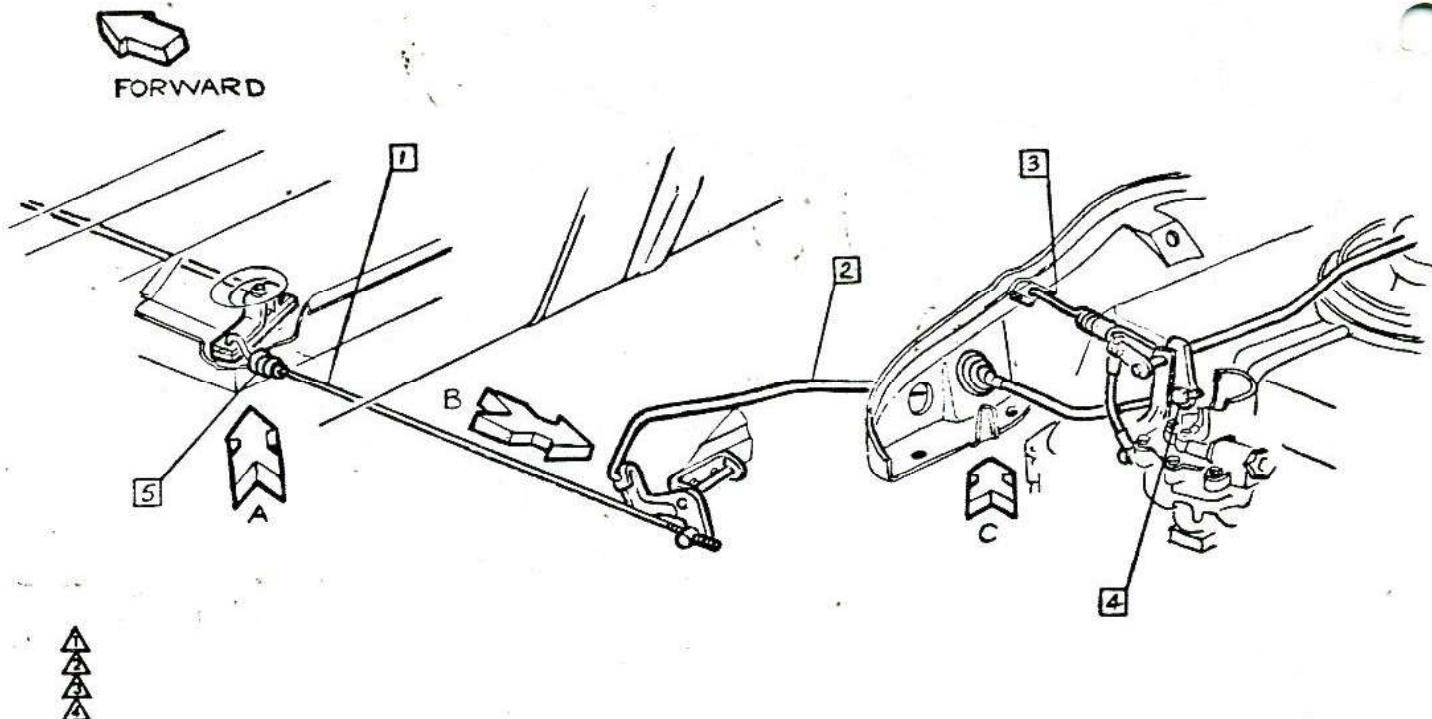

CHEVROLET MOTOR DIVISION, GMC				UPC	DATE	SYM	REVISION RECORD	AUTH.	DR	CK
ACCELERATOR CONTROLS LINKAGE & ADJUSTMENT				6	6-25-64	1	ITEM 5 ADDED	64778	RC	DF
10000				REF D 3.	7-10-64	2	WAS 3864834 ROD	—	RC	DP
D2.				⑦	9-29-64	3	EXC 10760 RMVD FROM NOTE TITLE	64467	RC	—
DWG PREL 2-14 R.C. REF: Prel. D2. L-71490 L-				⑦	—	4	1.50 WAS 1 1/4	—	—	DF
DATE REL 2-14 L- L- L-				⑦	12-30-64	5	ADJUSTMENT NOTE REVISED	67772	BR	CI
⑦ SHEET				⑦	1-22-65	6	WAS 3851924 SPRING &	67102	BR	—
				⑦	—	7	DWG REVISED	—	—	—
				⑦	—	—	WAS 3861883 ROD	—	—	CI

1965-78

- [21] 274612 RING-RETAINING
- [22] 3861877 SLEEVE
- [23] 6255952 BUSHING
- [24] 3861876 LEVER
- [25] 3876942 BOLT
- [26] 3861880 BUSHING
- [27] 3707713 SLEEVE
- [28] 3718496 P. WASHER
- [29] 3787007 BRACKET
- [30] 423345 SCREW

- [31] 3787002 SPL. WASHER
- [32] 3861881 LEVER
- [33] 6257704 SWIVEL
- [34] 3718496 SPL. WASHER
- [35] 3784992 BOOT
- [36] 9413523 RING RETAINING
- [37] 3866515 SPL. WASHER
- [38] 3728666 SPL. WASHER
- [39] 3866271 SLEEVE

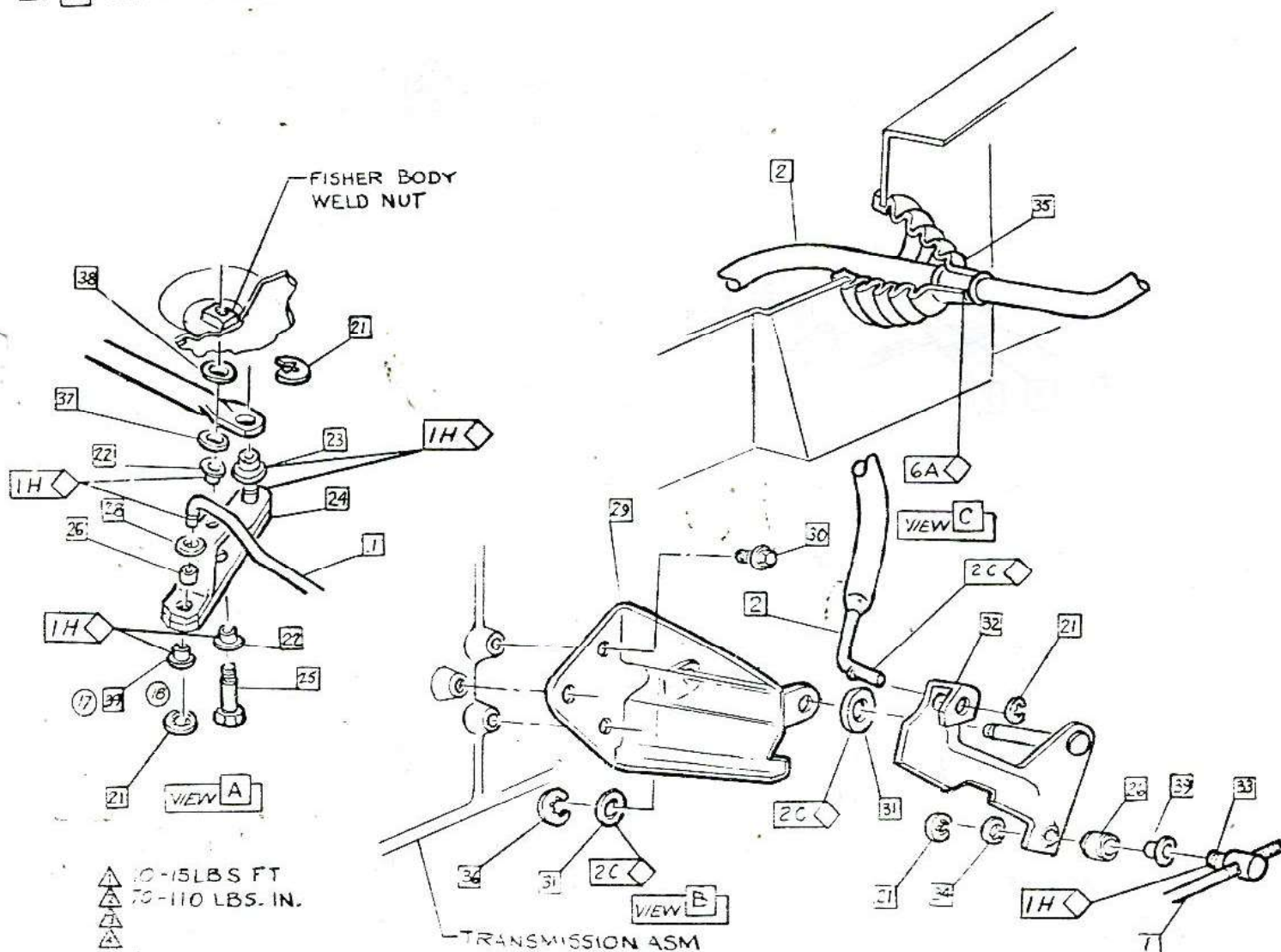

CHEVROLET MOTOR DIVISION, GMC				UPC	DATE	SYM	REVISION RECORD	AUTH.	DR.	CK.
ACCELERATOR CONTROLS LINKAGE & ADJUSTMENT				6	1-23-67	17	WAS 17-17-67 18 ITEM (25) REMOVED	3862100		CI
10000				REF D 2.						
DWG PREL 2-77 RC REF: Prel. D3 L-71490 L-				D3.						
DATE REL 2-77 L- L- L-				SHEET 1						



CHEVROLET

ASSEMBLY INSTRUCTIONS

3862100

CORVAIR 10000 SERIES

- 1 3850535 CROSS SHAFT ASM.
2 554285 CLIP
3 6255916 SWIVEL
4 3814081 ROD
5 273335 SCREW ASM.
6 2294788 CLIP

- 7 148149 RETAINER
8 3814082 ROD

CARBURETOR ADJUSTMENT

After mounting cross shaft asm. 1 & R. H. carburetor rod 8 grasp cross shaft accel. control lever lower end & push forward to insure R. H. carburetor throttle lever is against idle screw. Holding L. H. carburetor throttle lever against idle screw, adjust L. H. rod 4 by turning it into swivel 3 until it freely enters hole in lever on cross shaft asm.

1. Adjust rod 4, if required, so that L. & R. H. carb. throttle levers break away from the idle screw simultaneously. Then attach with clip 7. Manually operate linkage to check for freedom.

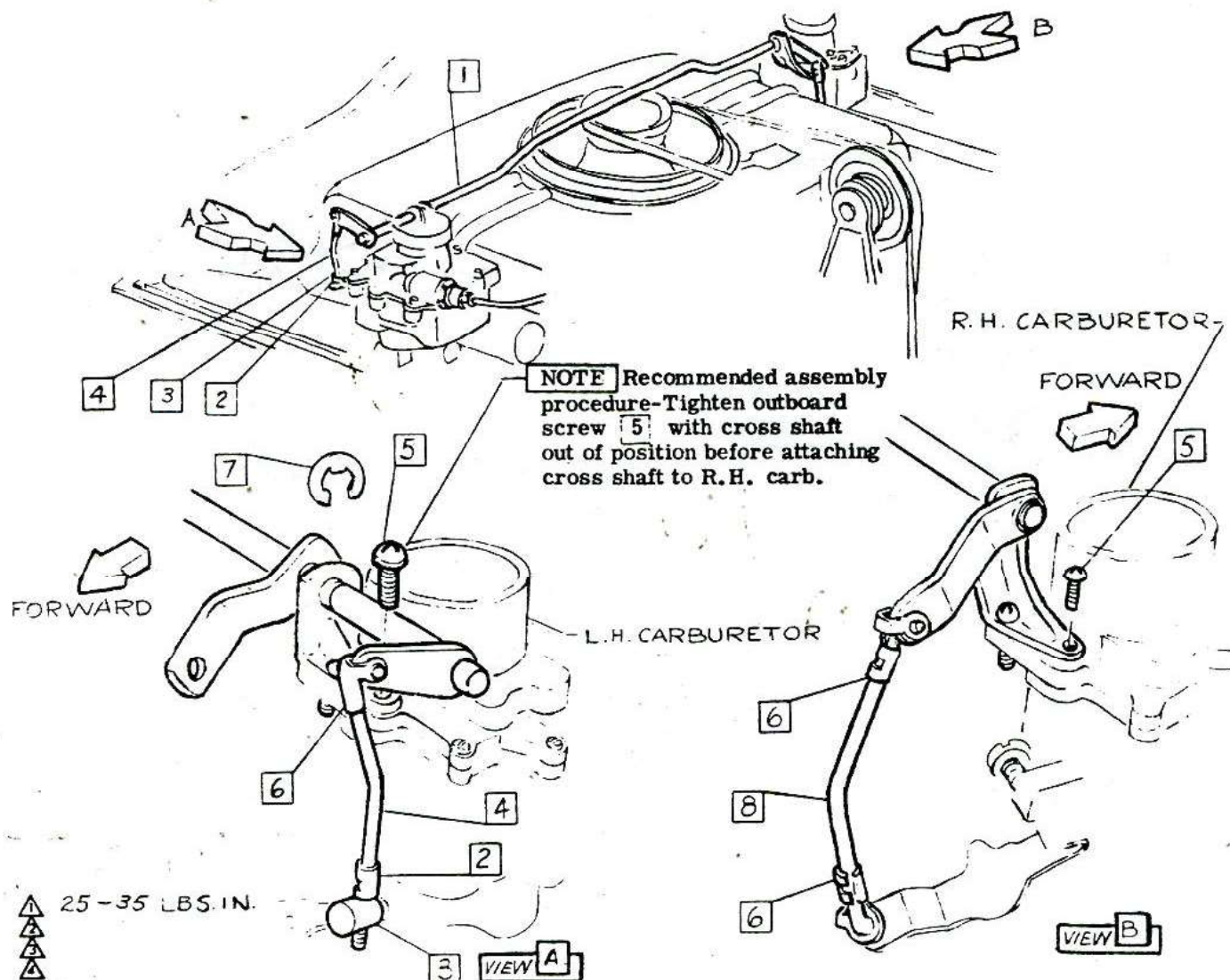

CHEVROLET MOTOR DIVISION, GMC				UPC	DATE	SYM	REVISION RECORD	AUTH.	DR	CK
CARBURETOR CROSS SHAFT LINKAGE & ADJUSTMENT				6	6-25-64	1	WAS 148194 RETAINER	6474	RCL	EA
10100-500				D4.	6-12-64	2	WAS 148194 RETAINER		RCL	
DWG PREL 2-25 R.C. REF: Prel. D 4 L-12693 L-				X SHEET						
DATE REL 2-25 L- L- L-										

1965-80

- | | | |
|---|---------|--------------|
| 1 | 554285 | CLIP |
| 2 | 3867209 | LEVER |
| 3 | 6255916 | SWIVEL |
| 4 | 3873991 | ROD |
| 5 | 3873988 | SHAFT ASM. |
| 6 | 2294788 | CLIP |
| 7 | 274574 | RING |
| 8 | 3867210 | SUPPORT ASM. |

- | | | |
|----|---------|-----------|
| 9 | 3867212 | ROD R. H. |
| 10 | 3873992 | ROD R. H. |
| 11 | 3867206 | ROD |
| 12 | 3867205 | ROD L. H. |
| 13 | 3867211 | ROD L. H. |
| 14 | 274611 | RING |
| 15 | 3873993 | SWIVEL |
| 16 | 3873994 | SPRING |
| 17 | 273335 | SCREW |

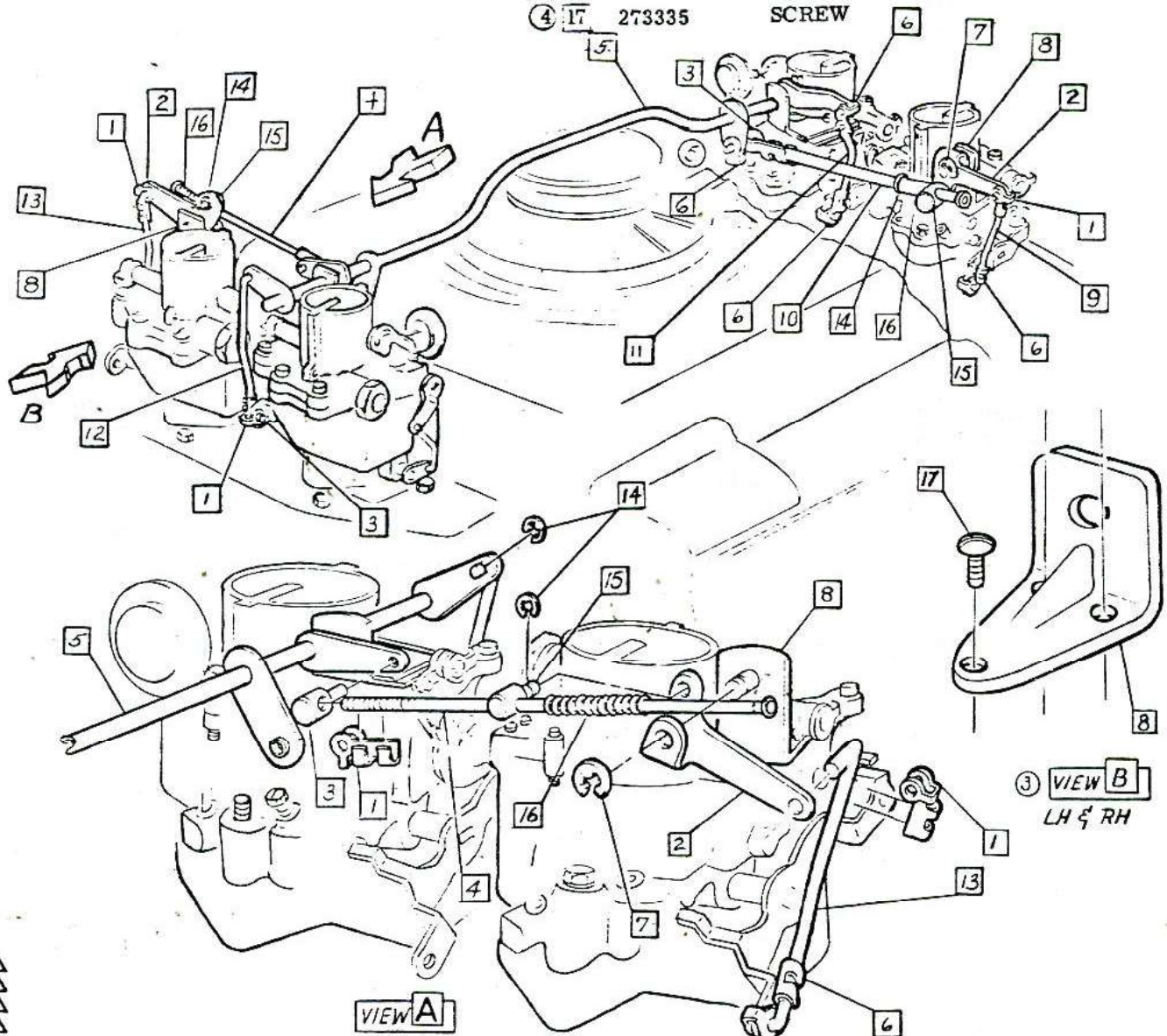

VIEW B
LH & RH

CHEVROLET MOTOR DIVISION, GMC		UPC	DATE	SYM	REVISION RECORD	AUTH.	DR	CK
CARBURETOR LINKAGE		6	3-2-65	2	REDRAWN & REDESIGNED	67102	BP	CI
10700		D5.	3-4-65	3	VIEW B ADDED	15982	KM	CI
DWG PREL 3-5		5B	3-5-65	4	ITEM 17 ADDED			CI
DATE REL 5-5			3-5-65	5	CLIP & SWIVEL DWG. REVISED		KM	CI
REF: Prel. D 5 L-75715 L-75471		SHEET						
L-75634 L-								

② ① SECONDARY CARBURETOR ADJUSTMENT

WHEN PRIMARY CARBURETOR ADJUSTMENT IS COMPLETE, INSERT .060 SPACER BETWEEN ANY TWO COILS OF THE SECONDARY ACTUATING SPRING D WHILE HOLDING CROSS SHAFT CONTROL LEVER A AT LOWER END UNTIL PRIMARY CARBURETOR THROTTLE LEVERS B ARE AT WIDE OPEN THROTTLE STOPS, AND PRIMARY CHOKE BLADES ARE IN OFF POSITION. ADJUST EACH SECONDARY ACTUATING ROD C TO FULLY COMPRESS SECONDARY ACTUATING SPRINGS D TO SOLID HEIGHT. REMOVE SPACERS FROM SPRINGS.

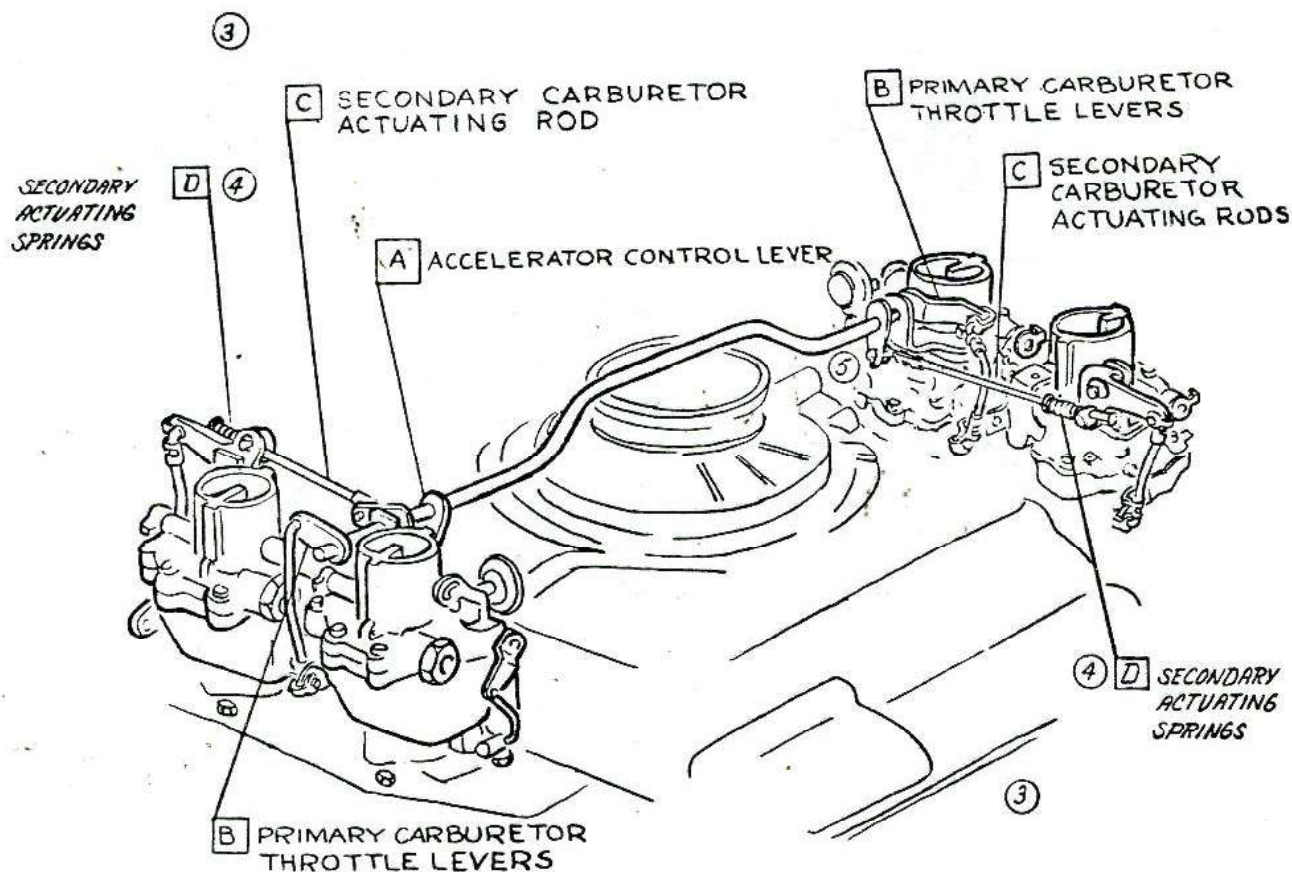

• CHEVROLET MOTOR DIVISION, GMC •				UPC	DATE	SYM	REVISION RECORD	AUTH.	DR	CK
CARBURETOR LINKAGE ADJUSTMENT				6	1-22-65	1	CARB. ADJUSTMENT REVISED	67102	JC	CI
10700					3-31-65	2	CARB. ADJUSTMENT REVISED	—	KM	
DWG PREL 5-18 R.C. REF: Prel. D 6. L-75671 L-				D6.		3	NOTE (C) RMVD. (2) PLACES			
DATE REL 5-18 L-76634 L- L-						4	WAS SWIVEL (2) PLACES			
					5	SWIVEL & CLIP DWG. REVISED			CI	
				<input checked="" type="checkbox"/> SHEET						

This document was created with Win2PDF available at <http://www.win2pdf.com>.
The unregistered version of Win2PDF is for evaluation or non-commercial use only.
This page will not be added after purchasing Win2PDF.